

31208 Hokusai - The Great Wave

- Installation requires a lot of patience and great observation that your LEGO bricks will come alive when you get this finished. The bricks with lighting as below, so make sure you're ready and let's get started.

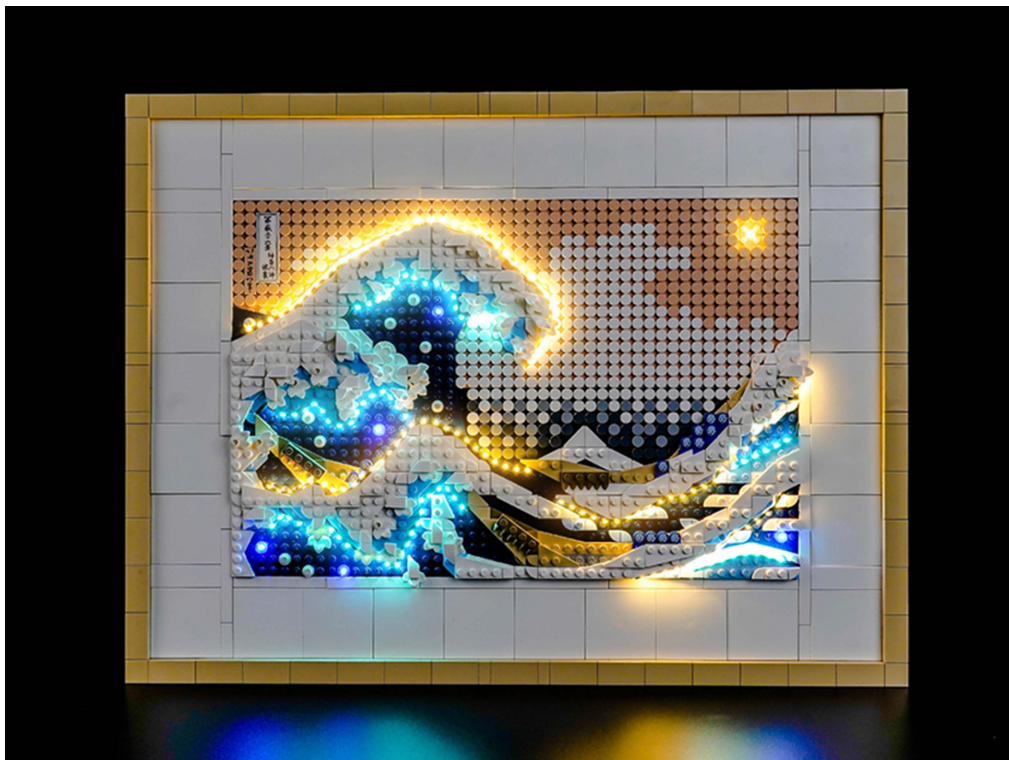

Strategies for the Installation

This instruction divides three sections to complete the installation of the lighting set.

Section A: Check the type and quantity of components.

The quantity and type of components of each products are different and it needs to be carefully checked to make sure there do have enough material. The type of components is indicated by the label on the bag.

Section B: Test that each components is working properly.

Each components is made individually so it is necessary to test that each components is working properly to avoid the situation that the lighting does not work .

Section C: laying out components following the instruction.

Our material is very small but not fragile, just be reminded that don't to pull the wires too hard. For different people, there may be some installation steps that you can't understand. Please look at the previous and later installation step.

Section A: Check the type and quantity of components.

This set contains thirteen bags labelled "1" "2" "3" "4" "5" "6" "7" "8" "9" "10" "11" "A01305" "A03801", please make sure that the components in each bag are the same as shown in the pictures.

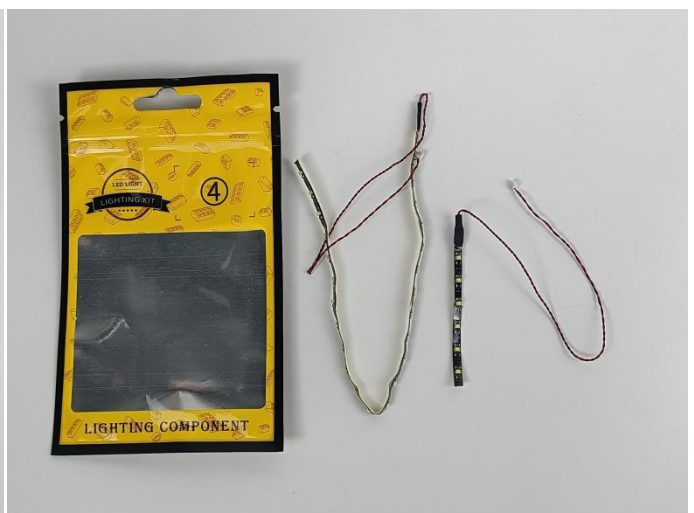





Please contact us immediately if there have any missing components.

Section B: Test that each components is working properly.

We need a structure to test all lights, so take out the bag with label “USB Power Cord”and “Expansion Boards”as follows.



It is worth reminding that our products are all customized. They have a unique way of connecting. The white plug on wire and the socket of the expansion board need to be connected together to transmit power.

Note that on one side of the white plug you can see two very small golden wires that should be connected to the two golden needles in socket of the expansion board. shown as blow.

Expansion Board

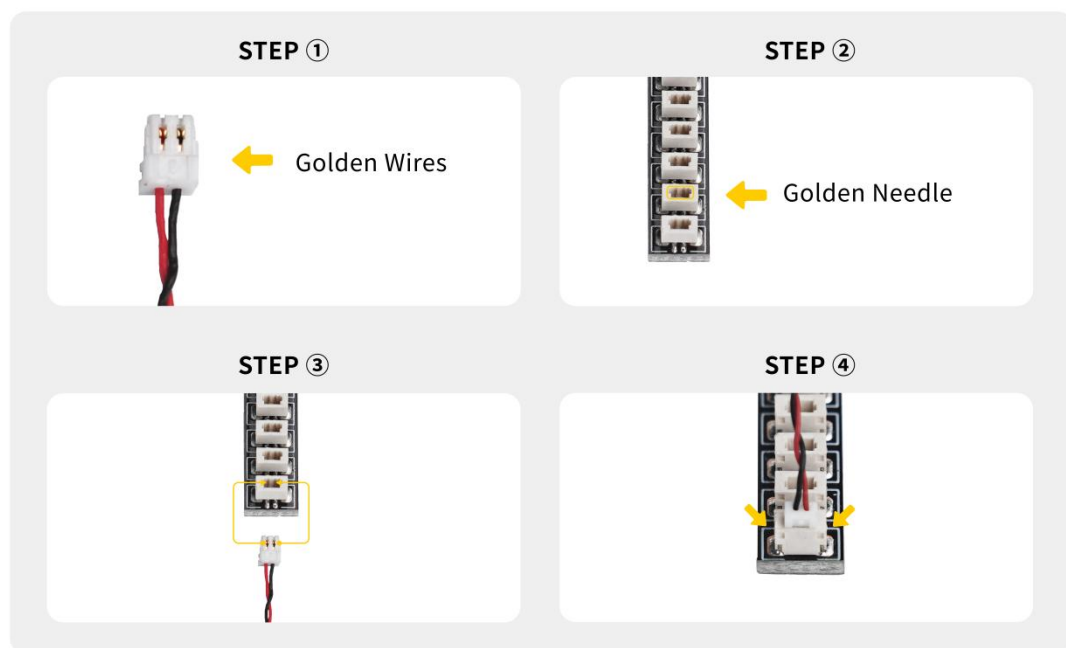

All our connections between plug and socket are all the same as shown above. So for any such structure with plug and socket, please pay attention to the golden wire of the plug and the golden needle of the socket, they must be touched together.

The connection method between the USB Power Cord and Expansion Boards is as follows:

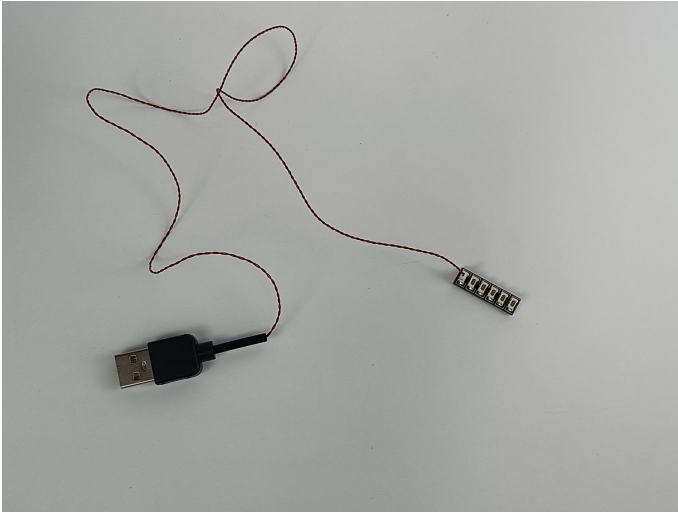

The USB Power Cord can be powered by phone chargers, power banks, etc.

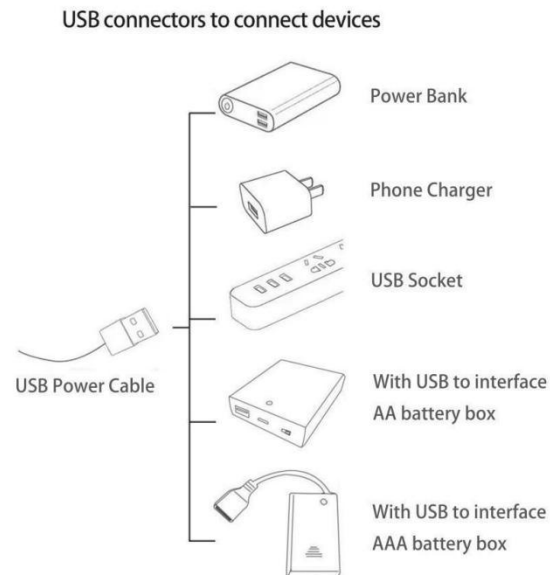

This instruction will use the power bank as power supply . The test structure is shown as follow. All lamp in this set will be tested by this structure.



When we test "③" particles. Take out one of the light and connect it to the socket. Turn on the power bank, the light will turn on normally as shown below.



Test each lamp according to this method. It should be noted that after the test, the lamp must be returned to the corresponding bag to avoid confusion of types.

Section C: laying out components following the instruction.

1.Take out the model.



2.Remove the building blocks one by one.

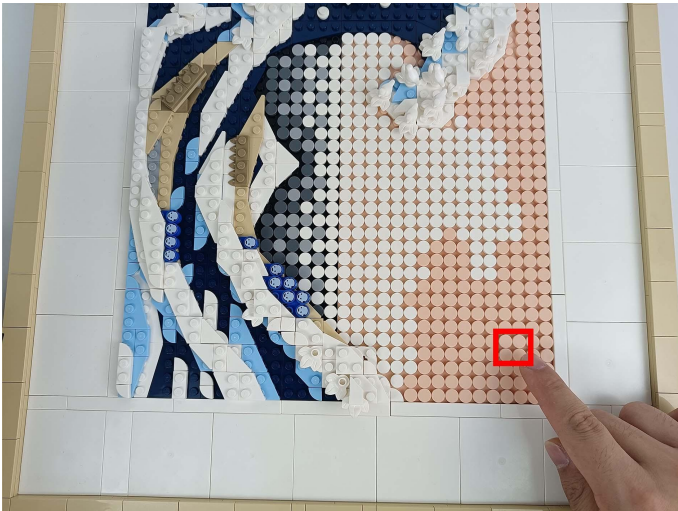

3.Take out one 15cm warm white bulb and one 2*2 round plate of transparent color from bag No.1.



4. Place the lamp with its bright side up on top of the model, and then fix the lamp to the model with a round plate.



5. Remove the building blocks one by one.

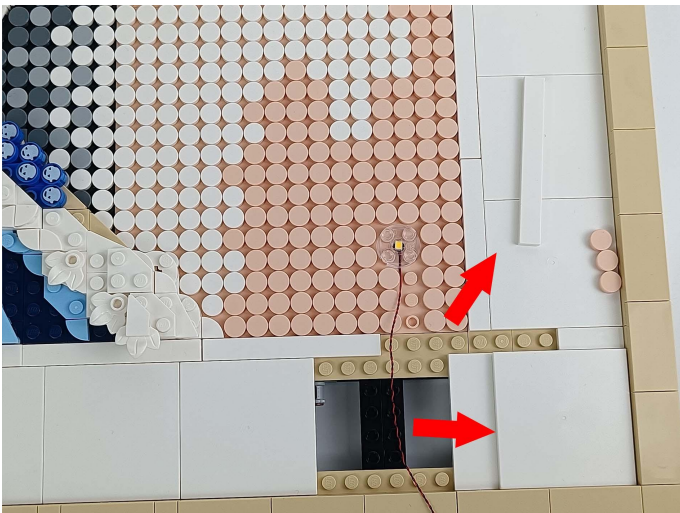

6. Thread the wire to the bottom and restore the building blocks.

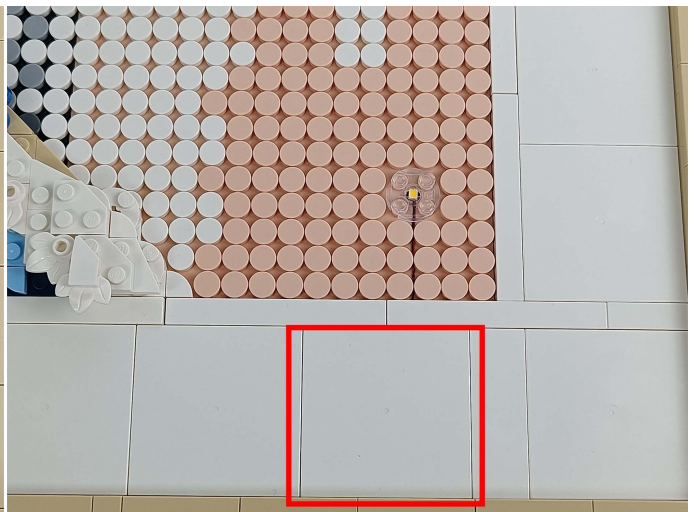
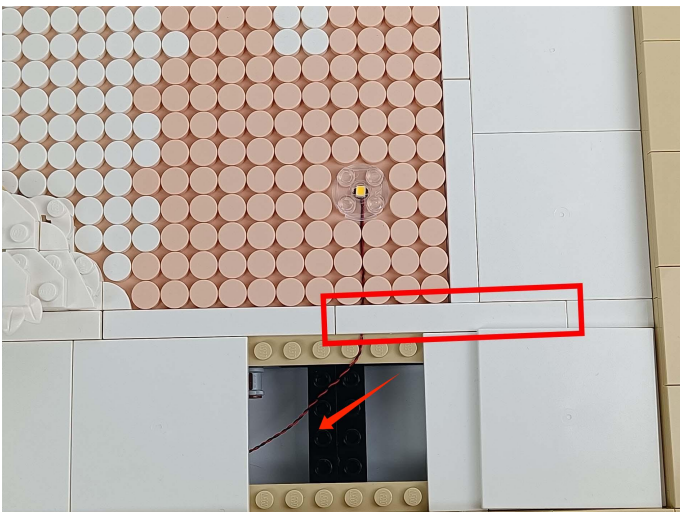

7.The wiring to the back of the model is shown in the figure.

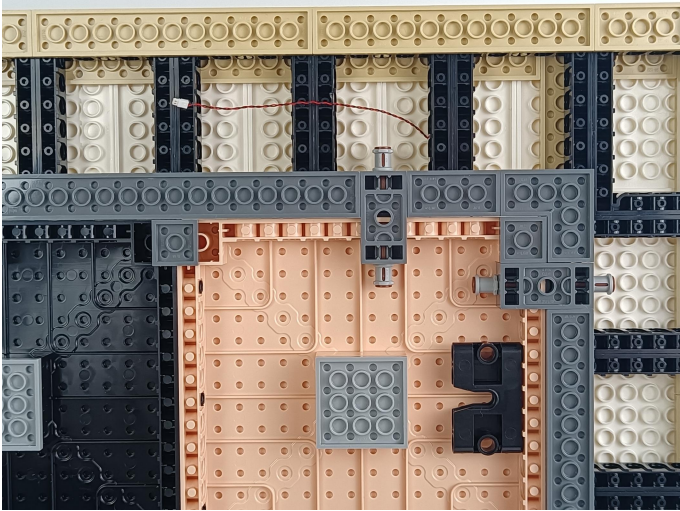

8.Look at the position in the picture and prepare to install.



9.Take one 28-piece warm white light from bag 2.



10.Look at the position in the picture and tear off the back adhesive paper on the light fixture.



11.Attach the lights to the building blocks.



12.Take the shorter warm white light bulb from bag 3.



13. Peel off the backing paper from the light fixture and stick it to the building block.

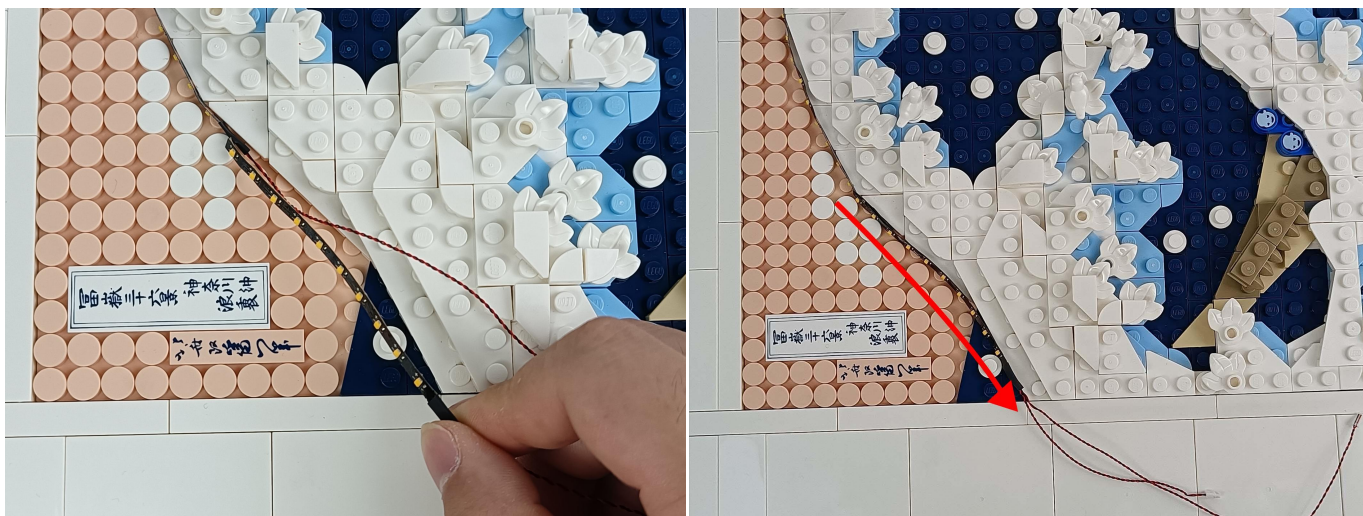

14. Look at the position in the picture and remove the building blocks one by one.

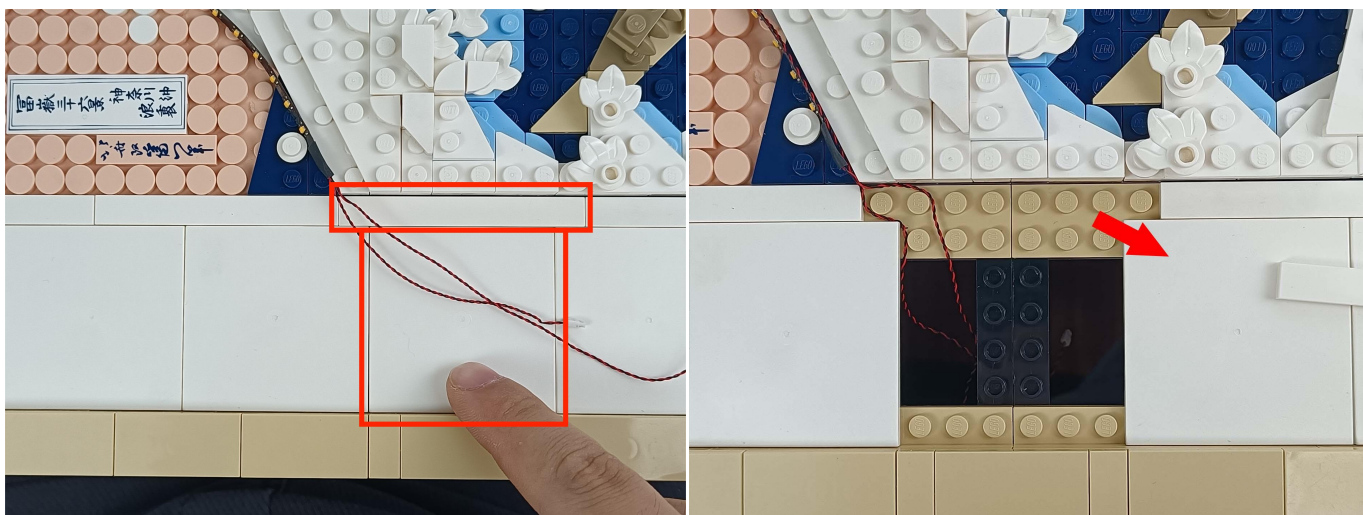

15. Thread the wires to the bottom in order, and then restore the building blocks in order.



16.Look at the position in the picture.



17.Remove the building blocks one by one.

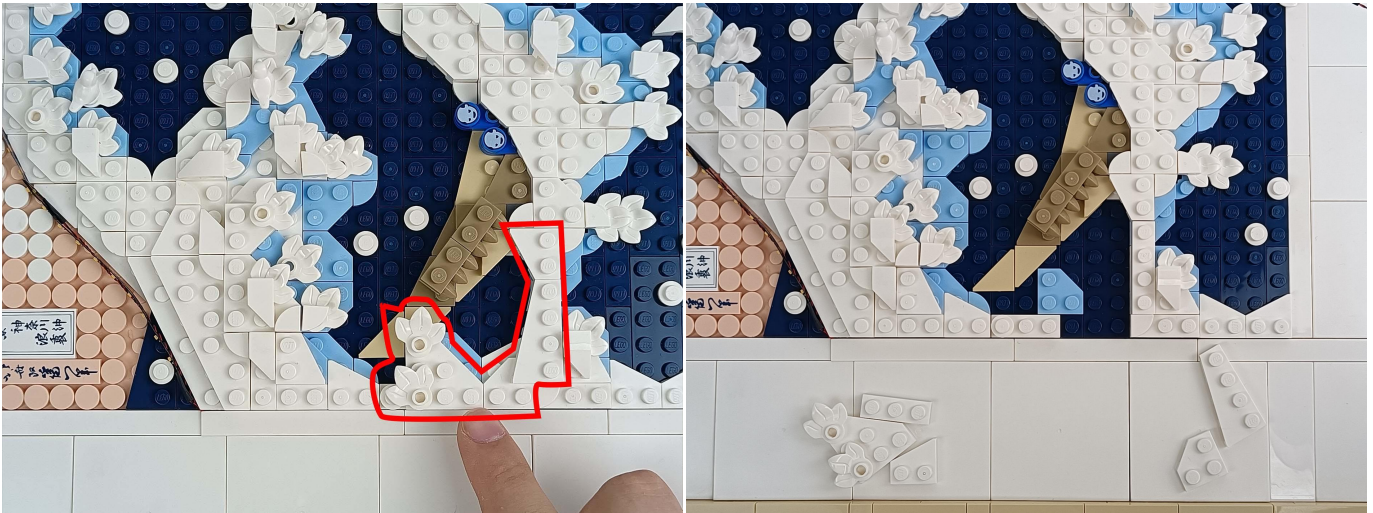

18.Take one 28-piece warm white light bulb from bag 2.



19. Peel off the backing paper from the light fixture and stick it on the building block.



20. Restore the building blocks and press down the light wire.



21. Remove the building blocks one by one.

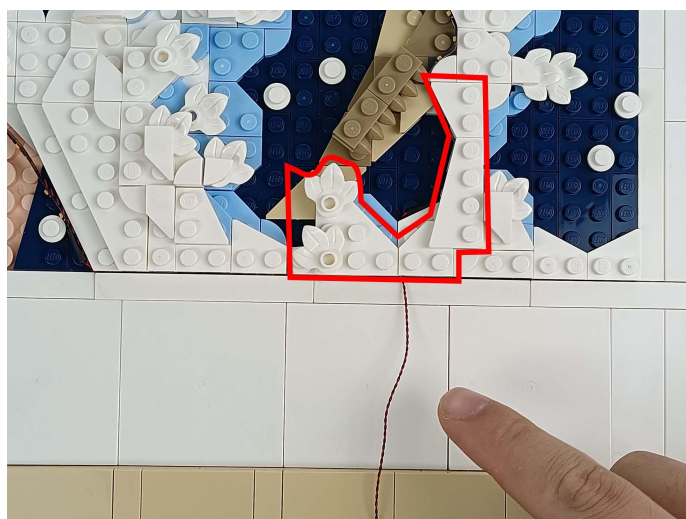

22.Remove the building blocks at the position in the picture, then put the light wire to the bottom, and then restore the building blocks in turn, pressing the light wire.

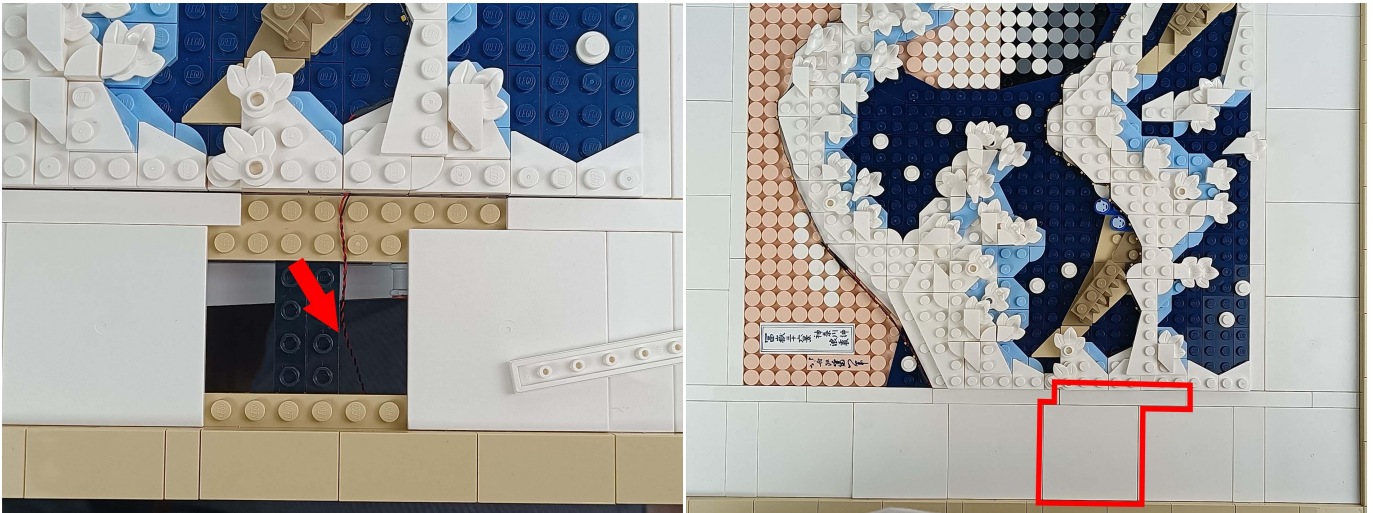

23.The wiring to the back of the model is shown in the figure.

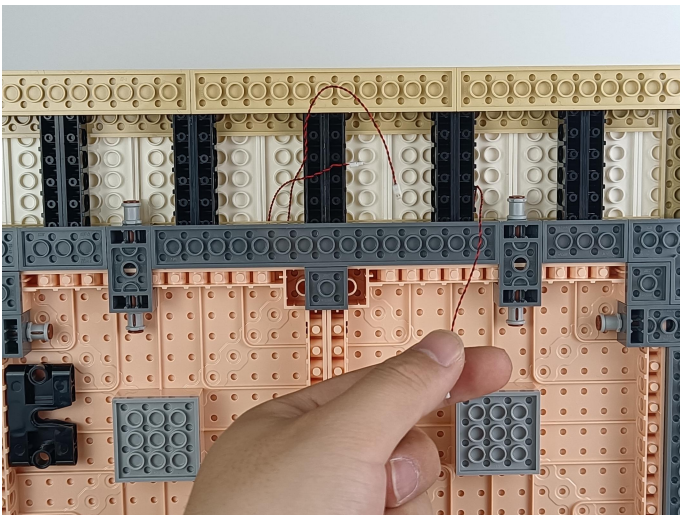

24.Take one of the 28 warm white light beads from bag 2.



25.Look at the position in the picture.

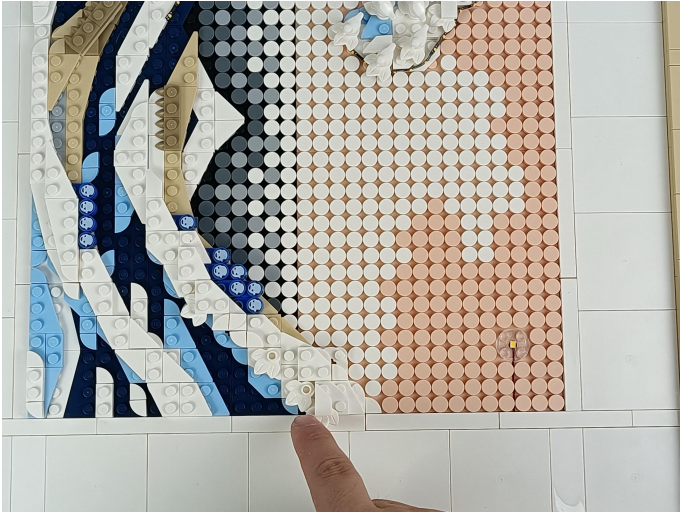

26.Peel off the backing paper from the light fixture and stick it to the building block.

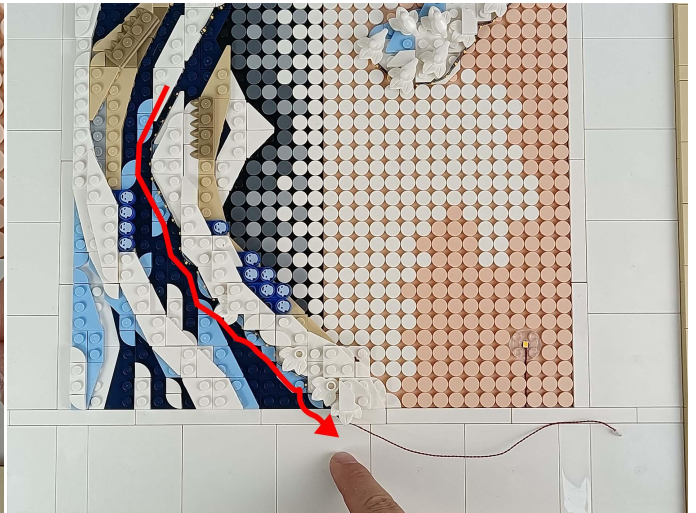

27.Remove the building blocks one by one, thread the light wire to the bottom, and then restore the building blocks one by one.

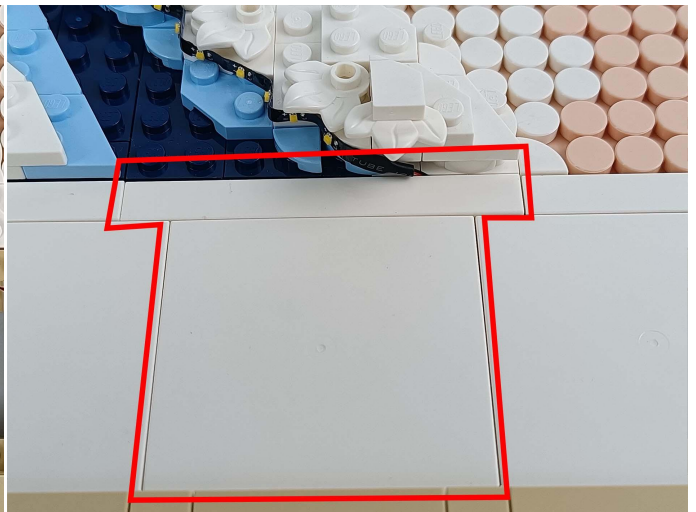

28.The wiring to the back of the model is shown in the figure.

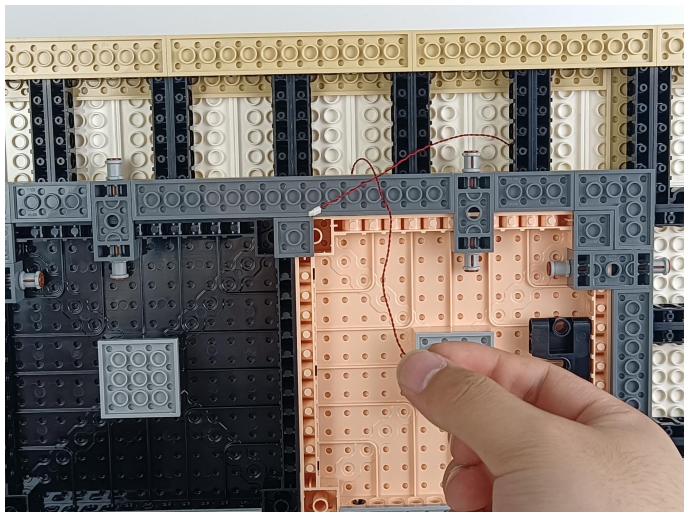

29.Look at the position in the picture.



30.Take one warm white light from bag 3.



31. Peel off the backing paper from the light fixture and stick it to the building block.

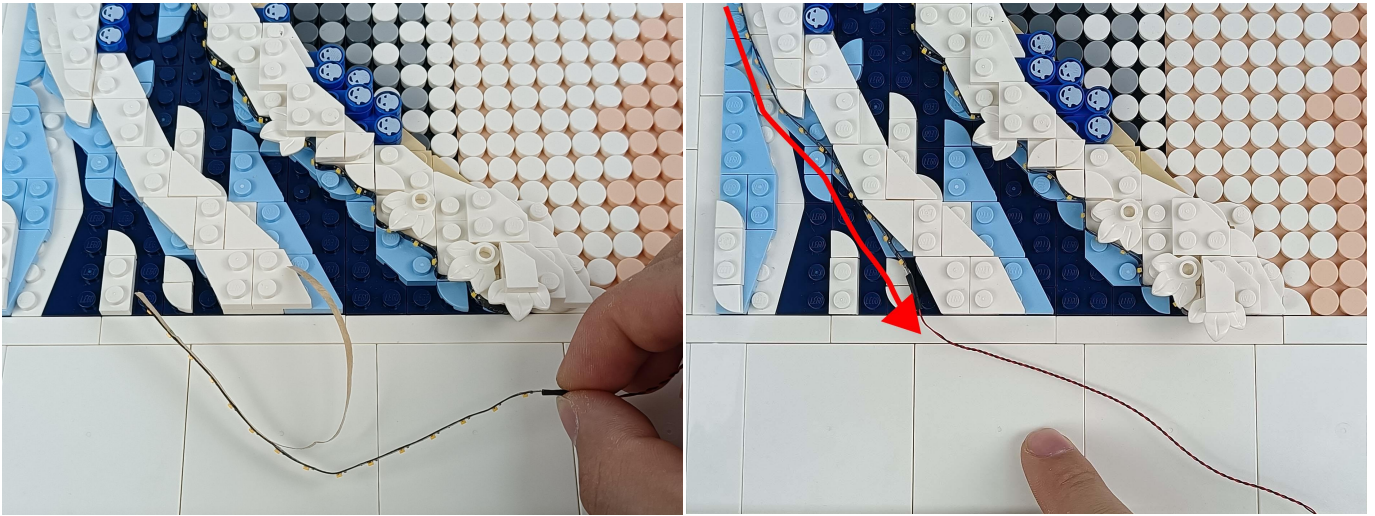

32. Thread the wire to the bottom and restore the blocks in sequence.



33. The wiring to the back of the model is shown in the figure.

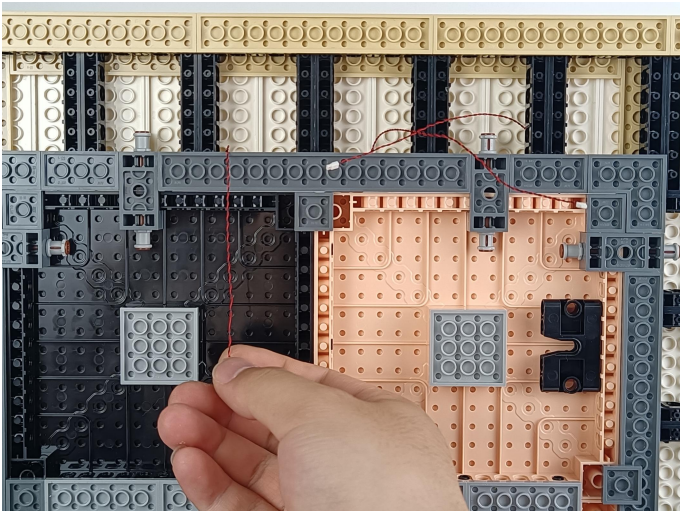

34. Twist the lamp wires in the picture into a single strand.

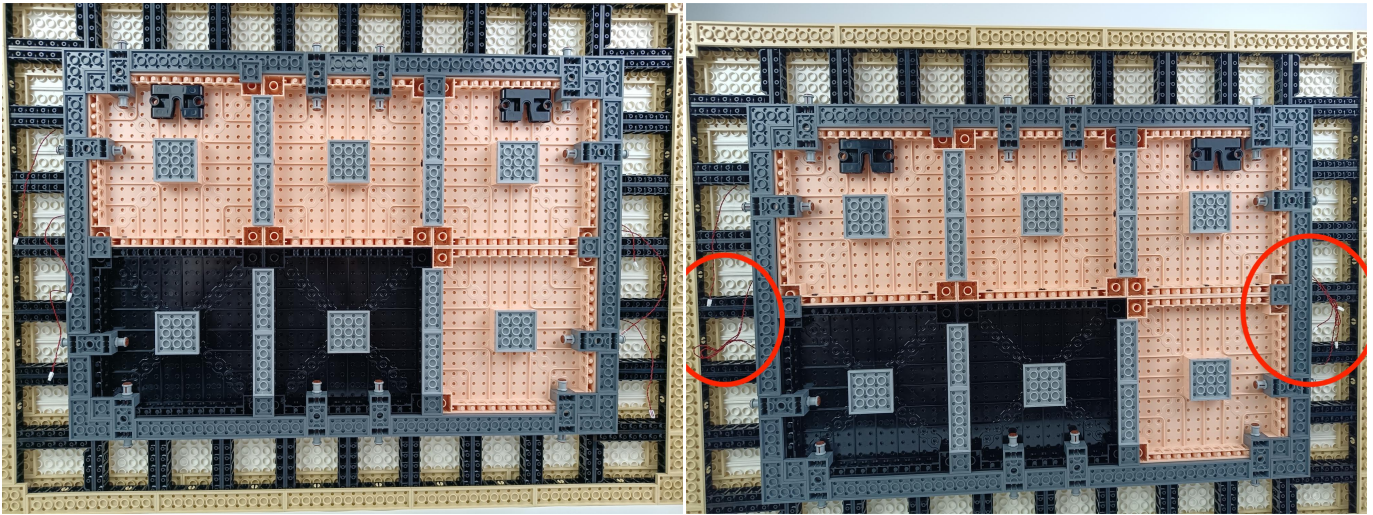

35. Look at the position in the picture.



36. Take out the longest green light particle from bag 5.



37. Peel off the backing paper from the light fixture and stick it to the building block.

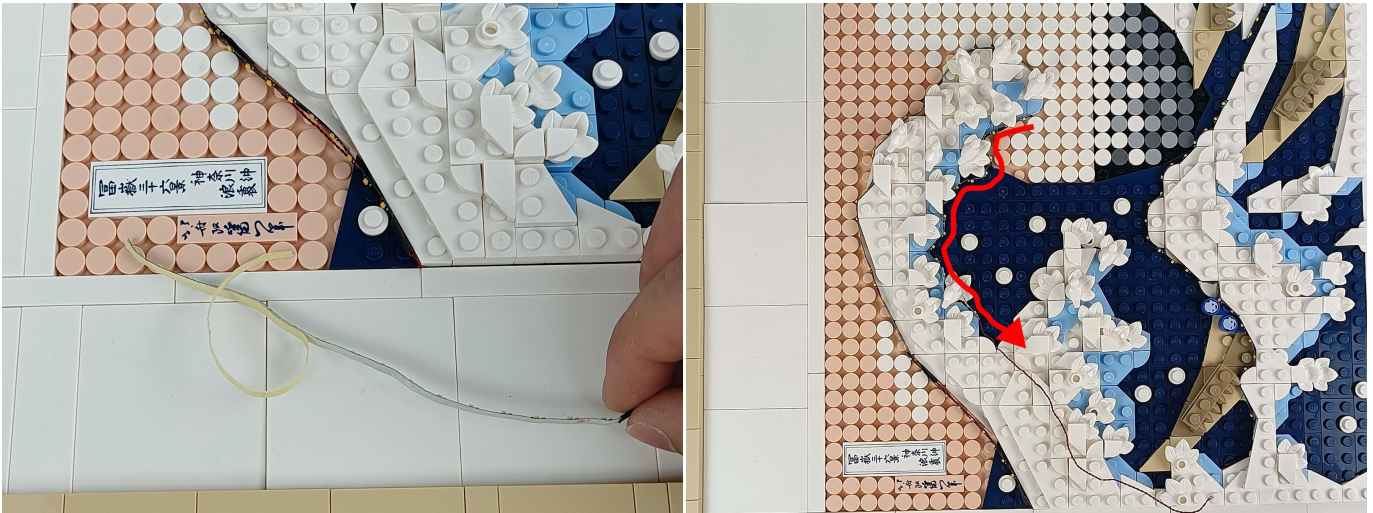

38. Remove the building blocks one by one, and then wire them as shown.



39. Remove the building blocks one by one and press down on the light wire.



40.Remove the building blocks one by one, thread the light wire to the bottom, and then restore the building blocks one by one.



41.The wiring to the back of the model is shown in the figure.

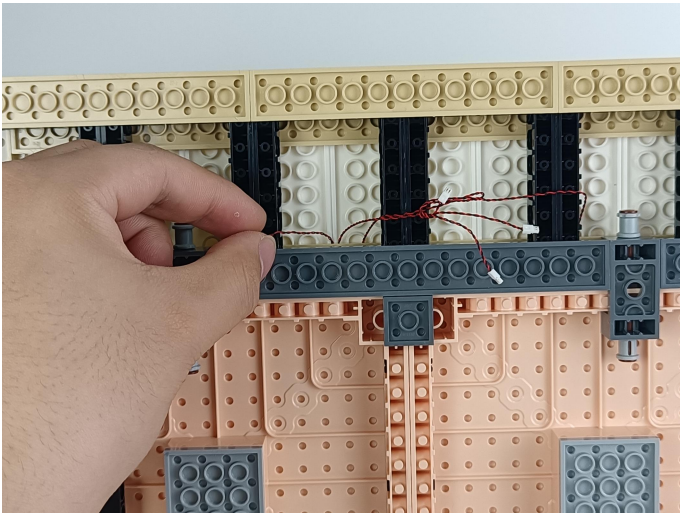

42.Look at the position in the picture.



43. Take one green light from bag 5.

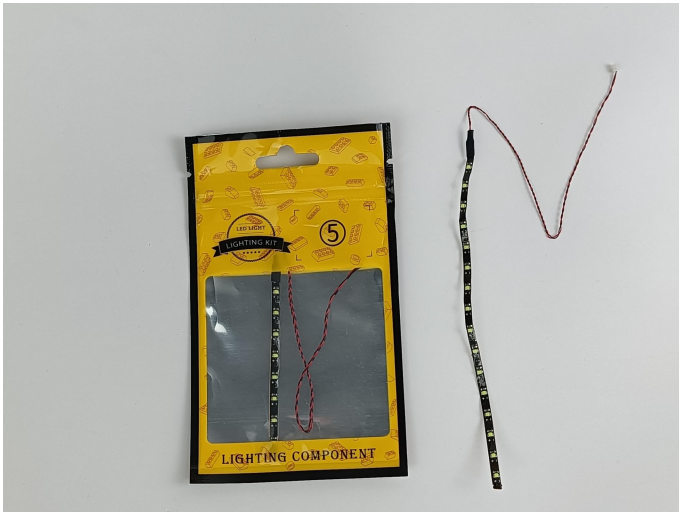

44. Peel off the backing paper from the light fixture and stick it to the building block.

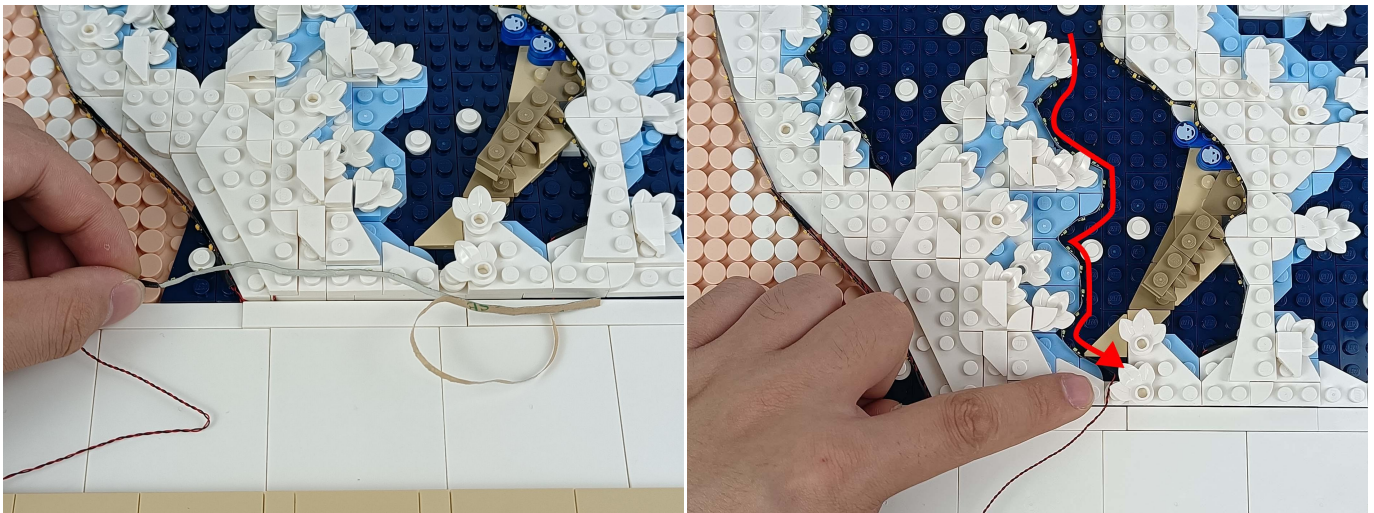

45. Remove the building blocks one by one and thread the light wire to the bottom.



46.The wiring to the back of the model is shown in the figure.

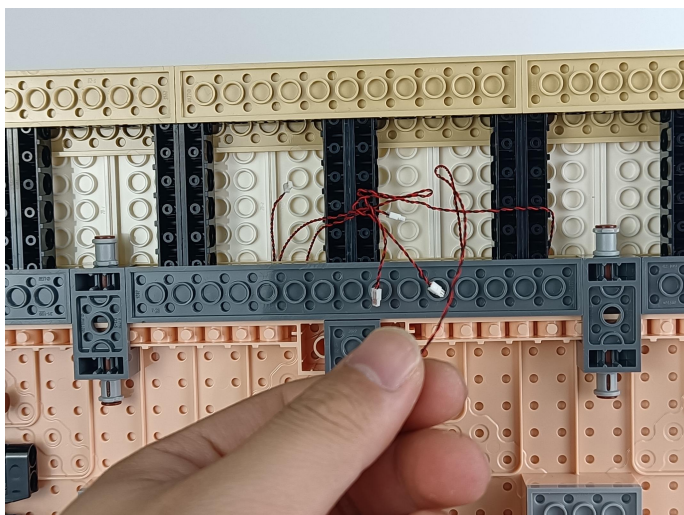

47.Look at the position in the picture.



48.Take one green light from bag 4.



49. Peel off the backing paper from the light fixture and stick it to the building block.

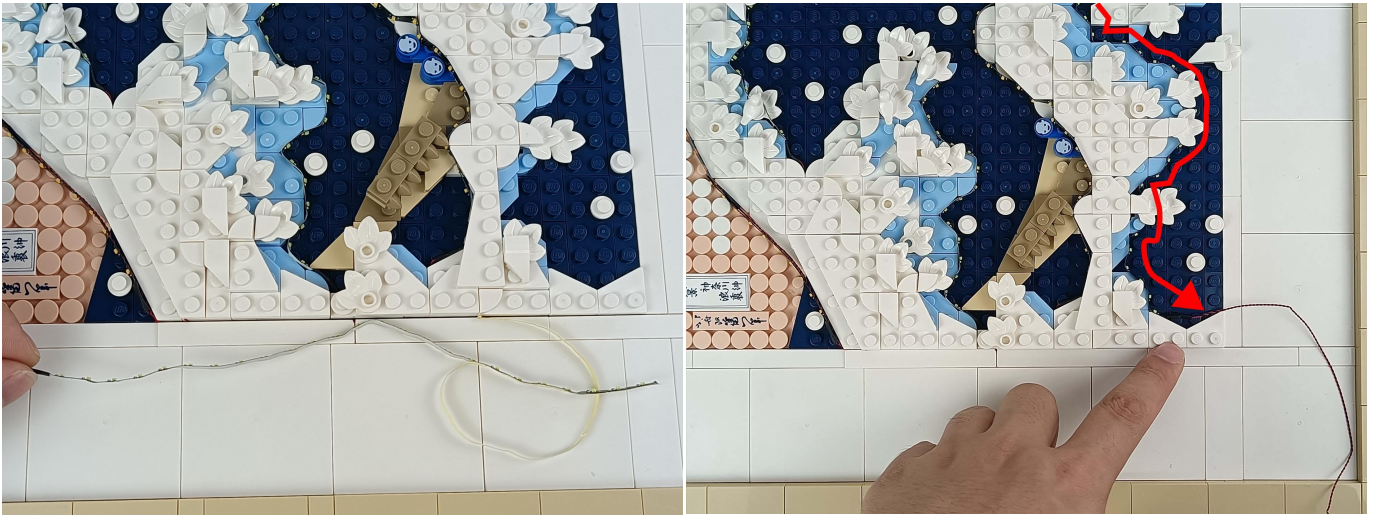

50. Remove the building blocks one by one, thread the light wire to the bottom, and then restore the building blocks one by one.



51. The wiring to the back of the model is shown in the figure.

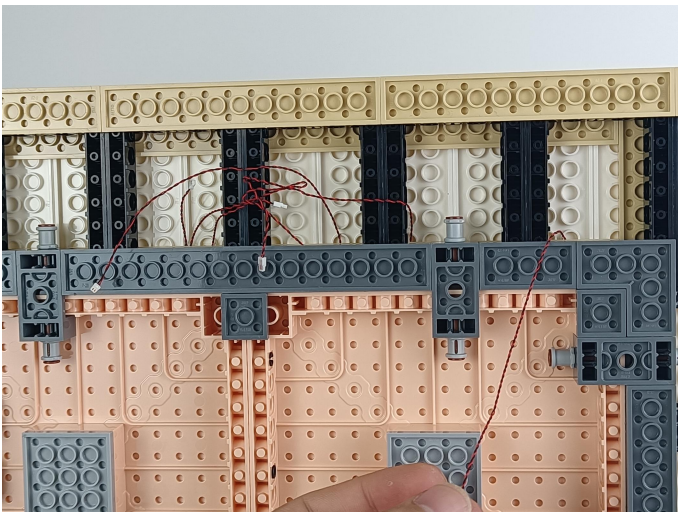

52.Look at the position in the picture.



53.Take one green light from bag 4.



54.Peel off the backing paper from the light fixture and stick it to the building block.

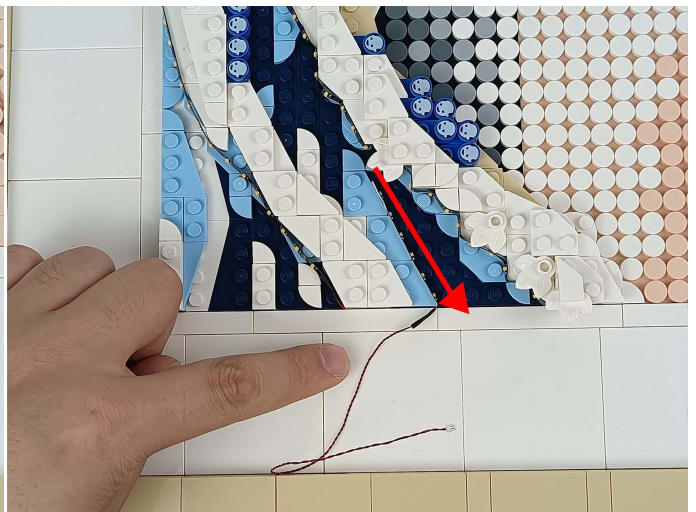
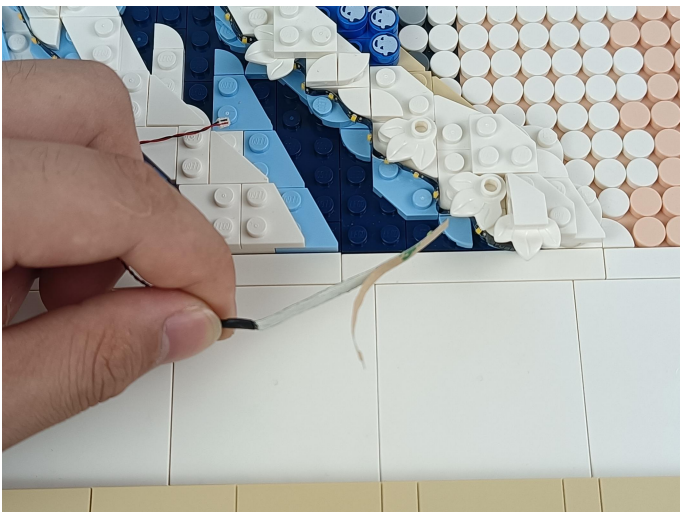

55.Remove the building blocks one by one, thread the light wire to the bottom, and then restore the building blocks one by one.

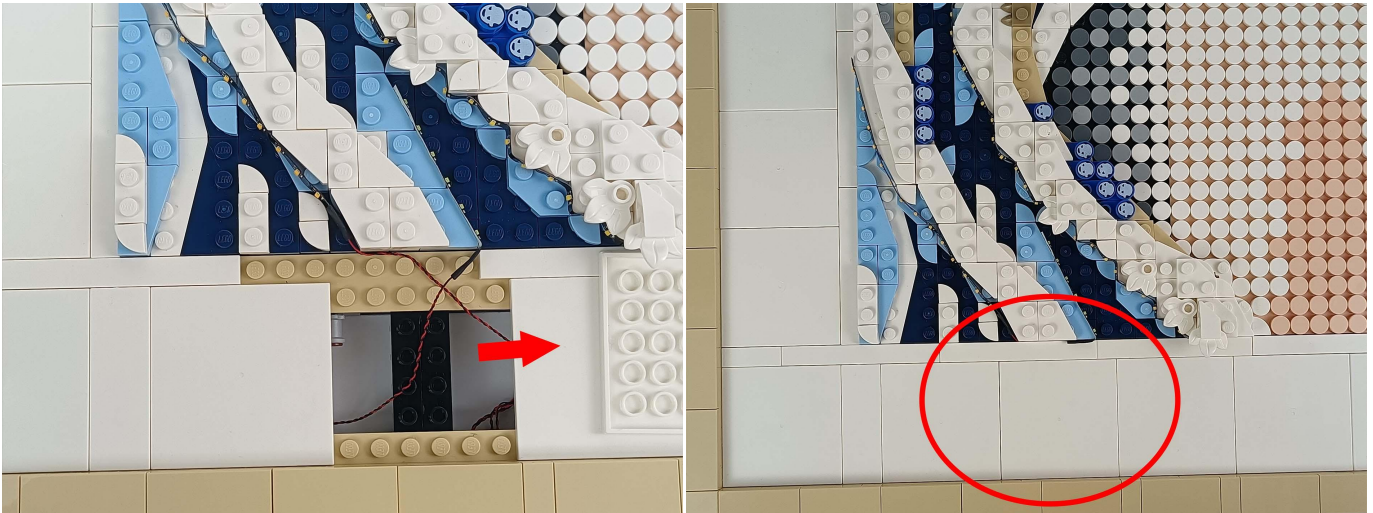

56.The wiring to the back of the model is shown in the figure.

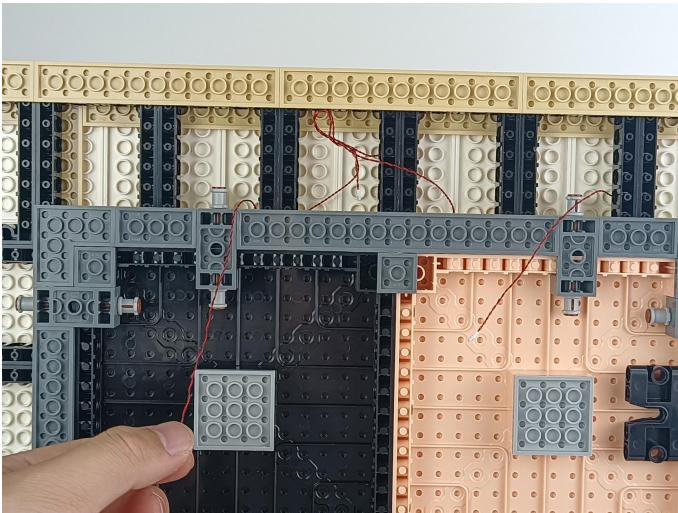

57.Look at the position in the picture.



58. Take one green light from bag 5 and tear off its back adhesive tape.

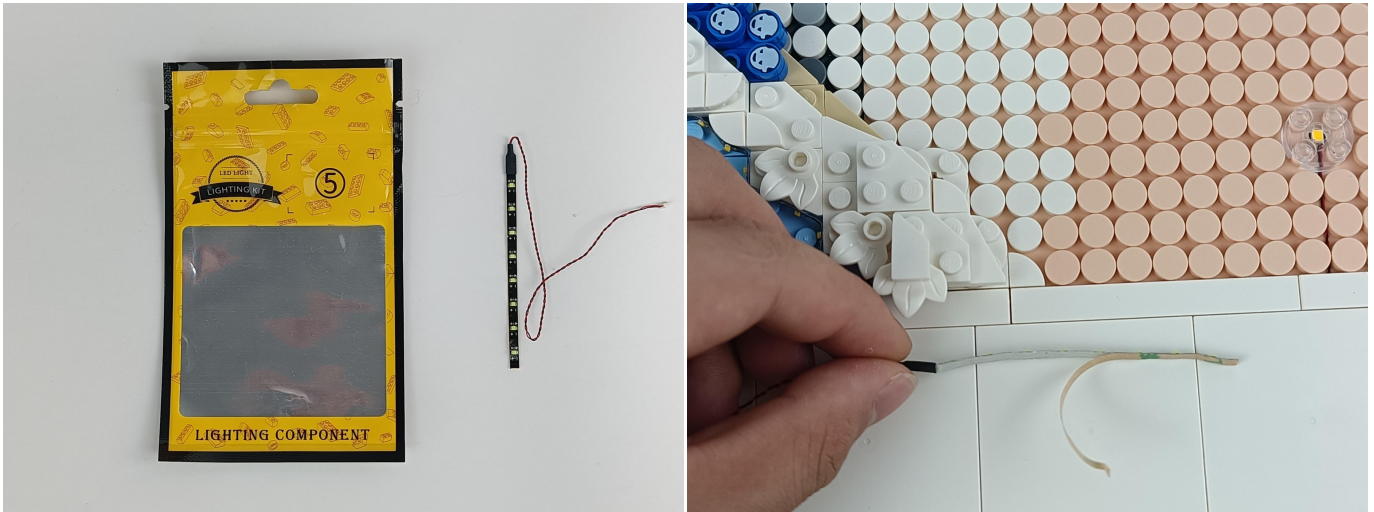

59. Attach the lights to the building blocks.



60. Remove the building blocks one by one, thread the light wire to the bottom, and then restore the building blocks one by one.



61. Flip to the back.

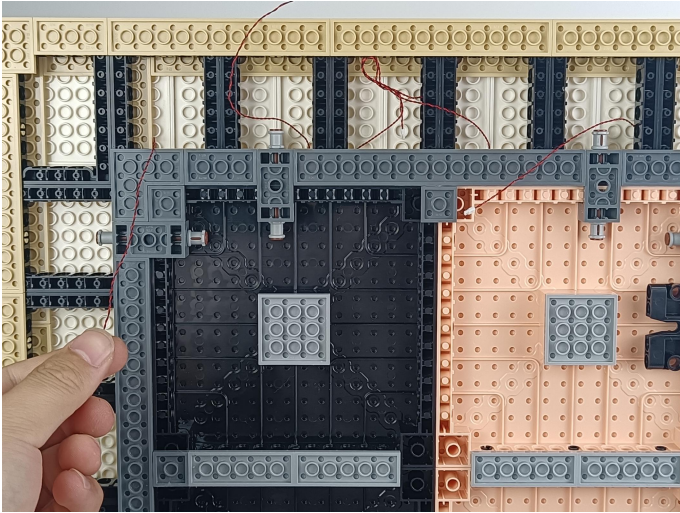

62. Find the light lines in the picture and twist them together.

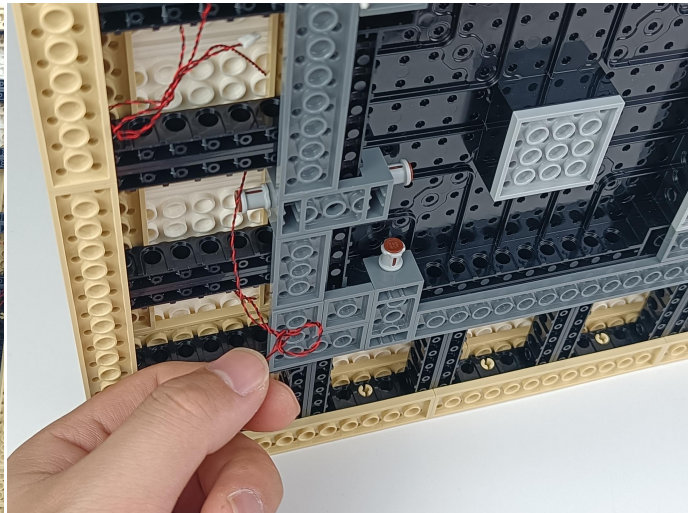
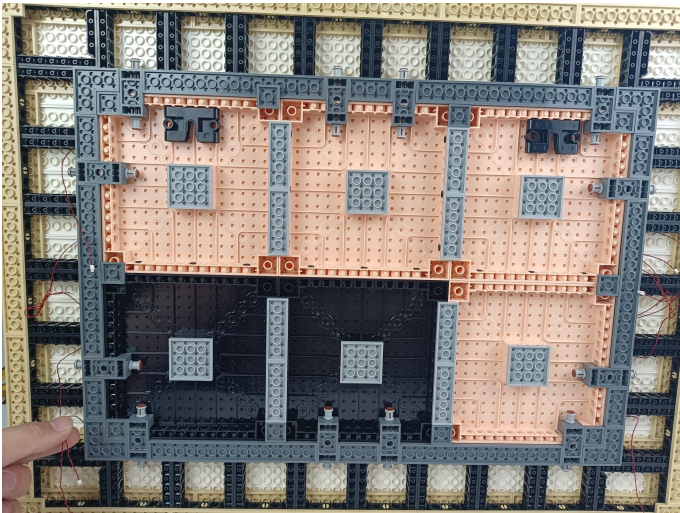

63. Find the light lines in the picture and twist them together.

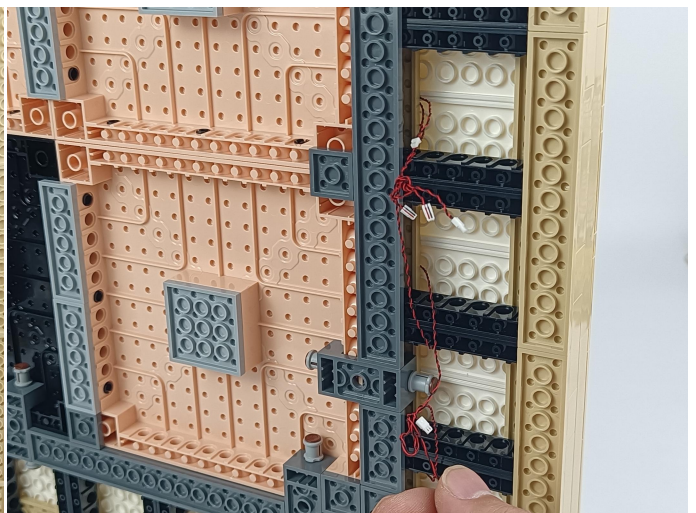
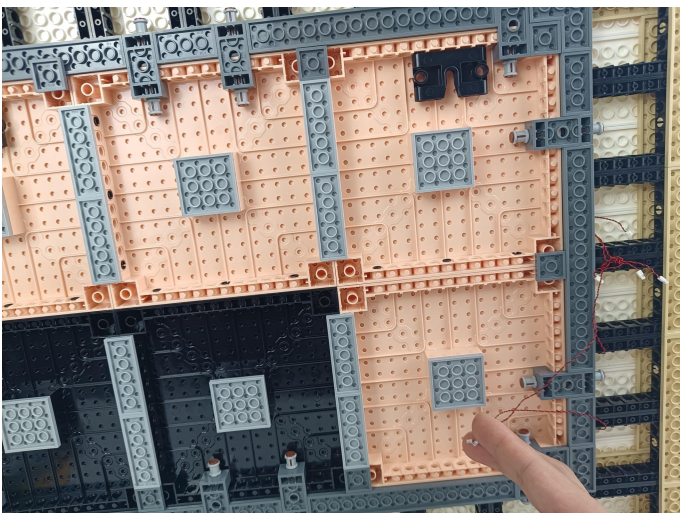

64.Find the location in the picture.

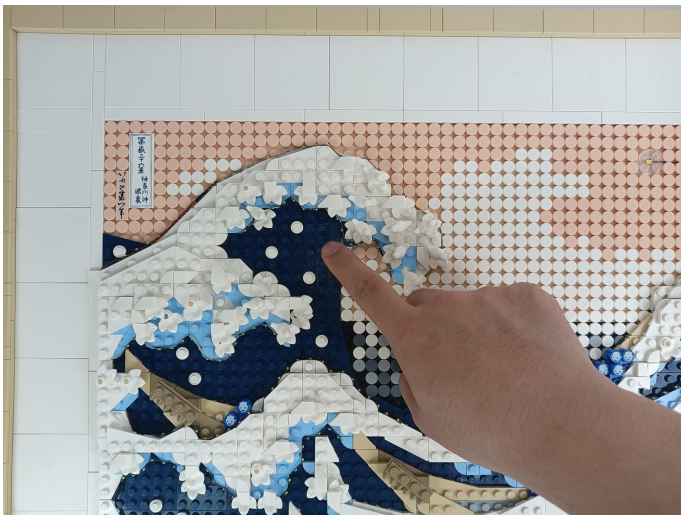
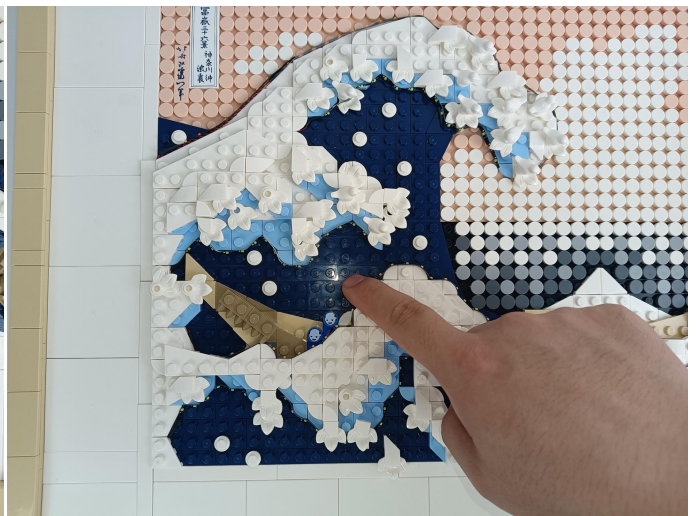
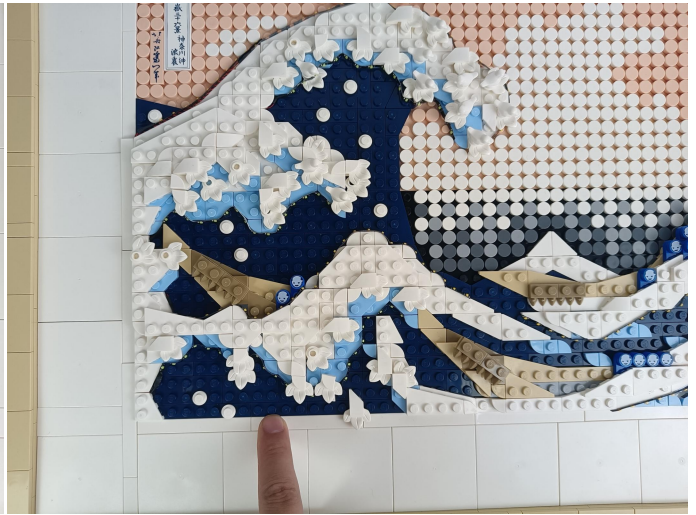

65.Take out 5 small 1*1 round plates from bag No.6. Deep blue transparent color (open).



TIPS

The slit on the the plate round 1X1 are hand-made to avoid squeeze the wire and cause short circuit and abnormal heat during installation.

The plate without slit

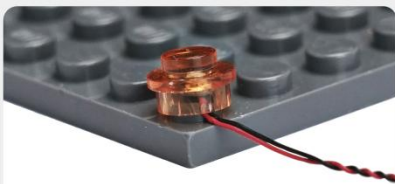

The squeeze causes the protective layer of the wire to be torn apart, the positive and negative wires touch together, and the set is short-circuited and the hot or wire is crushed, the wire to be disconnected and don't work.

The plate with slit

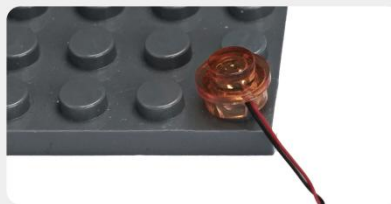

The wire has enough space to avoid being squeezed endowed with longer service life and more stable effect.

66.Fix the small round plate to the building block in turn.

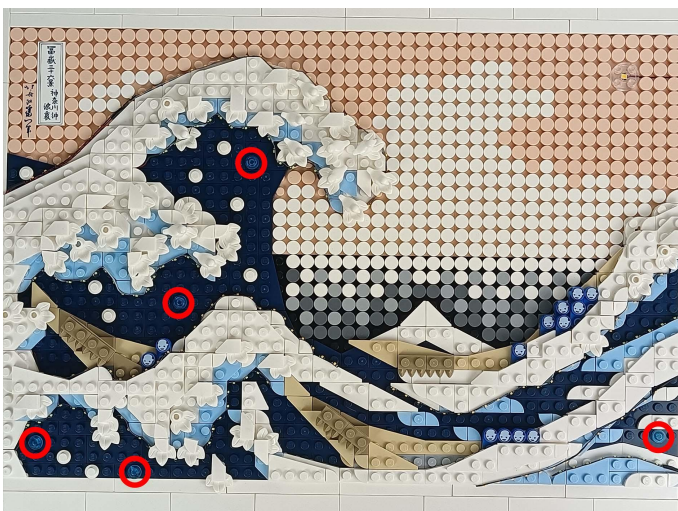

67. Take out two 15cm blue ordinary light bulbs from bag 6.



68. Look at the position in the picture, remove the small round plate, put the light facing out, and restore the small round plate. (Pay attention to the cut on the small round plate, and the light wire is stuck in the cut on the small round plate.)



69. Remove the building blocks one by one, thread the light wire to the bottom, and then restore the building blocks one by one.

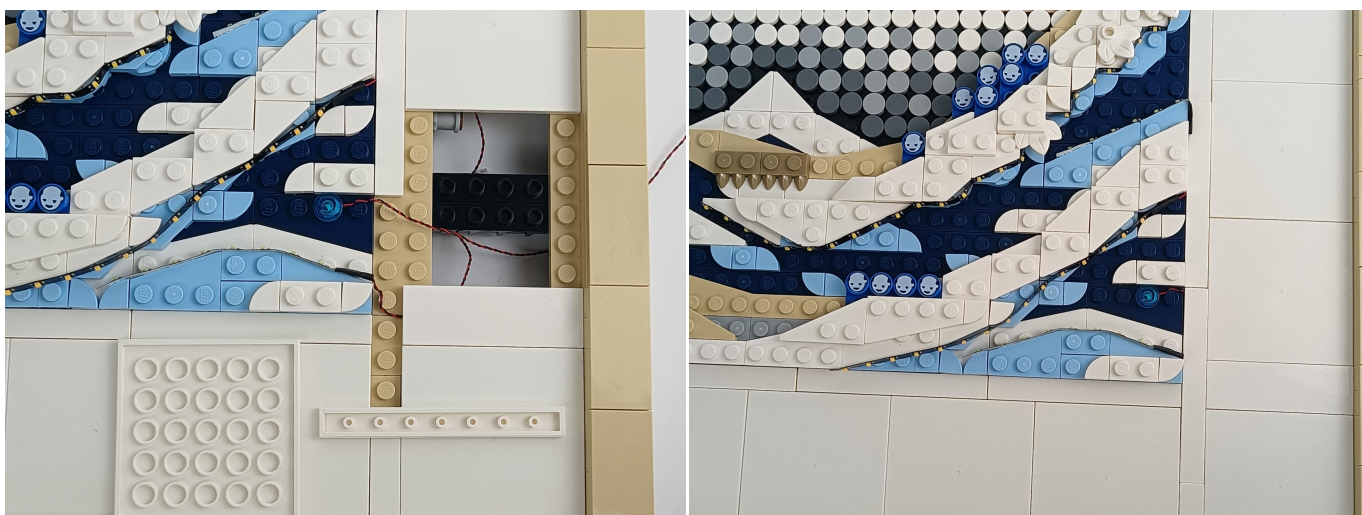

70. Install it in the same way at another place.

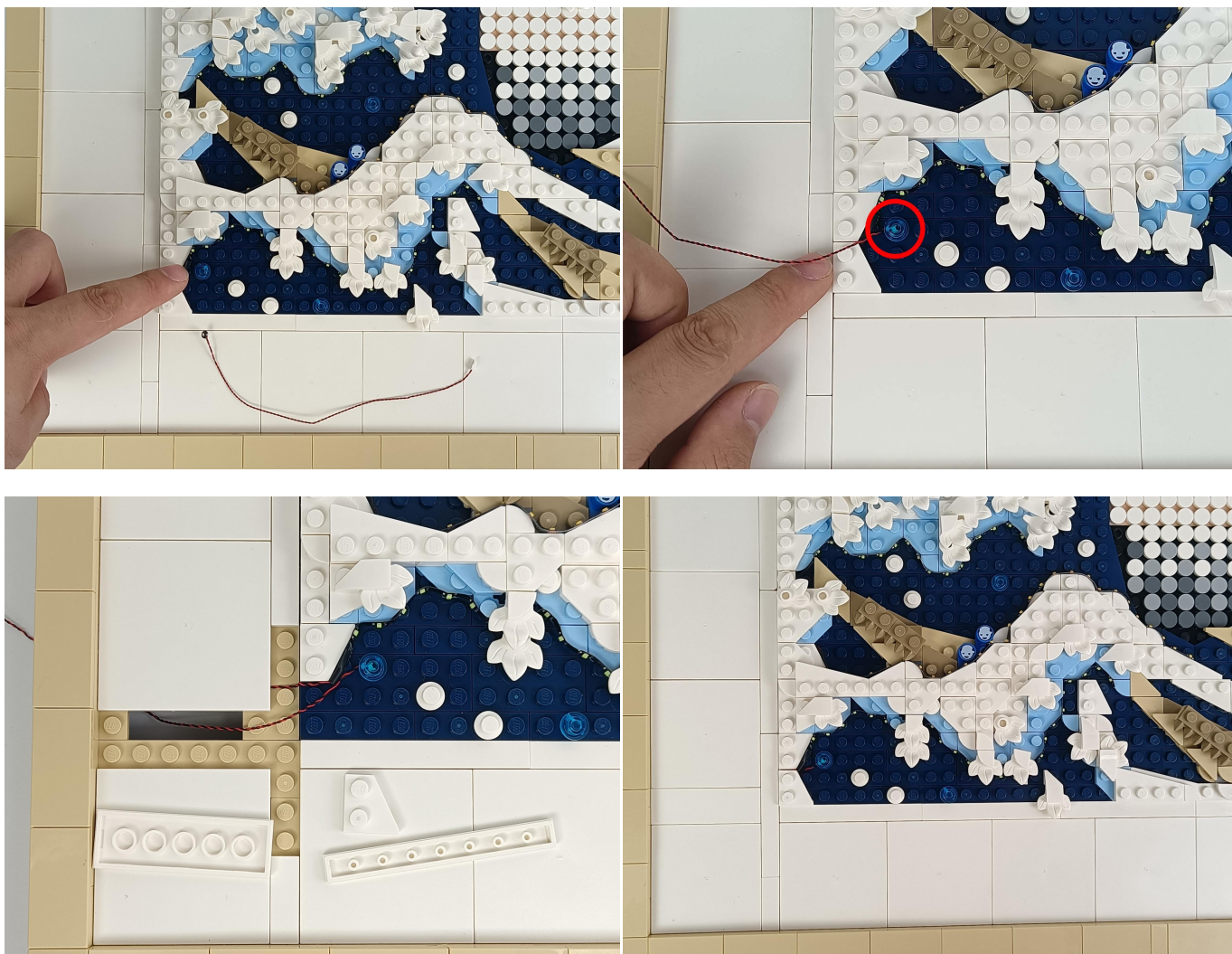

71. Remove the 30cm blue ordinary light bulb from bag 7.

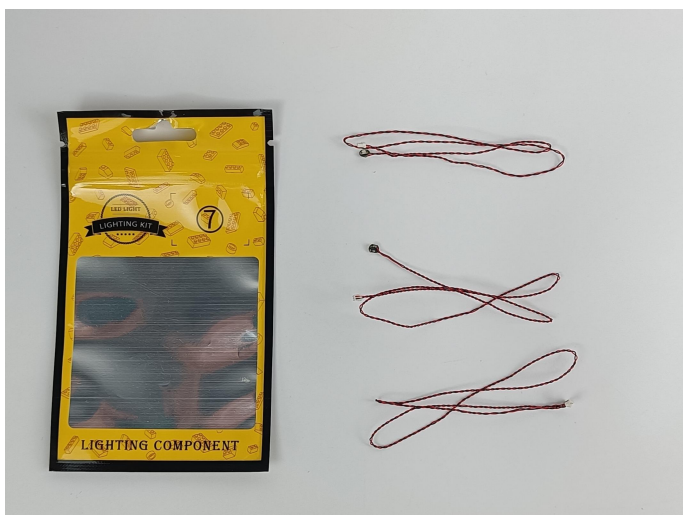

72.Look at the position in the picture, remove the small round plate, put the light facing out, and restore the small round plate. (Pay attention to the cut on the small round plate, where the light wire is stuck.)

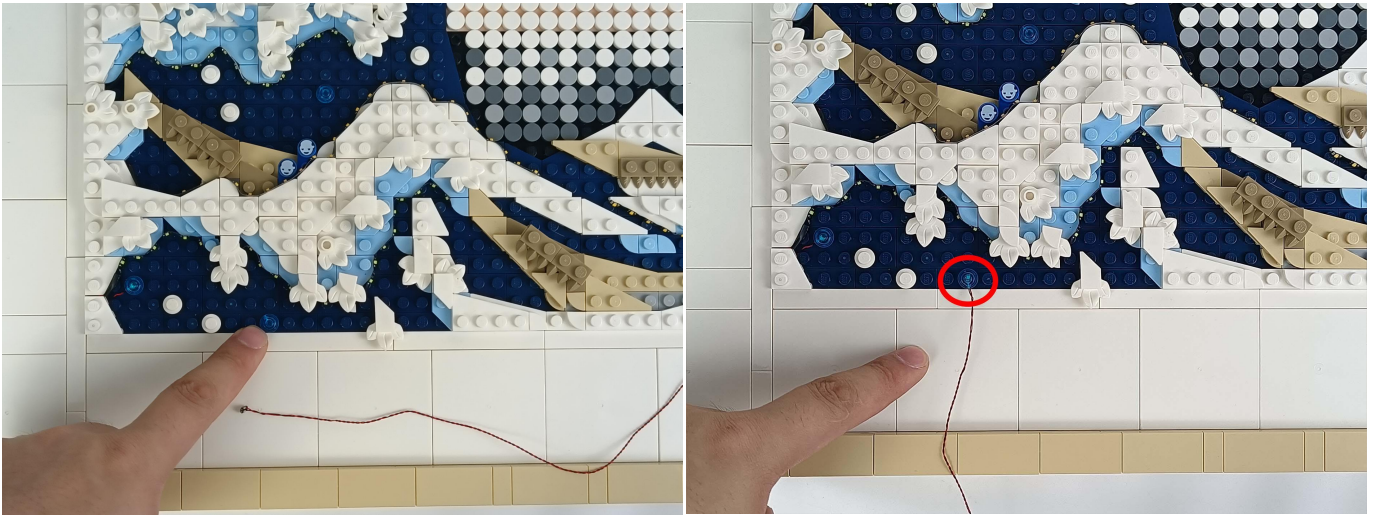

73.Remove the building blocks one by one, thread the light wire to the bottom, and then restore the building blocks one by one.



74. Install it in the same way at another place.

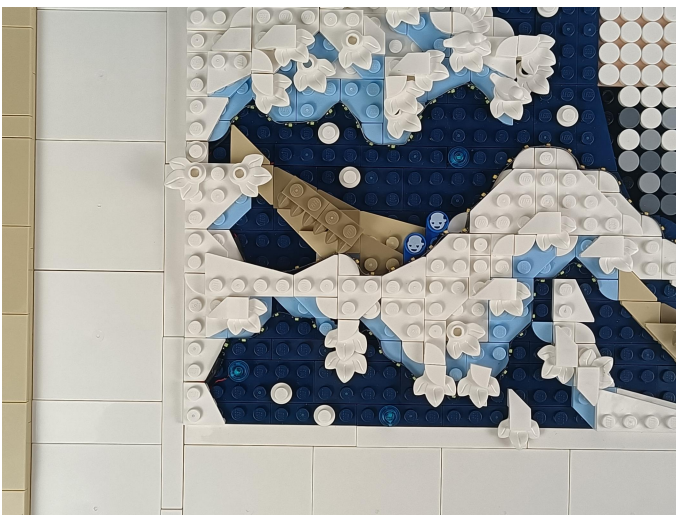
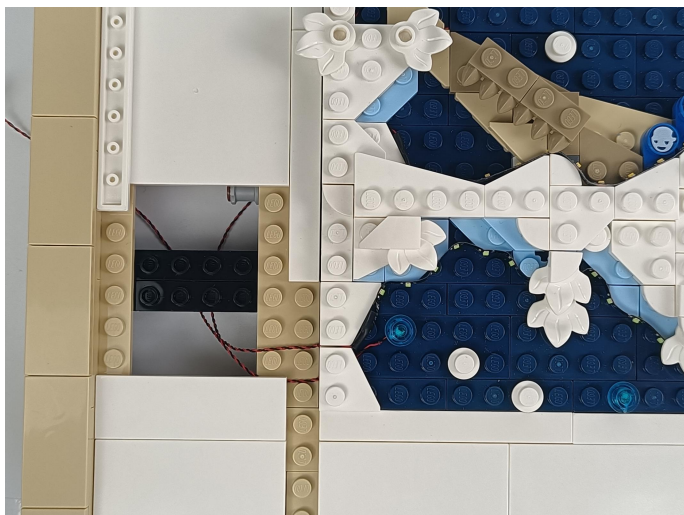
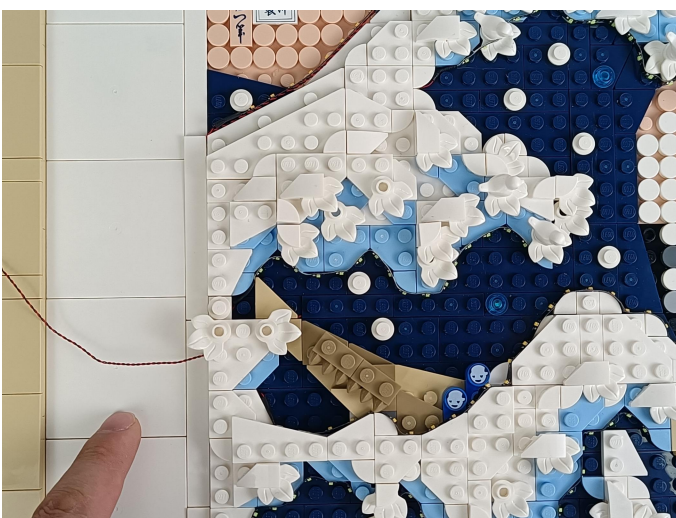
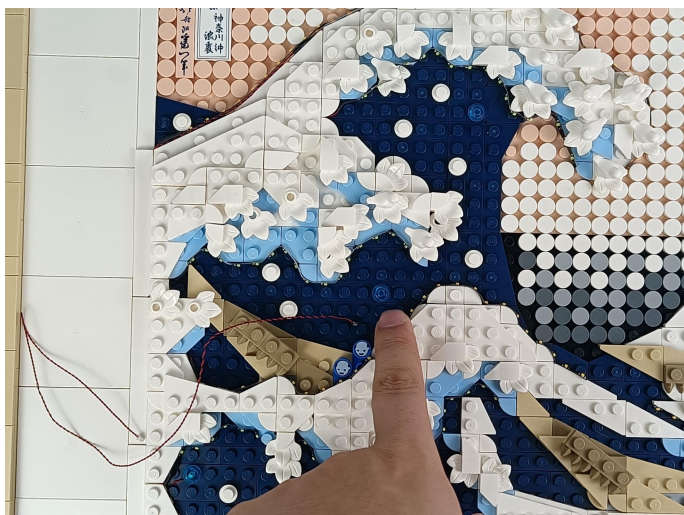

75. Install it in the same way at another place.

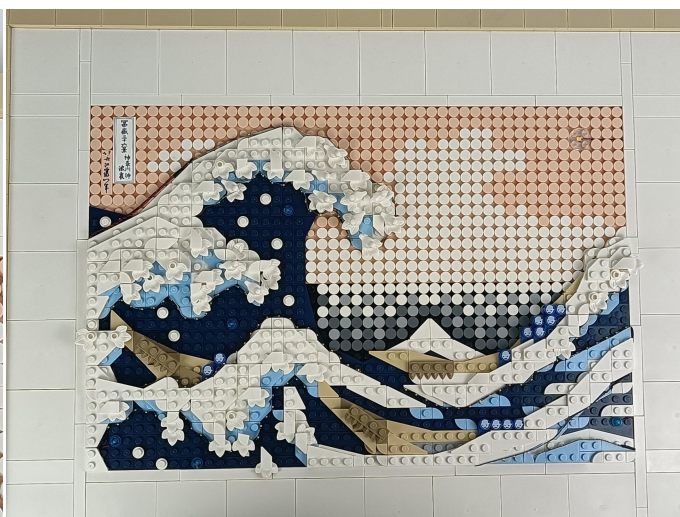
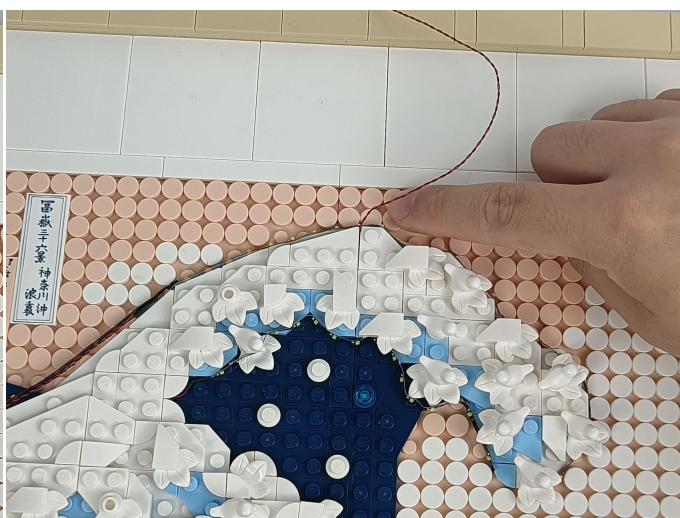
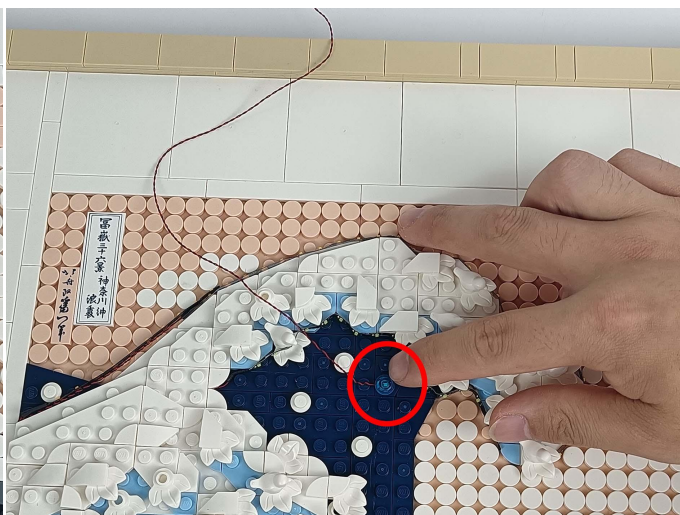

76. Flip to the back.

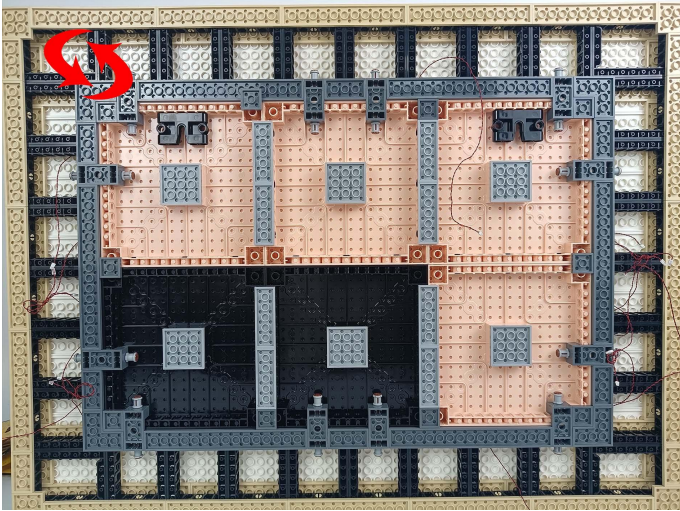

77. Take out one 4-seat expansion board from bag 8.



78. Find the lights in the picture and connect them to the expansion board.

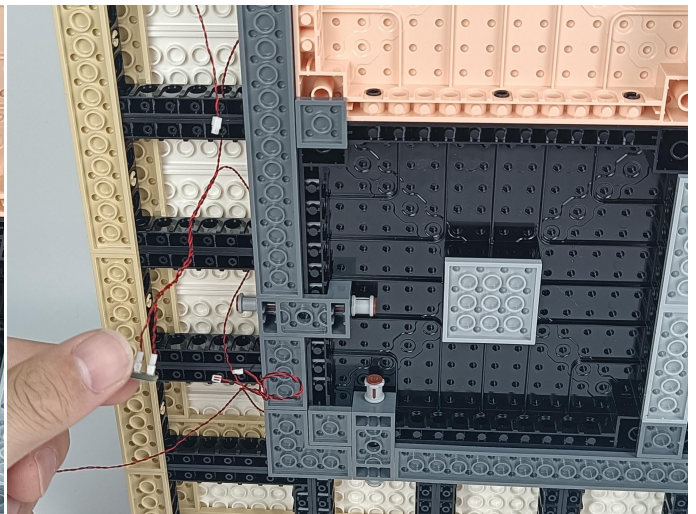
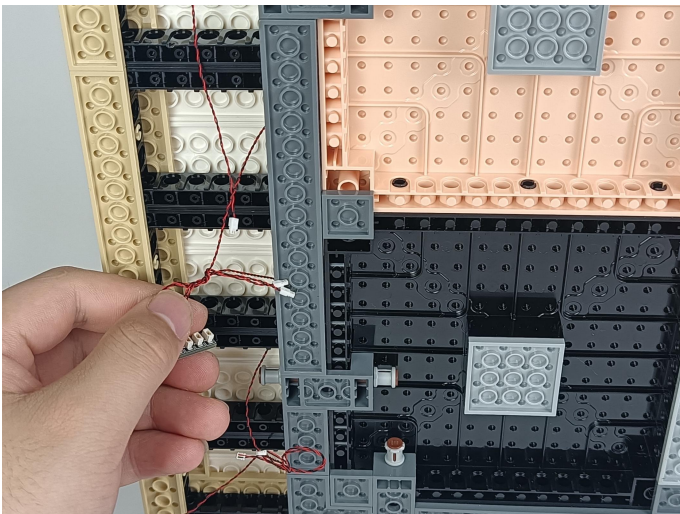

79. Take out one 4-seat expansion board from bag 8.



80. Find the light lines in the picture and connect them to the expansion board.

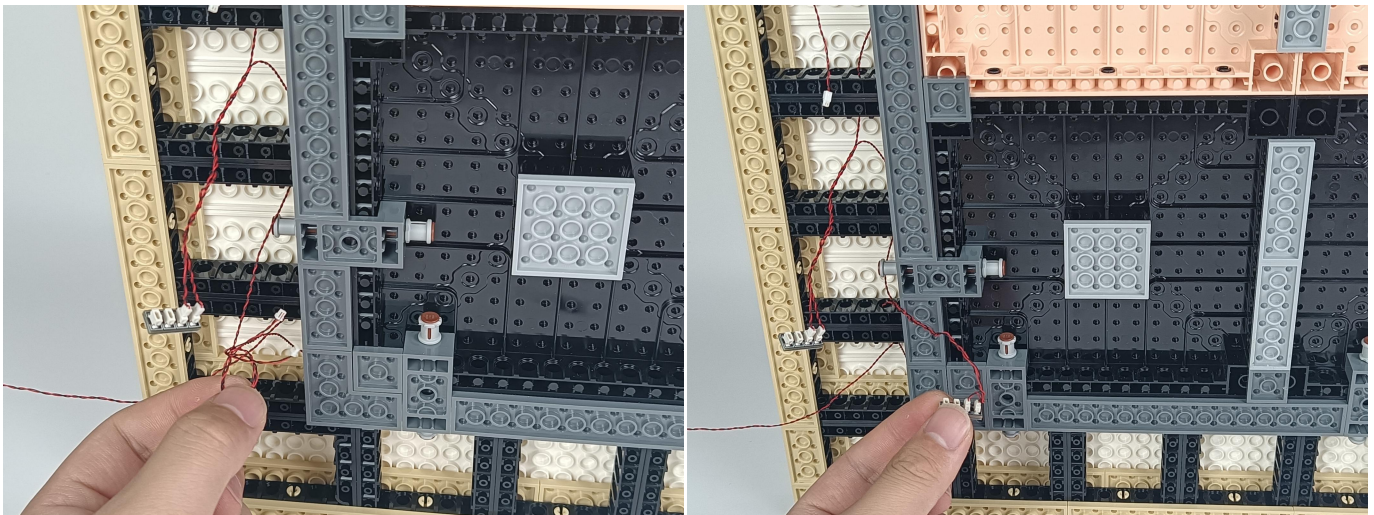

81. Take out one 4-seat expansion board from bag 8.



82.Find the light line in the picture.

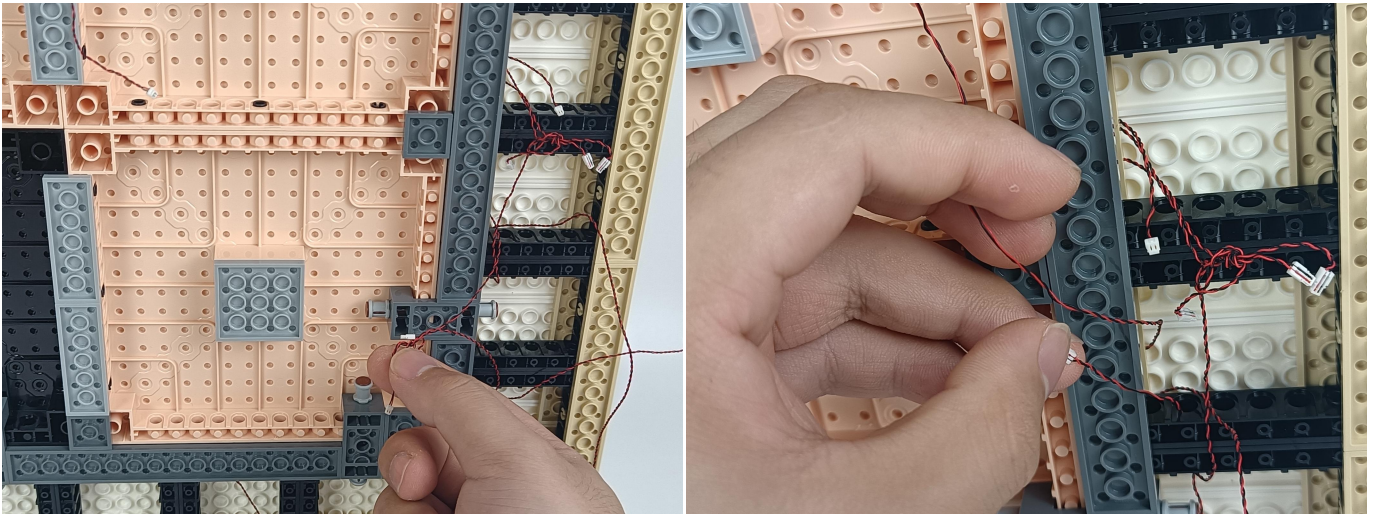

83.Connect the lamp wire to the expansion board.

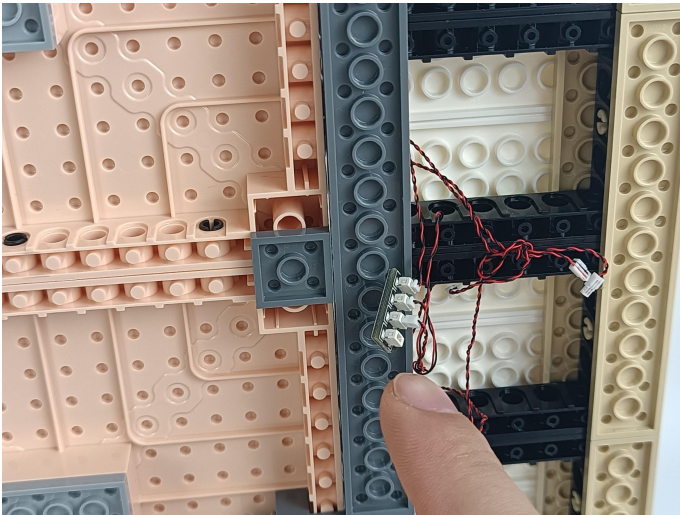

84.Take out one 4-seat expansion board from bag 8.



85.Find the light lines in the picture and connect them to the expansion board.

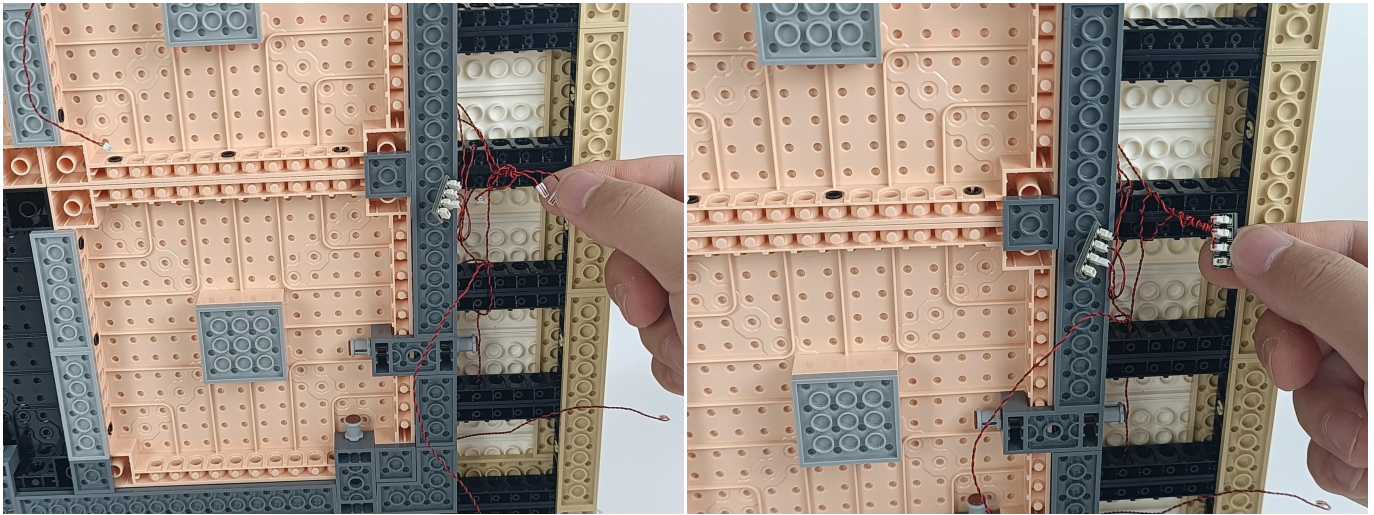

86.Find the light line in the picture and put it through the hole in the block.

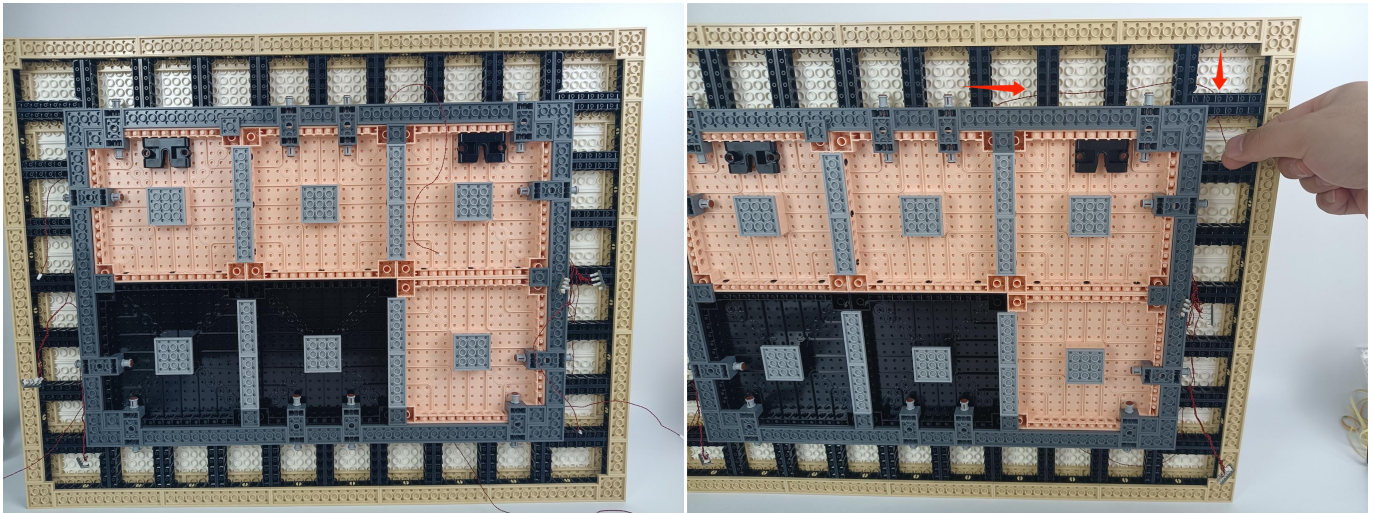

87.Take out one 2-seat expansion board from bag 8 and one 15cm connecting line from bag 11.



88. Connect the lamp wires and connecting wires in the picture to the expansion board.

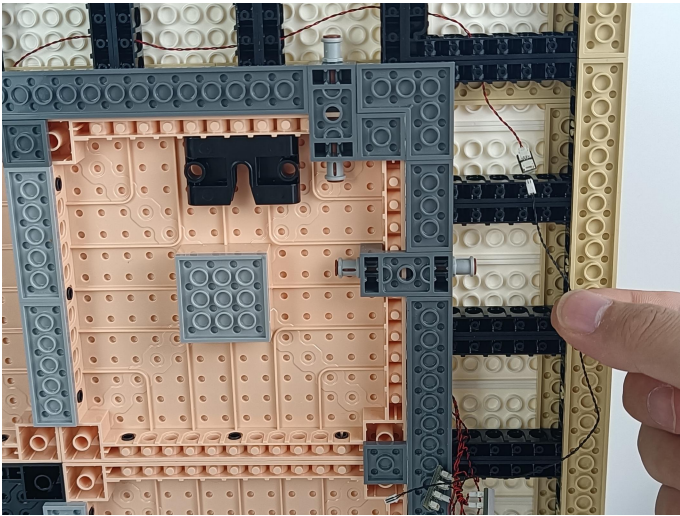

89. Take out one 6-seat expansion board from bag 8.



90. Connect the light line in the picture to the expansion board.

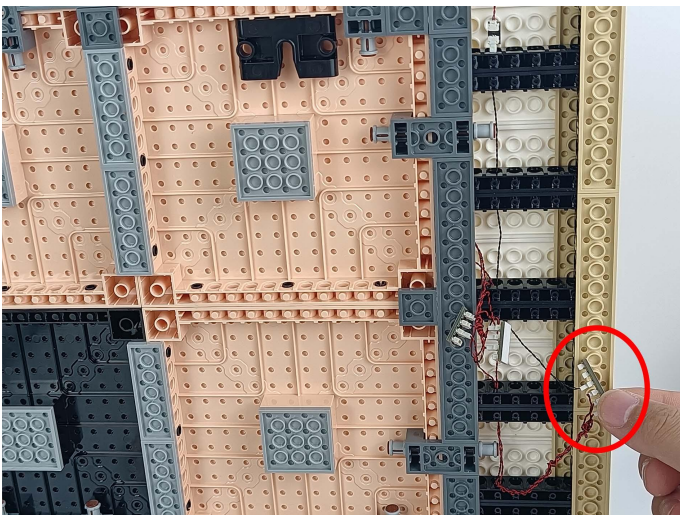

91. Take one 50cm connecting wire from bag 10 and connect it to the expansion board.

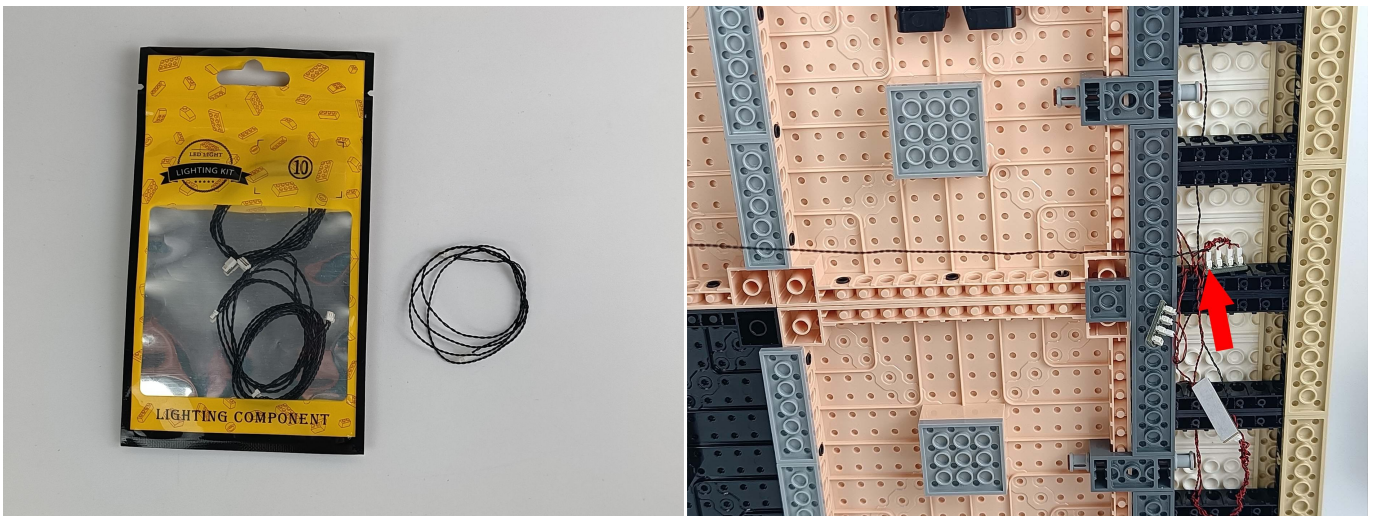

92. Pull the wire to the left and connect it to the expansion board.

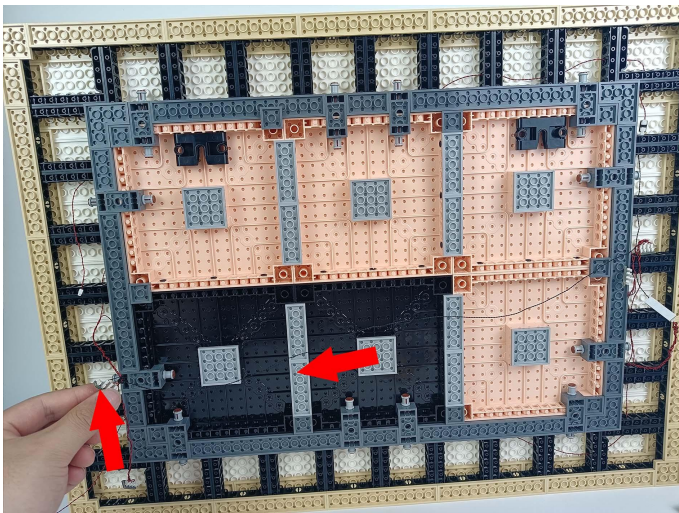

93. Take one 50cm connecting wire from bag 10 and connect it to the expansion board.

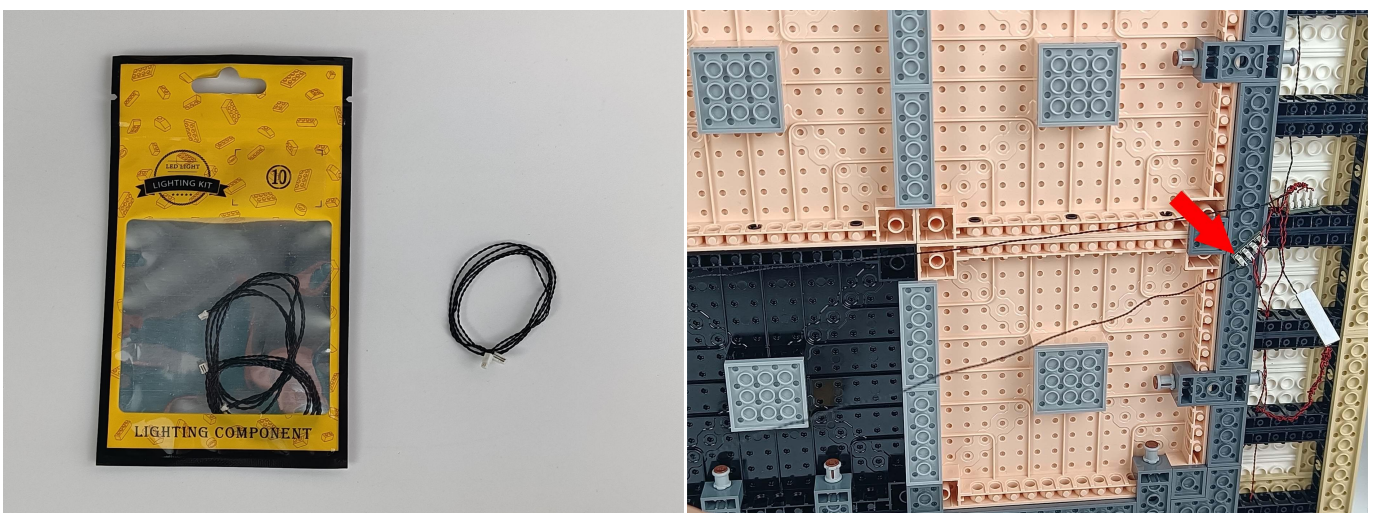

94.Pull the wire to the left and connect it to the expansion board.

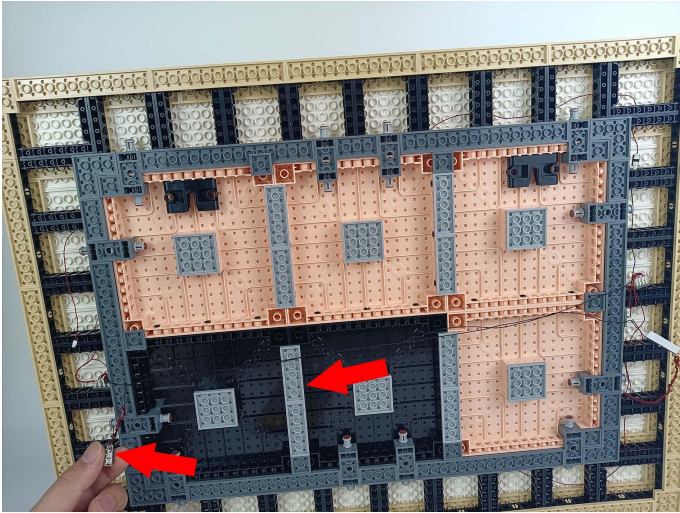

95.Peel off the backing paper on the expansion board and stick it to the building block.

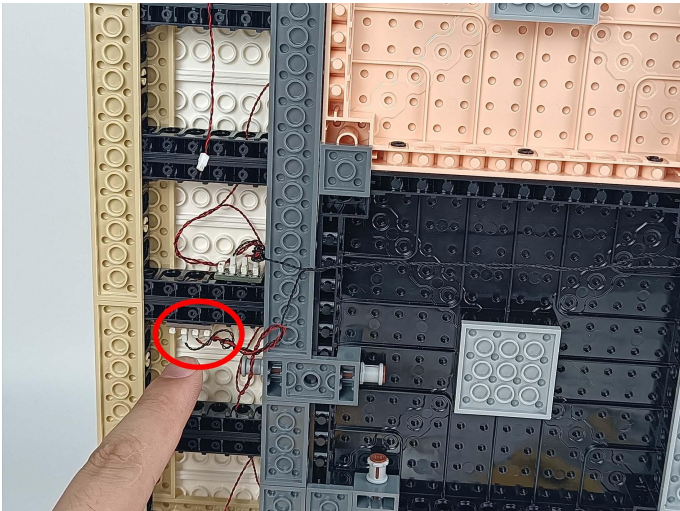

96.Take one 50cm connecting wire from bag 10 and connect it to the expansion board.

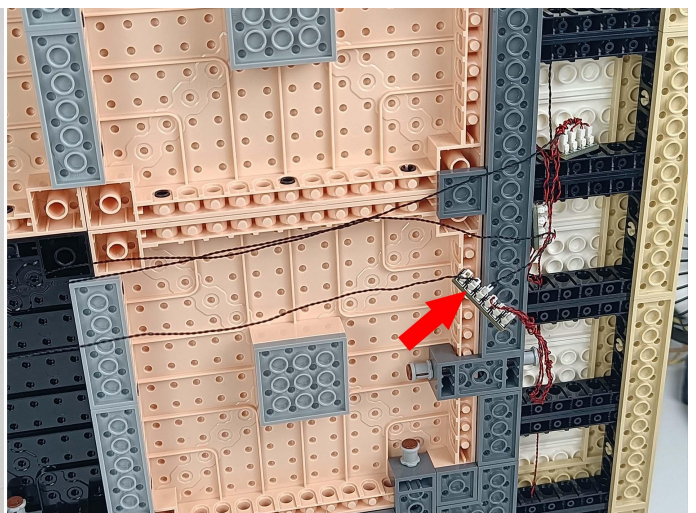

97. Peel off the backing paper on the expansion board and stick it to the building block.

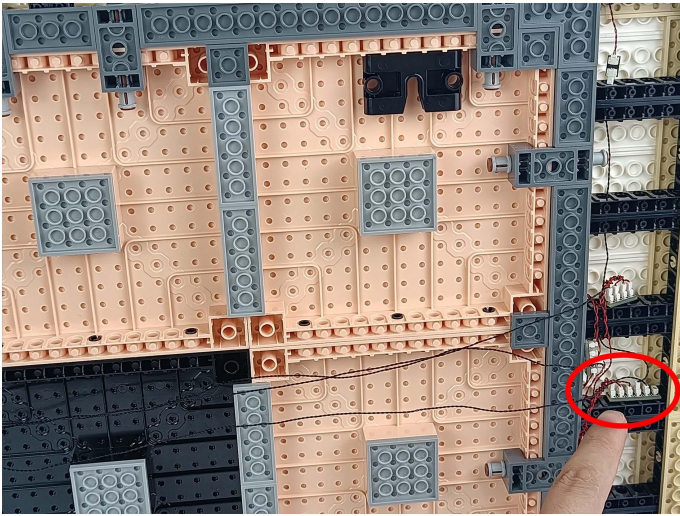

98. Take out one 4-seat expansion board from bag 8.



99. Find the light lines in the picture and connect them to the expansion board.

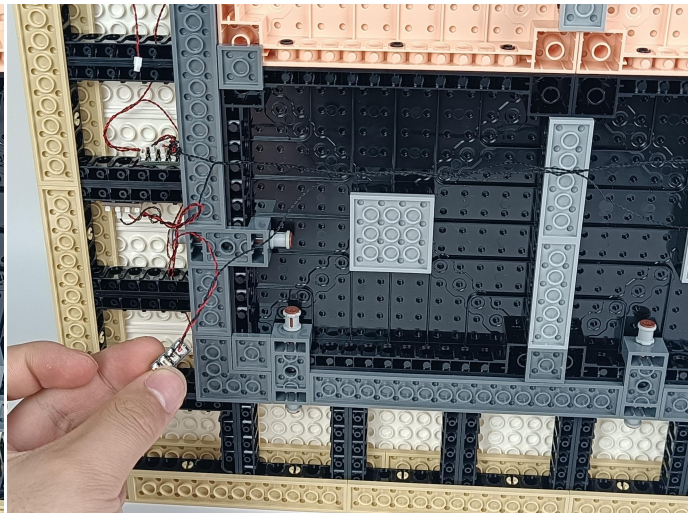
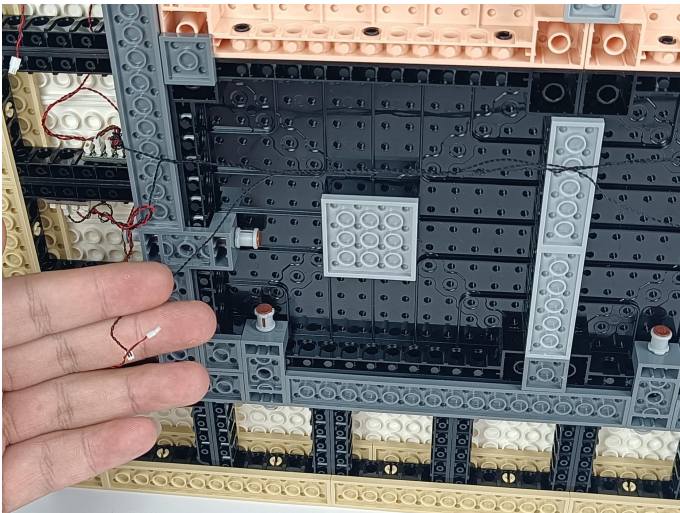

100. Peel off the backing paper on the expansion board and stick it to the building block.

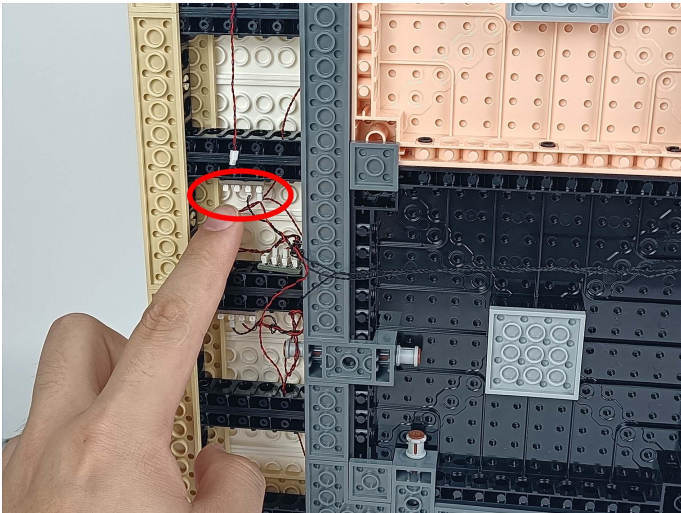

101. Remove the remote control module from the bag.



Remote Control Function Introduce

ON: All lights turn on sequentially.

OFF: All lights are off.

 : A, B, C, D are turned on slowly in sequence.

 : Breathing light mode.

 : A and D the light is on and C and B flash alternately.

 : A the light is on, B, C, D flow light effect I.

 : A the light is on, B, C, D flow light effect II.

 : Quickly open from A to D in turn.

 : A, B, C, D flow light effect.

 : A, B, C, D flash alternately.



A: Turn A on/off.

B: Turn B on/off.

C: Turn C on/off.

D: Turn D on/off.

↑: Increase frequency.

↓: Decrease frequency.

+: Brightness+: Increases brightness

***-: Brightness-:** Increases brightness



Remote Control Battery

The remote control does not contain batteries, please buy a CR2025 or CR2032 button battery in the nearest store and install it in the remote control.



102. Connect the light line in the picture to port A of the remote control module.

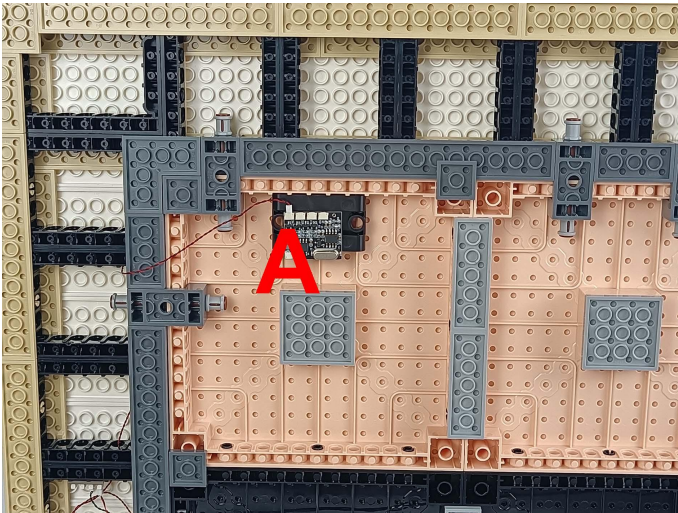

103. Take the two 20cm connecting wires from bag 9 and connect them to the expansion board.

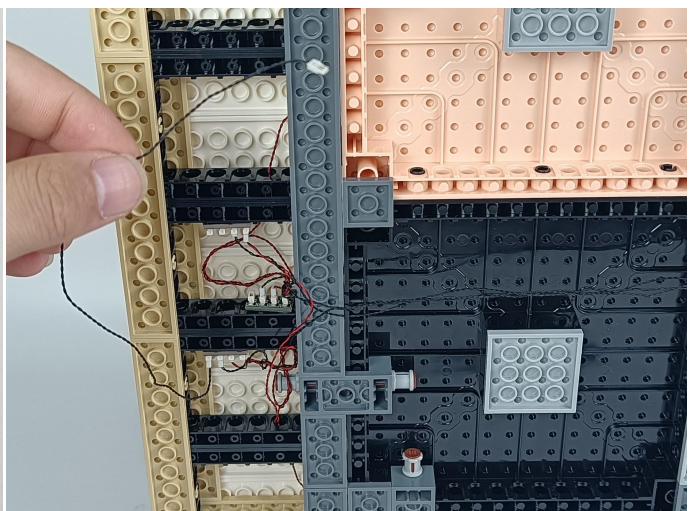

104. Connect the cable to the C port of the remote control module.

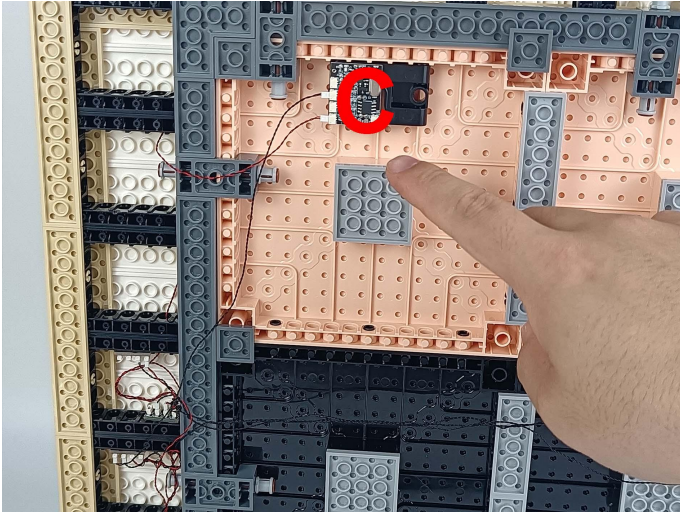

105. Connect the cable to the expansion board.

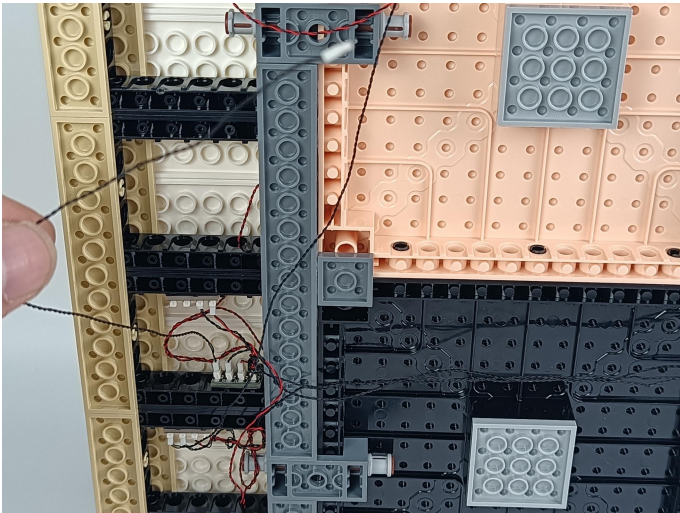

106. Connect the cable to port B of the remote control module.

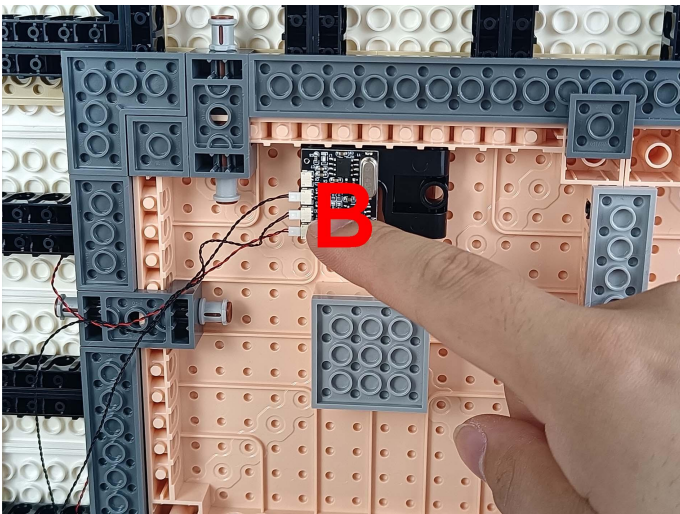

107. Take one 15cm cable from bag 11 and connect it to the expansion board.

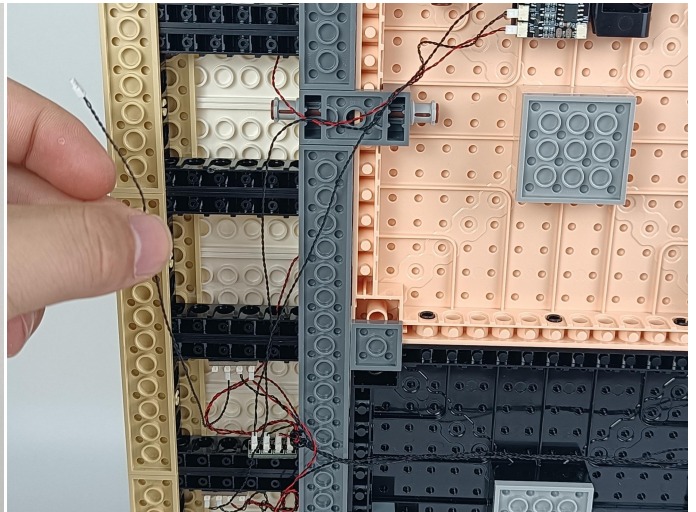

108. Connect the cable to the D port of the remote control module.

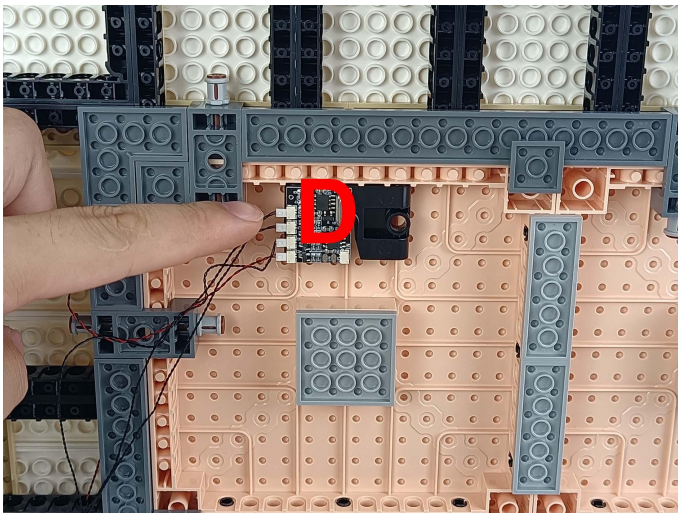

109. Take one 50cm connecting wire from bag 10 and connect it to the remote control module.

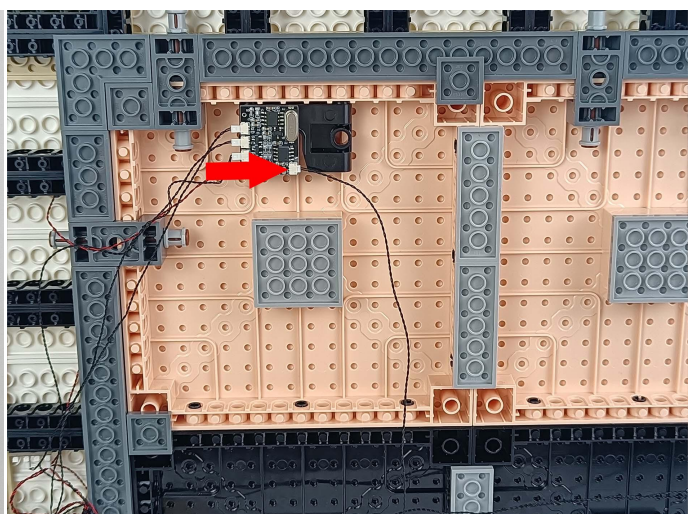

120. Take out one 2-seat expansion board from bag No.8 and connect the connecting line in the picture to the expansion board.

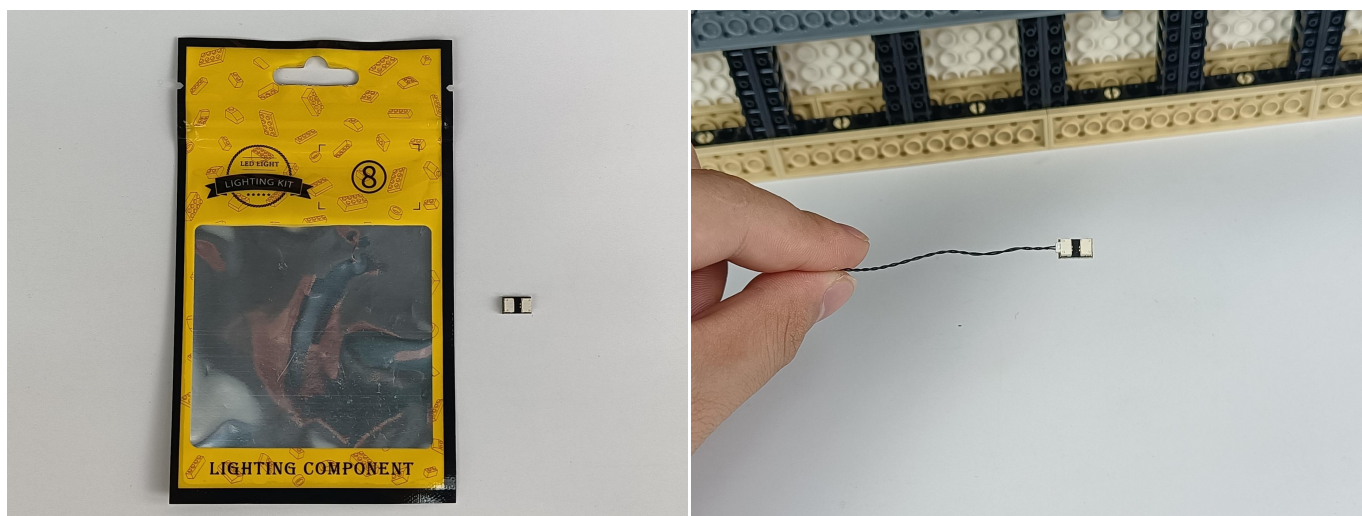

121. Remove the USB power cable from the bag and connect it to the expansion board.

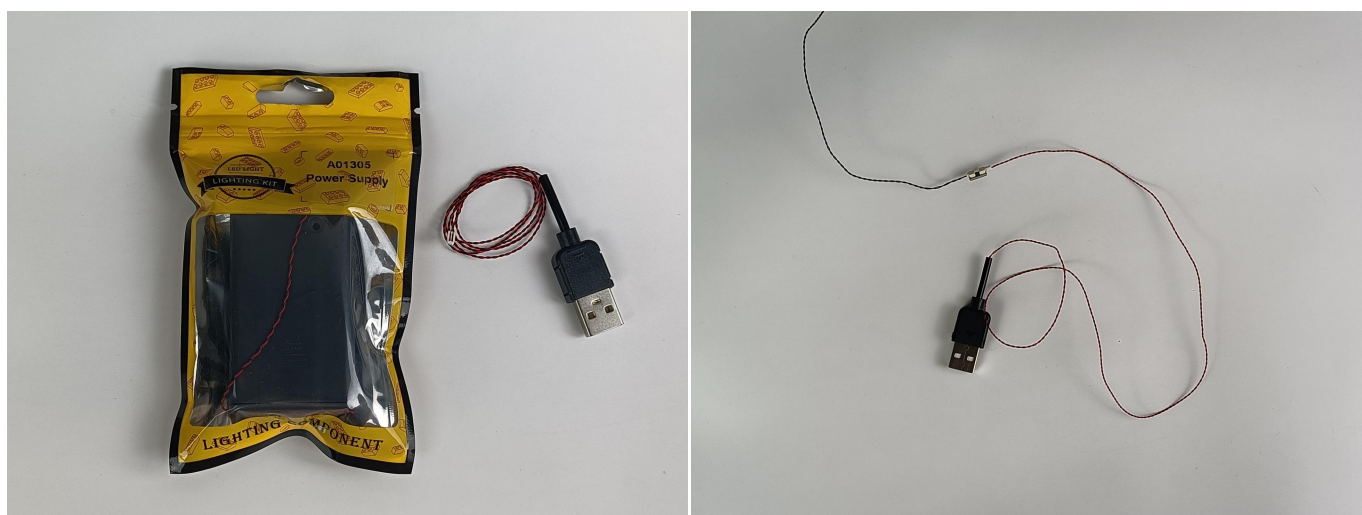

122. Take the remote control out of the bag and put in the battery to use normally.



123.Plug in the power.



124.Install as shown.



Good job, you've done all the installation steps, power it up and enjoy your work.



The battery box can also power the set. If it is necessary to change the power supply , prepare three AAA batteries, install them in the battery box, turn on the switch on the battery box, remove the plug of the USB Power Cable from the socket of the expansion board,plug the plug of the battery box to the same socket in the expansion board to power the suit as well.

THANKS