

BRICK BLING

INSTALLATION INSTRUCTIONS

76294 X-Men: The X-Mansion

- Installation requires a lot of patience and great observation that your LEGO bricks will come alive when you get this finished. The bricks with lighting as below, so make sure you're ready and let's get started.



Strategies for the Installation

This instruction divides three sections to complete the installation of the lighting set.

Section A: Check the type and quantity of components.

The quantity and type of components of each products are different and it needs to be carefully checked to make sure there do have enough material. The type of components is indicated by the label on the bag.

Section B: Test that each components is working properly.

Each components is made individually so it is necessary to test that each components is working properly to avoid the situation that the lighting does not work .

Section C: laying out components following the instruction.

Our material is very small but not fragile, just be reminded that don't to pull the wires too hard. For different people, there may be some installation steps that you can't understand. Please look at the previous and later installation step.

Section A: Check the type and quantity of components.

There are 17 bags in this set. The name and quantities of specific components are as shown , please check carefully.

Label	Content	Quantity
A01007 Light-30CM Yellow	Light-30CM Yellow	1
A01024 High-Brightness light 15CM-Warm White	High-Brightness light 15CM-Warm White	5
A01026 Light-30CM Cyan	Light-30CM Cyan	1
A01101 LED Strip Red	LED Strip Red	1
A01105 LED Strip Warm White	LED Strip Warm White	7
A012 Expansion Board	2 Socket Expansion Board	2
	6 Socket Expansion Board	2
	4 Socket Expansion Board	2
A01305 Power Supply	Power Supply	1
A01501 Connecting Cable 5CM	Connecting Cable 5CM	1
A01502 Connecting Cable 15CM	Connecting Cable 15CM	8
A01503 Connecting Cable 30CM	Connecting Cable 30CM	3
A01504 Connecting Cable 50CM	Connecting Cable 50CM	1
A01506 Connecting Cable 20CM	Connecting Cable 20CM	1
A02201 Lamppost-Black	Lamppost-Black	1
A02516 Light Strip-Warm White	Light Strip-Warm White	2
A02526 Light Strip-Warm White	Light Strip-Warm White	2
A03801 Remote Control	Remote Control	1
Components		

Please contact us immediately if there have any missing components.

Section B: Test that each components is working properly.

We need a structure to test all lights, so take out the bag with label “USB Power Cord”and “Expansion Boards”as follows.



BRICK BLING

It is worth reminding that our products are all customized. They have a unique way of connecting. The white plug on wire and the socket of the expansion board need to be connected together to transmit power.

Note that on one side of the white plug you can see two very small golden wires that should be connected to the two golden needles in socket of the expansion board. shown as blow.

Side-Mounted Expansion Board

BRICK
BLING

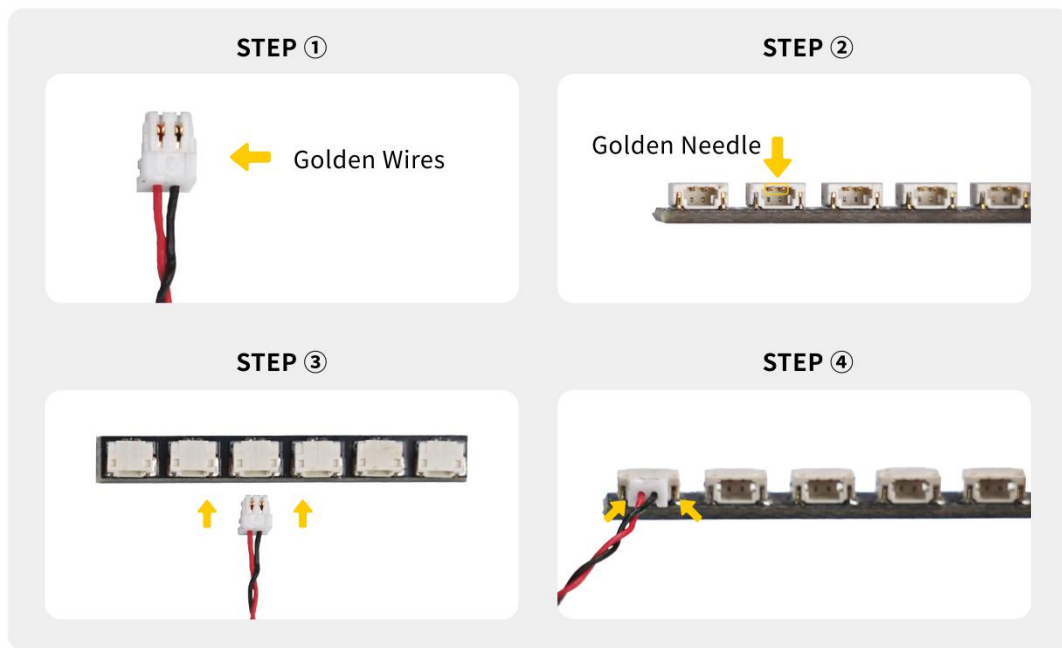

All our connections between plug and socket are all the same as shown above. So for any such structure with plug and socket, please pay attention to the golden wire of the plug and the golden needle of the socket, they must be touched together.

The connection method between the USB Power Cord and Expansion Boards is as follows:

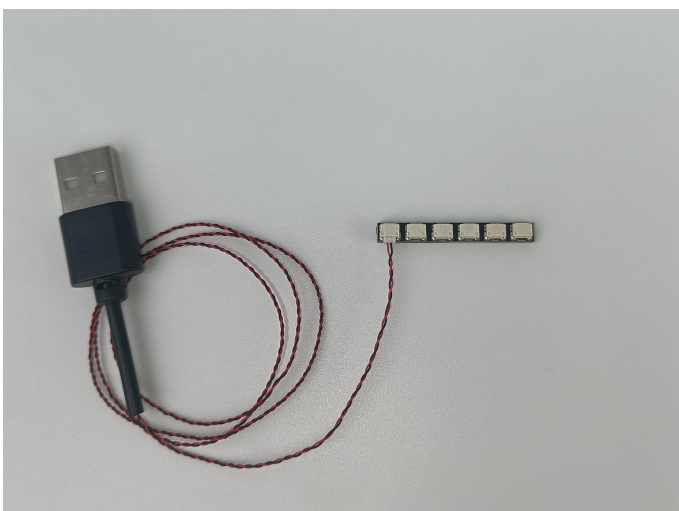

The USB Power Cord can be powered by phone chargers, power banks, etc.

USB connectors to connect devices

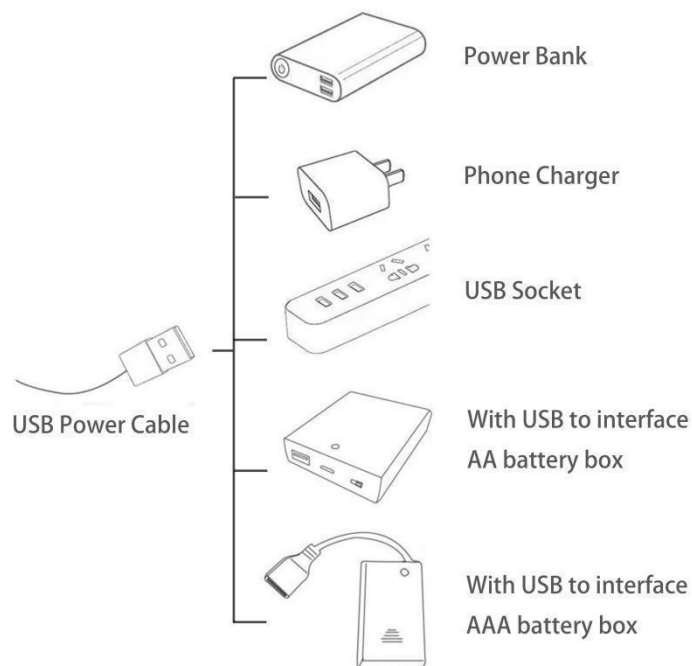

This instruction will use the power bank as power supply . The test structure is shown as follow. All lamp in this set will be tested by this structure.



BRICK BLING

When we test "A01007 Light-30CM Yellow" particles, Take out the bag labelled "A01007 Light-30CM Yellow". Take out one of the light and connect it to the socket. Turn on the power bank, the light will turn on normally as shown below.

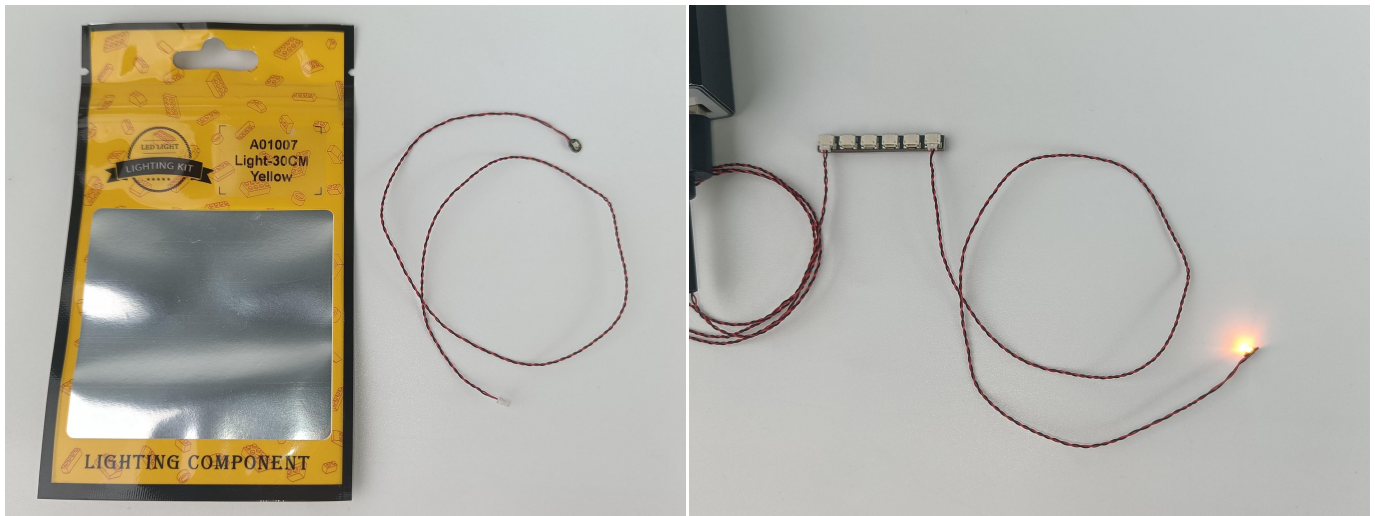

Test each lamp according to this method. It should be noted that after the test, the lamp must be returned to the corresponding bag to avoid confusion of types.



BRICK BLING

LED strip test:

Take out the bag labeled "A01101 LED Strip Red". Take out the LED light bar, connect the USB power cable, turn on the mobile power supply, the light will be on normally, as shown in the figure below.

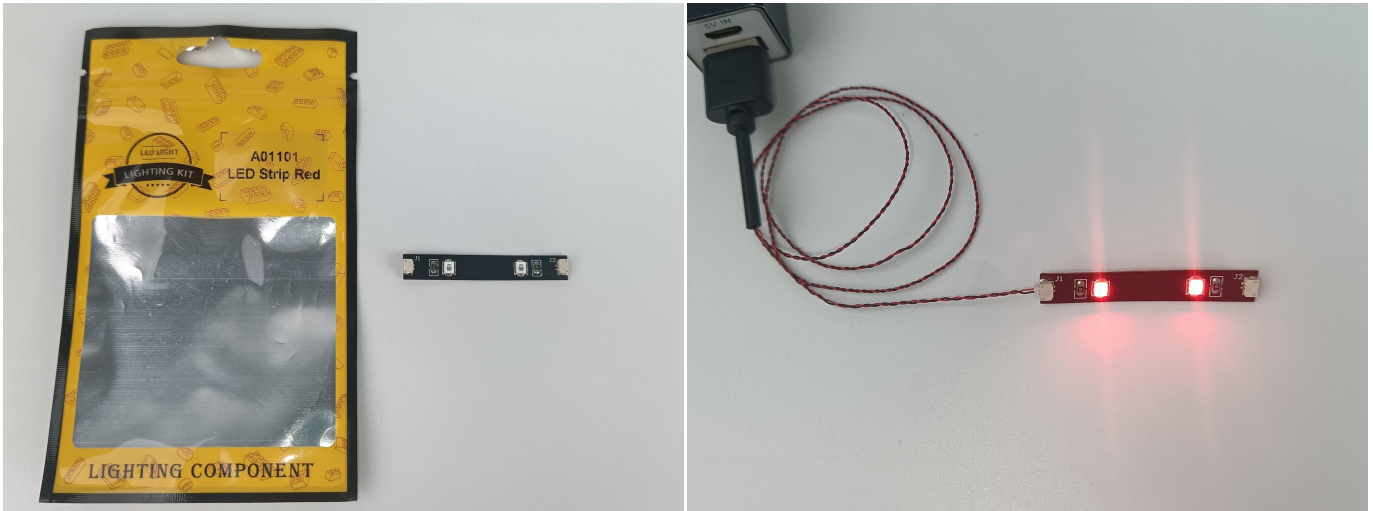

Please contact us immediately if any components don't work.



BRICK BLING

Section C: laying out components following the instruction.

1



2

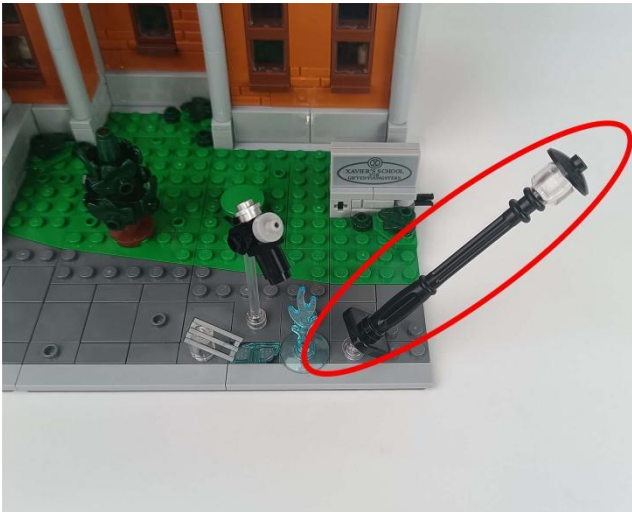

3

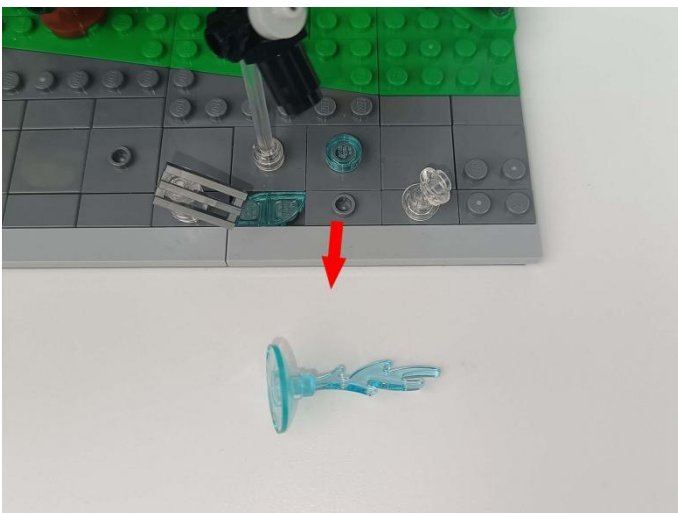

BRICK BLING

4



TIPS

BRICK
BLING

The slit on the the plate round 1X1 are hand-made to avoid squeeze the wire and cause short circuit and abnormal heat during installation.

The plate without slit

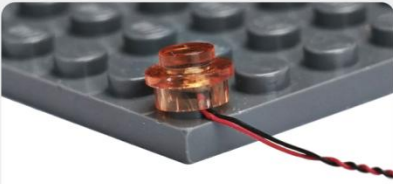

The squeeze causes the protective layer of the wire to be torn apart, the positive and negative wires touch together, and the set is short-circuited and the hot or wire is crushed, the wire to be disconnected and don't work.

The plate with slit

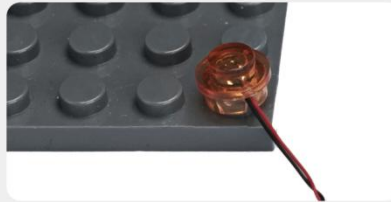

The wire has enough space to avoid being squeezed endowed with longer service life and more stable effect.

5

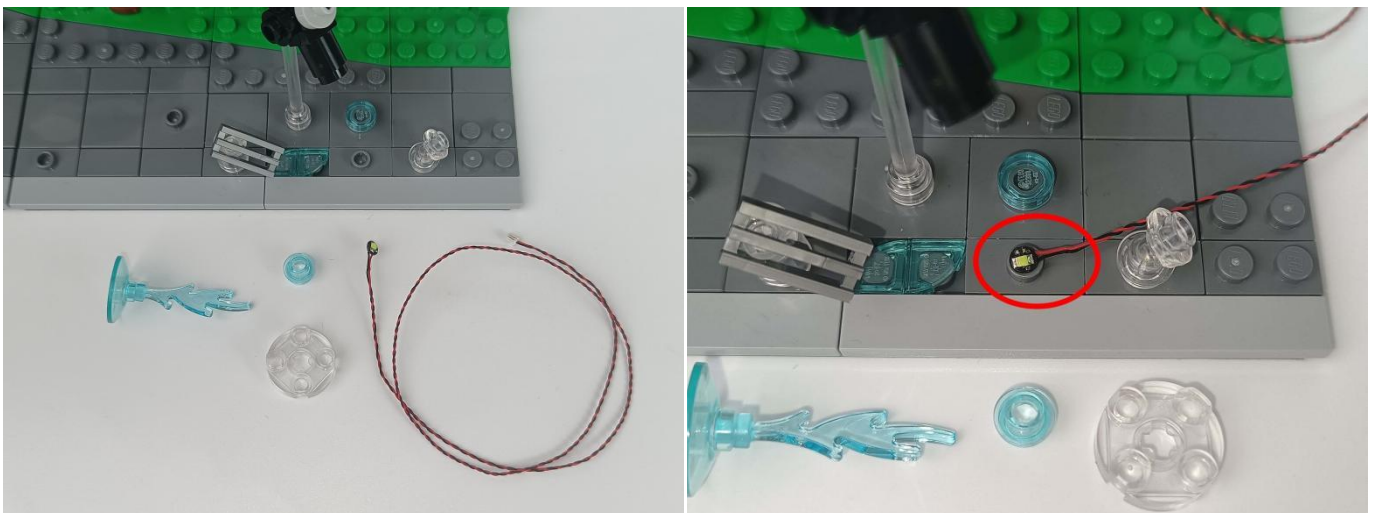

BRICK BLING

6

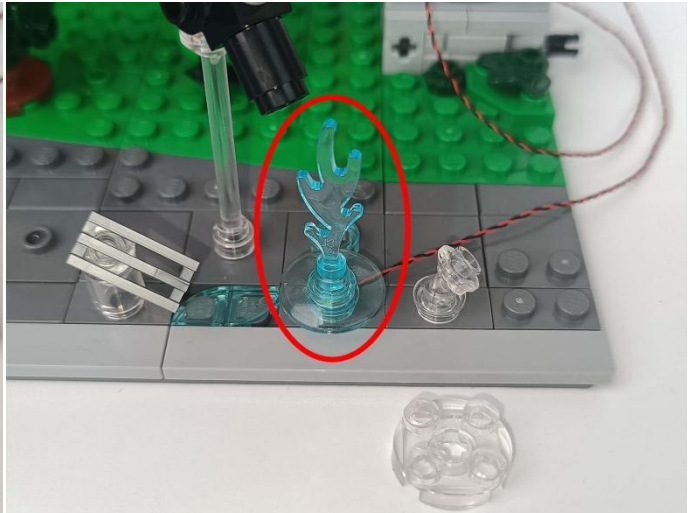
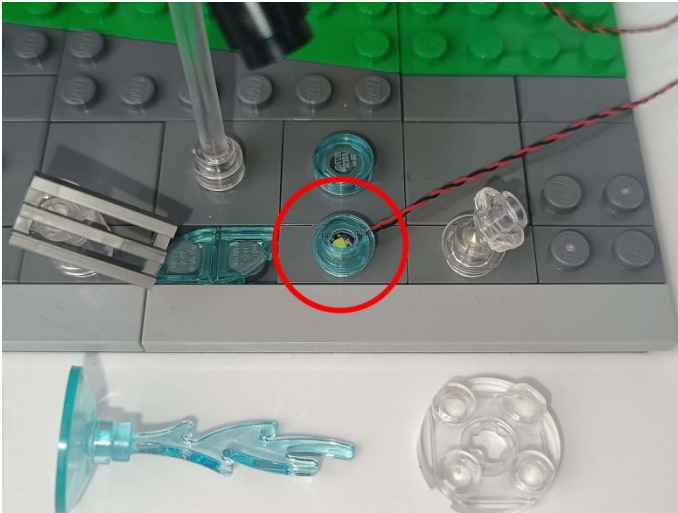

7



8

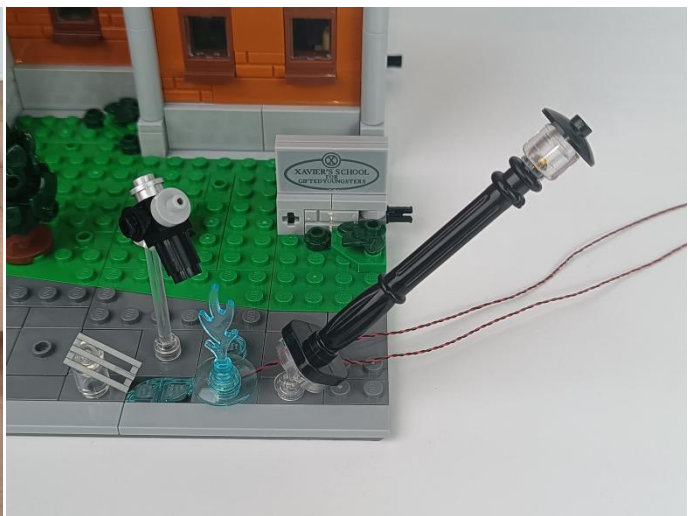
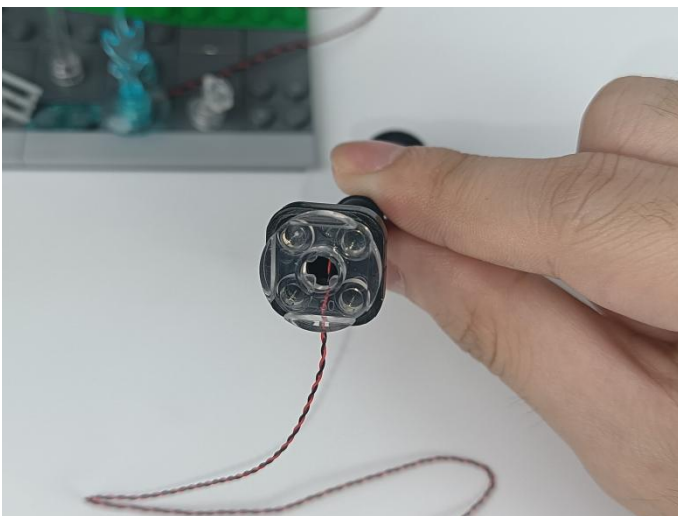

BRICK BLING

9



10



11

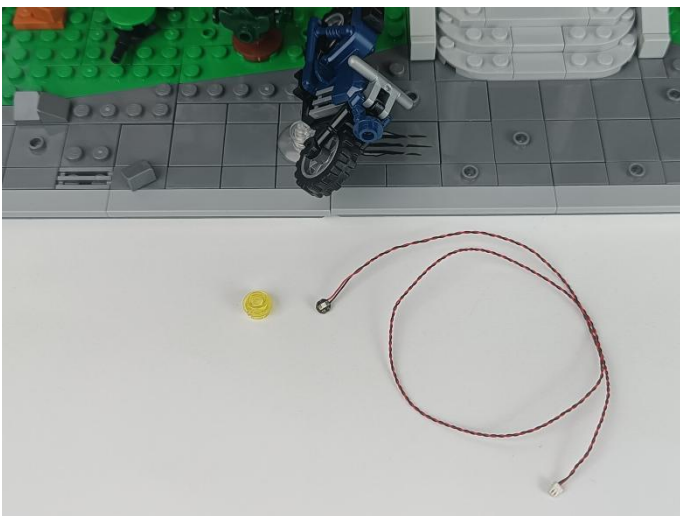

BRICK BLING

12

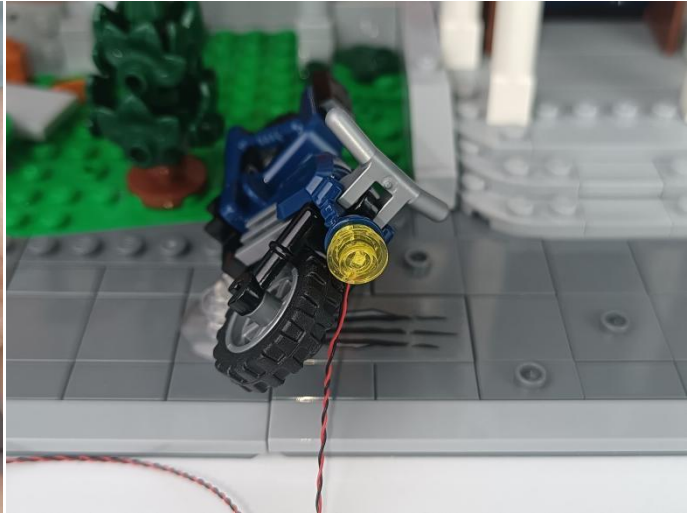

13

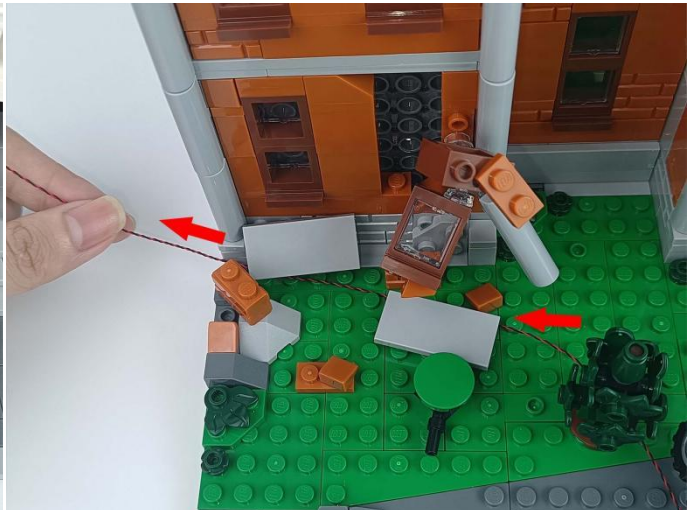

14



15



16

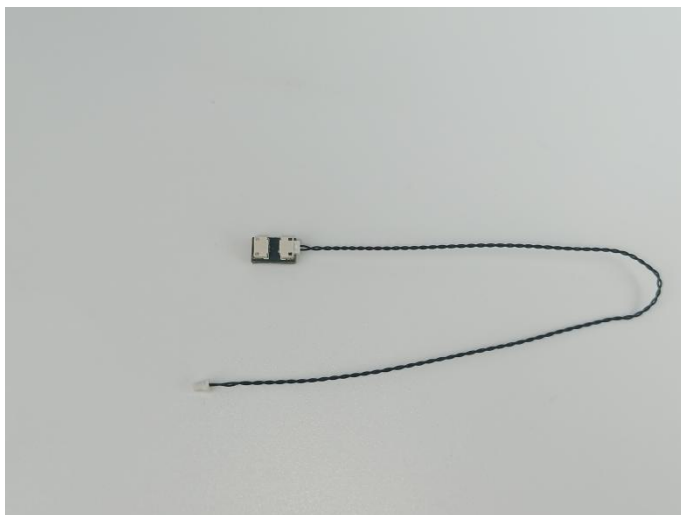

17

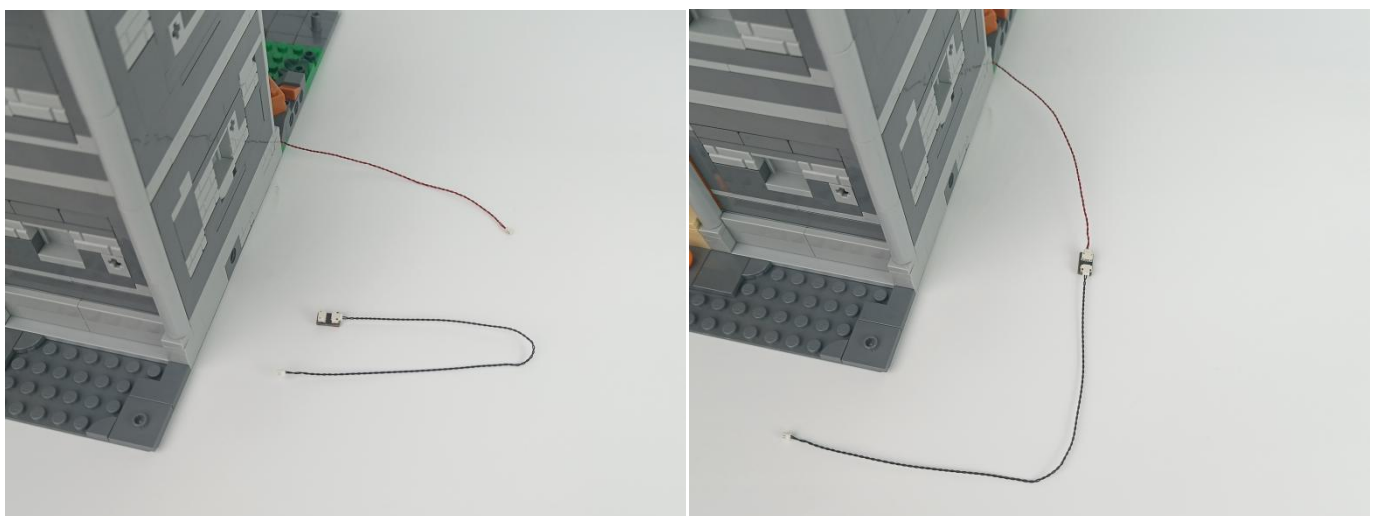

18

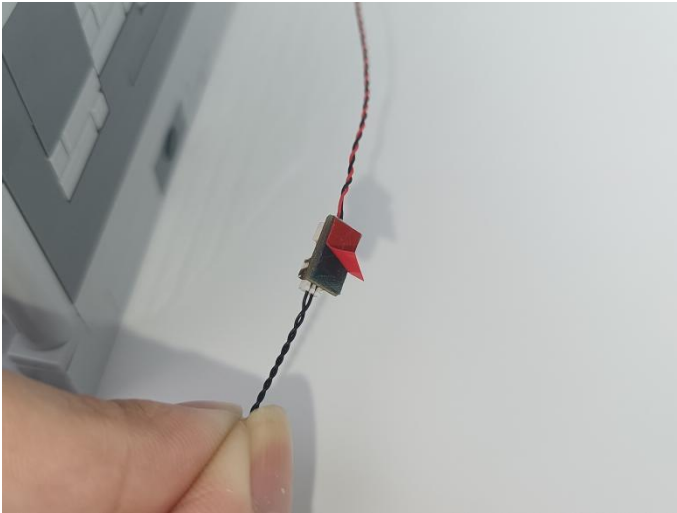

19



20



21

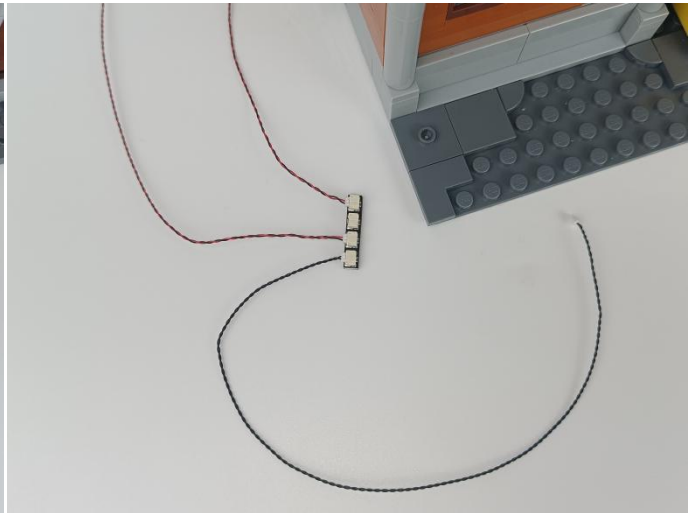
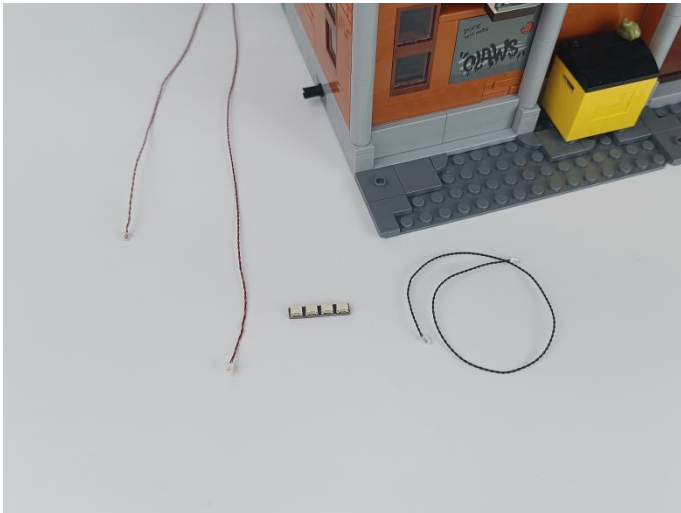

22

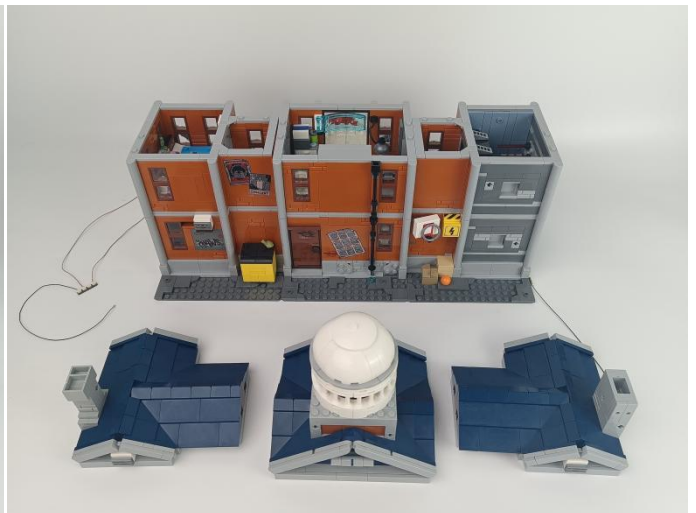

23

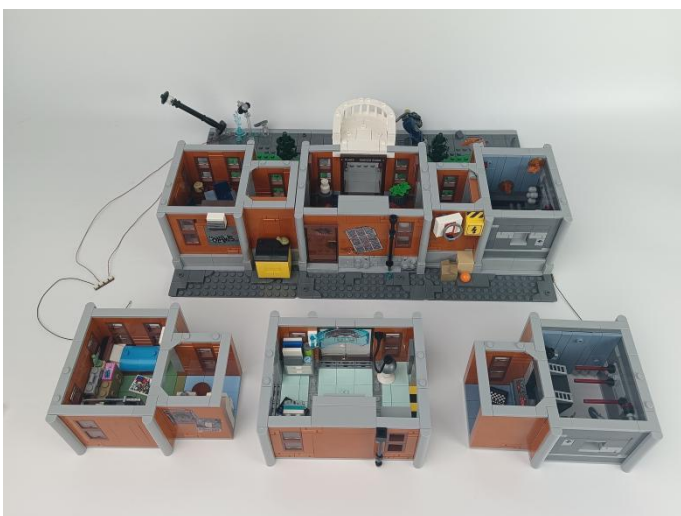

BRICK BLING

24

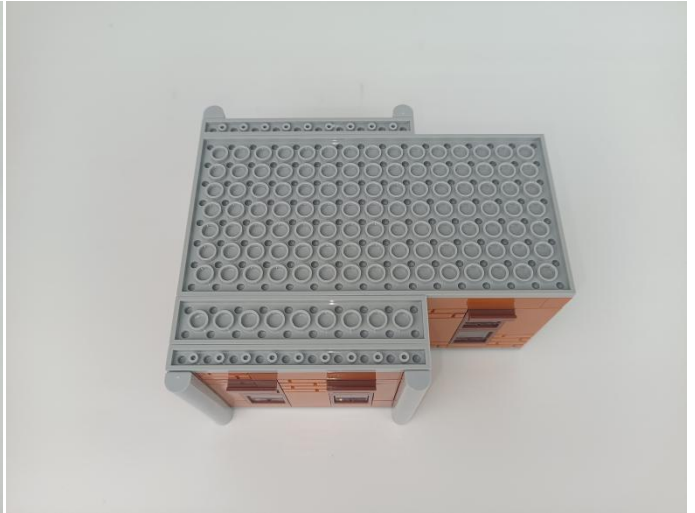

25



26

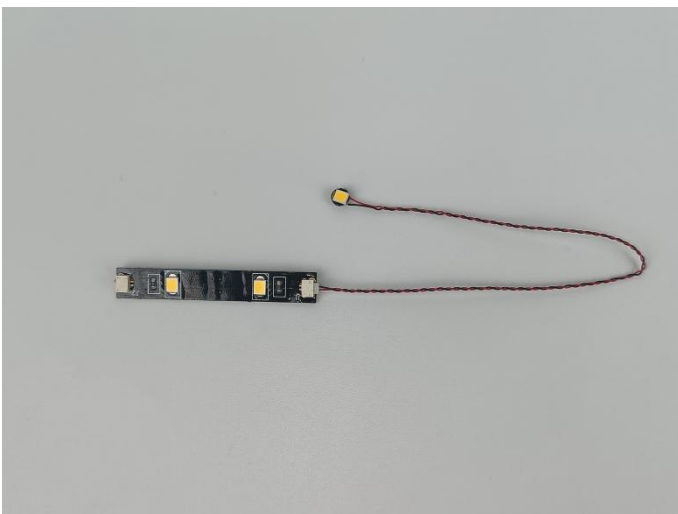

27

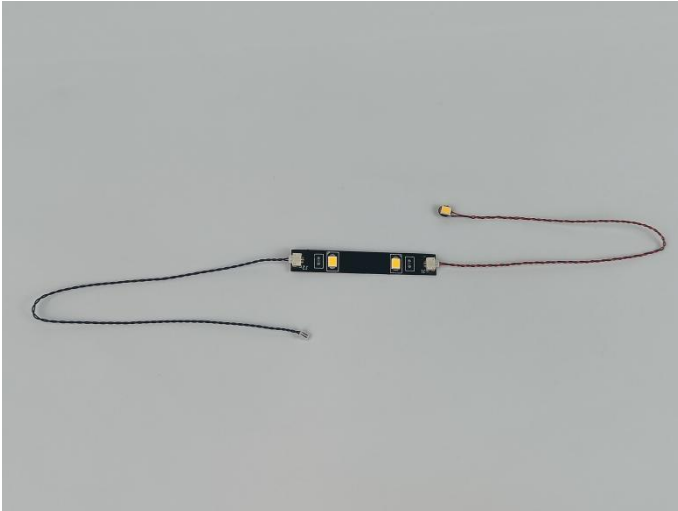

28

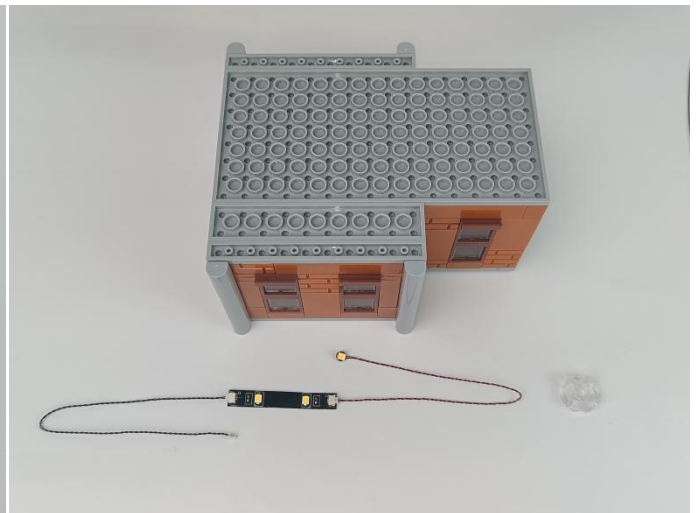

29

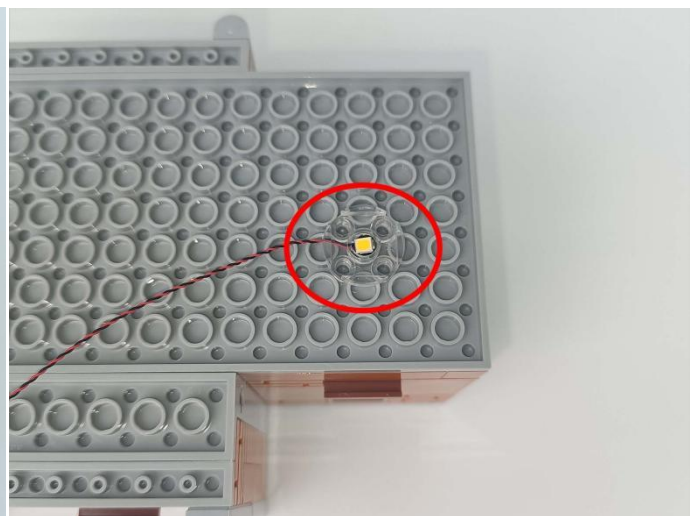
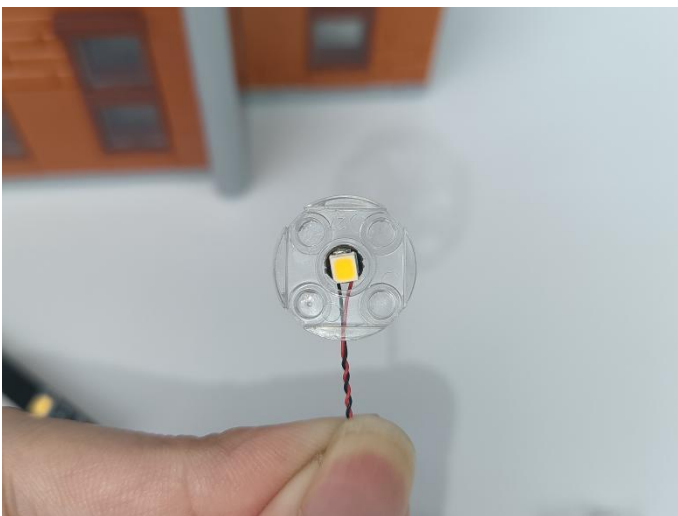

BRICK BLING

30

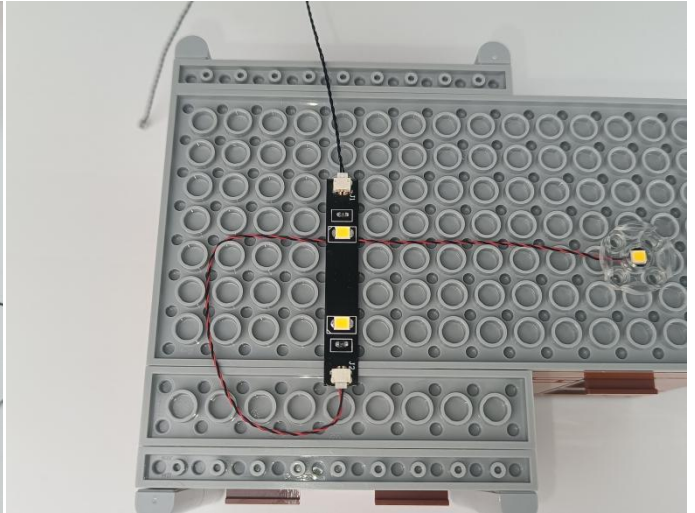
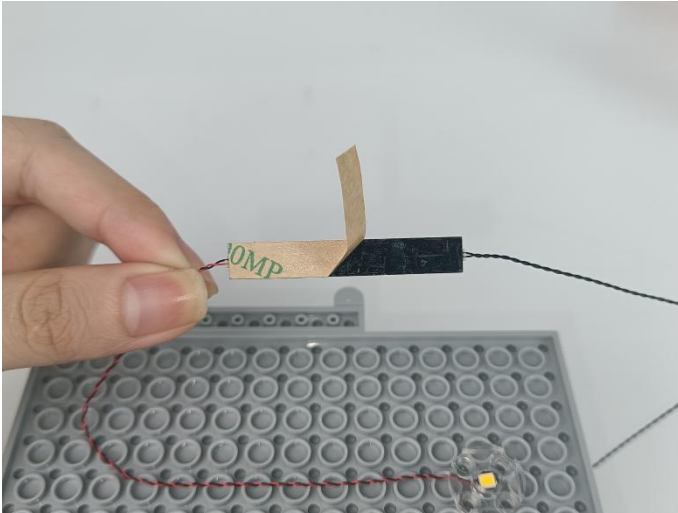

31

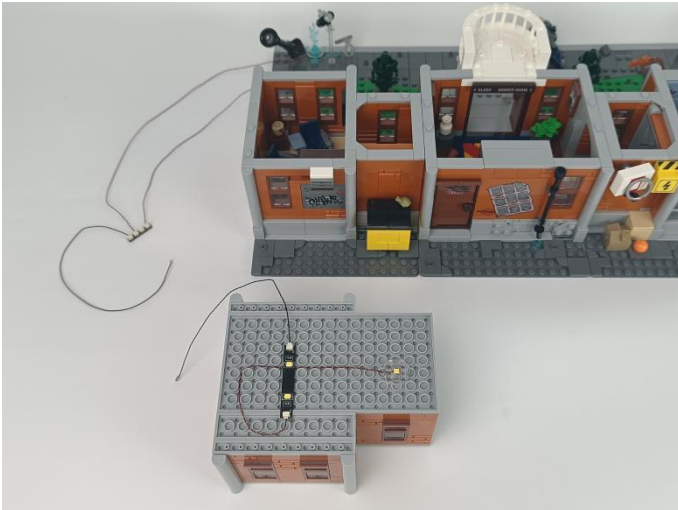

32

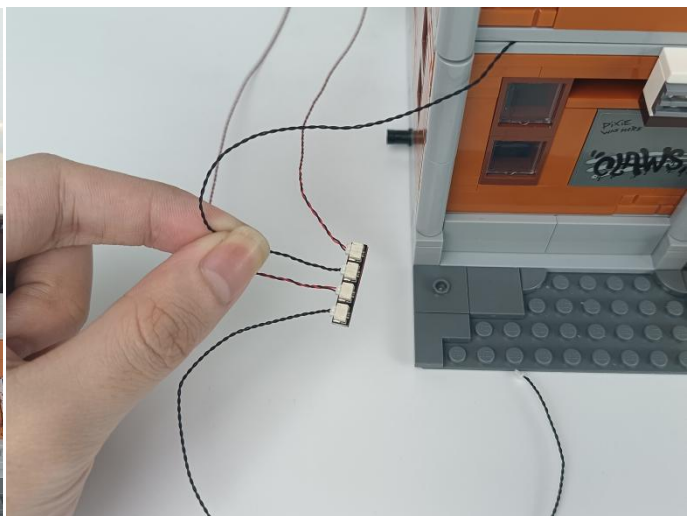

BRICK BLING

33

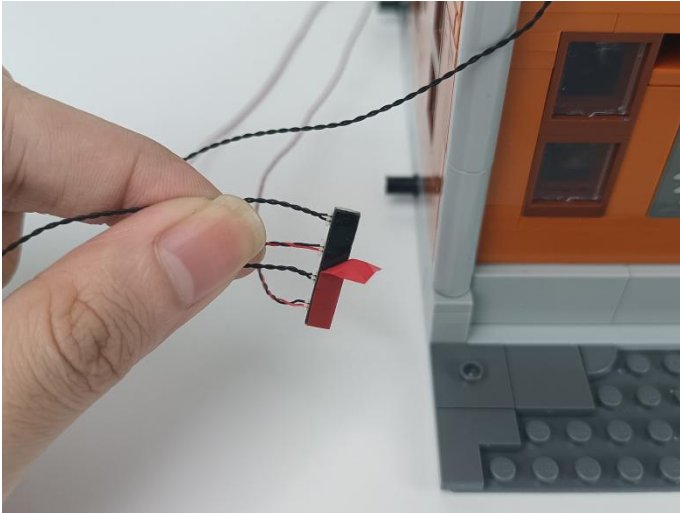

34

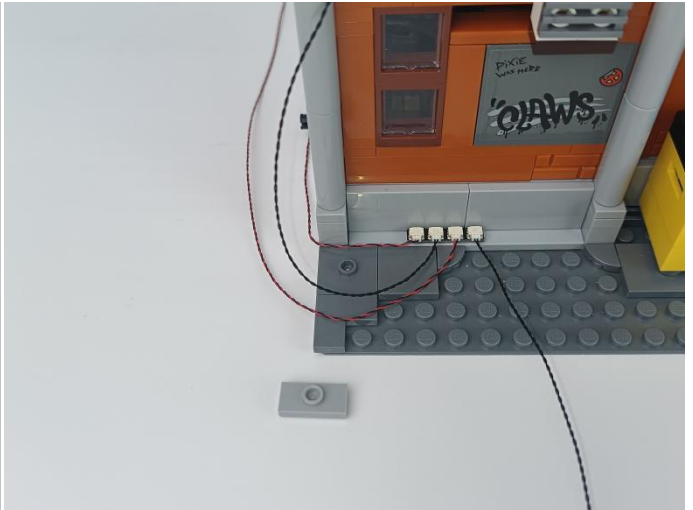

35



BRICK BLING

36



37

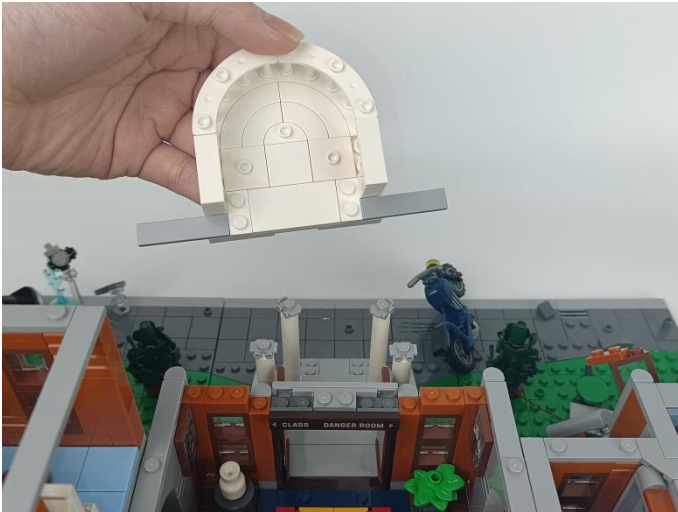

38



BRICK BLING

39



40



41



BRICK BLING

42

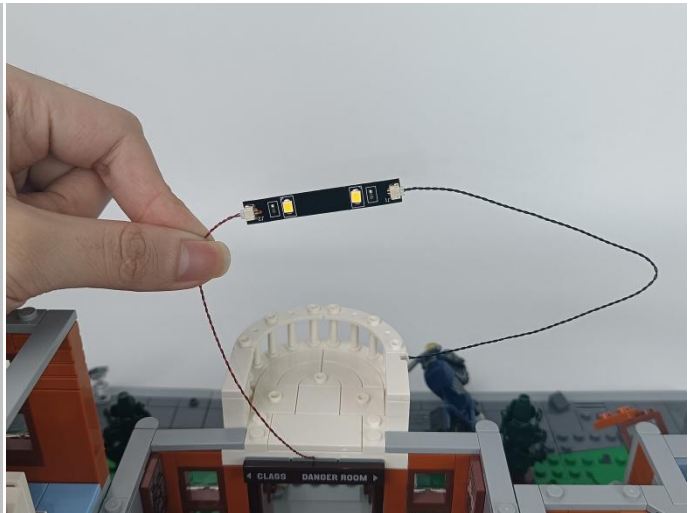

43

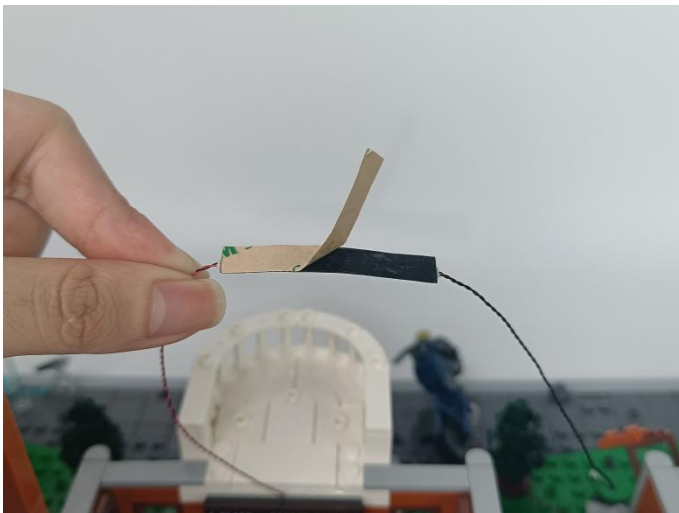

44

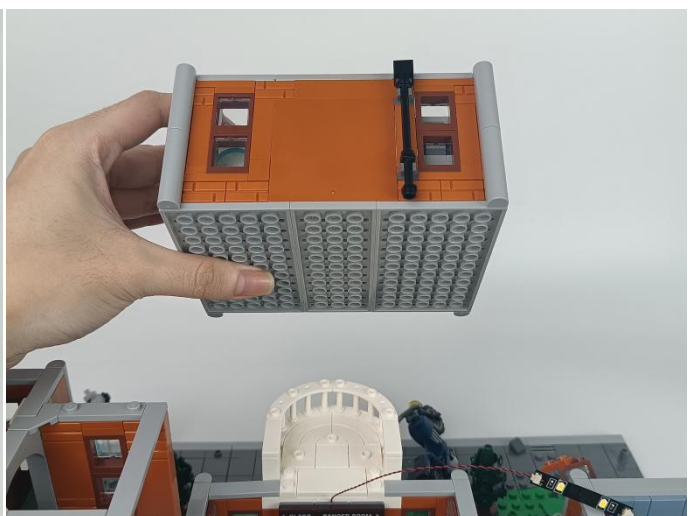

BRICK BLING

45

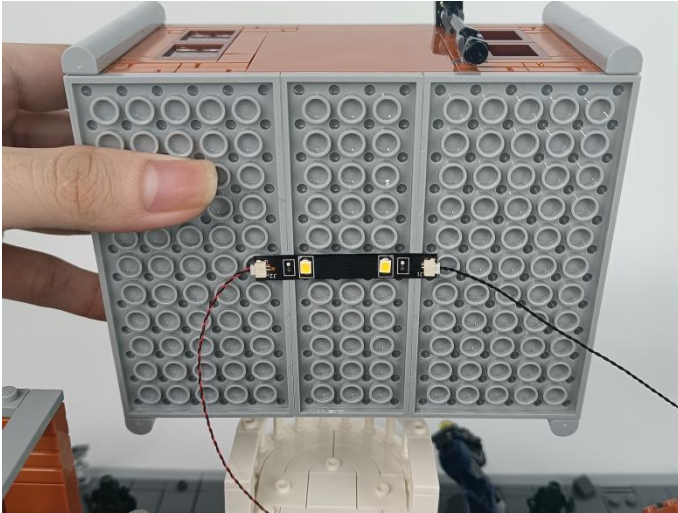

46

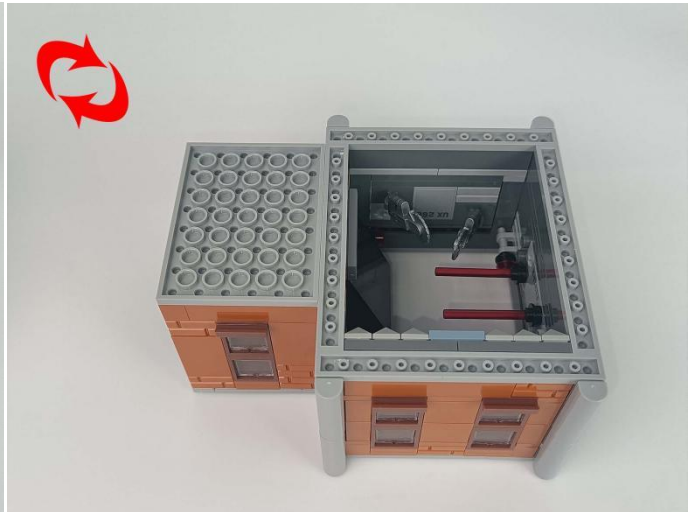

47



48

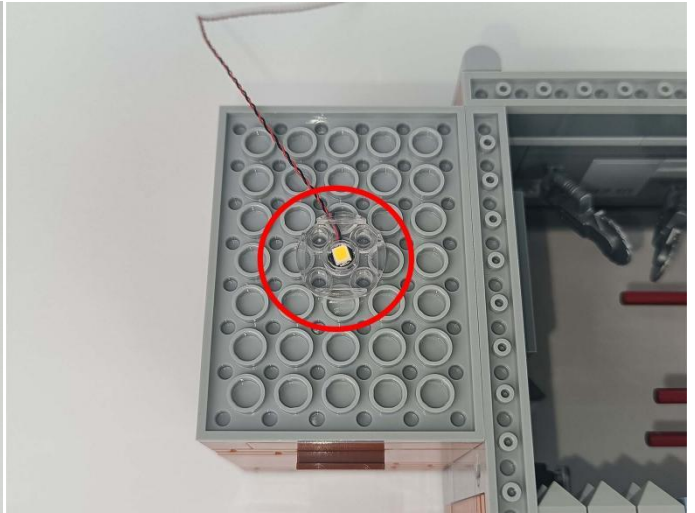
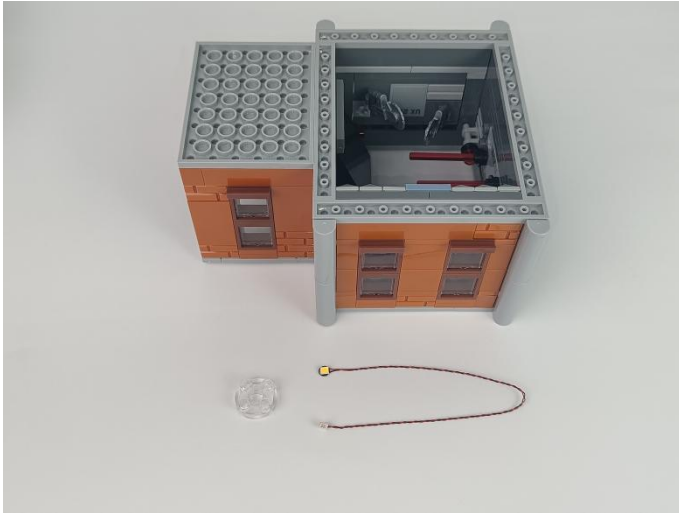

49

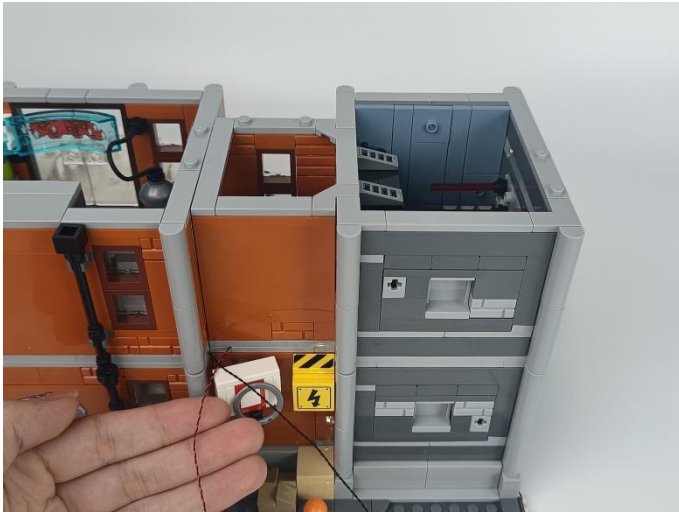

50



BRICK BLING

51

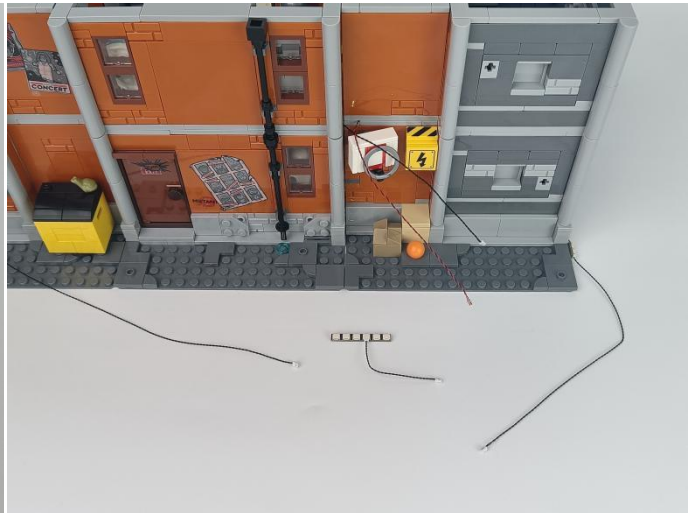
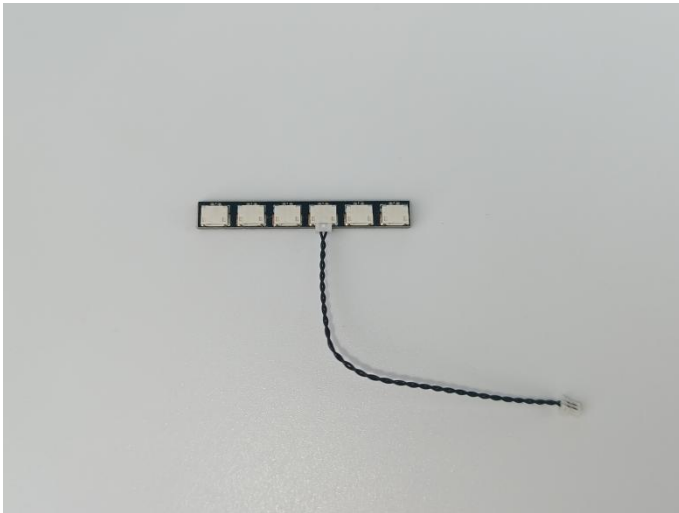

52

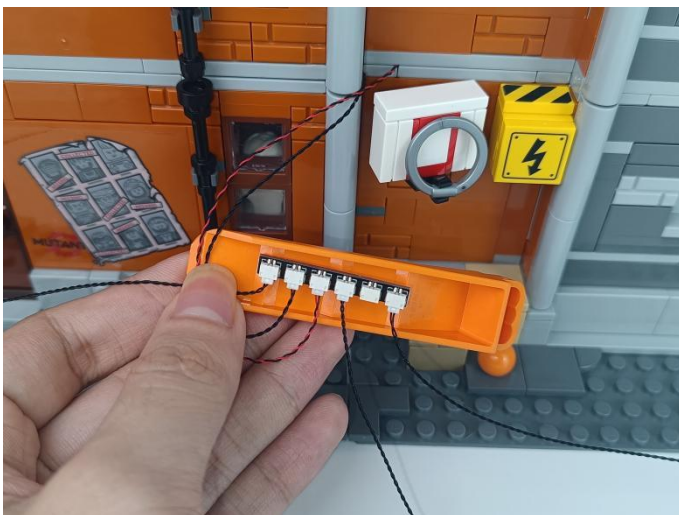

53

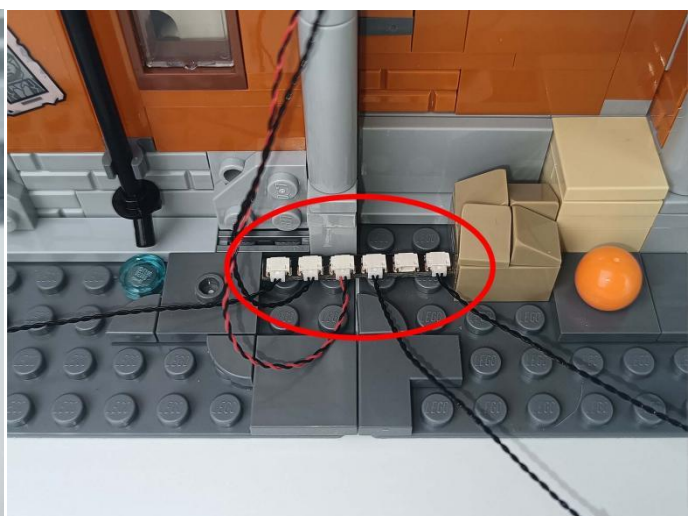
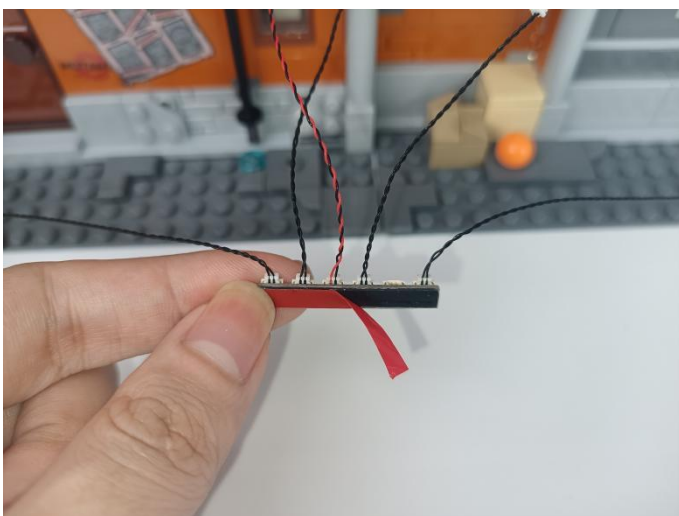

BRICK BLING

54

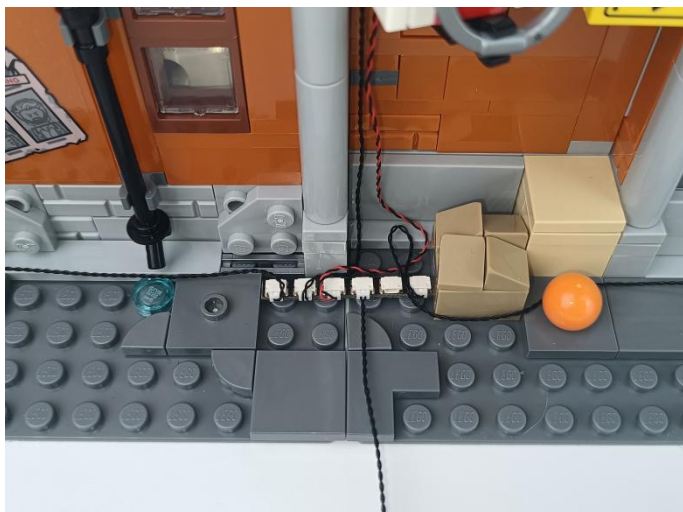

55

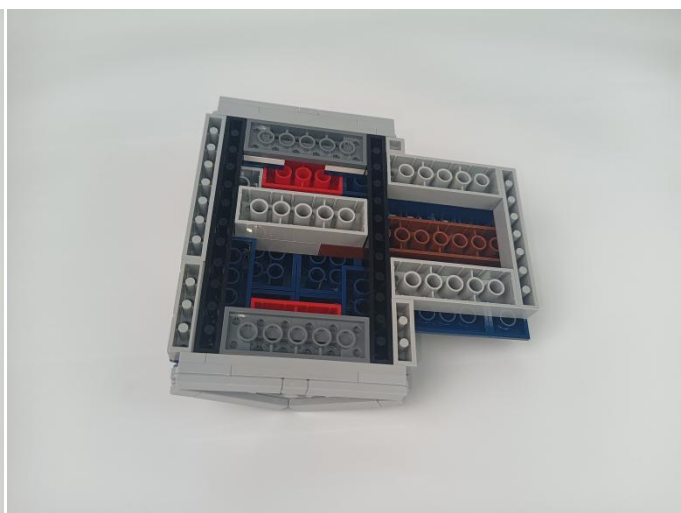
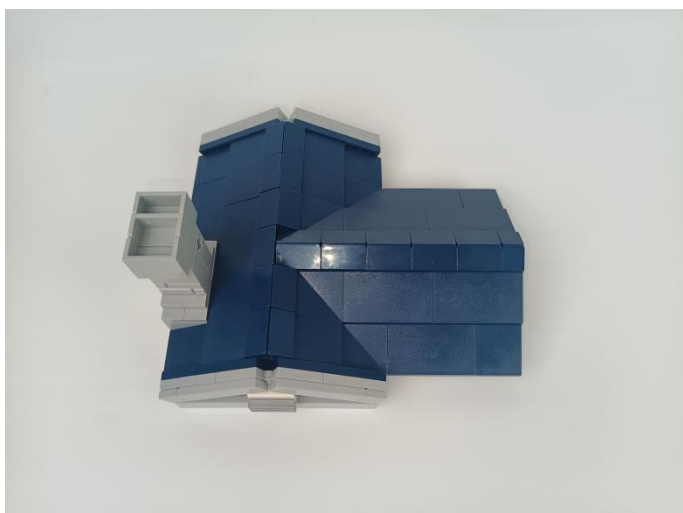

56



BRICK BLING

57

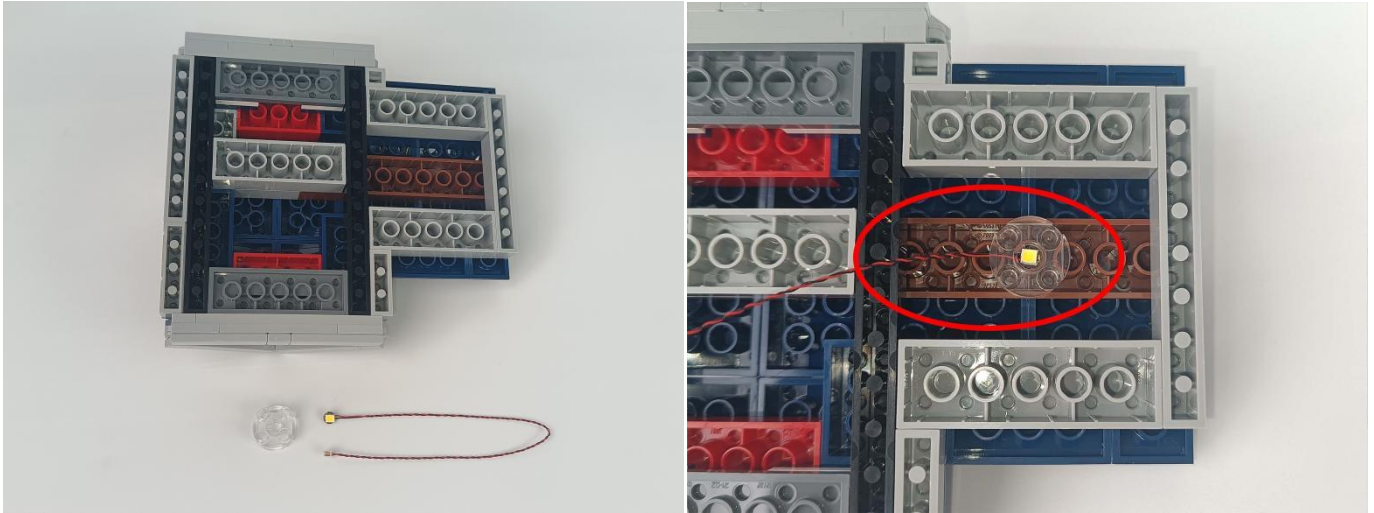

58

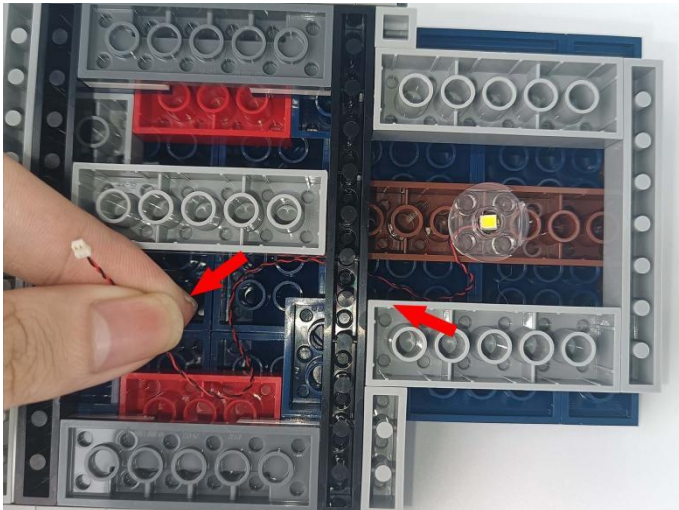

59



60

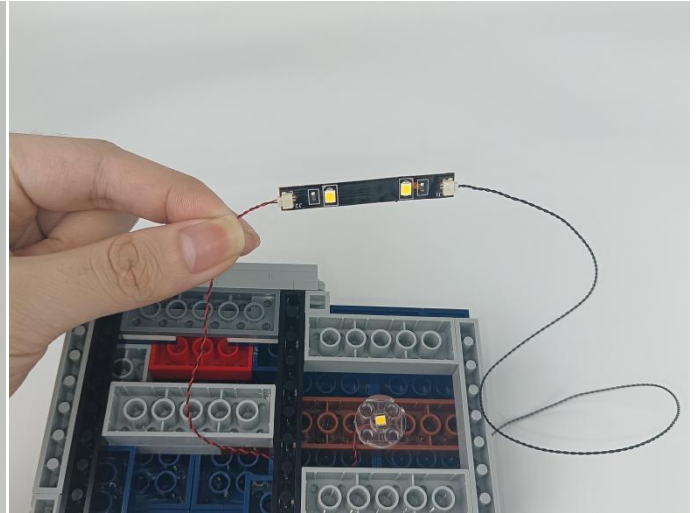
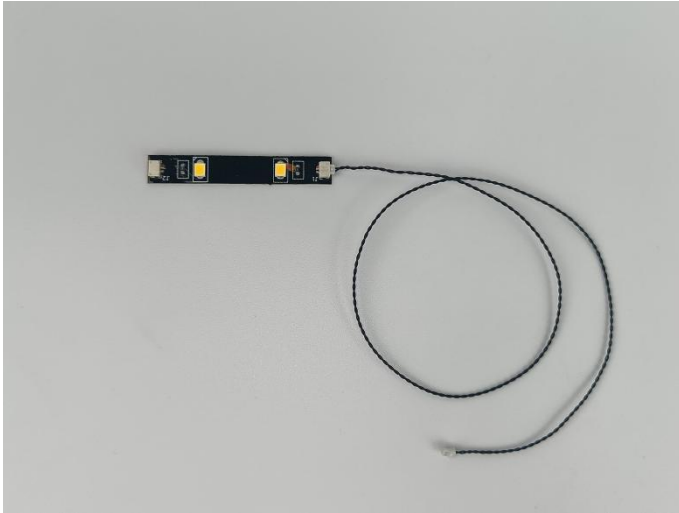

61

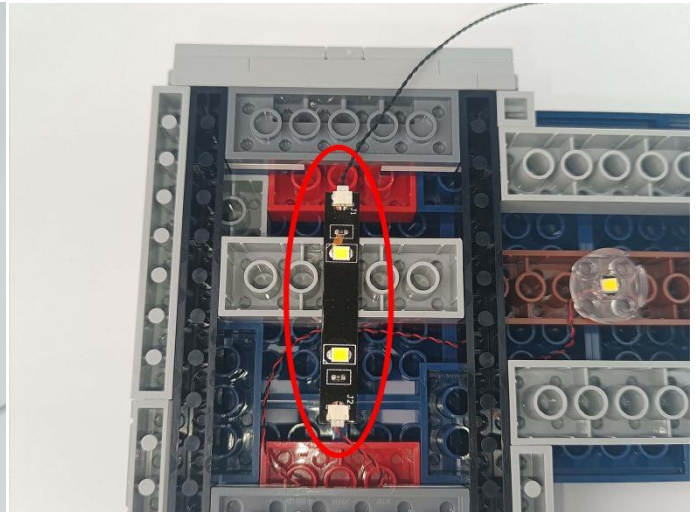
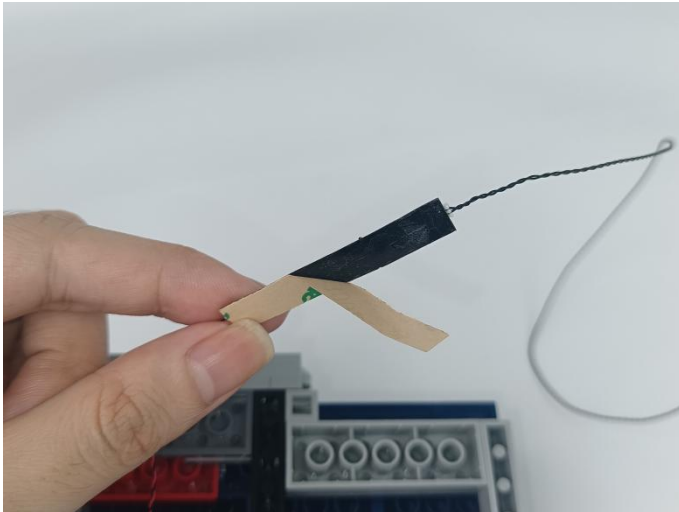

62



BRICK BLING

63

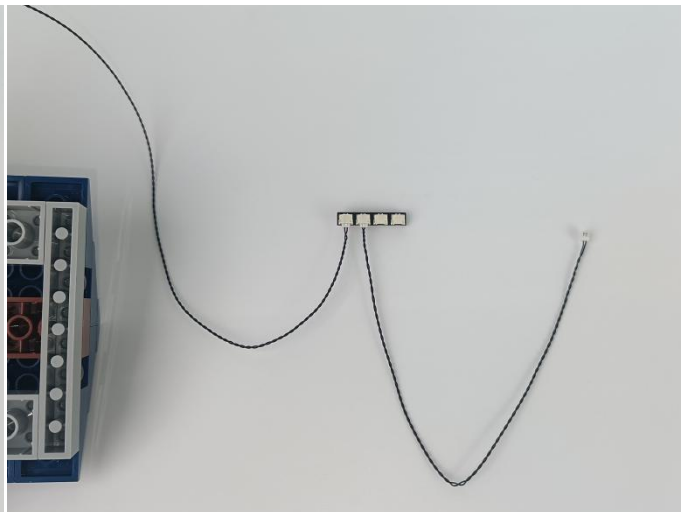
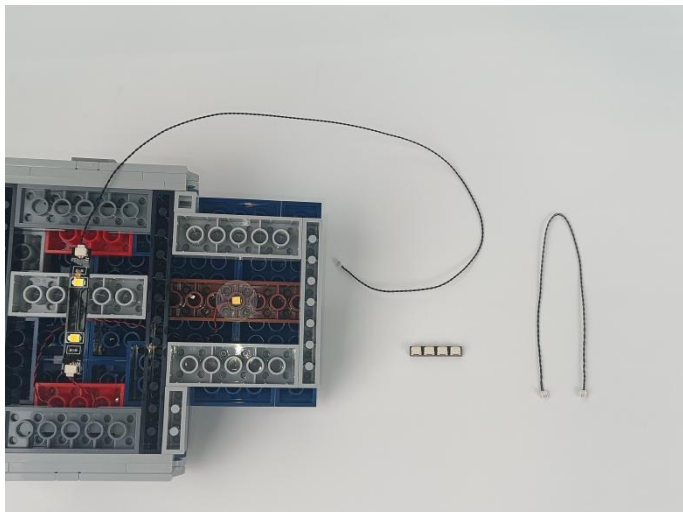

64

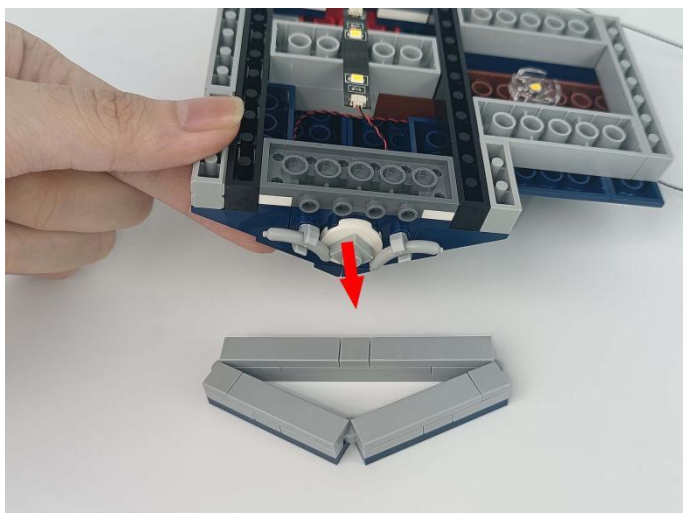

65

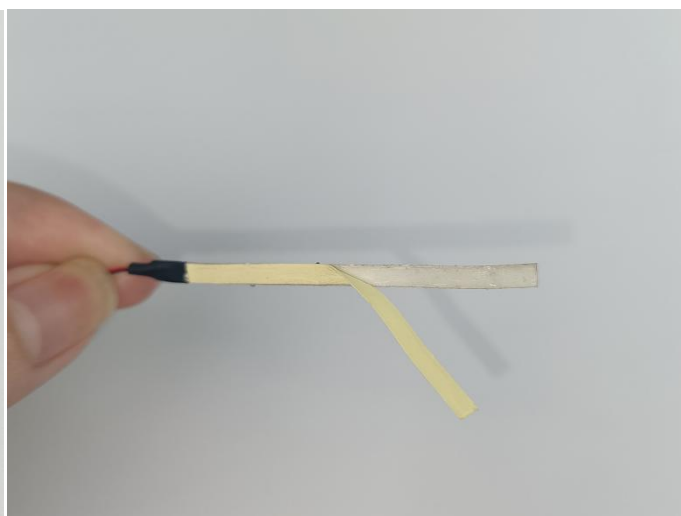

BRICK BLING

66

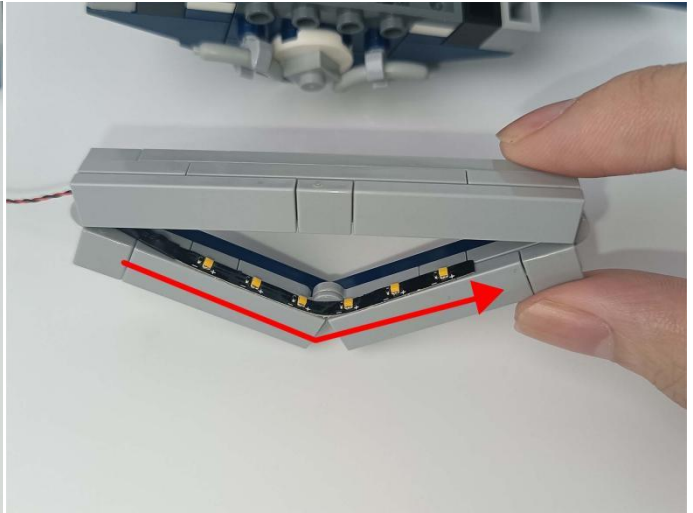
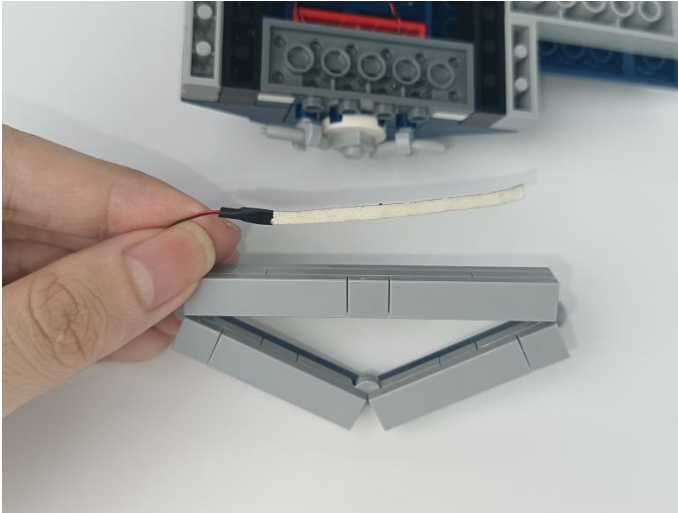

67

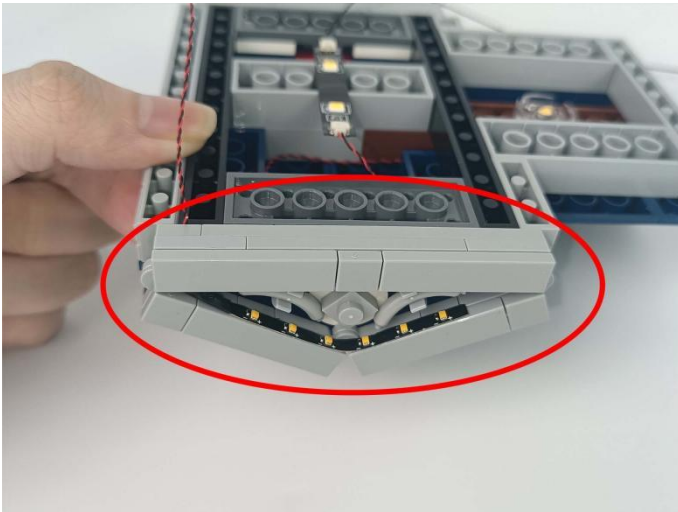

68



BRICK BLING

69

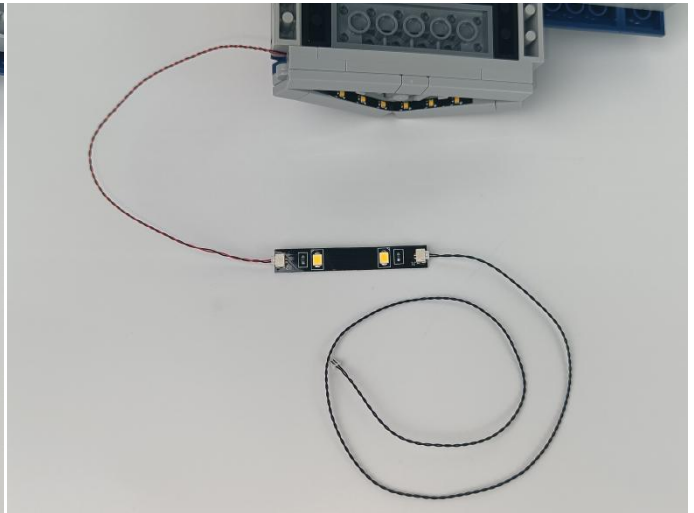
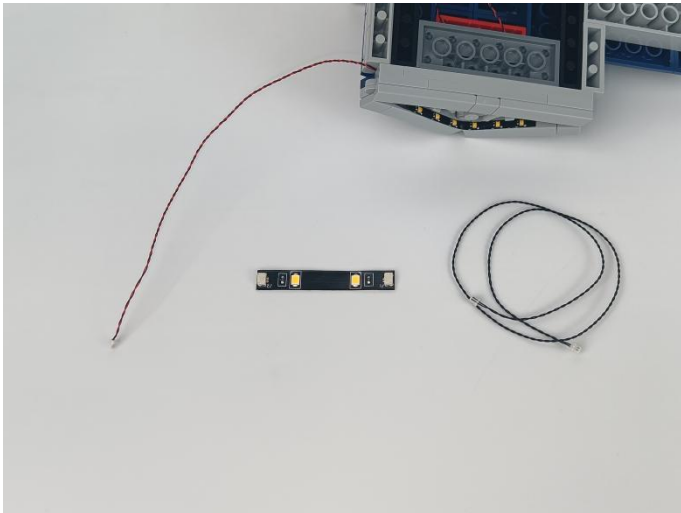

70

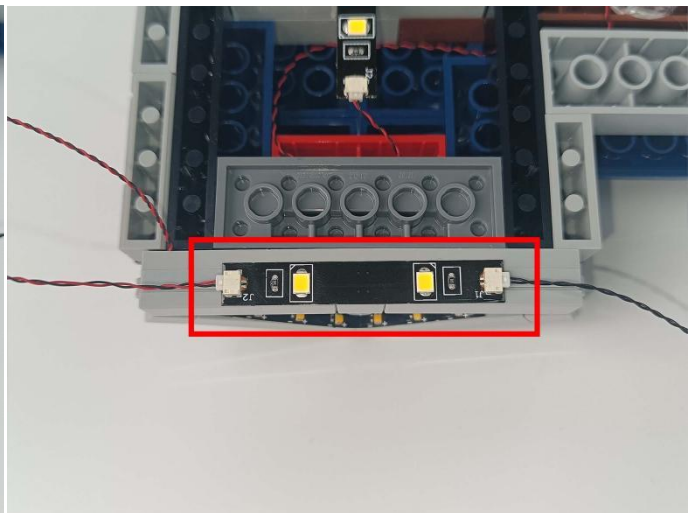
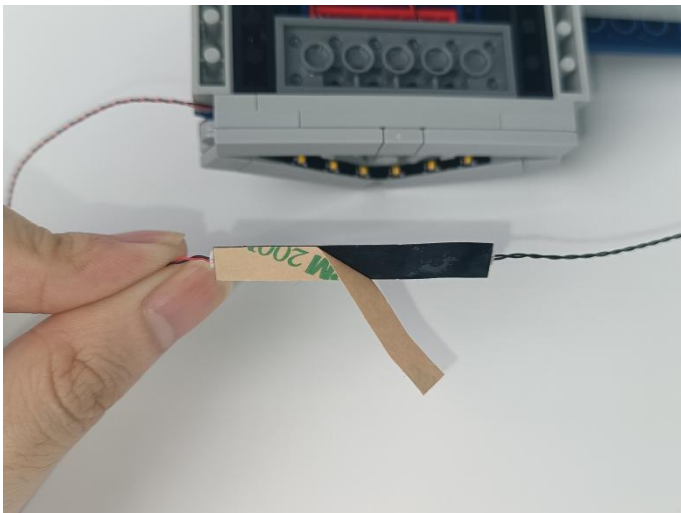

71

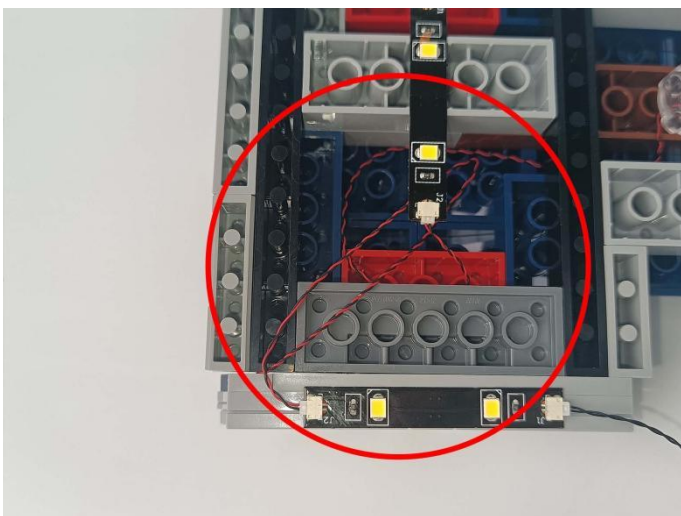

72

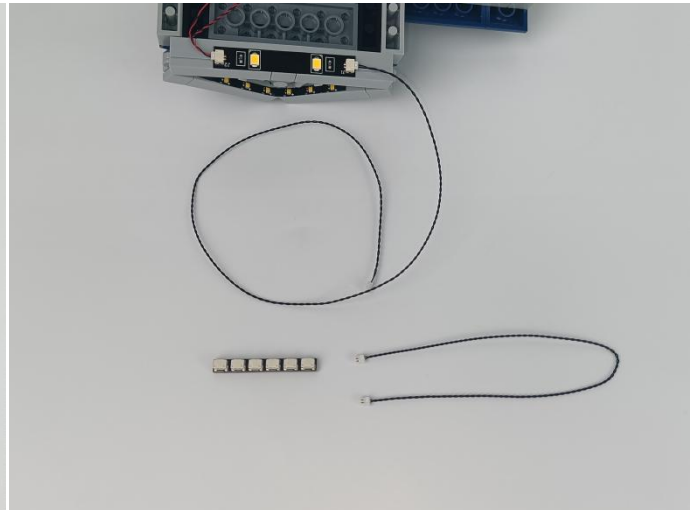

73

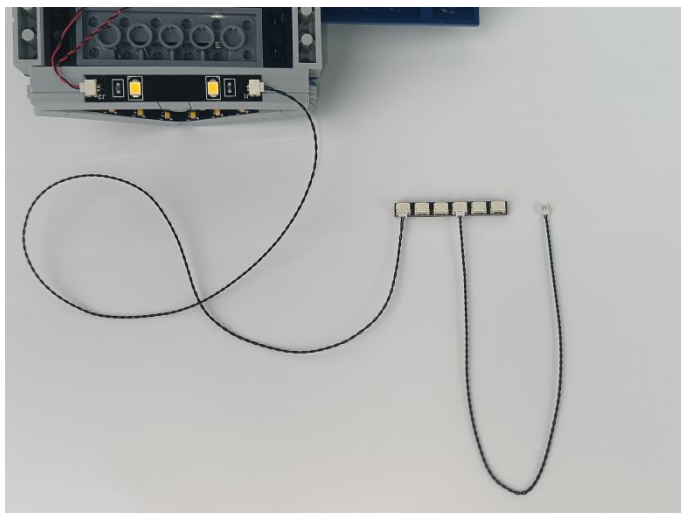

74



75



76



77

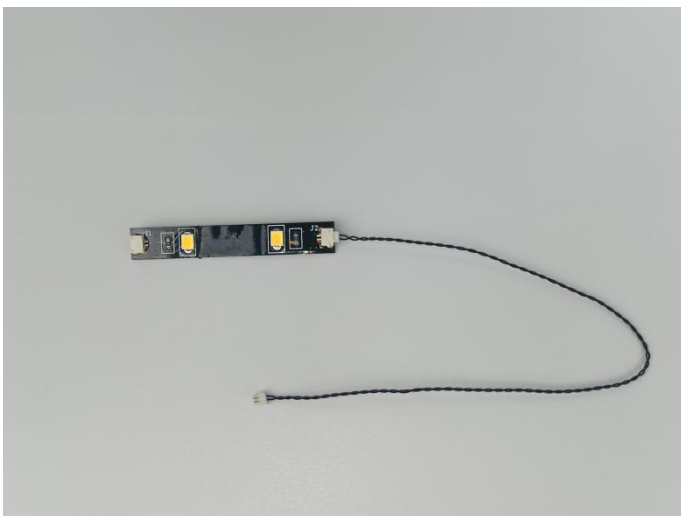

BRICK BLING

78

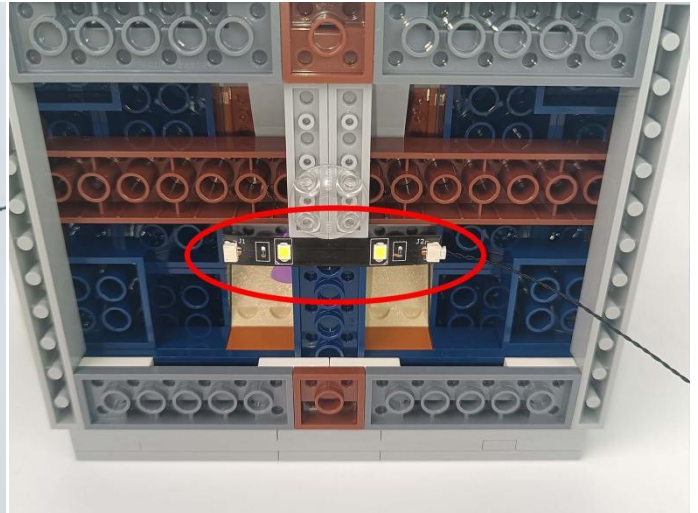
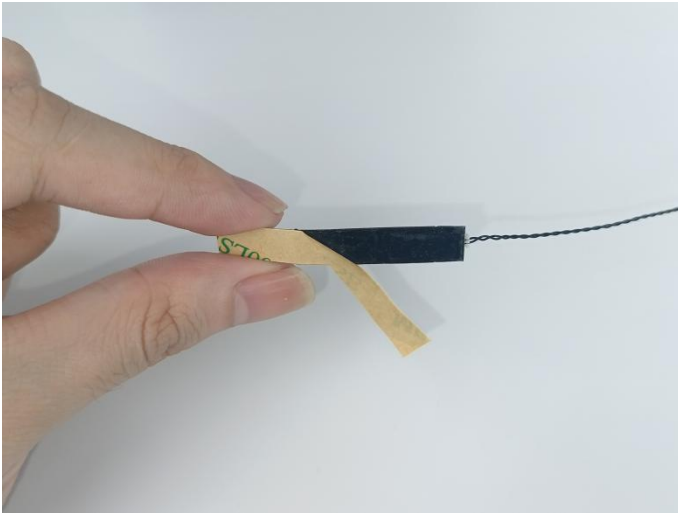

79



80



81

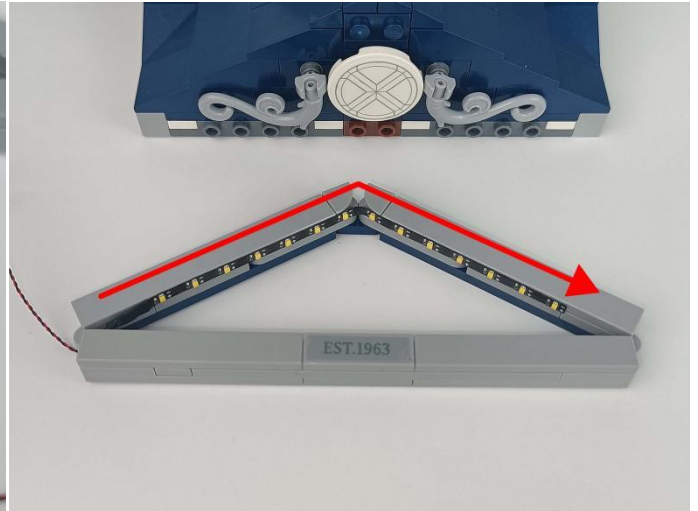
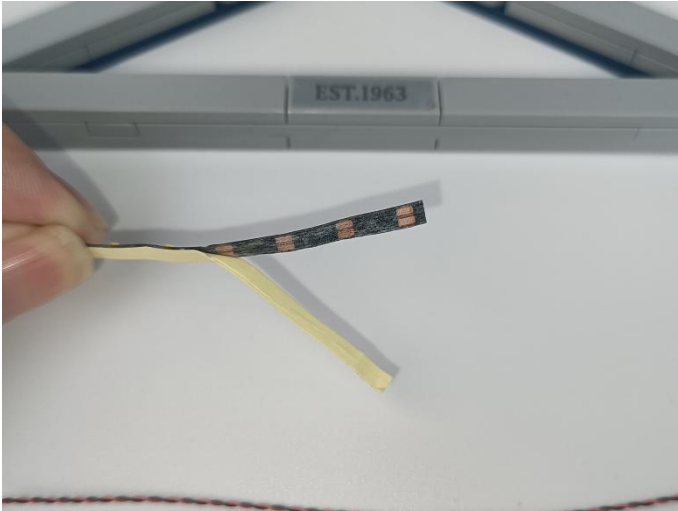

82

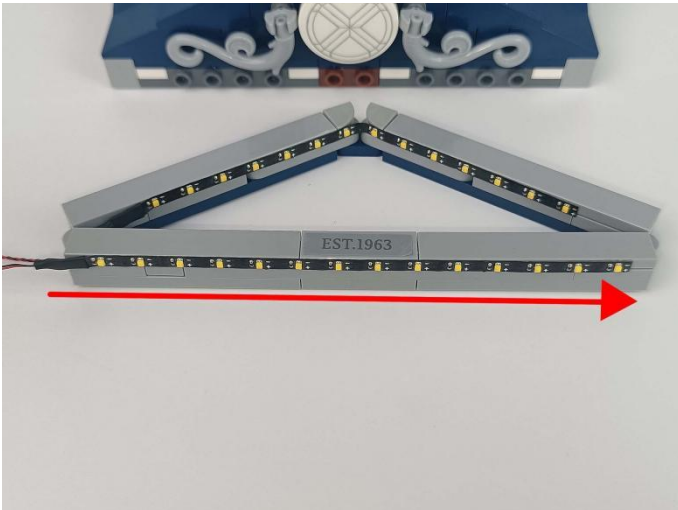

83

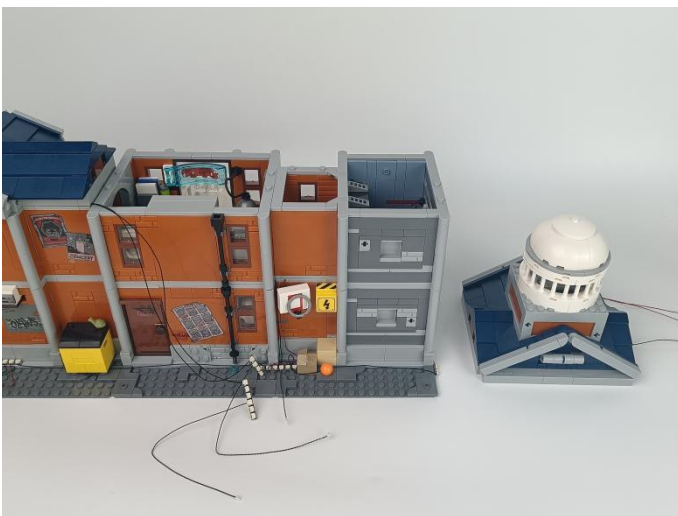

84

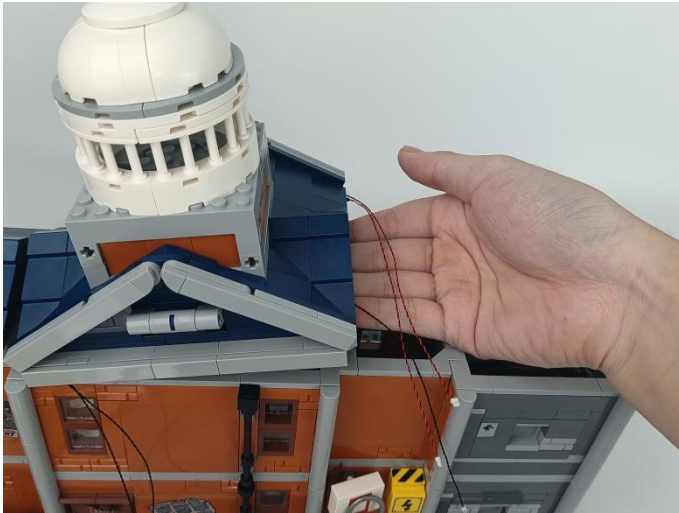

85

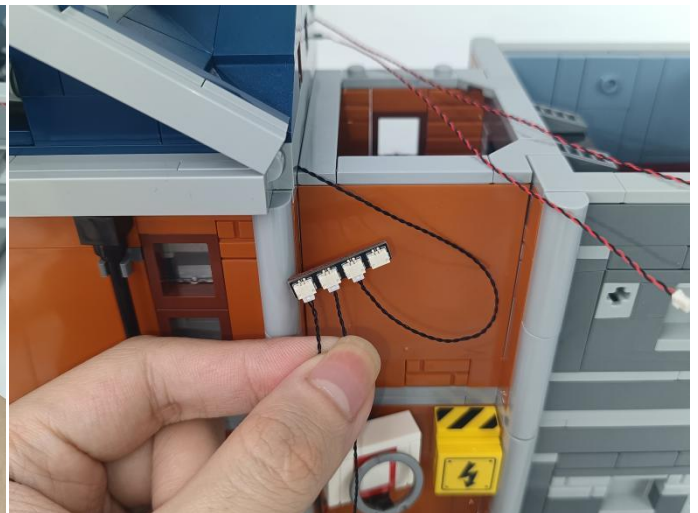
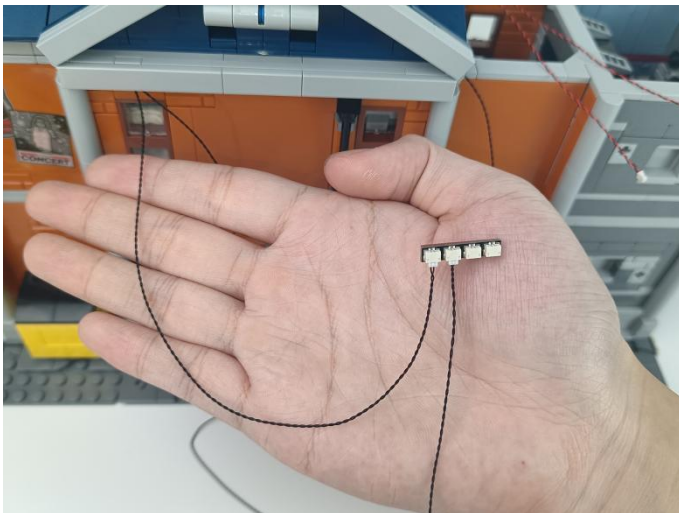

86

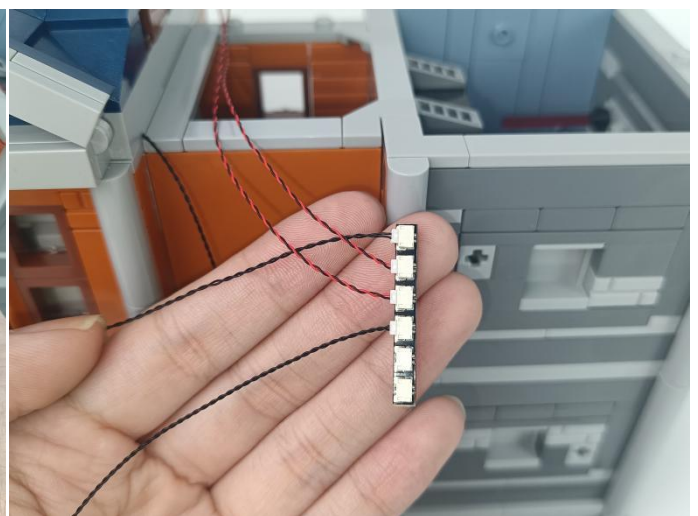
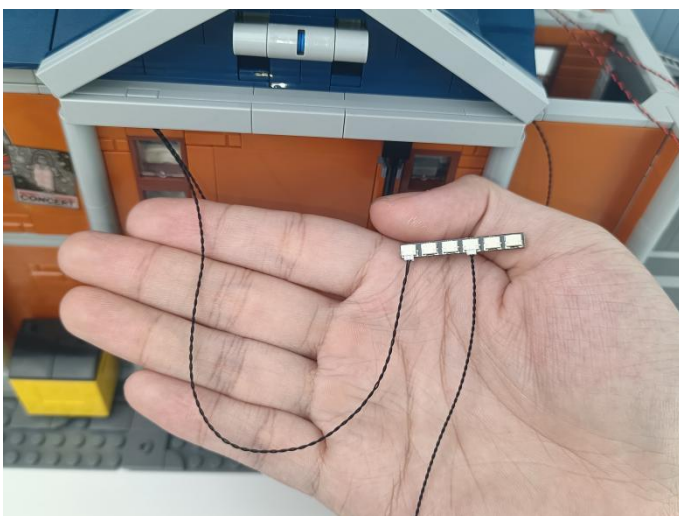

87

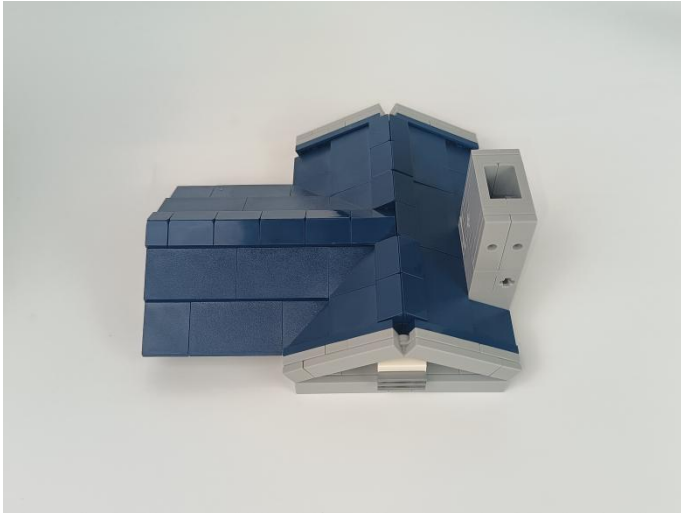

88



89

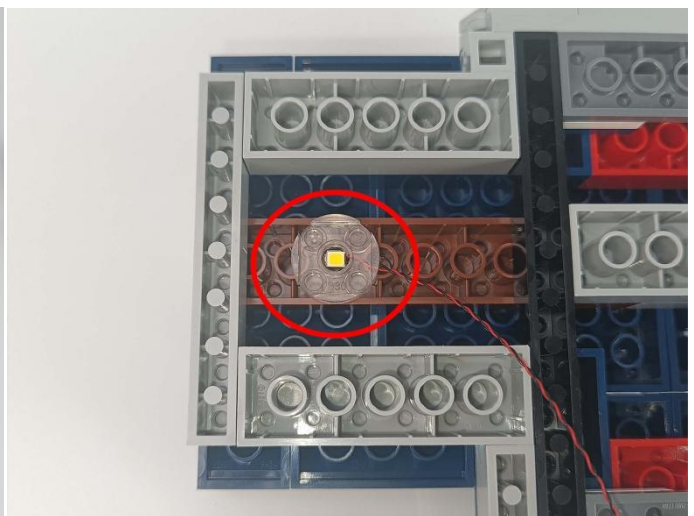
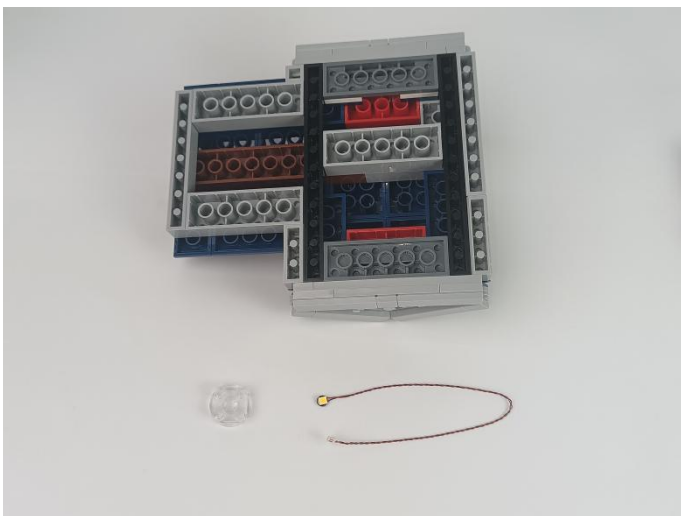

BRICK BLING

90

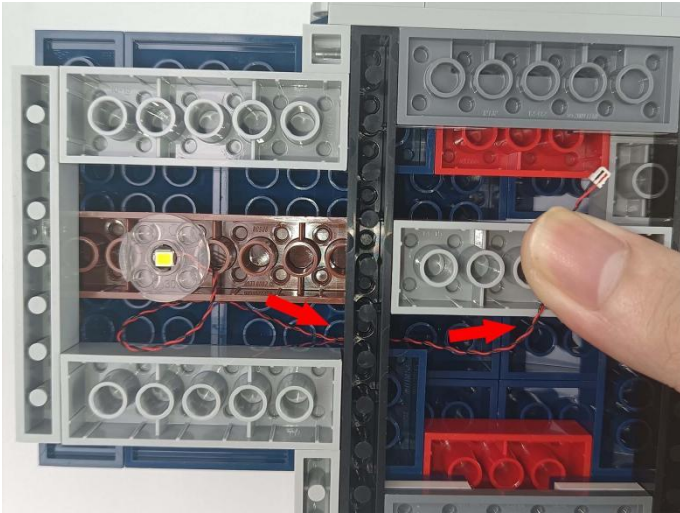

91



92

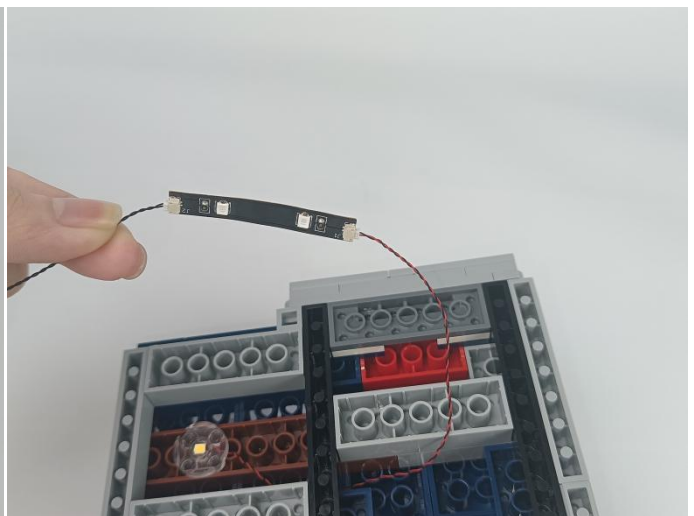
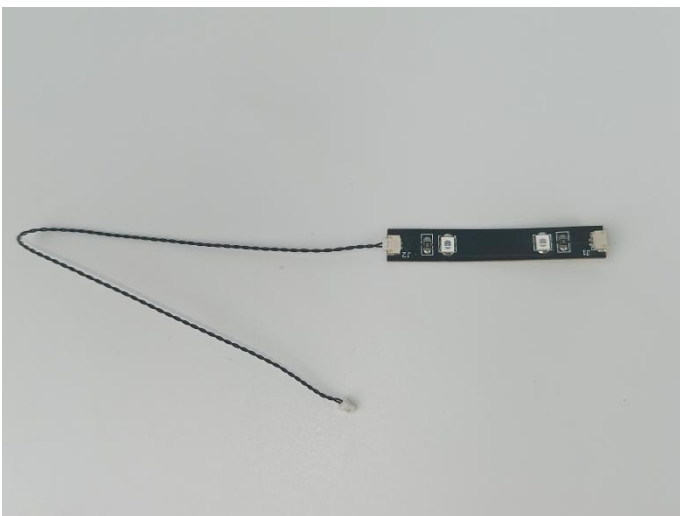

93

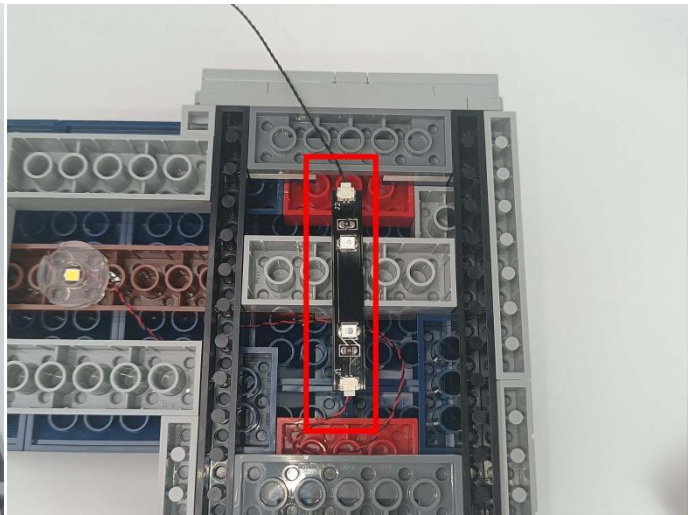
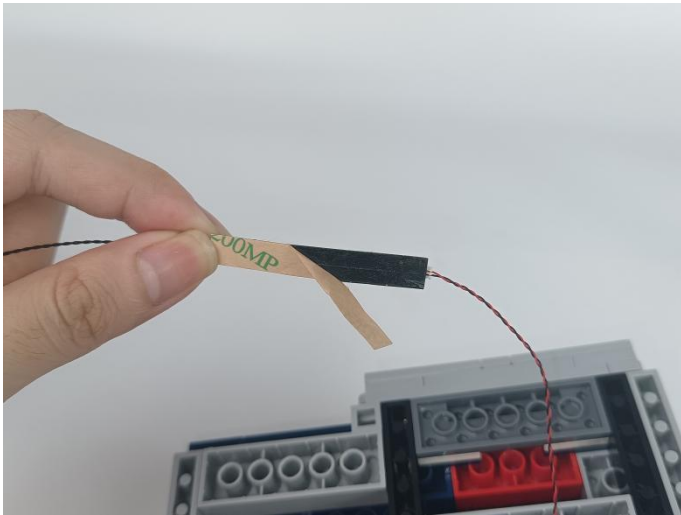

94

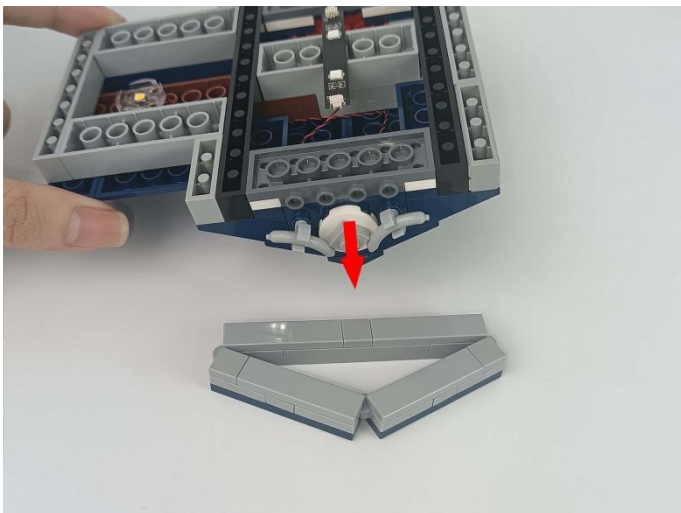

95

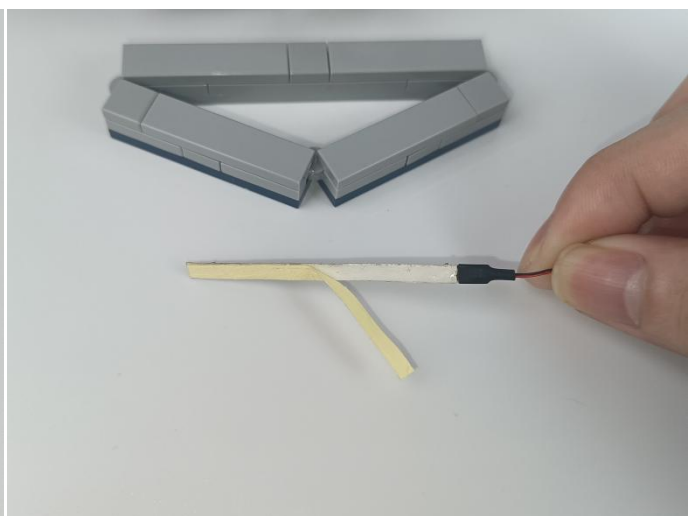

BRICK BLING

96

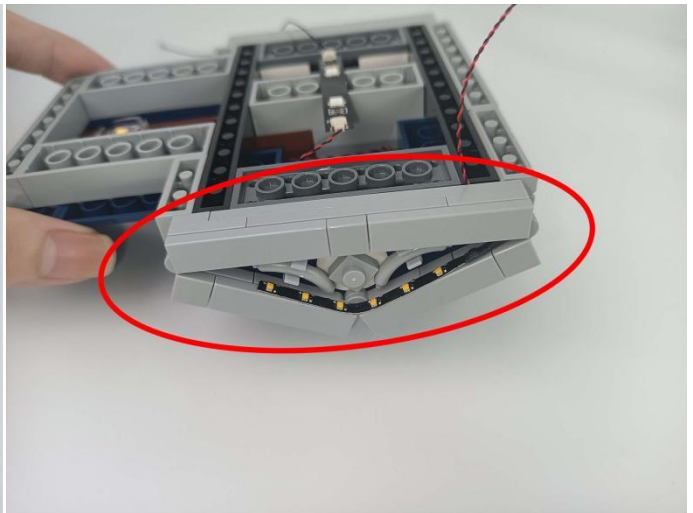
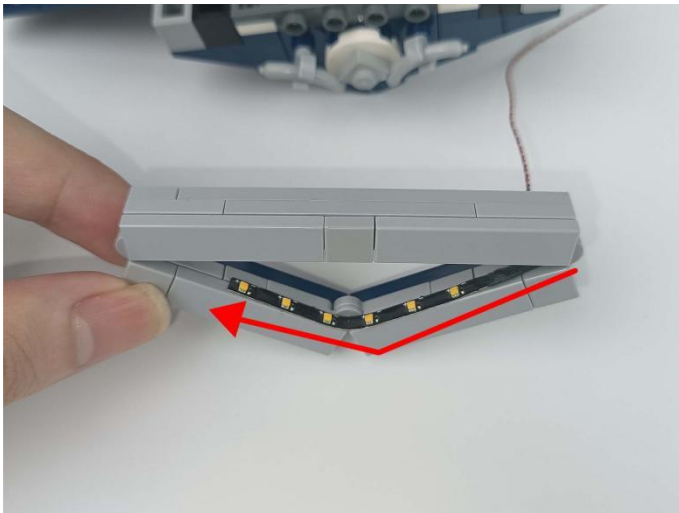

97



98

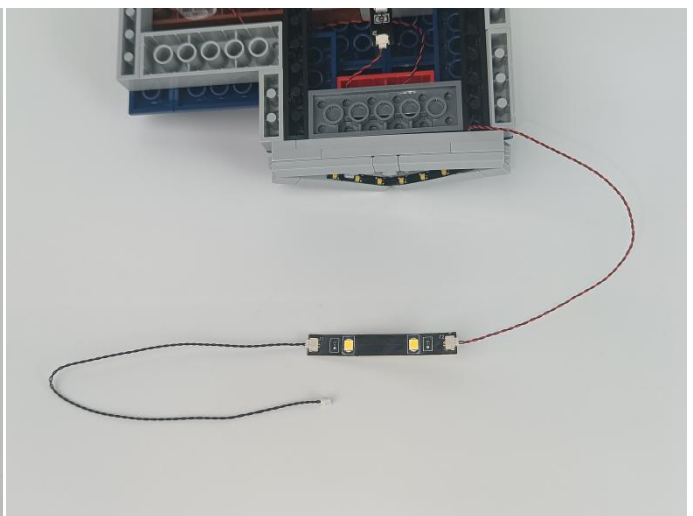

BRICK BLING

99

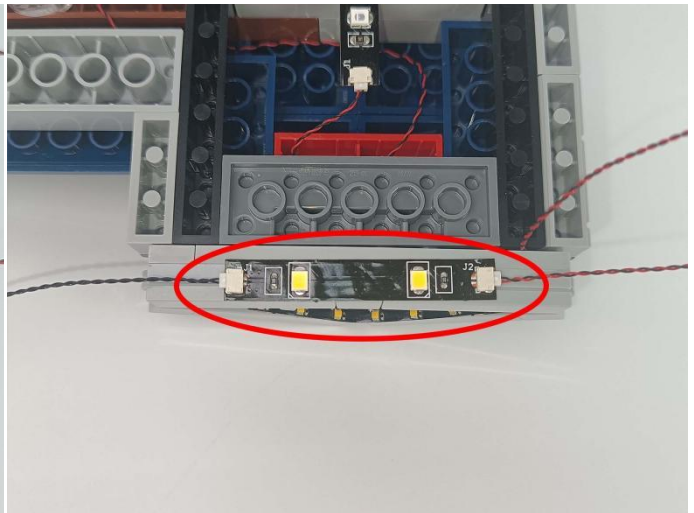
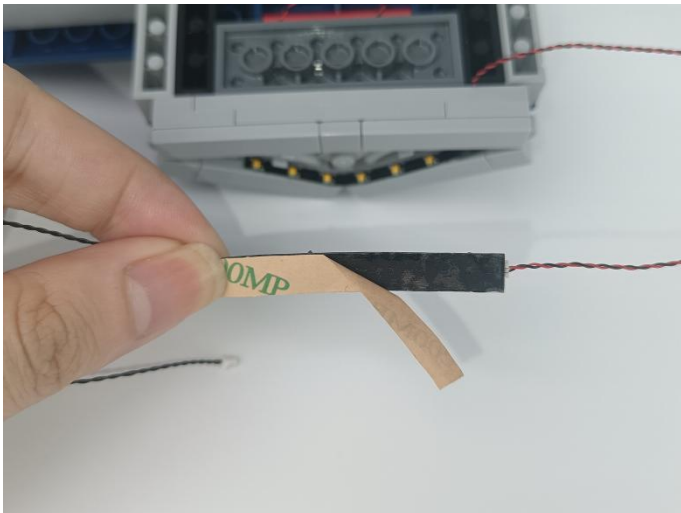

100

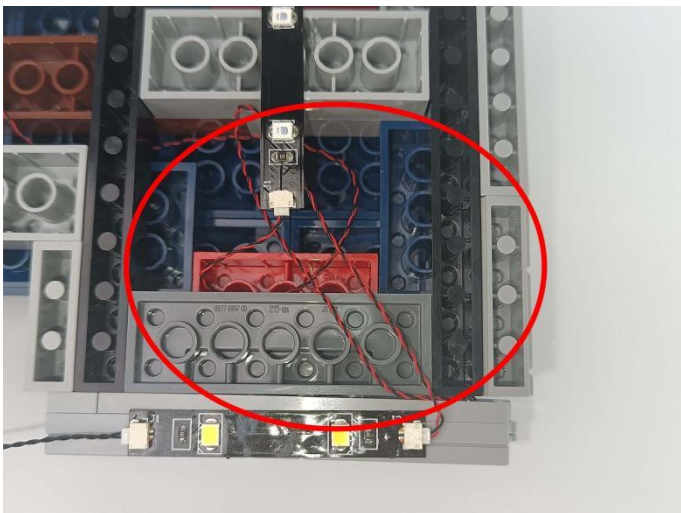

101

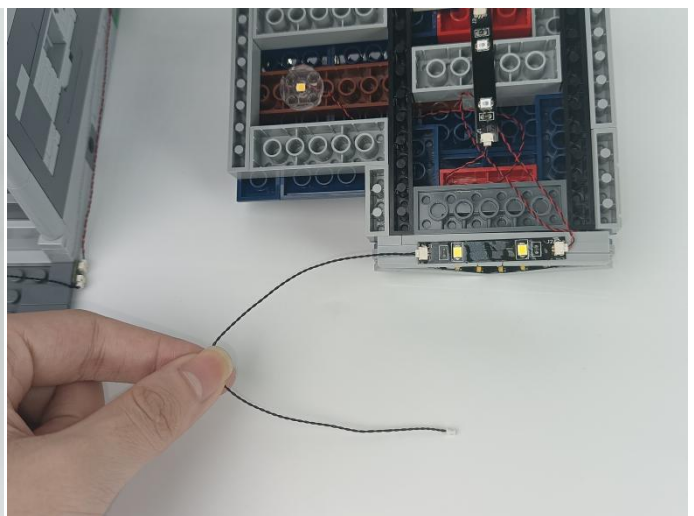
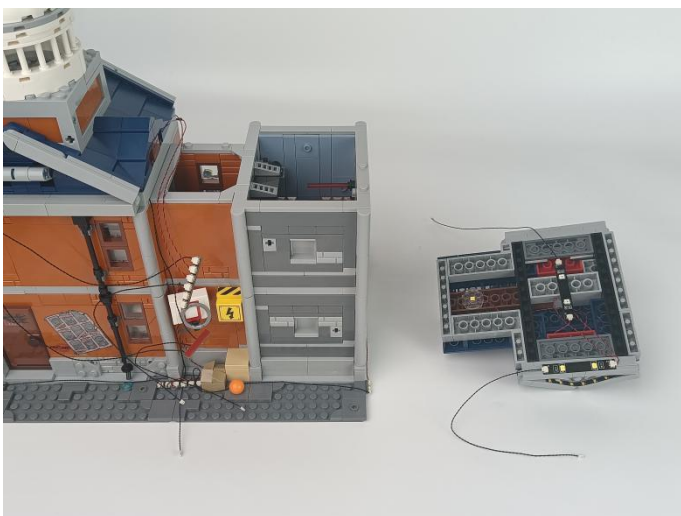

BRICK BLING

102

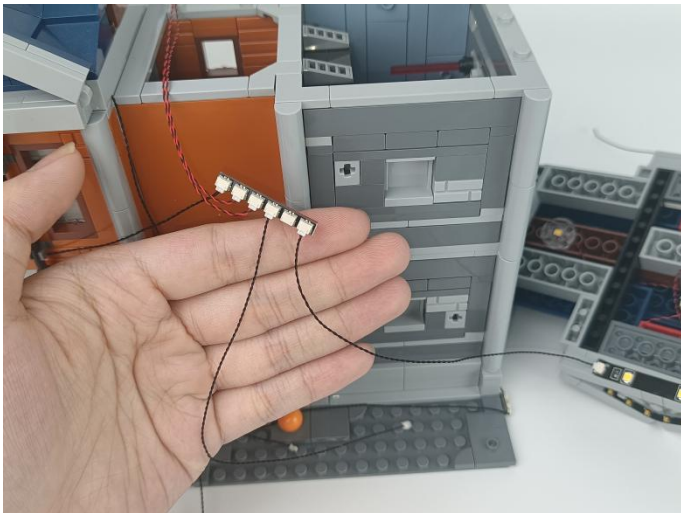

103

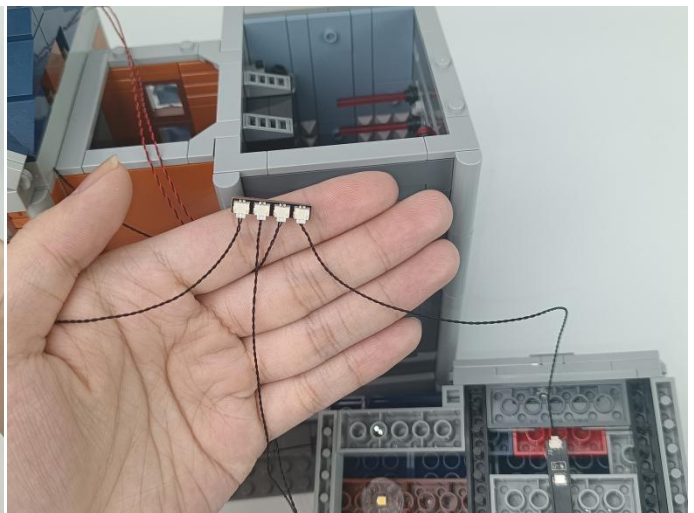
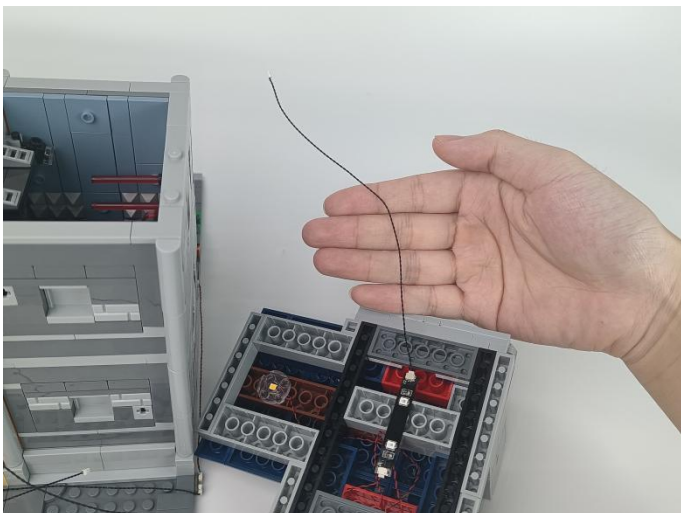

104

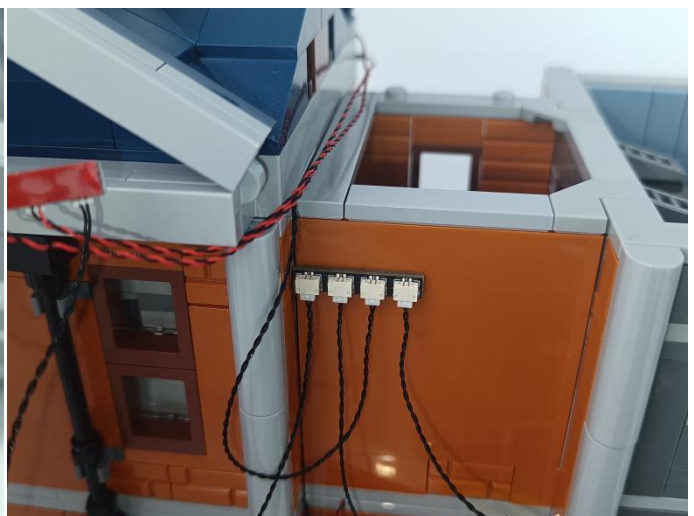
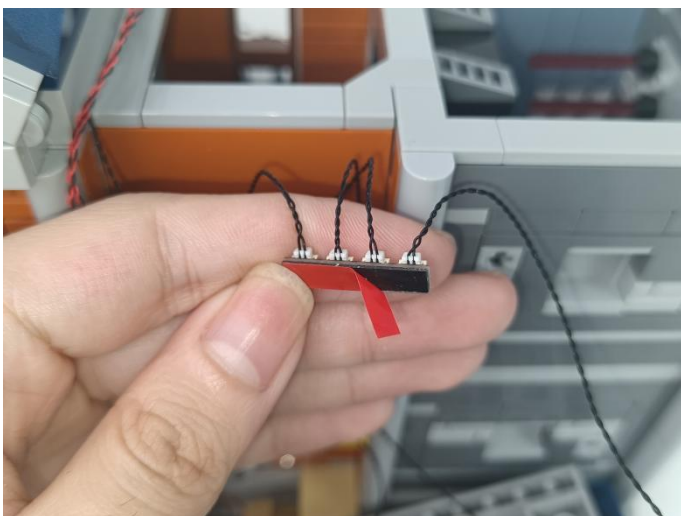

BRICK BLING

105

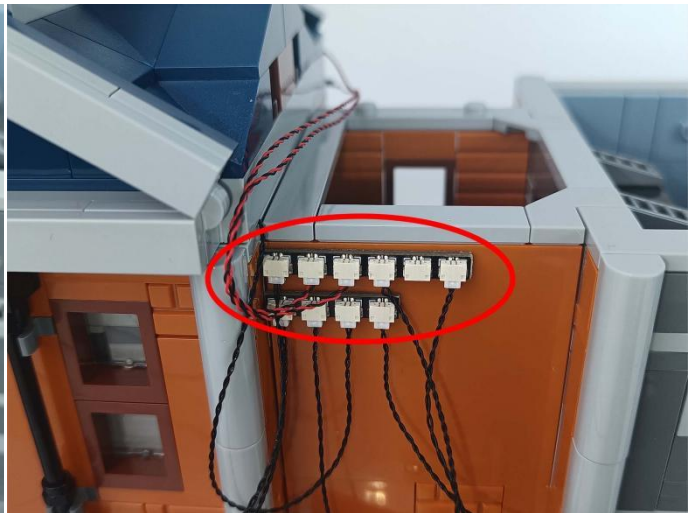
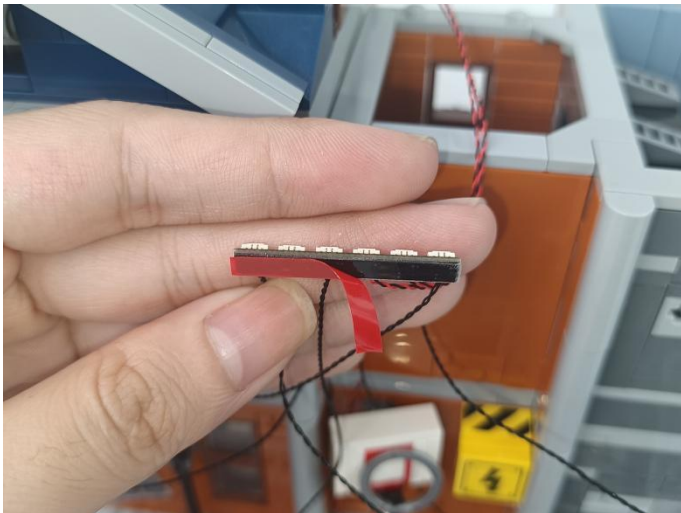

106

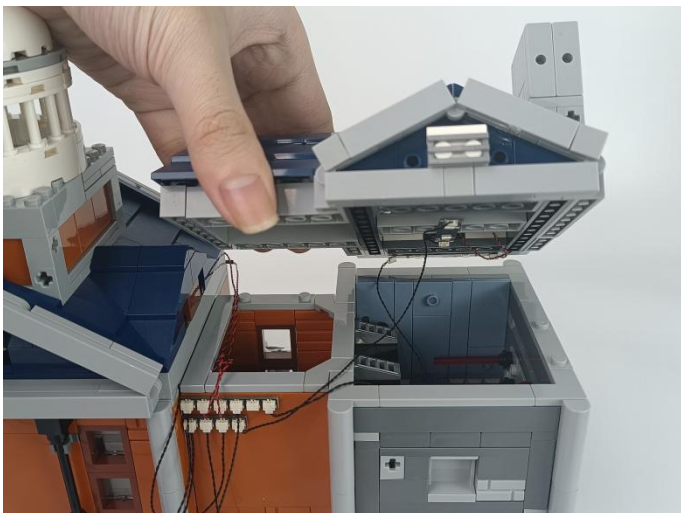

107

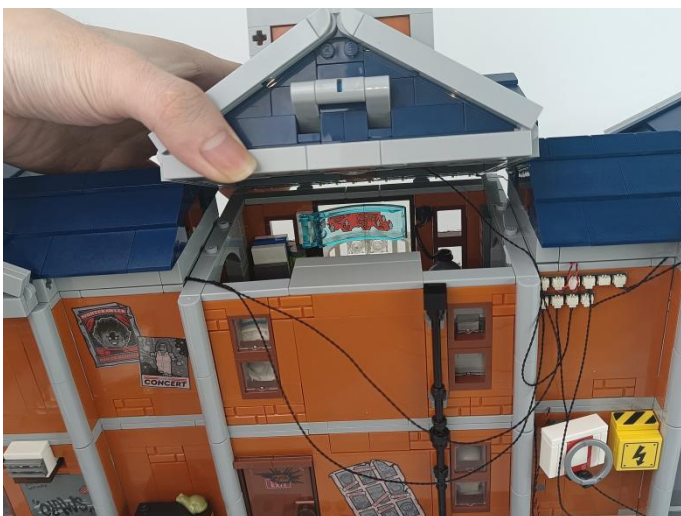

BRICK BLING

108



109

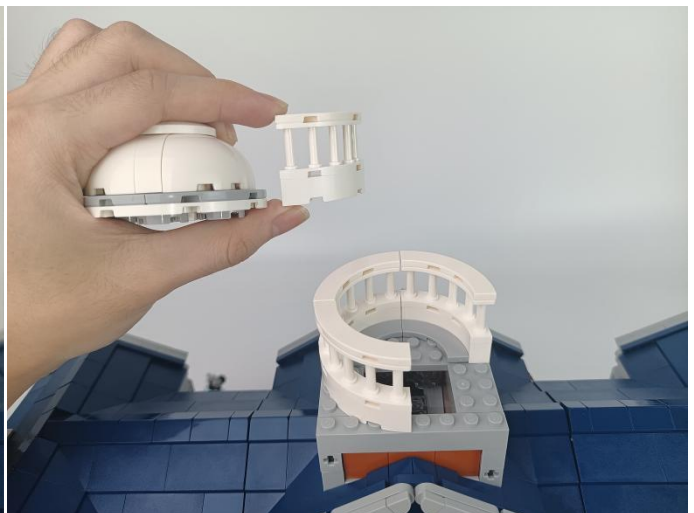

110



111

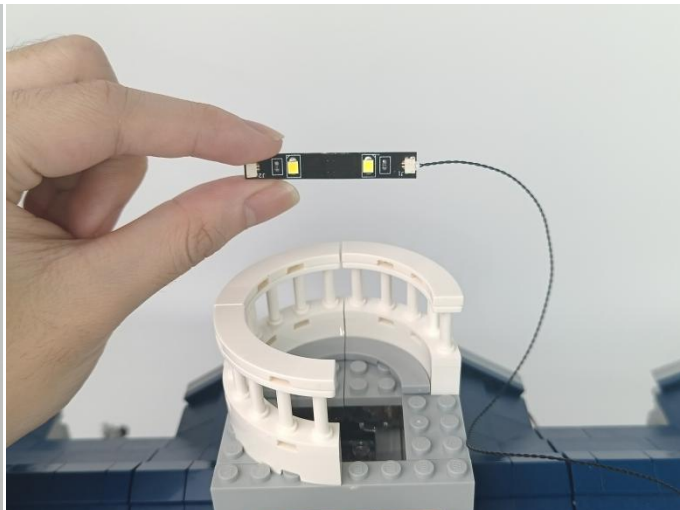

112

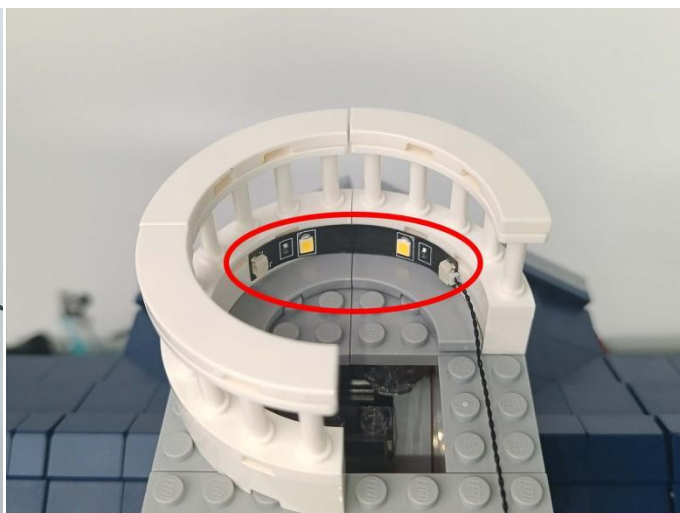
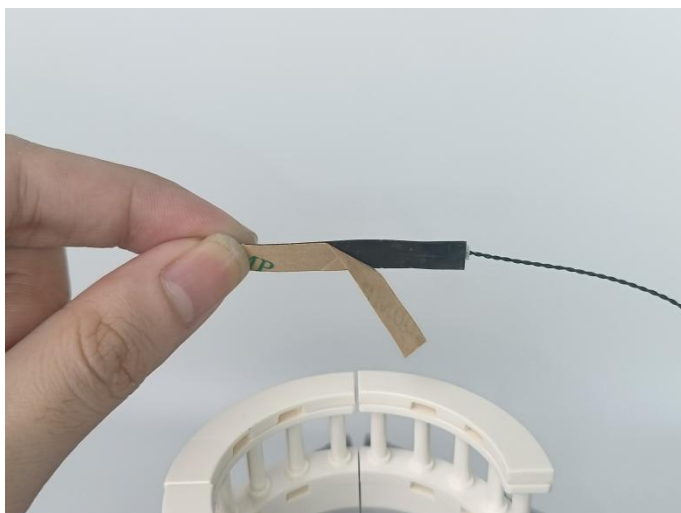

113

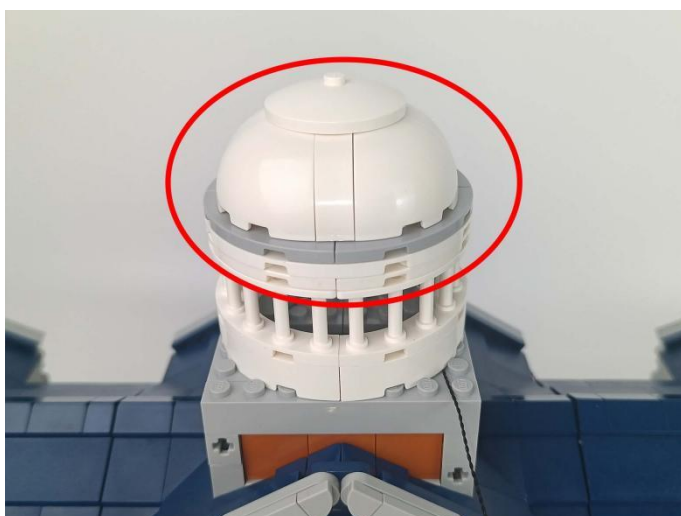

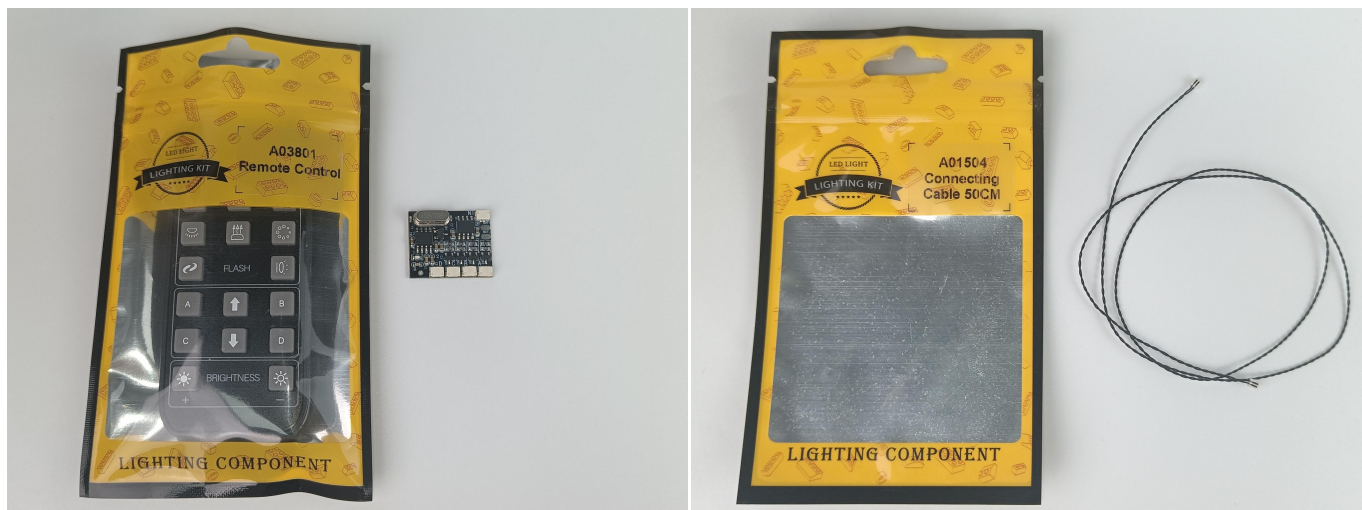

Remote Control Function Introduce

BRICK BLING

ON: All lights turn on sequentially.
OFF: All lights are off.

: A, B, C, D are turned on slowly in sequence.

: Breathing light mode.

: A and D the light is on and C and B flash alternately.

: A the light is on, B, C, D flow light effect I.

: A the light is on, B, C, D flow light effect II.

: Quickly open from A to D in turn.

: A, B, C, D flow light effect.

: A, B, C, D flash alternately.



A: Turn A on/off.

B: Turn B on/off.

C: Turn C on/off.

D: Turn D on/off.

↑: Increase frequency.

↓: Decrease frequency.

+: Brightness+: Increases brightness

*****: Brightness+: Increases brightness



The remote control does not contain batteries, please buy a CR2025 or CR2032 button battery in the nearest store and install it in the remote control.

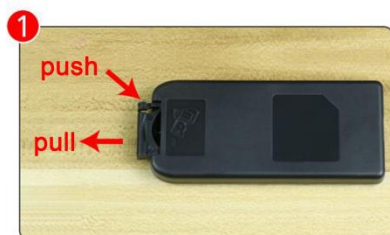

115

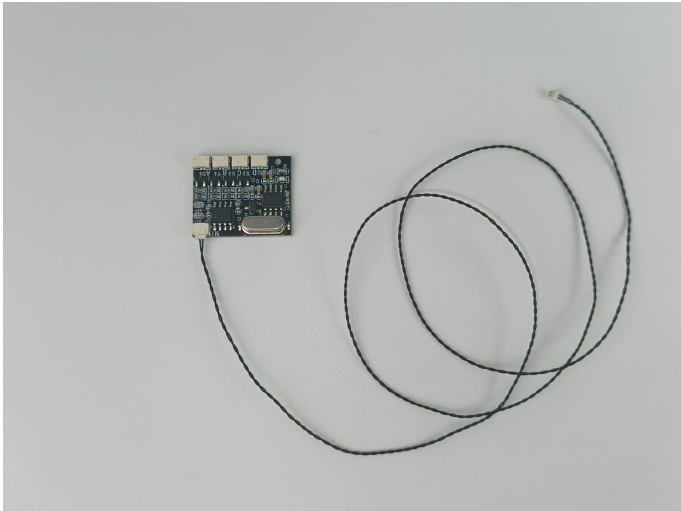

116

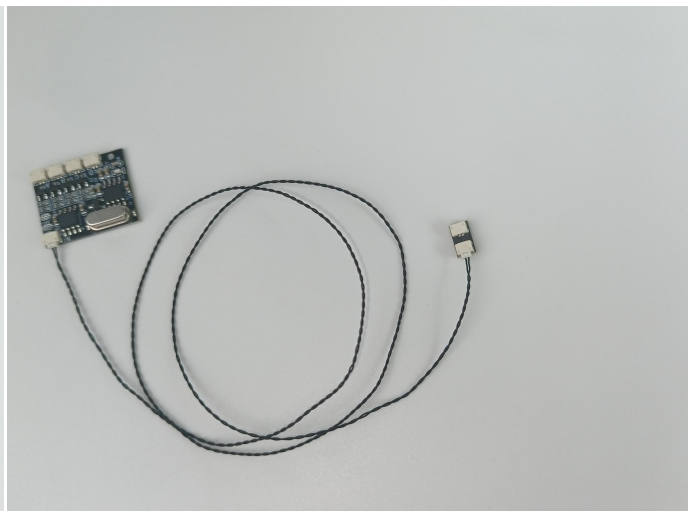

117

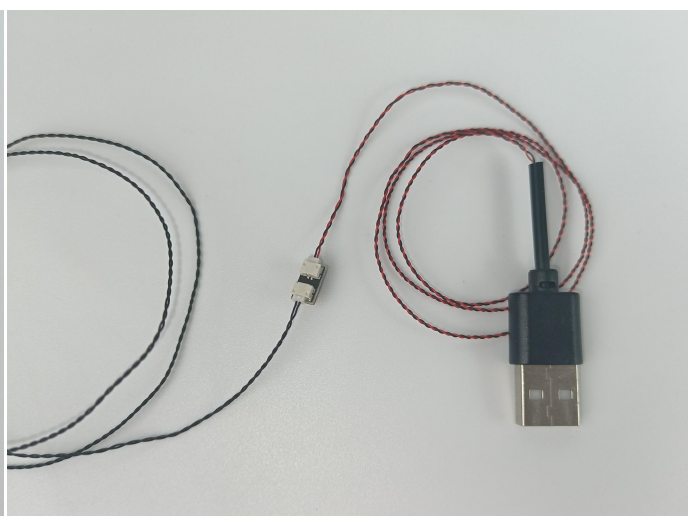

BRICK BLING

118

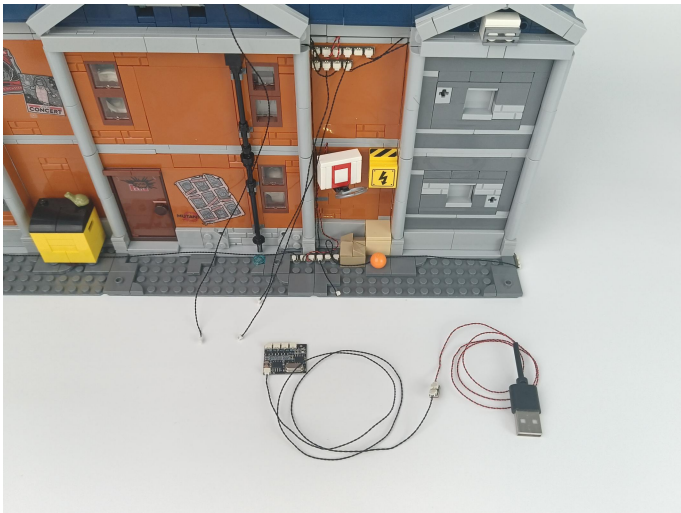

119

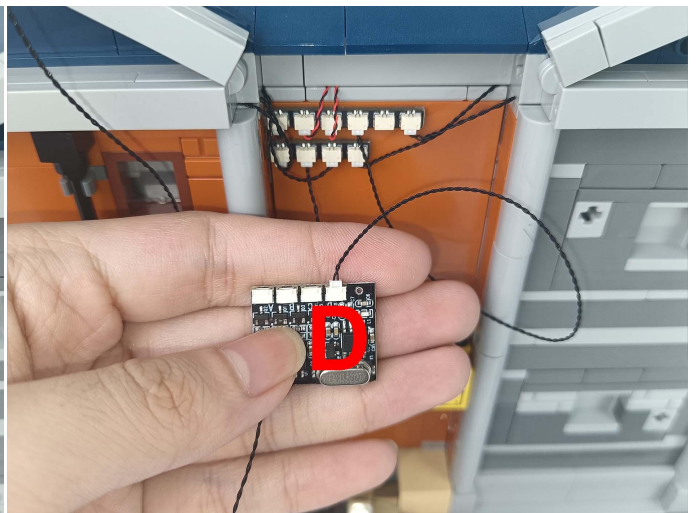
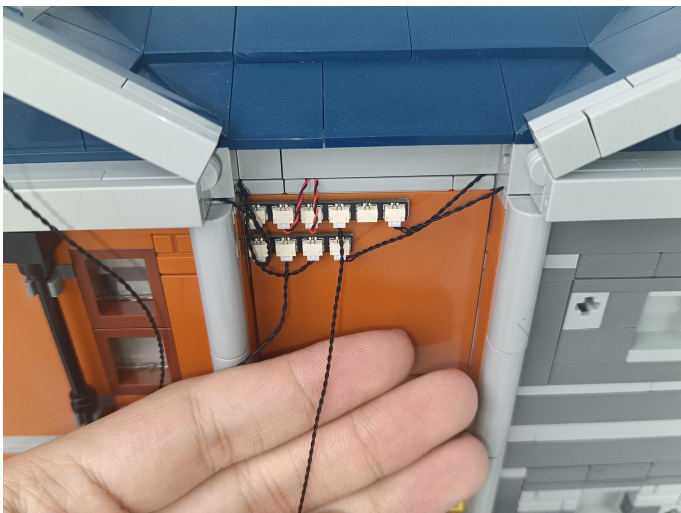

120

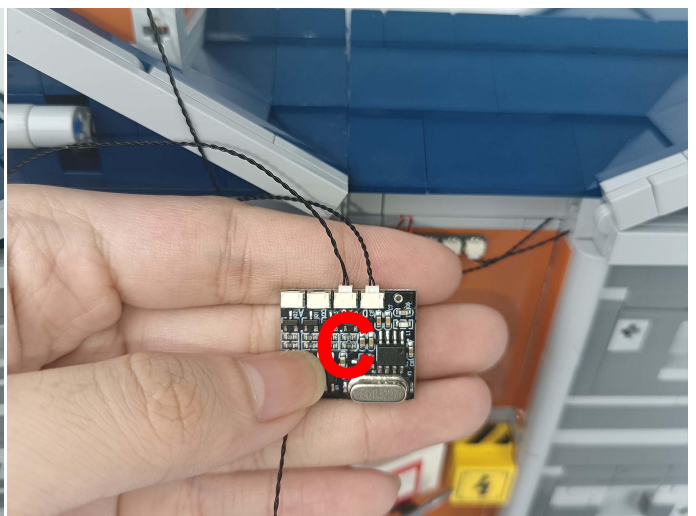
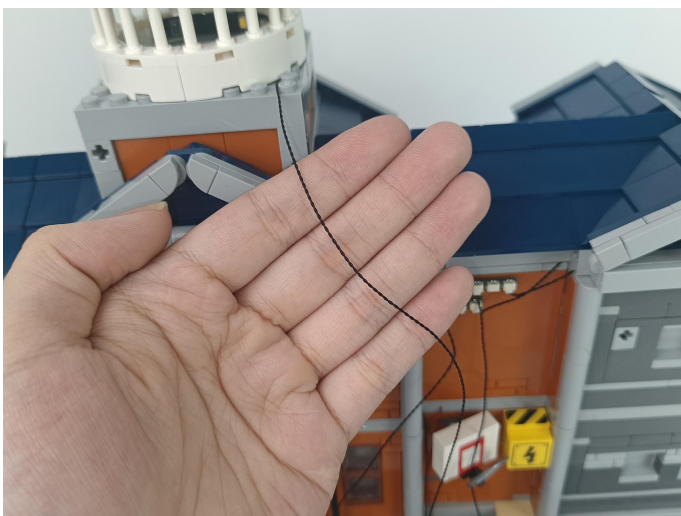

121

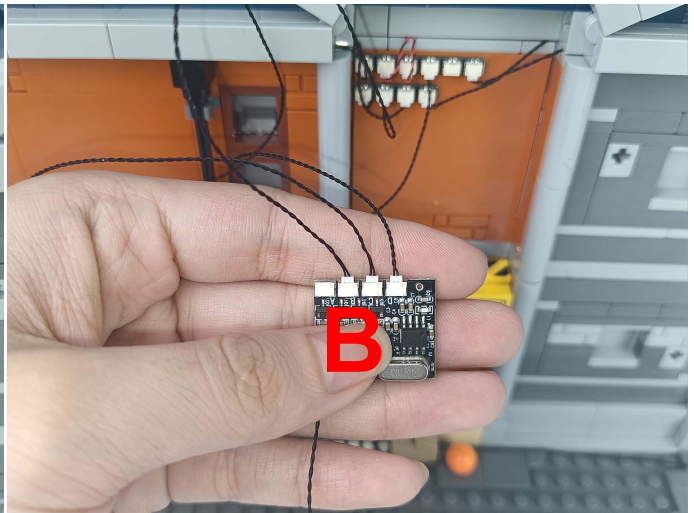
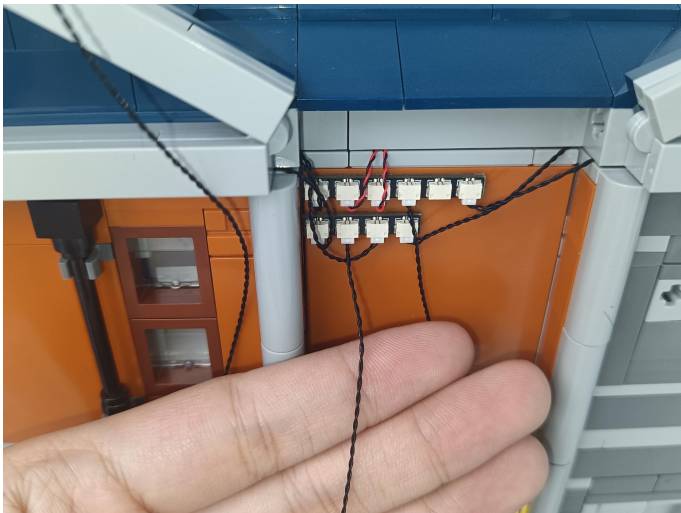

122

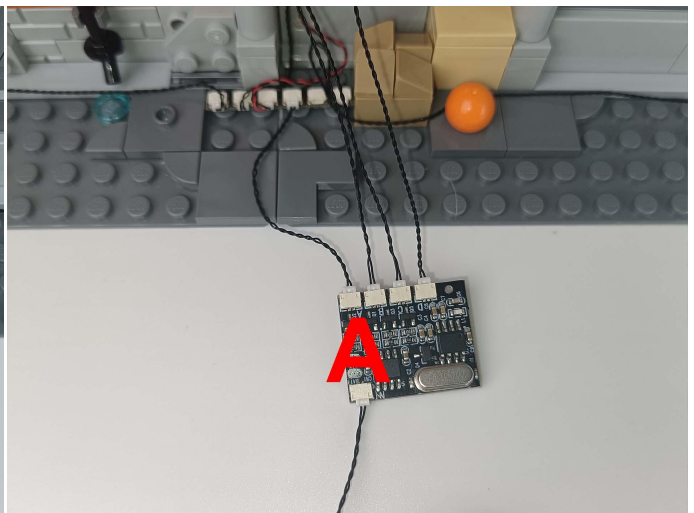
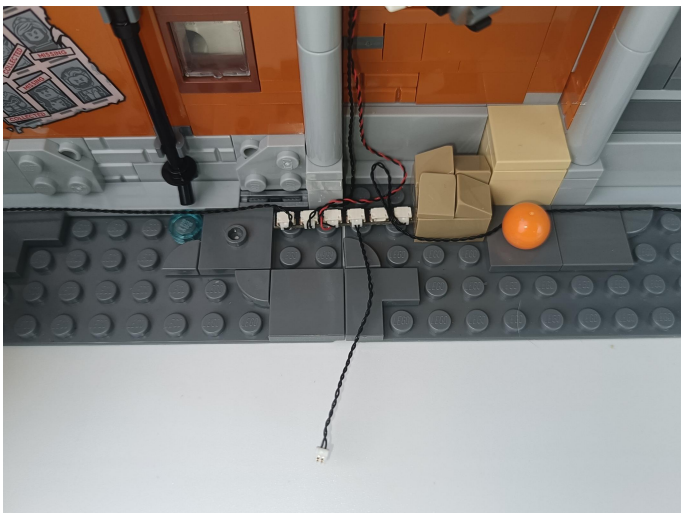

123

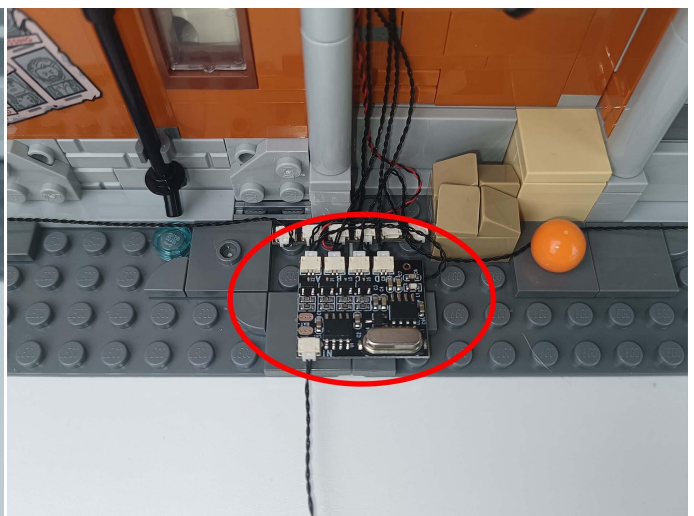
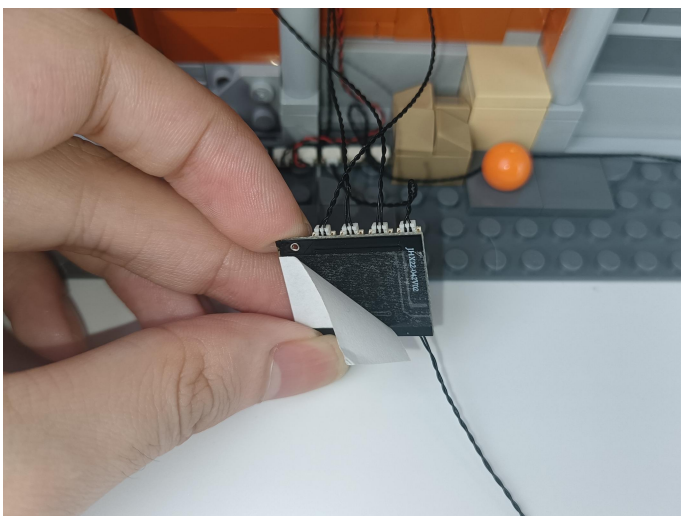

124

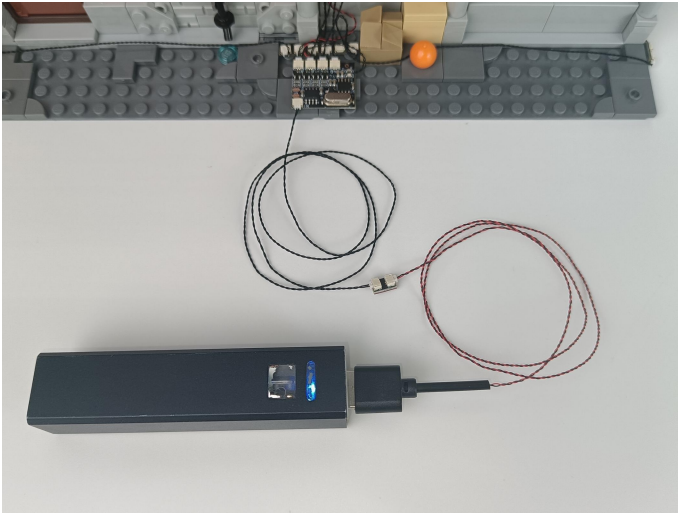

125



126



BRICK BLING

127



128



BRICK BLING

Good job, you've done all the installation steps, power it up and enjoy your work.



The battery box can also power the set. If it is necessary to change the power supply , prepare three AAA batteries, install them in the battery box, turn on the switch on the battery box, remove the plug of the USB Power Cable from the socket of the expansion board,plug the plug of the battery box to the same socket in the expansion board to power the suit as well.

THANKS