

10252 Volkswagen Beetle P38

- P38 is the unique code of lighting set, we use this to accurately identify the product you purchased and the corresponding manuals and services you need to obtain. Please make sure your product code is the same as the label on the back of the box shown “10252 P38”.
- Installation requires a lot of patience and great observation that your LEGO bricks will come alive when you get this finished. The bricks with lighting as below, so make sure you're ready and let's get started.



Strategies for the Installation

This instruction divides three sections to complete the installation of the lighting set.

Section A: Check the type and quantity of components.

The quantity and type of components of each products are different and it needs to be carefully checked to make sure there do have enough material. The type of components is indicated by the label on the bag.

Section B: Test that each components is working properly.

Each components is made individually so it is necessary to test that each components is working properly to avoid the situation that the lighting does not work .

Section C: laying out components following the instruction.

Our material is very small but not fragile, just be reminded that don't to pull the wires too hard. For different people, there may be some installation steps that you can't understand. Please look at the previous and later installation step

Section A: Check the type and quantity of components.

There are 5 bags in this set. The name and quantities of specific components are as shown , please check carefully.

Label	Content	Quantity
Bit Lights-15CM-Warm White	Bit Lights-15CM-Warm White	2
Expansion Board	8 Socket Expansion Board	1
Flat Battery Pack	Flat Battery Pack	1
Bit Lights-30CM-Warm White	Bit Lights-30CM-Warm White	4
Parts package		

Please contact us immediately if there have any missing components.

Section B: Test that each components is working properly.

We need a structure to test all lights, so take out the bag with label “USB Power Cord”and “Expansion Boards”as follows.



It is worth reminding that our products are all customized. They have a unique way of connecting. The white plug on wire and the socket of the expansion board need to be connected together to transmit power.

Note that on one side of the white plug you can see two very small golden wires that should be connected to the two golden needles in socket of the expansion board.shown as blow.

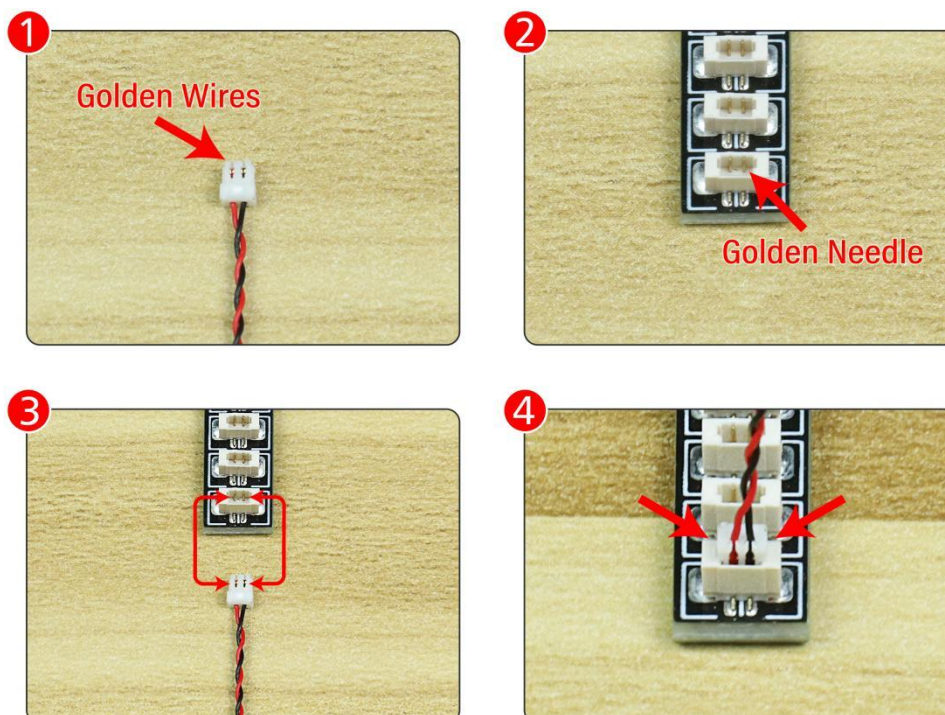

All our connections between plug and socket are all the same as shown above. So for any such structure with plug and socket, please pay attention to the golden wire of the plug and the golden needle of the socket, they must be touched together.

The connection method between the USB Power Cord and Expansion Boards is as follows:

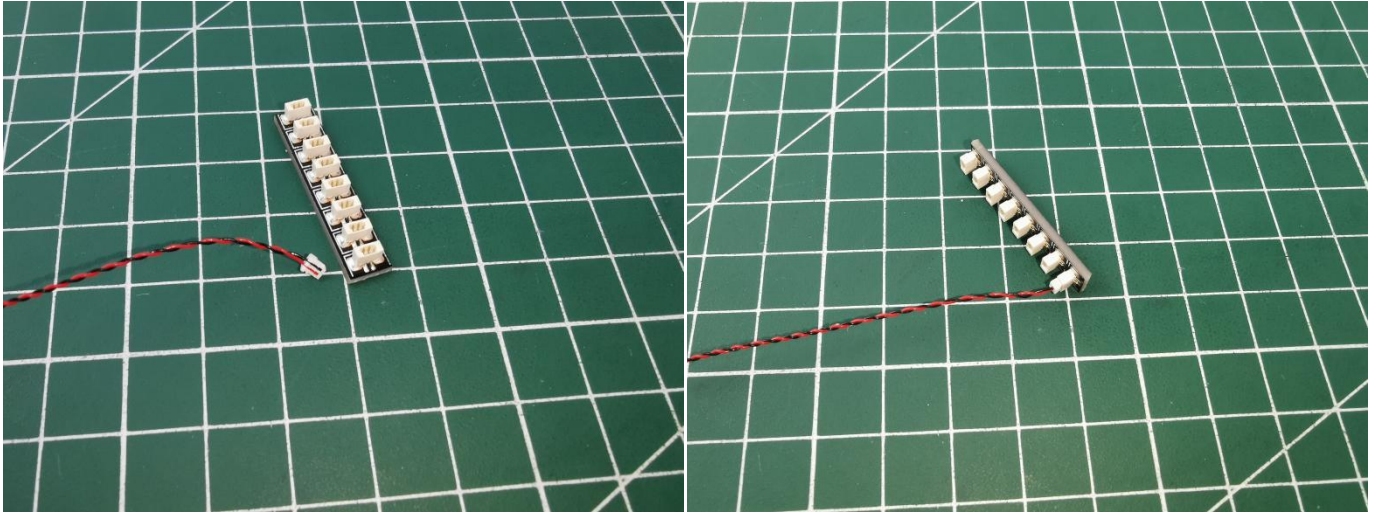

The USB Power Cord can be powered by phone chargers, power banks, etc.

USB connectors to connect devices

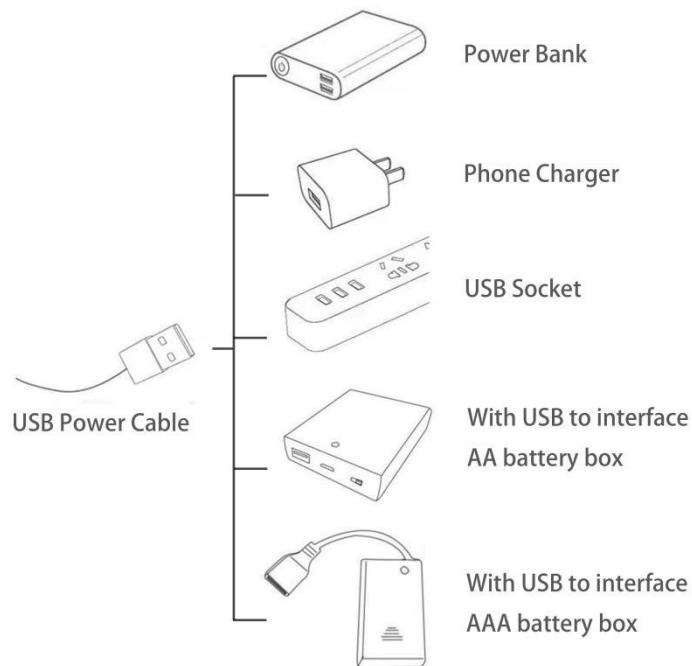

This instruction will use the power bank as power supply . The test structure is shown as follow. All lamp in this set will be tested by this structure.



when we test "Bit Lights-15CM-Warm White" particles,Take out the bag labelled "Bit Lights-15CM-Warm White".Take out one of the light and connect it to the socket. Turn on the power bank, the light will turn on normally as shown below.

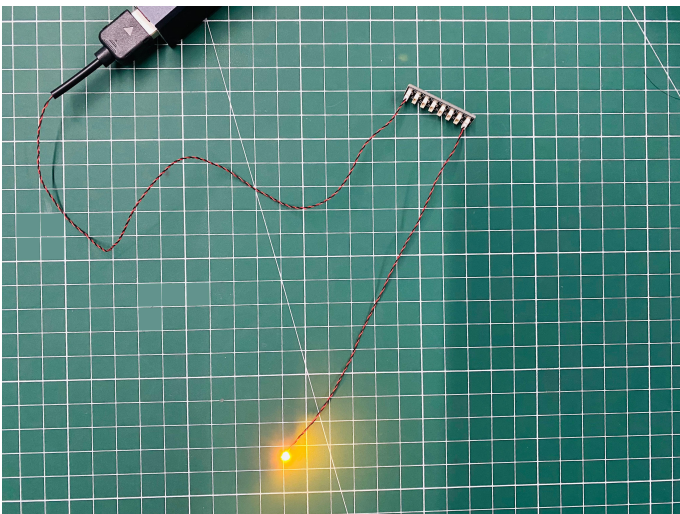

Test each lamp according to this method. It should be noted that after the test, the lamp must be returned to the corresponding bag to avoid confusion of types.



The components needs to be tested in this set is 1*Bit Lights-15CM-Warm White,4*Bit Lights-30CM-Warm White.

Please contact us immediately if any components don't work.

Section C: laying out components following the instruction.

1

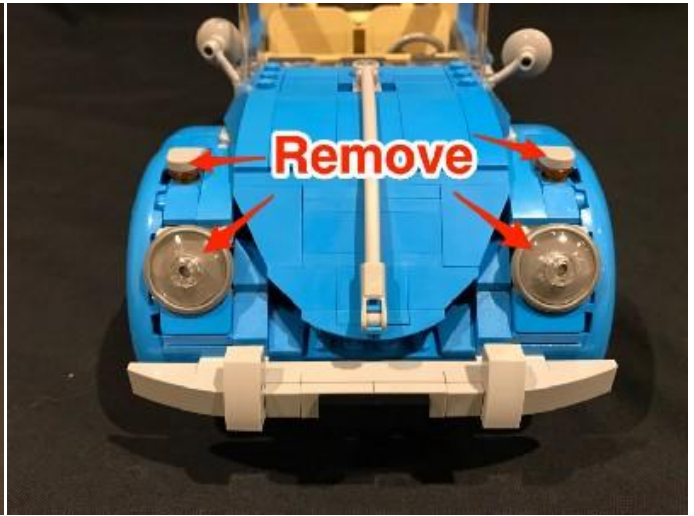

2



3. Take one of the dot lights with 30 cm cable and place the LED component part directly over the stud of the headlight. Ensure it is facing the correct way up and then secure it in place by reconnecting the trans dish piece over the top.

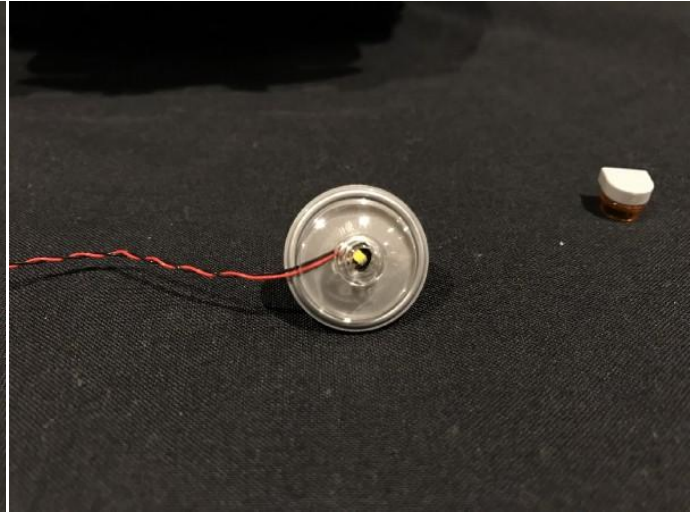
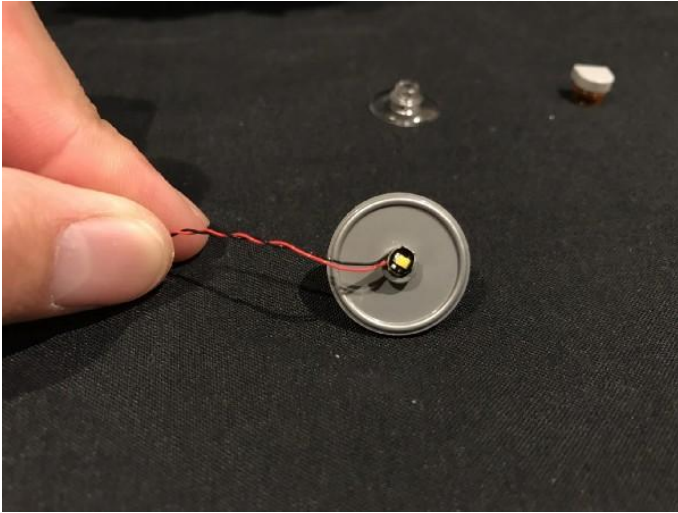

4. Reconnect this section back to the car ensuring the cable is facing inside of the bonnet.

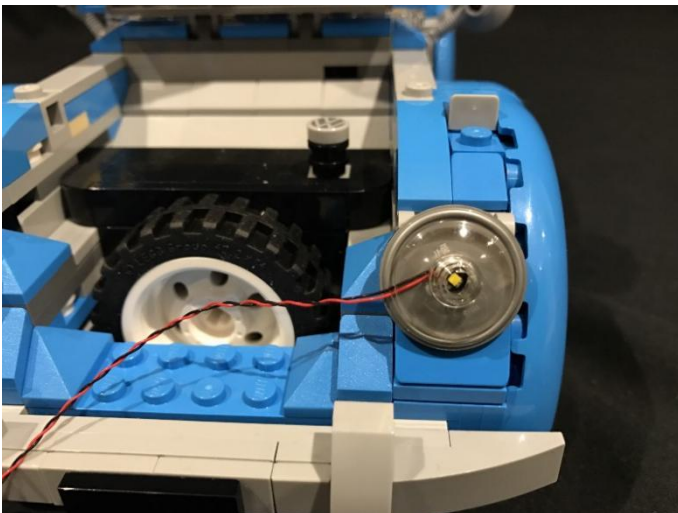

5. Remove the blue piece next to where the indicator light was and then take another dot light with 30cm cable and place it directly over the blue stud as per below.

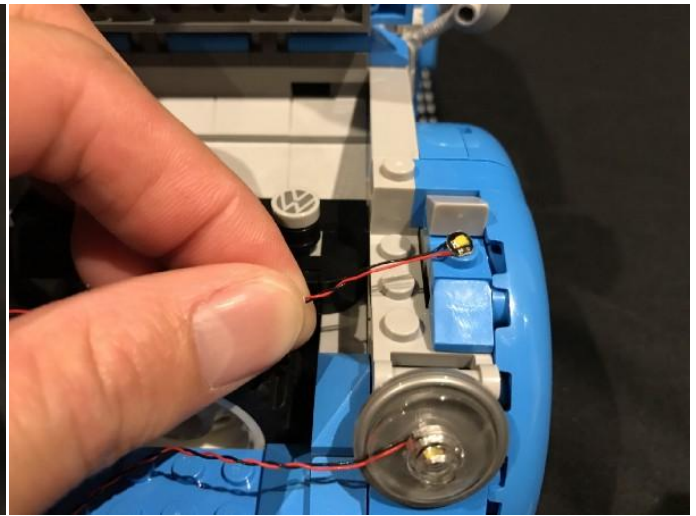
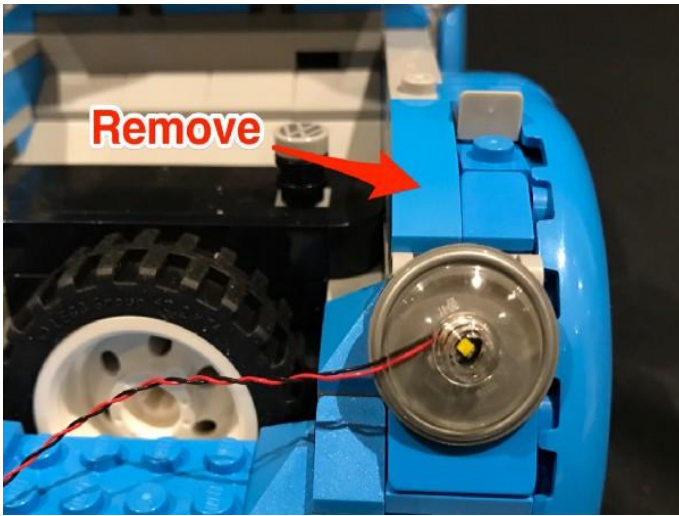

6. Secure the dot light in place by reconnecting the indicator light piece directly over the top, ensuring the cable is facing toward the inside of the bonnet. Reconnect the blue piece we removed earlier ensuring the cable underneath is laid in between studs.

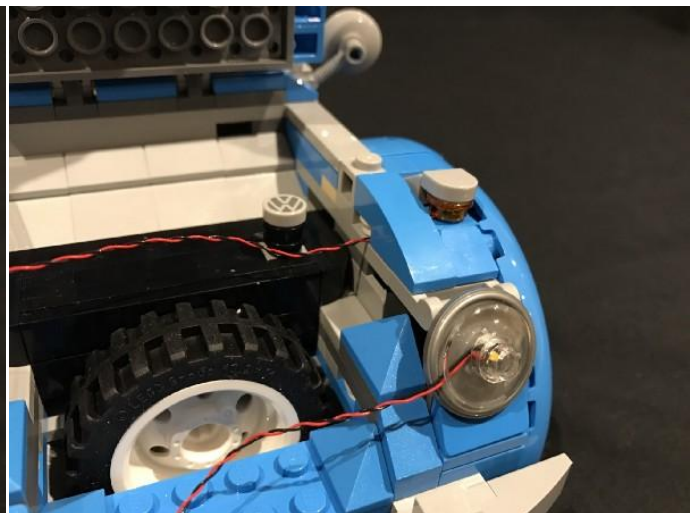
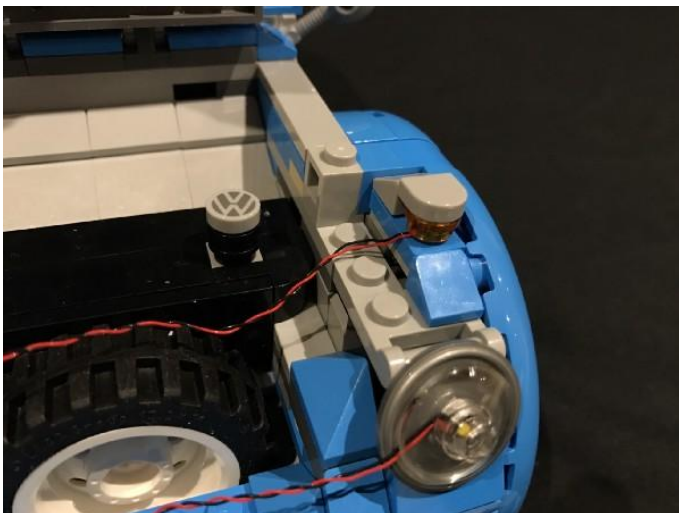

7. Remove the spare tyre from the inside and then thread the 2 cables down underneath the car. Lift the car up and then using one cable at a time, thread the cable through holes of the pieces down towards the back of the car.

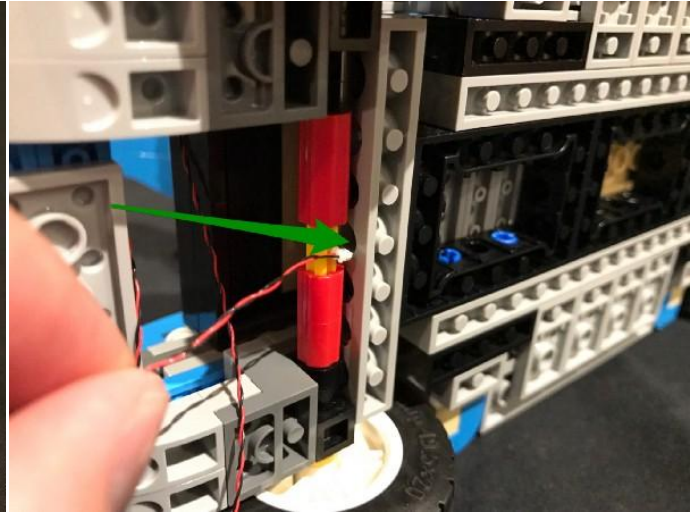
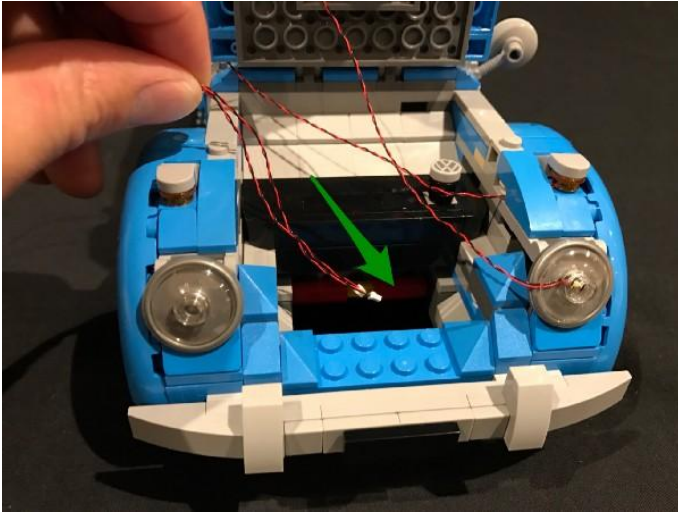

8

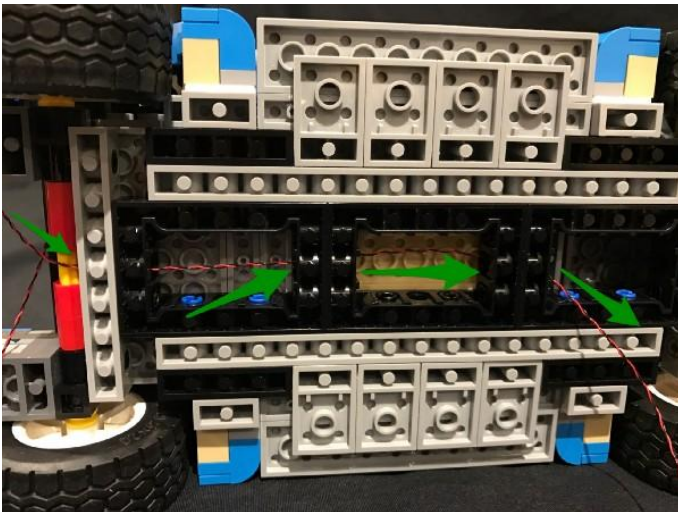

9. Repeat the above process to install another 2 dot lights with 30cm cable to the left section of the front of the car.

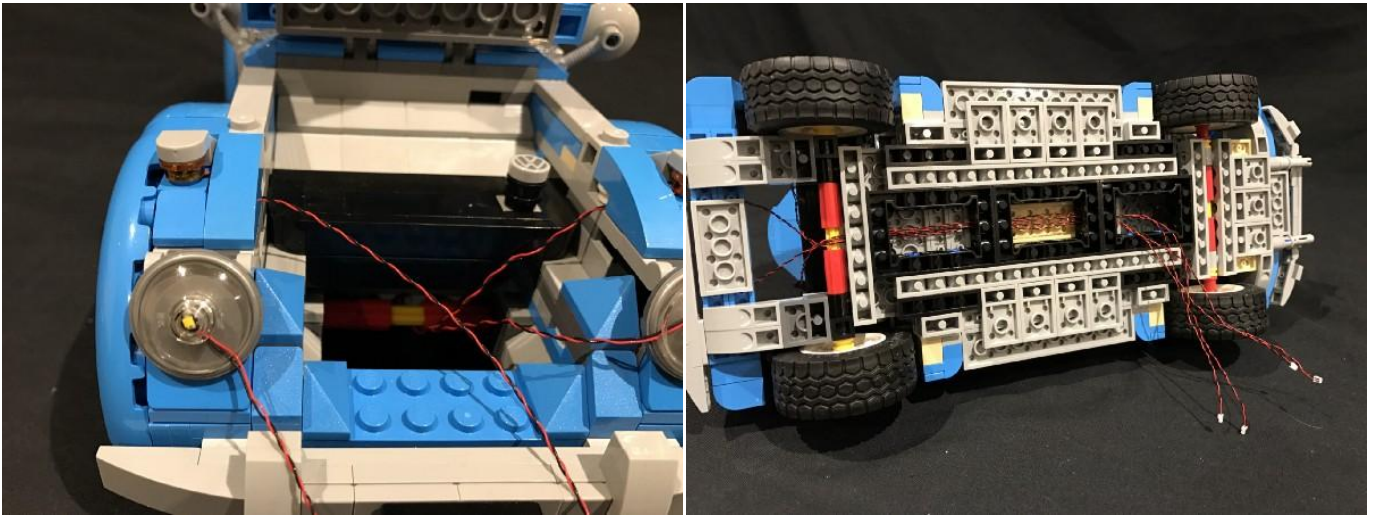

10. Place the tyre back inside and then close the bonnet.

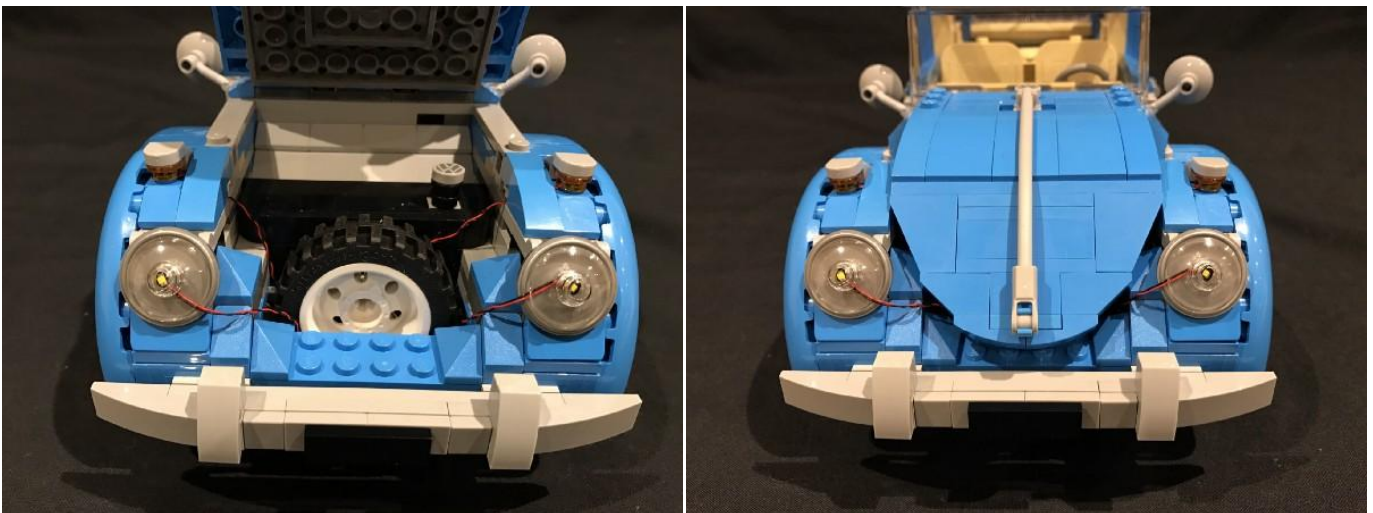

11. Take all 4 cables from underneath of the car and then connect them to the ports on the 8-port expansion board. To eliminate excess cables, wind the cables around the expansion board.

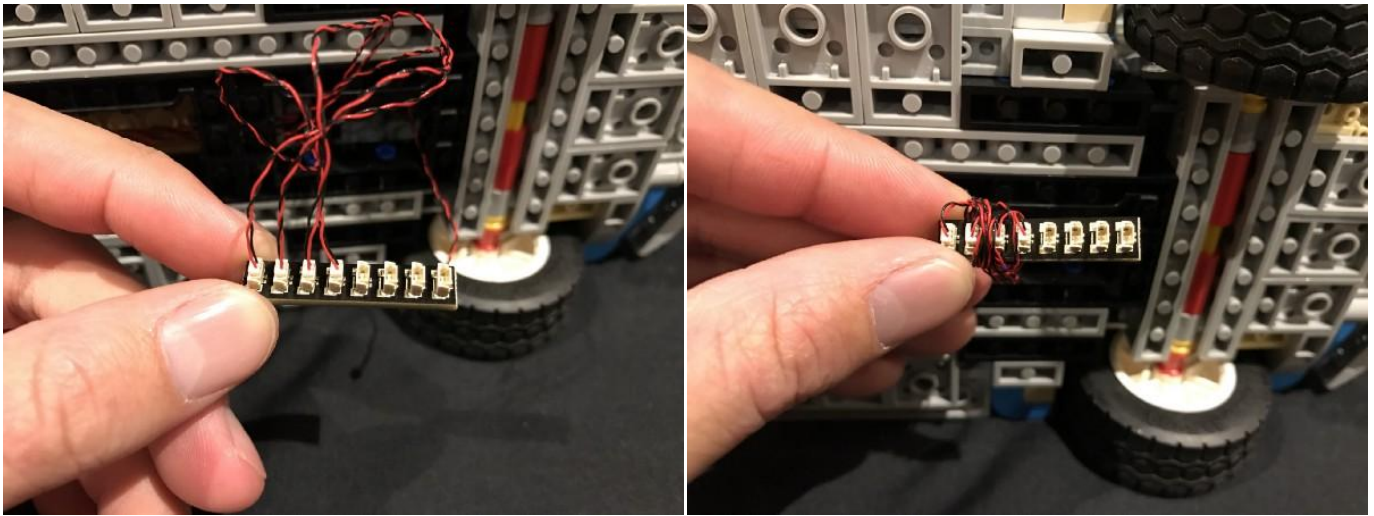

12. We will now install the tail lights.

Start by removing the wheel, the blue piece on the right of the wheel, followed by the tail light section as per below.

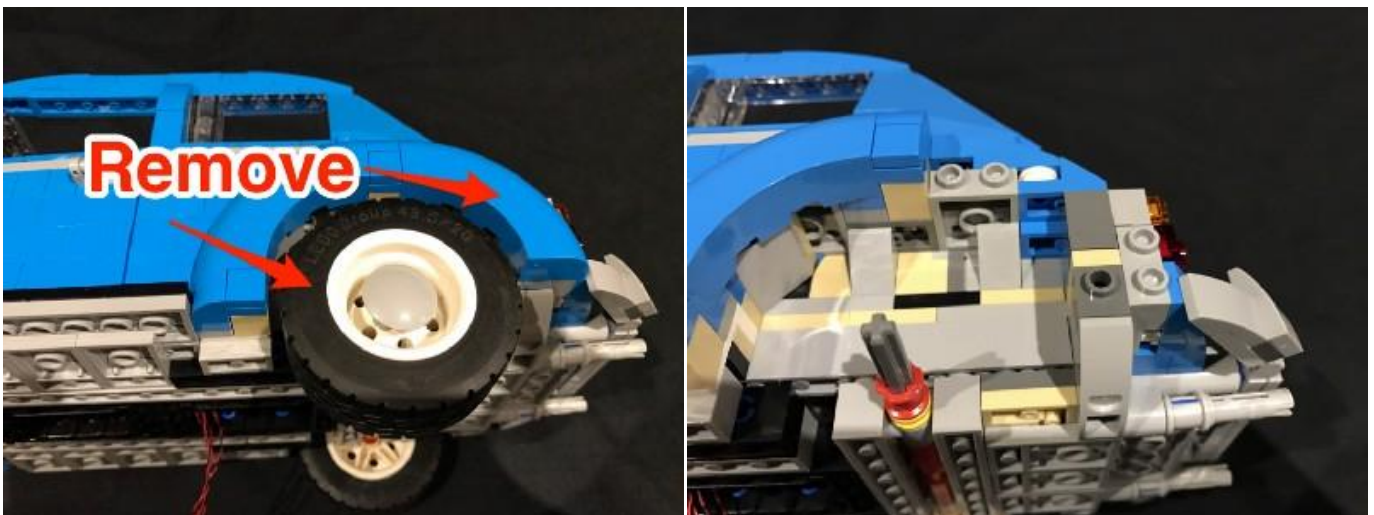

13



14

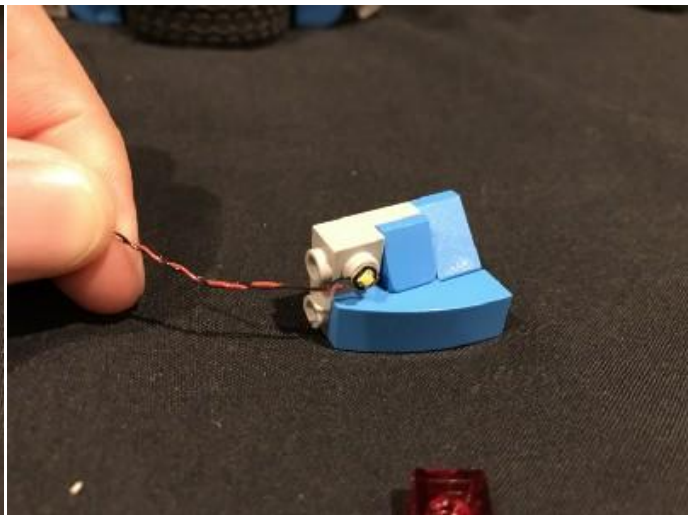
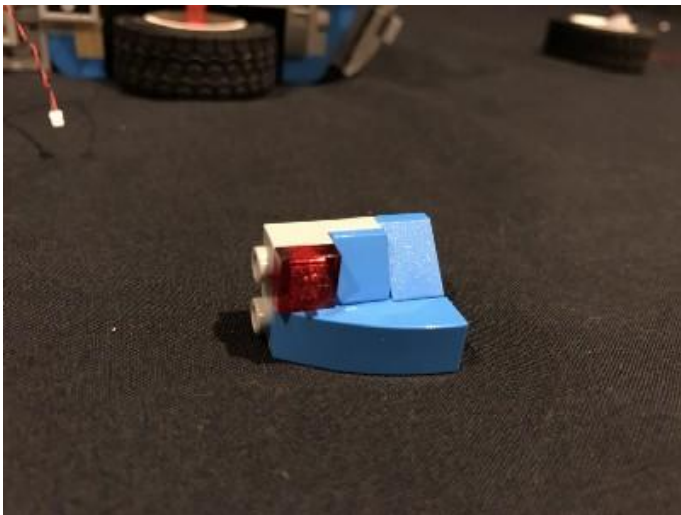

15

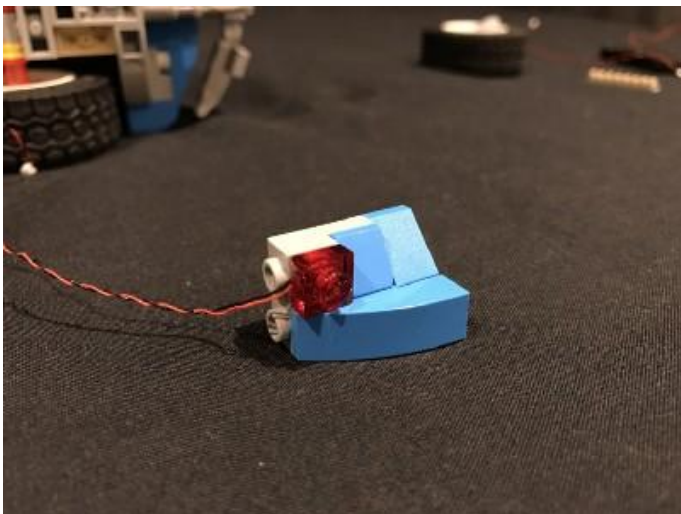

16.Reconnect this tail light section with dot light installed back to the Beetle.

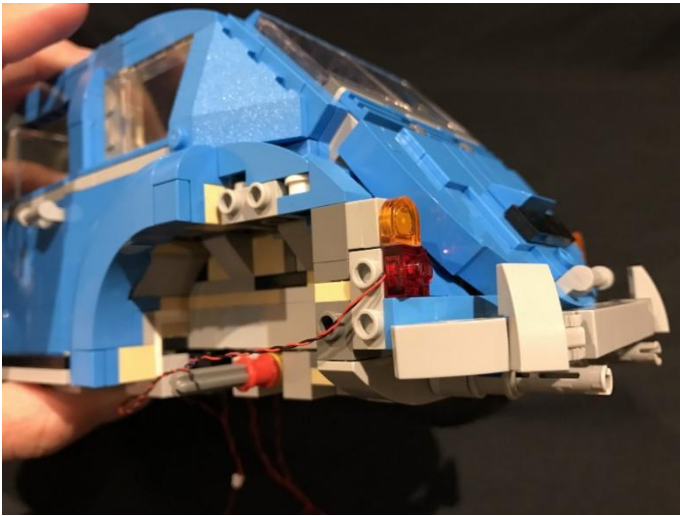

17.Thread the cable across and then inside the spacing between the black and grey bricks. Lift the grey bricks where the wheel axle is and then secure the cable in place by reconnecting the grey bricks back over the top.

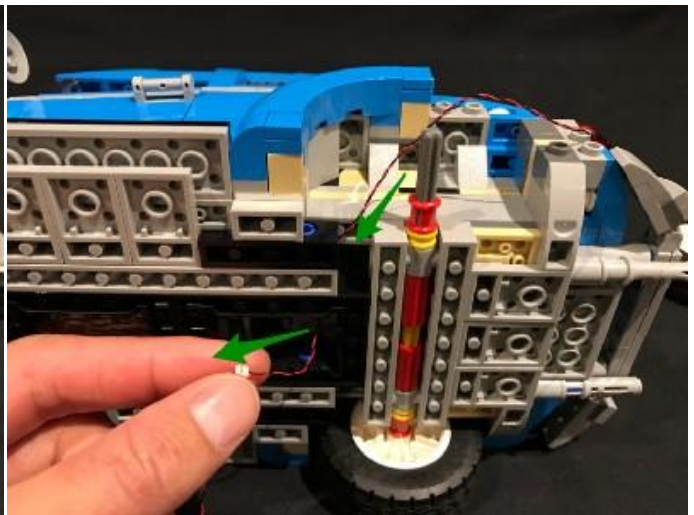
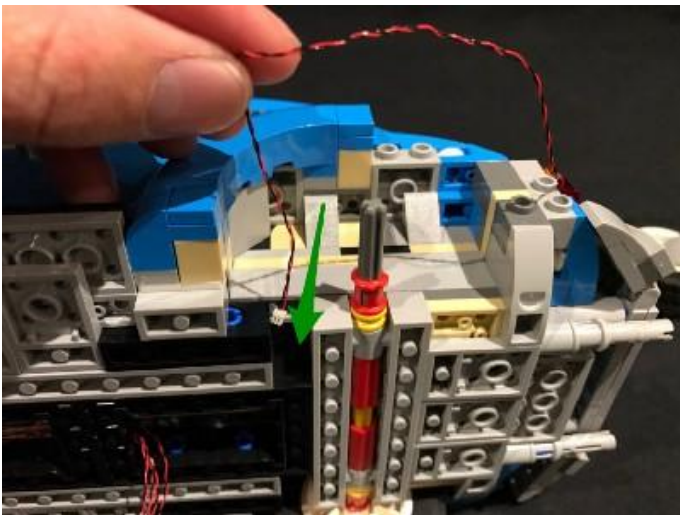

18

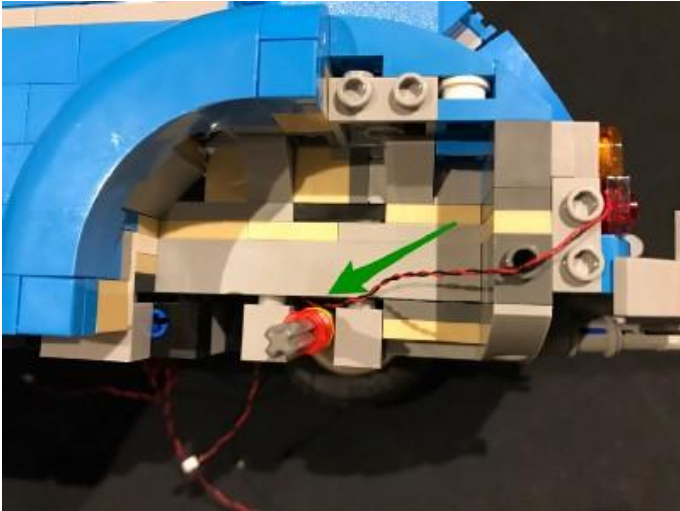

19. Ensure the cable is laid between studs before then reconnecting the wheel and blue piece on the right of the wheel.

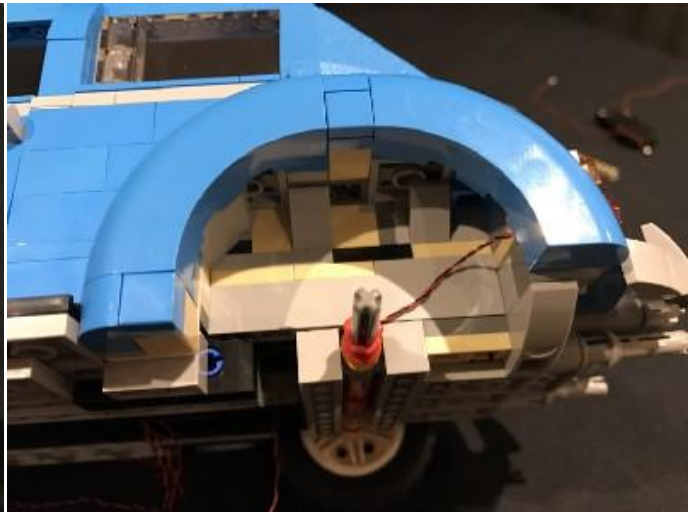
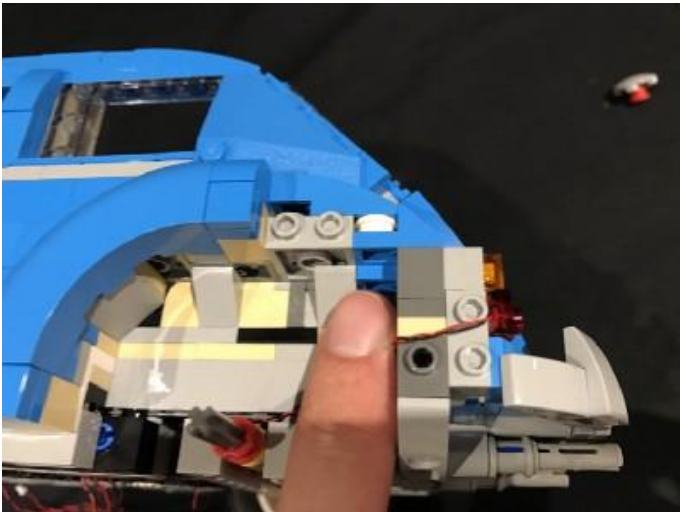

20

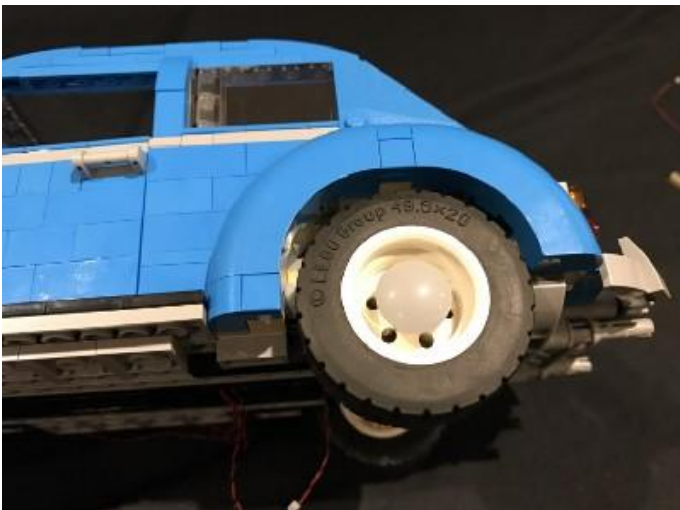

21. Pull the cable from the tail light down from underneath the car and then connect this to the next available port on the expansion board.

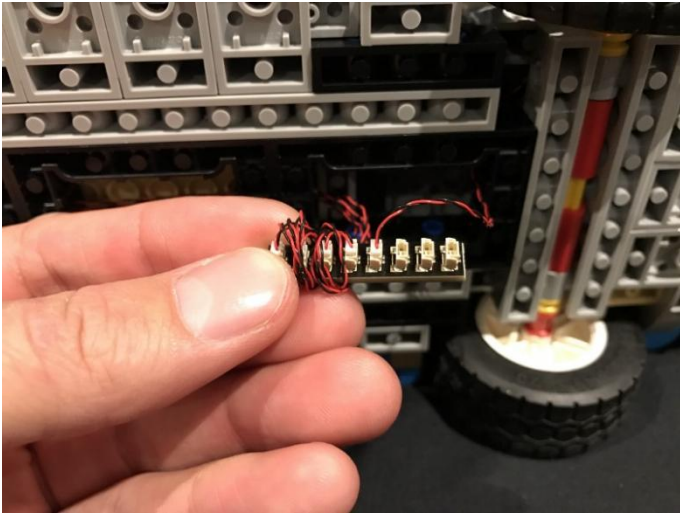

22. Turn the car over and then follow the previous steps to install another dot light to the right tail light.



23

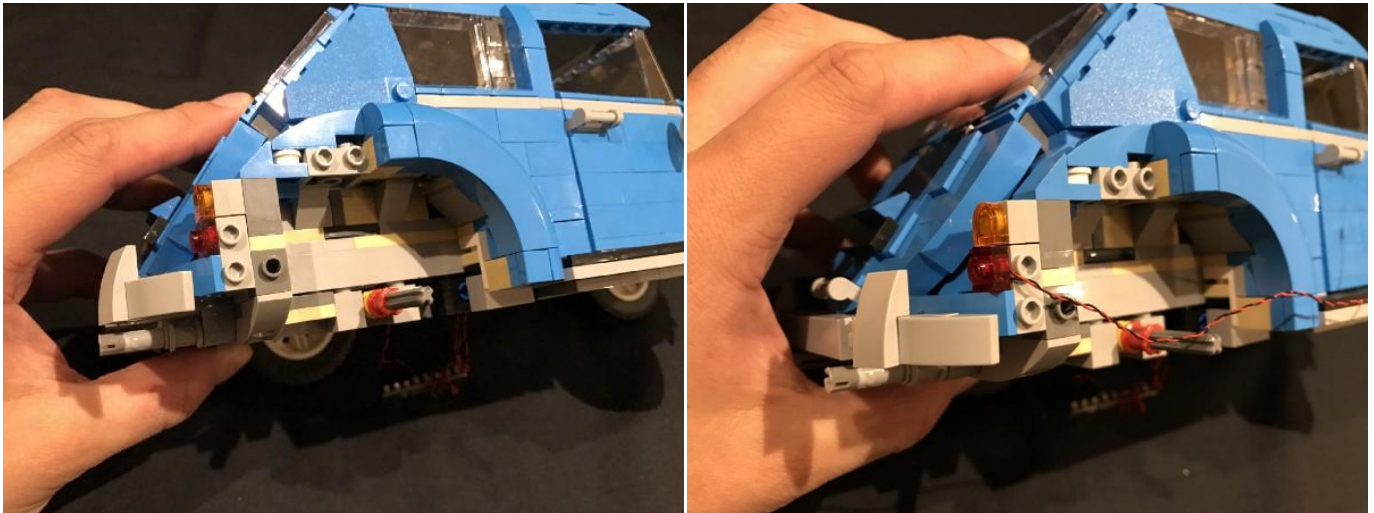

24. Thread the cable underneath the wheel axle like we did for the tail light on the other side, and then connect the cable into the next available port on the expansion board.



25. Before we reconnect the wheel, remove the following pieces which make up the right back door.

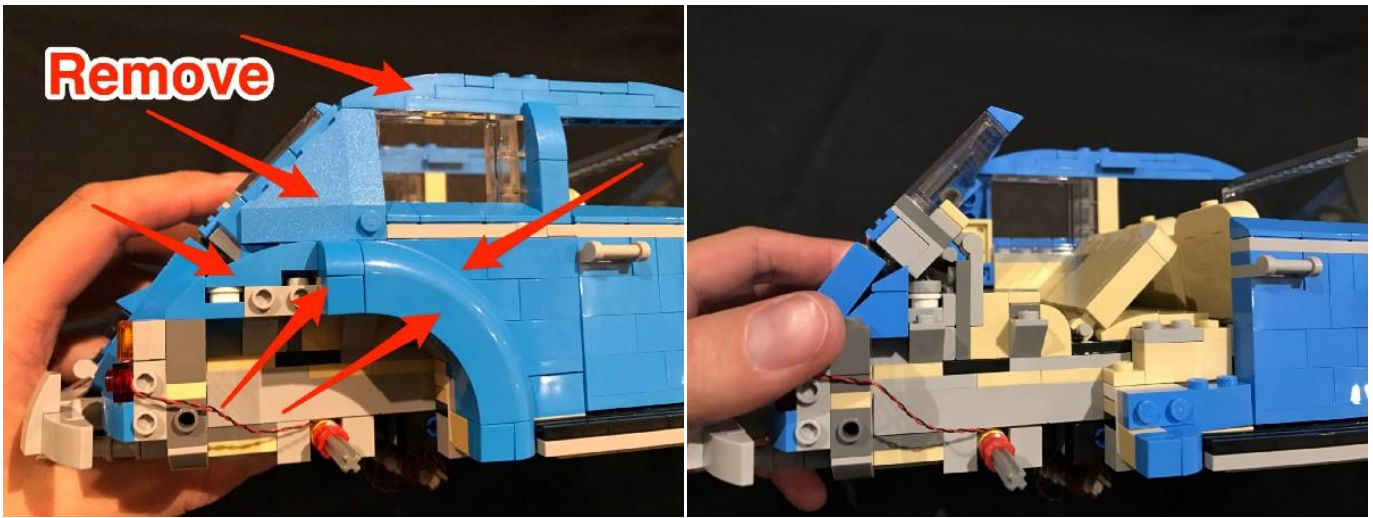

26. Take the flat battery pack and insert 2x CR2032 batteries to it. Place it behind the back seat in the following position, with the cable facing the same way.

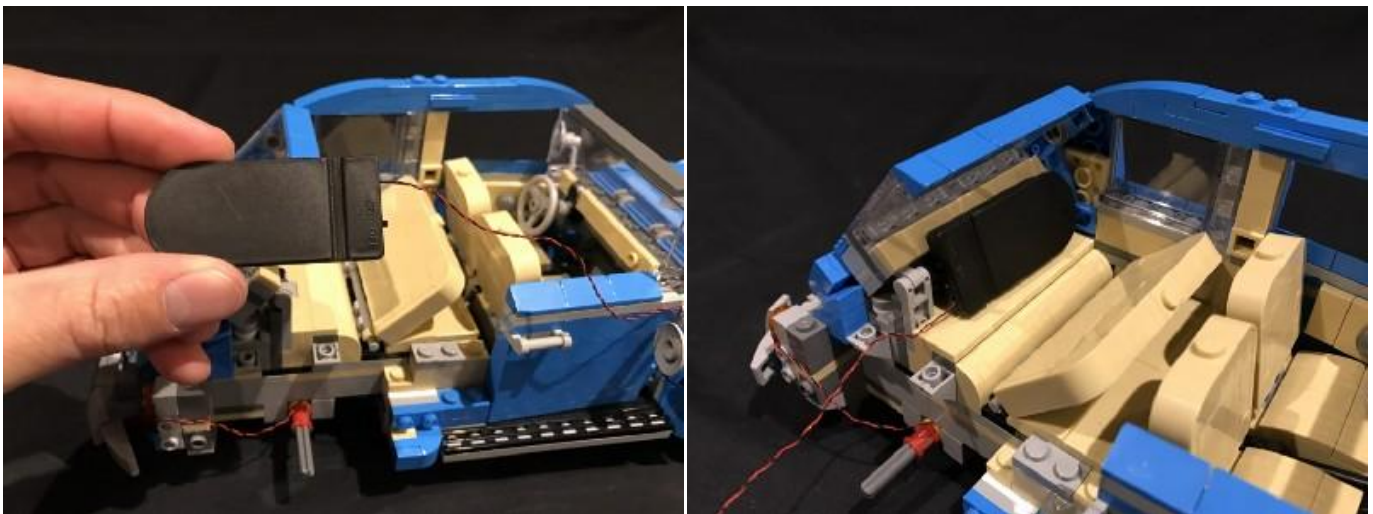

The flat battery pack does not contain batteries, please buy a 2025 or 2032 button battery in the nearest store and install it in the flat battery pack.

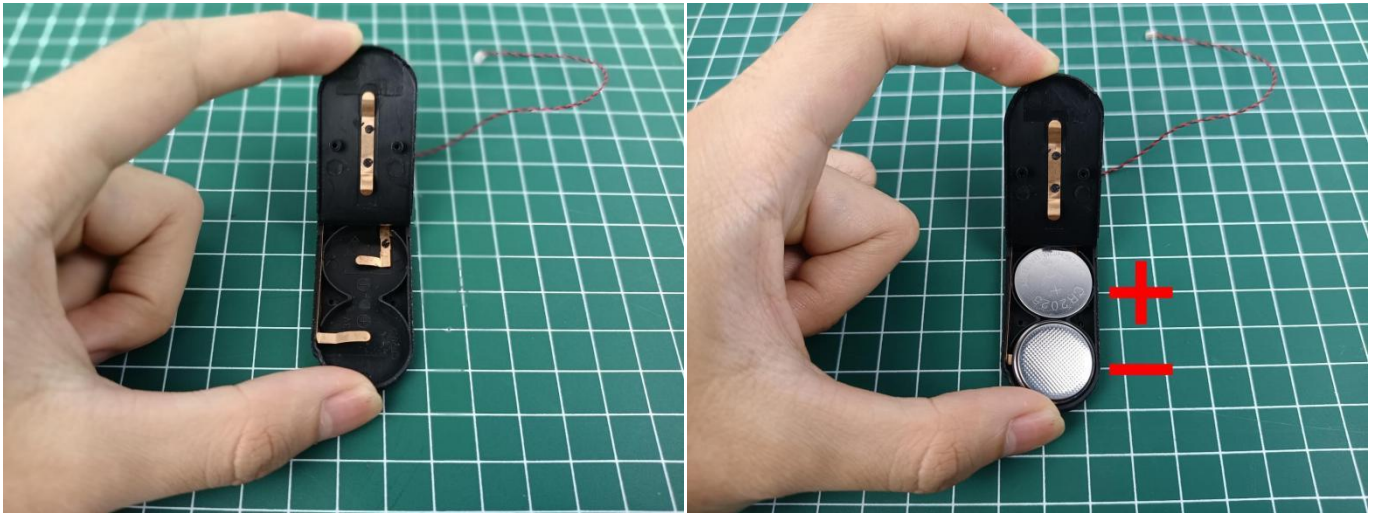

27

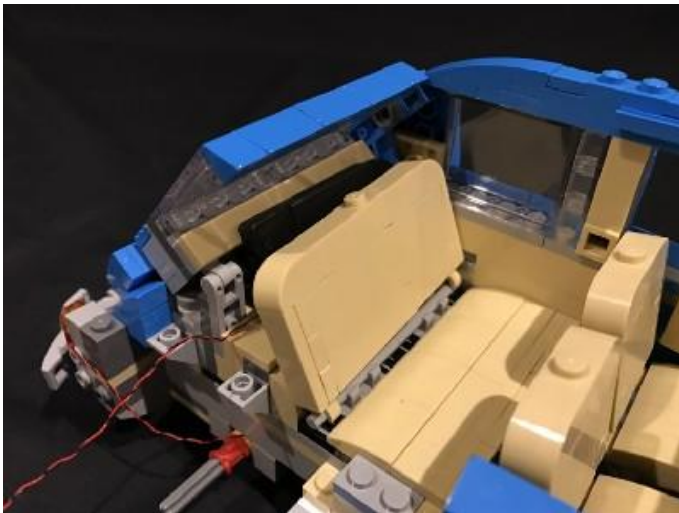

28. Thread the cable down the side and then underneath the car through the same spacing where we threaded the tail light. Connect the cable to the next available port on the expansion board.

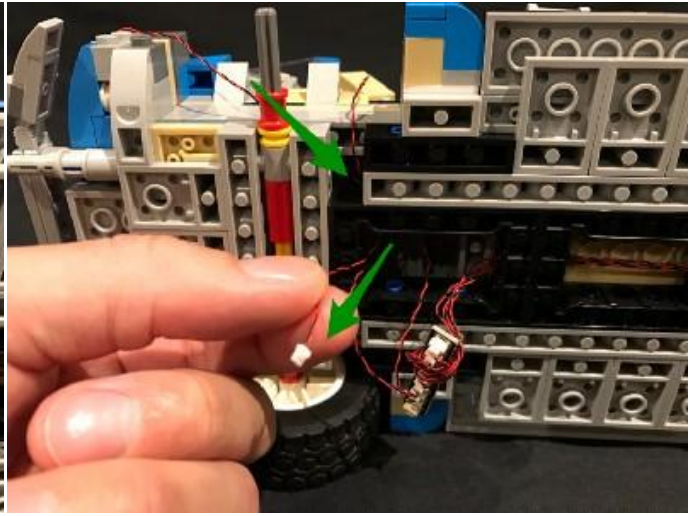
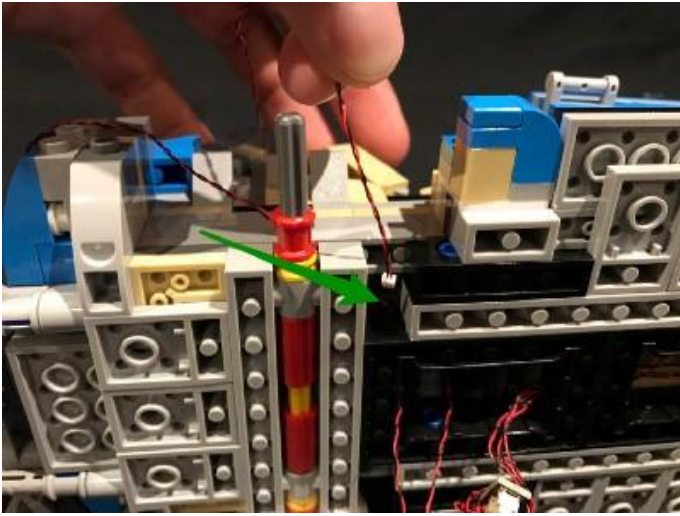

29

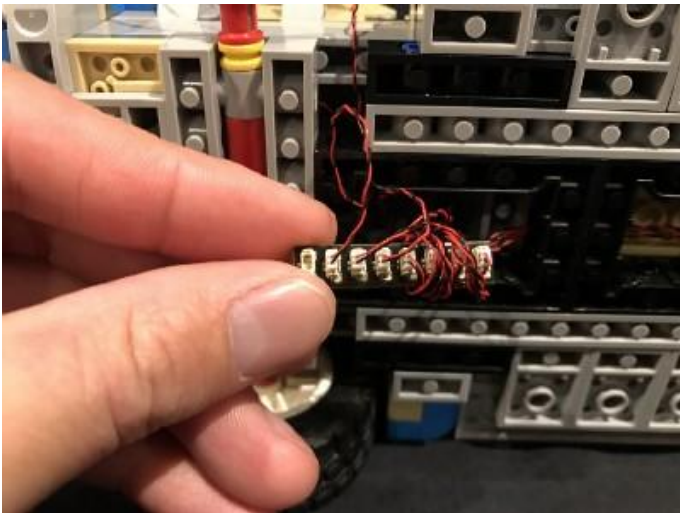

30.Reconnect the pieces we removed which make up the right back door and then reconnect the wheel and surrounding pieces.

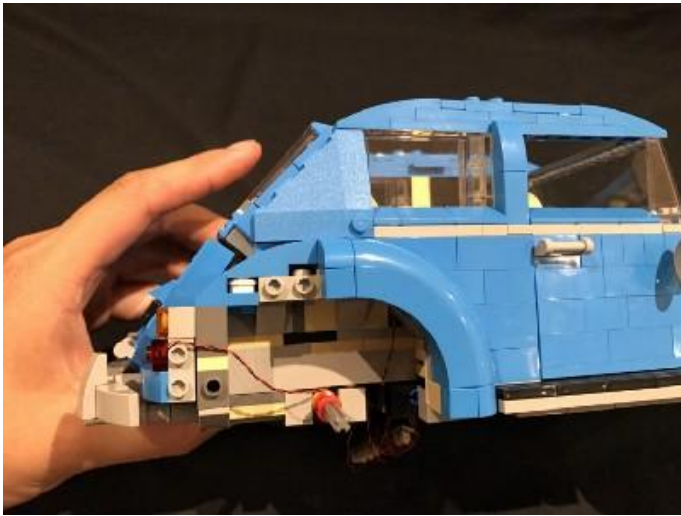

31



32.Wind any remaining excess cables around the expansion board and then tuck everything in underneath the car in the following space.

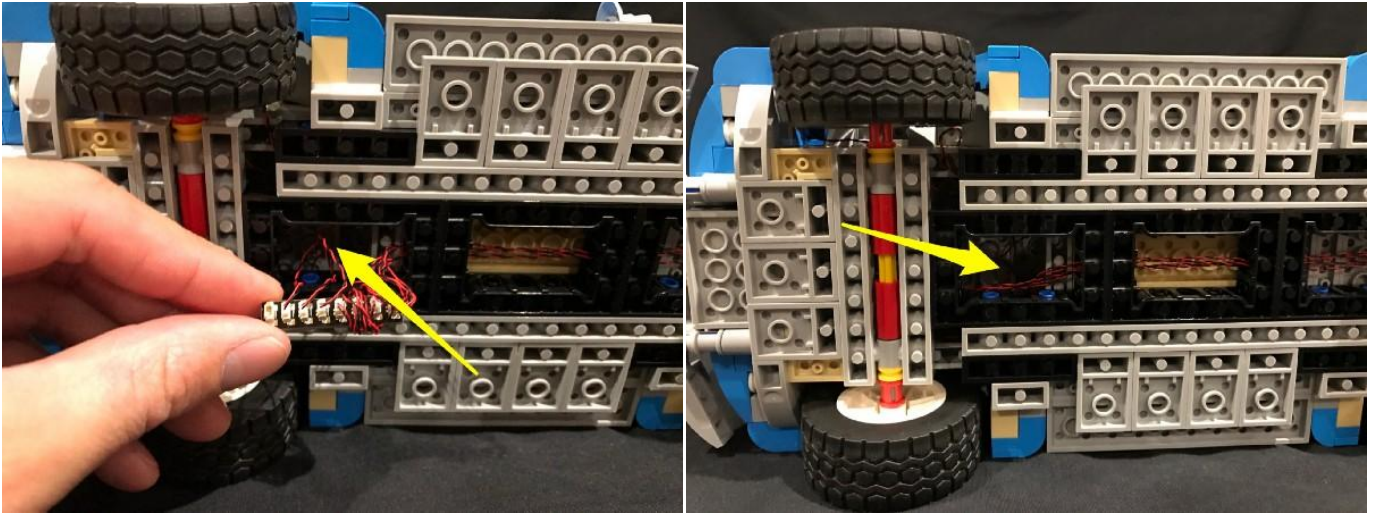

33.This now completes installation of your VW Beetle LED Light kit. All you need to do now is turn on the battery pack and ENJOY!

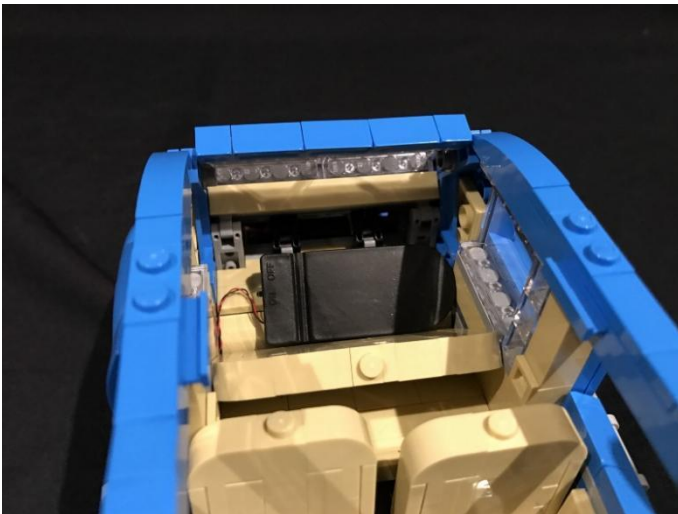

Good job, you've done all the installation steps, power it up and enjoy your work.

