

# 10360 Shuttle Carrier Aircraft

- Installation requires a lot of patience and great observation that your LEGO bricks will come alive when you get this finished. The bricks with lighting as below, so make sure you're ready and let's get started.



# Strategies for the Installation

This instruction divides three sections to complete the installation of the lighting set.

## **Section A:** Check the type and quantity of components.

The quantity and type of components of each products are different and it needs to be carefully checked to make sure there do have enough material. The type of components is indicated by the label on the bag.

## **Section B:** Test that each components is working properly.

Each components is made individually so it is necessary to test that each components is working properly to avoid the situation that the lighting does not work .

## **Section C:** laying out components following the instruction.

Our material is very small but not fragile, just be reminded that don't to pull the wires too hard. For different people, there may be some installation steps that you can't understand. Please look at the previous and later installation step.

## Section A: Check the type and quantity of components.

This set contains eleven bags labelled "1" "2" "3" "4" "5" "6" "7" "8" "9" "10" "A01305 Power Supply", please make sure that the components in each bag are the same as shown in the pictures.





**Please contact us immediately if there have any missing components.**



## Section B: Test that each components is working properly.

Take out the expansion board and USB power cable from "No. 9 bag " and the " A01305 power supply" bag.



It is worth reminding that our products are all customized. They have a unique way of connecting. The white plug on wire and the socket of the expansion board need to be connected together to transmit power.

Note that on one side of the white plug you can see two very small golden wires that should be connected to the two golden needles in socket of the expansion board.shown as blow.

### Side-Mounted Expansion Board

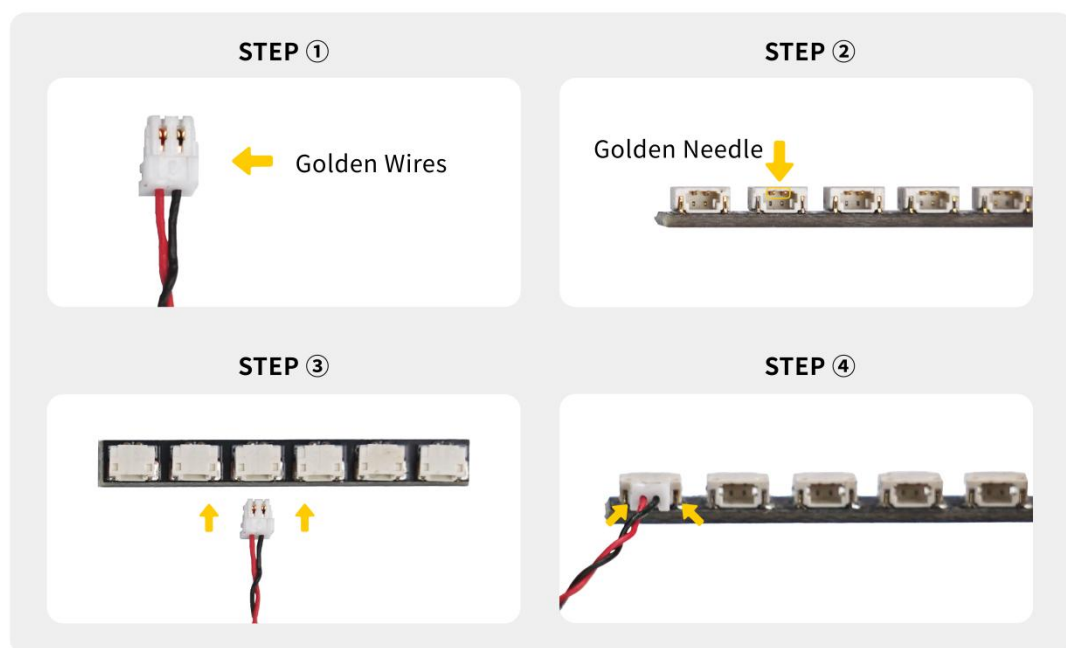

All our connections between plug and socket are all the same as shown above. So for any such structure with plug and socket, please pay attention to the golden wire of the plug and the golden needle of the socket, they must be touched together.

**The connection method between the USB Power Cord and Expansion Boards is as follows:**

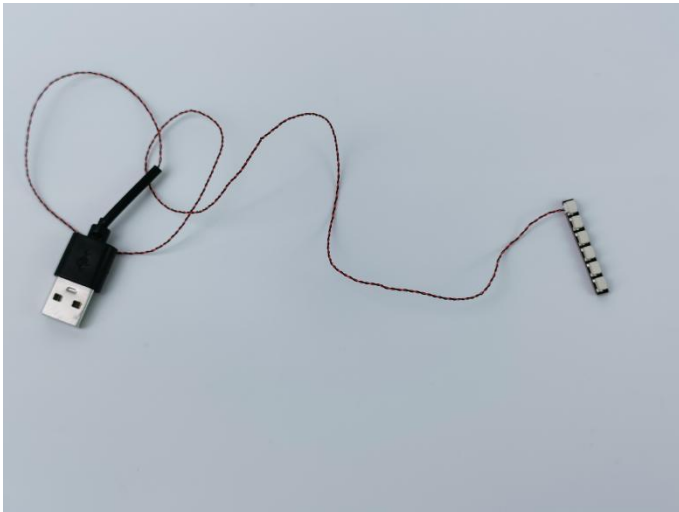

**The USB Power Cord can be powered by phone chargers, power banks, etc.**

### **USB Connectors to Connect Devices**

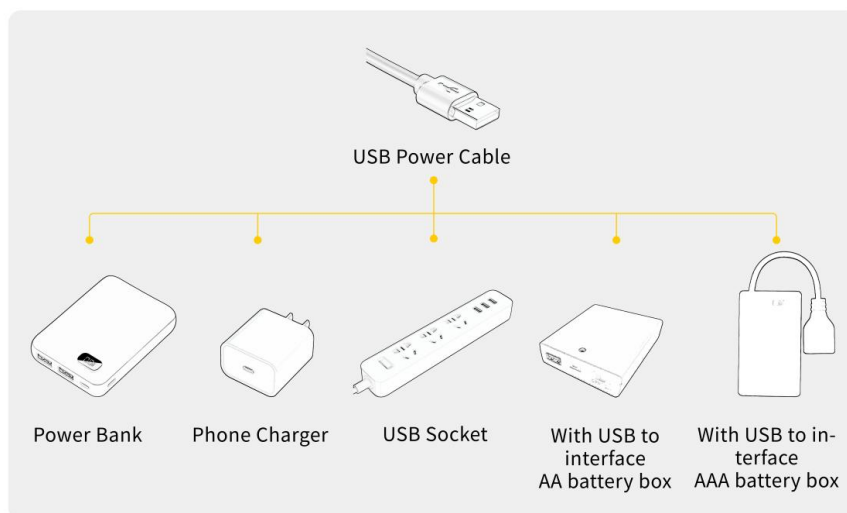

**This instruction will use the power bank as power supply . The test structure is shown as follow. All lamp in this set will be tested by this structure.**



When we test "①" particles. Take out one of the light and connect it to the socket. Turn on the power bank, the light will turn on normally as shown below.

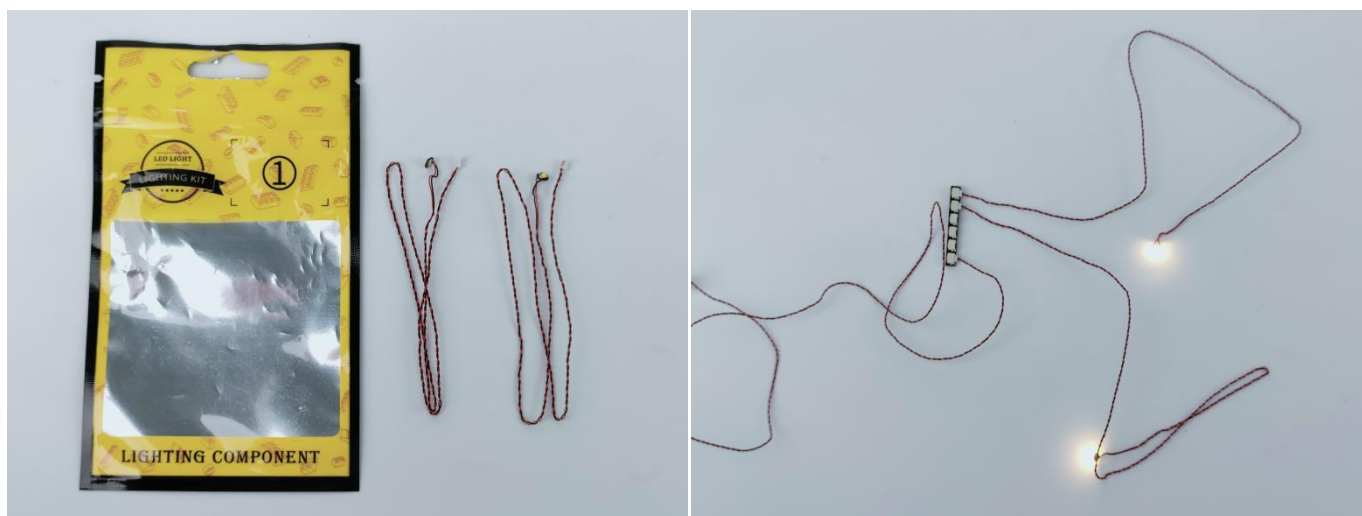

Test each lamp according to this method. It should be noted that after the test, the lamp must be returned to the corresponding bag to avoid confusion of types.



## Section C: laying out components following the instruction.

1



2



3

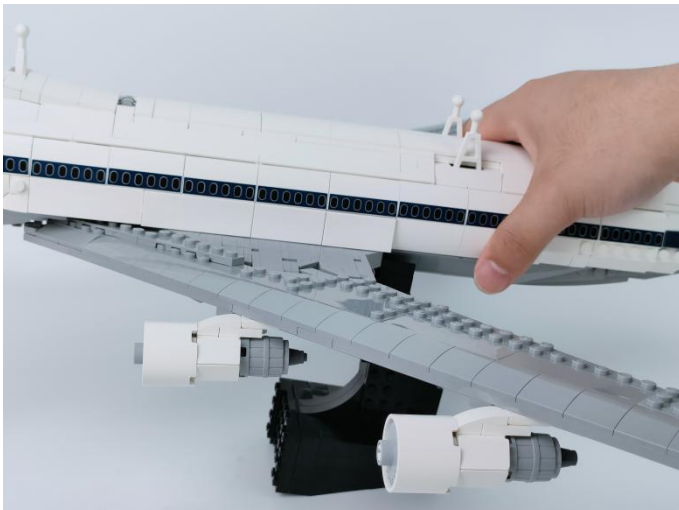



4



5

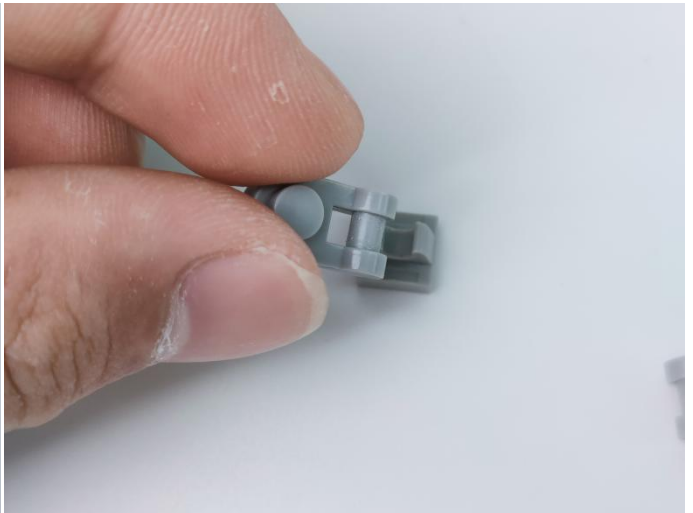

6



7

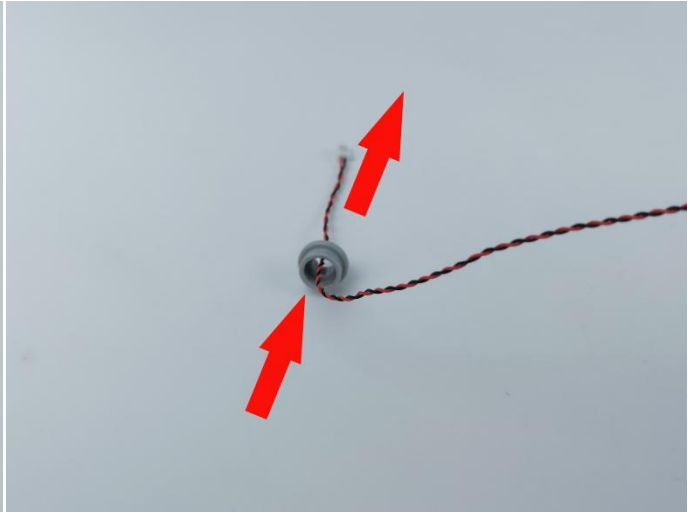

8



9



10

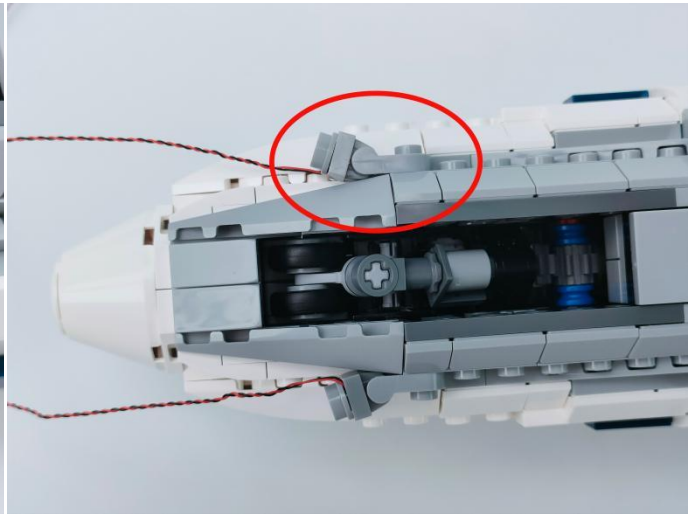
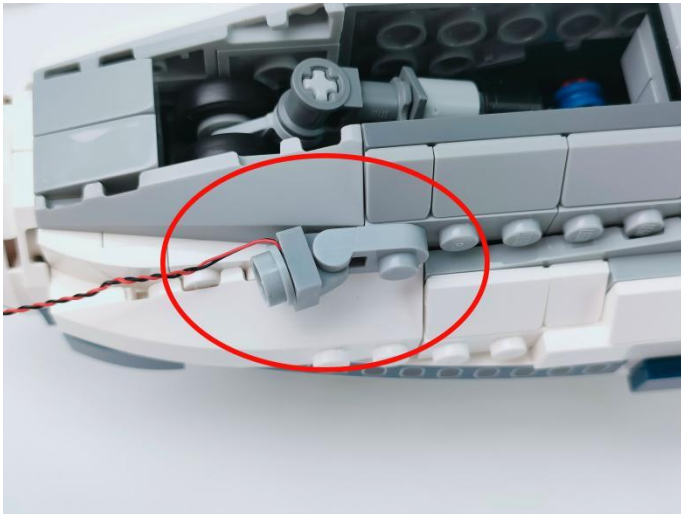

11

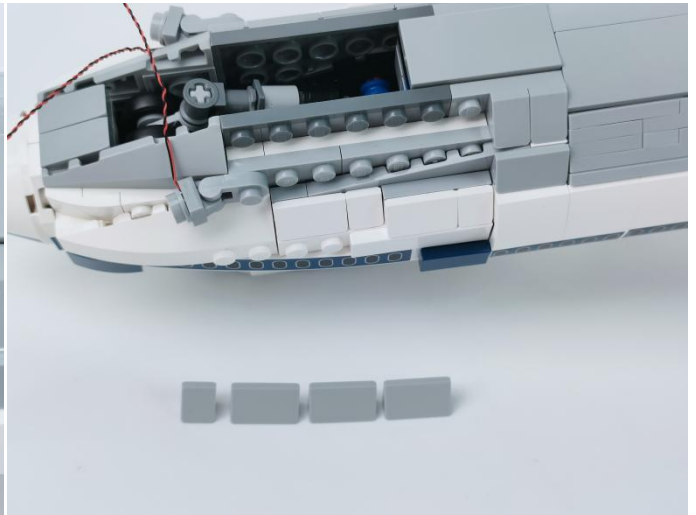
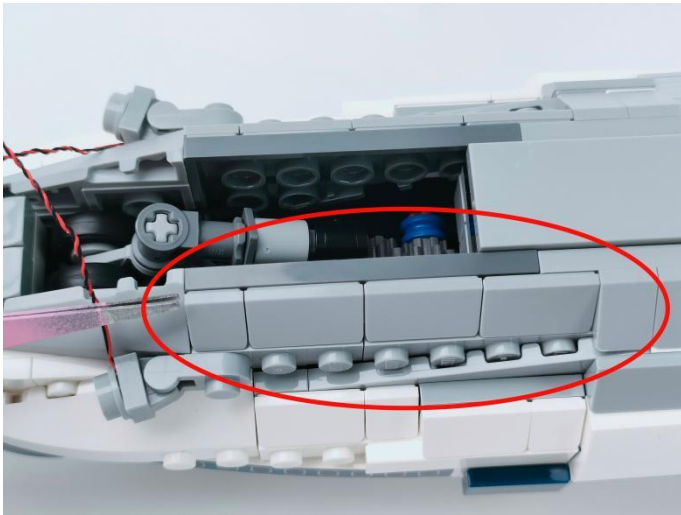

12

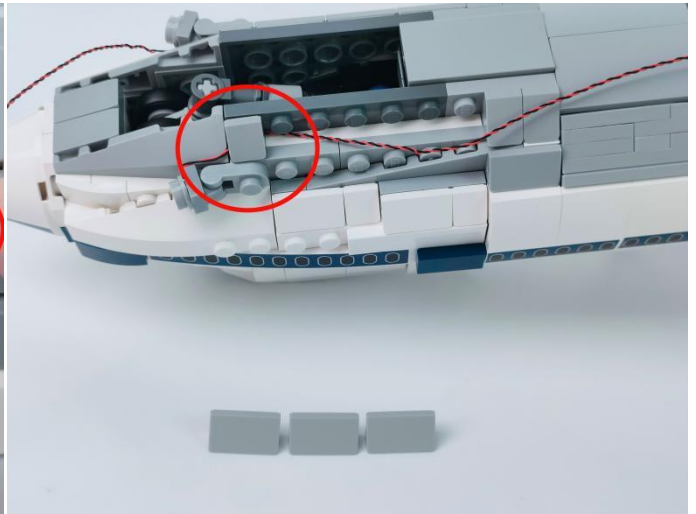
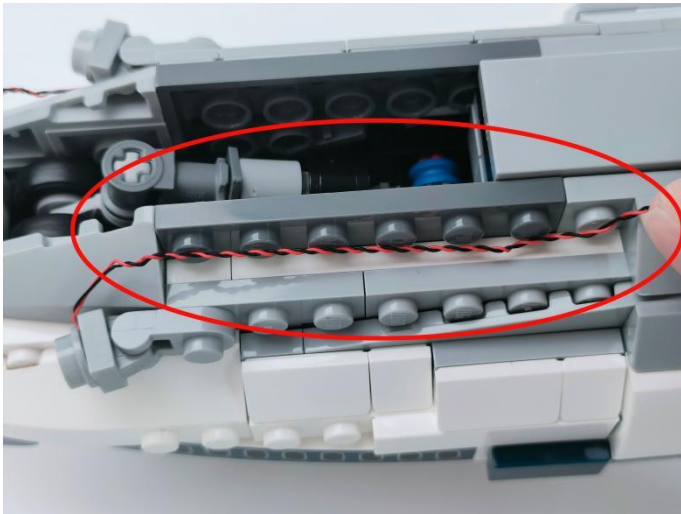

13

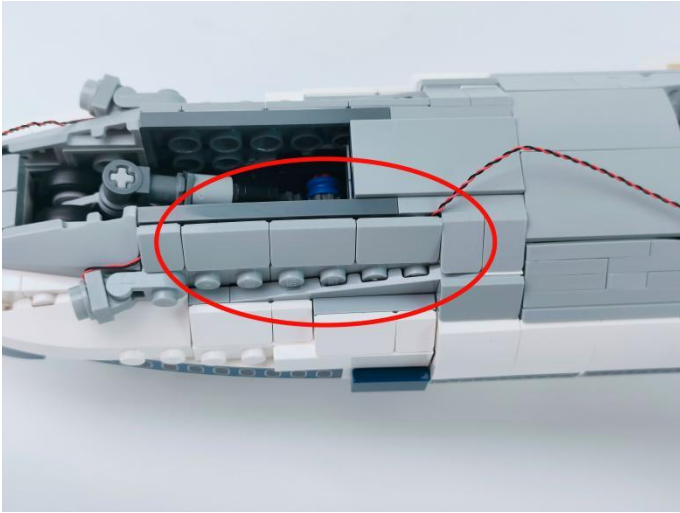

14

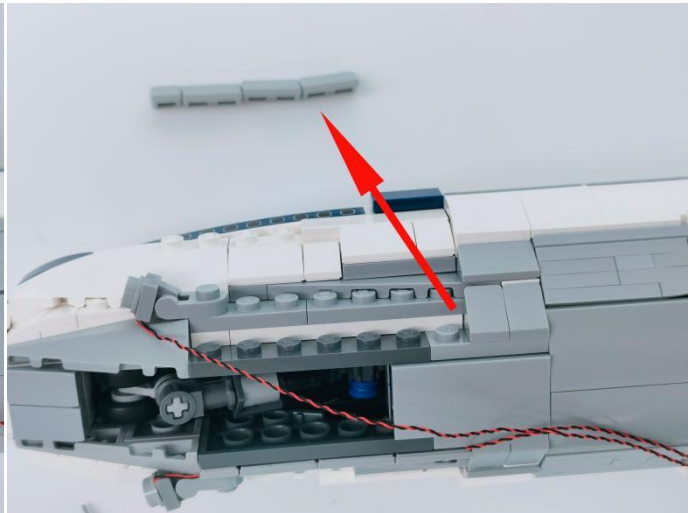
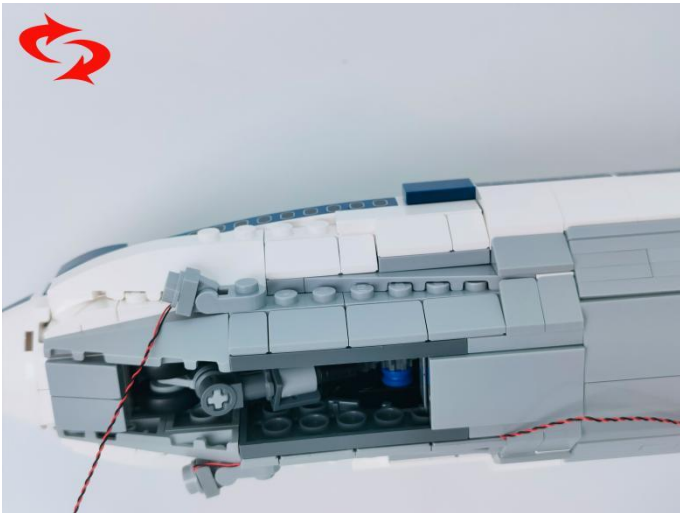

15

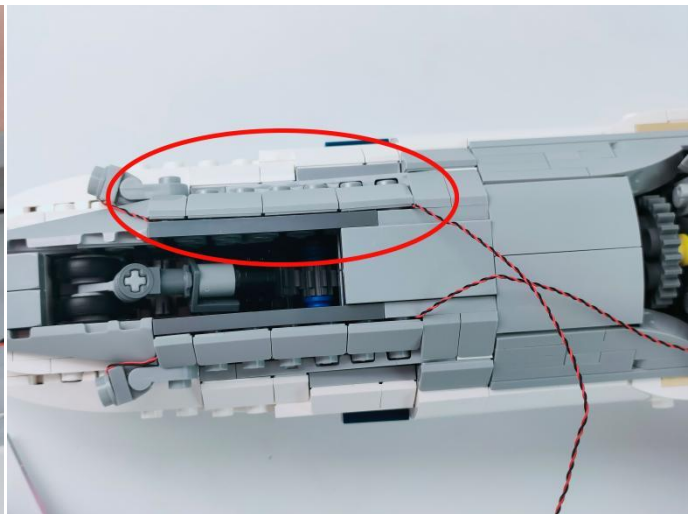
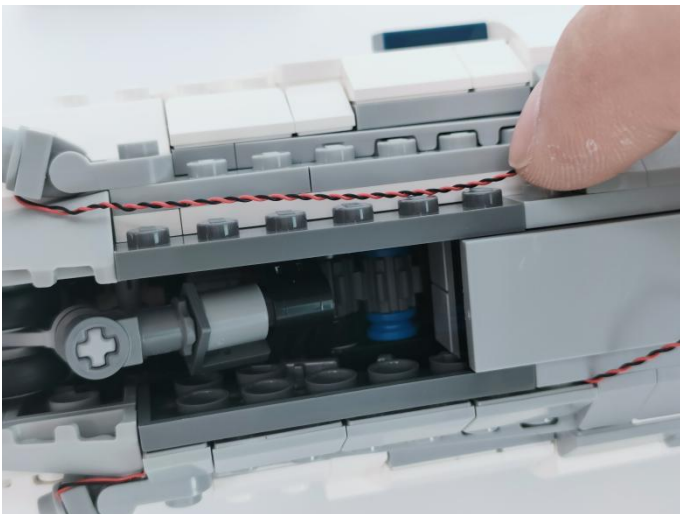



16

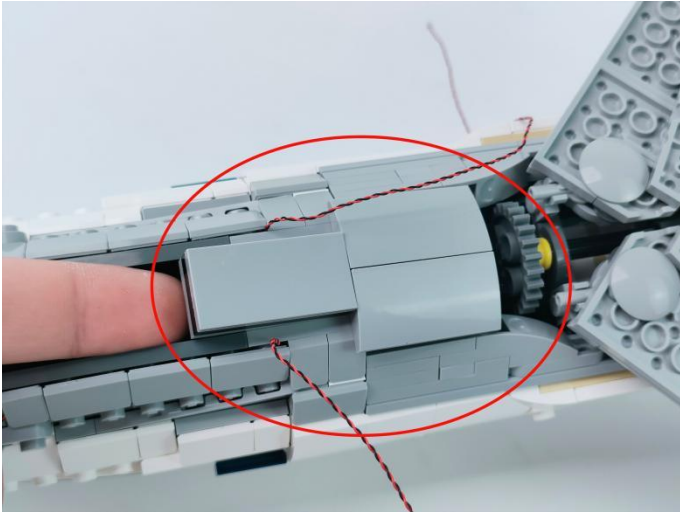

17

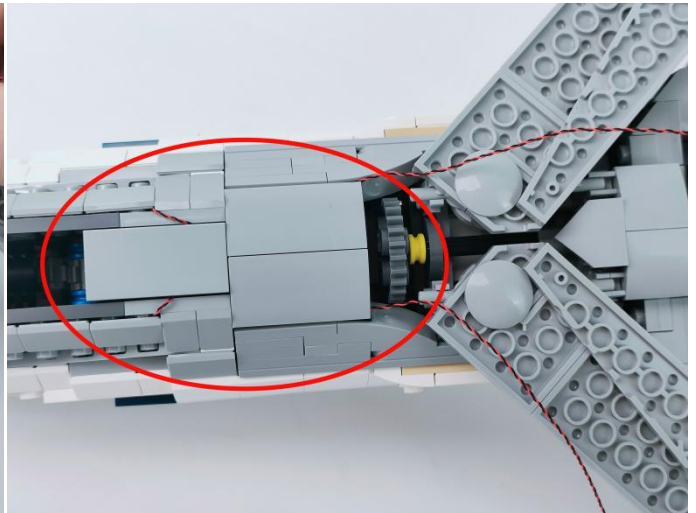
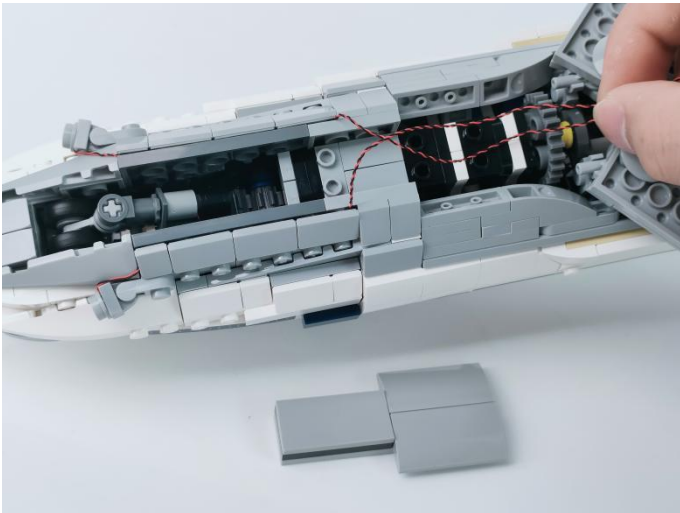

18

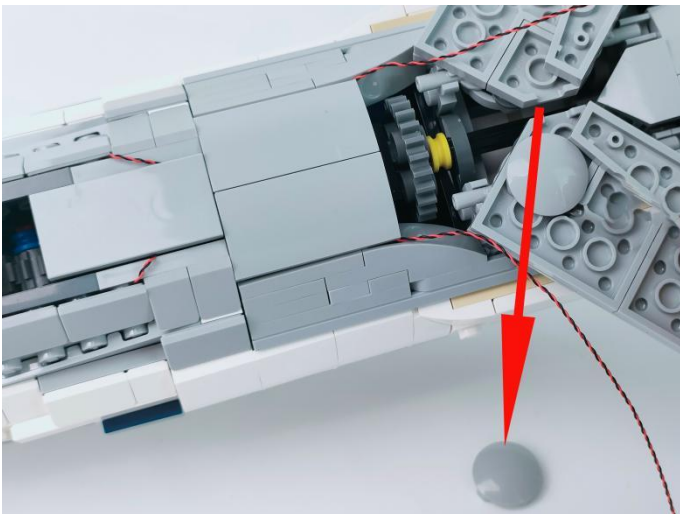

**19**

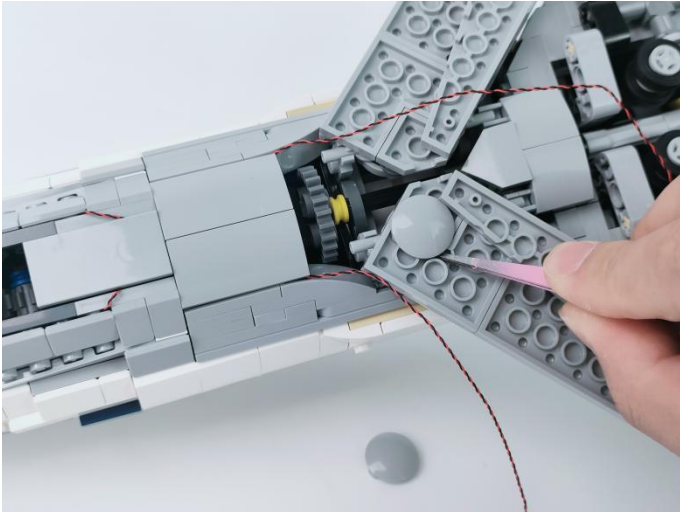

**20**

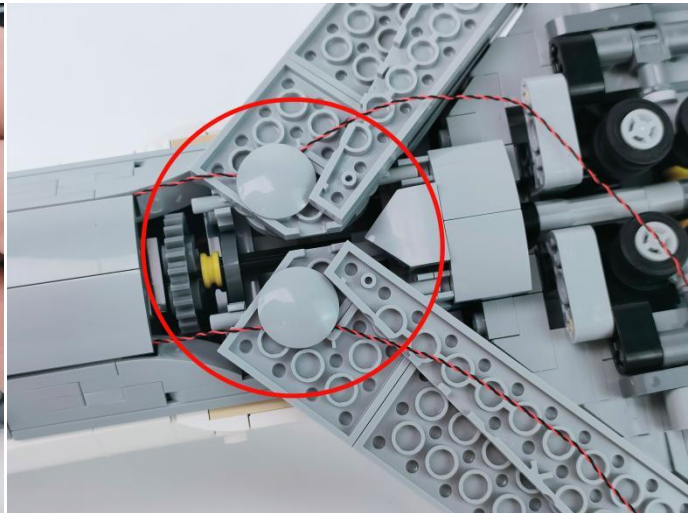
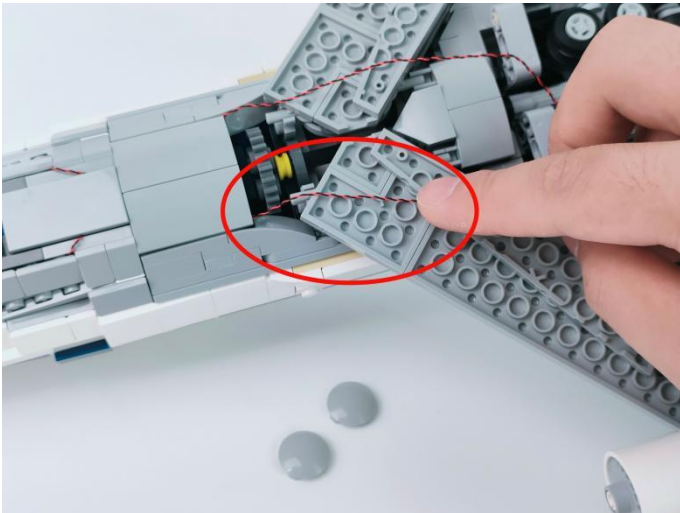

**21.** Twist the two lighting wires into one strand.

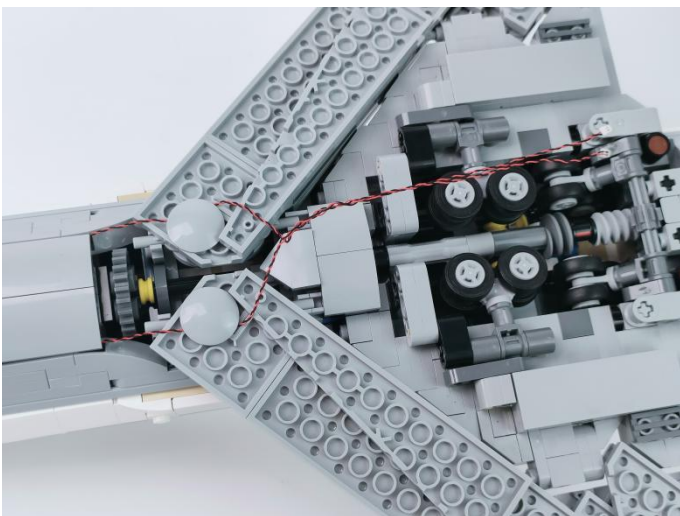

22

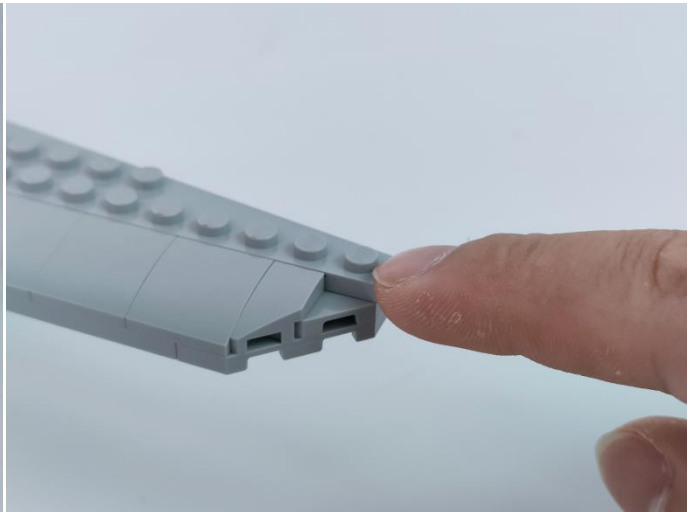

23



24

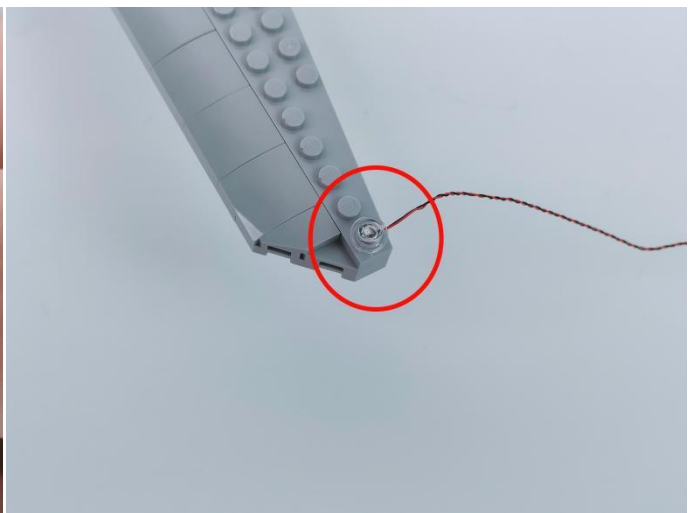
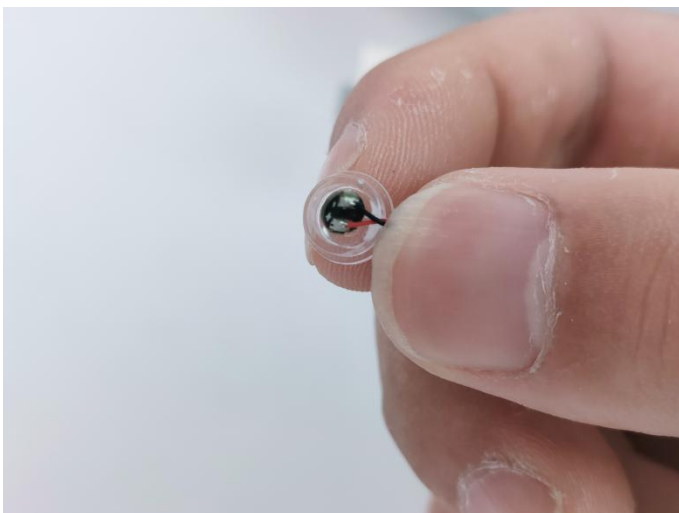



## TIPS

The slit on the the plate round 1X1 are hand-made to avoid squeeze the wire and cause short circuit and abnormal heat during installation.

The plate without slit



The squeeze causes the protective layer of the wire to be torn apart, the positive and negative wires touch together, and the set is short-circuited and the hot or wire is crushed, the wire to be disconnected and don't work.

The plate with slit

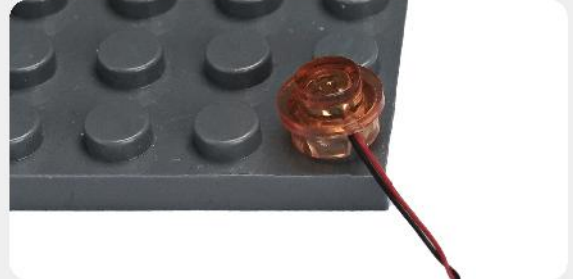

The wire has enough space to avoid being squeezed endowed with longer service life and more stable effect.

25

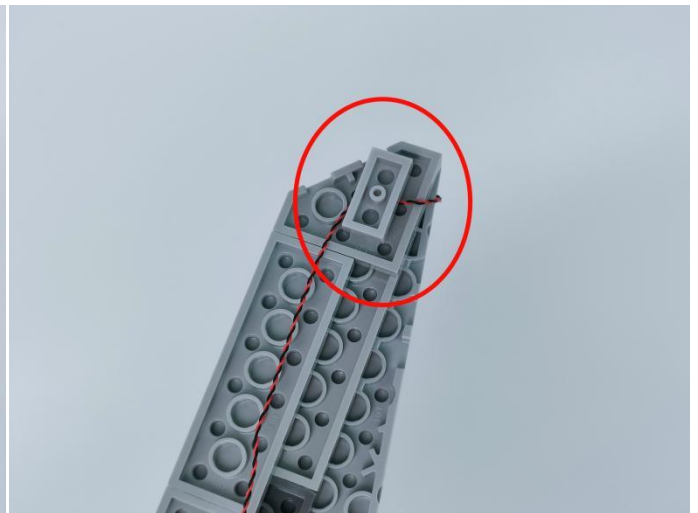
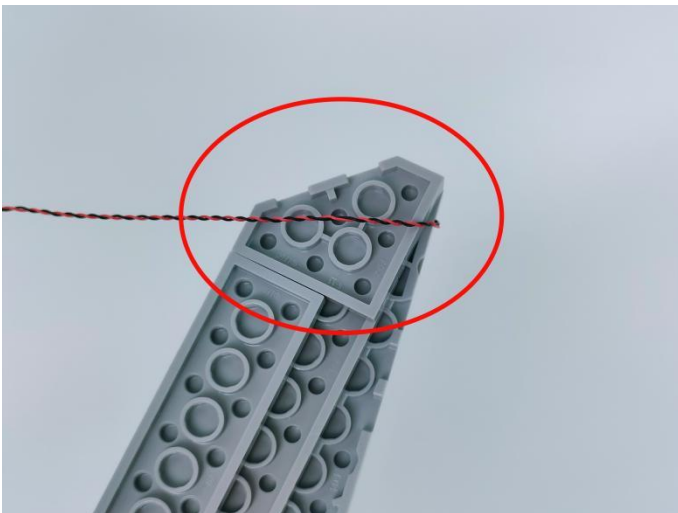



**26**

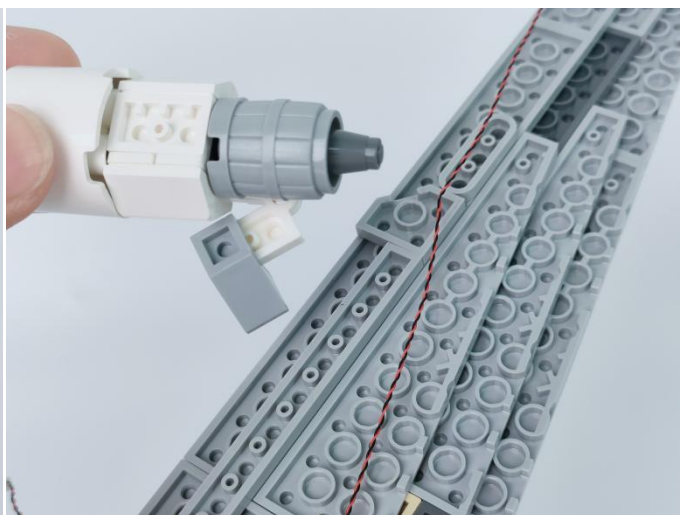
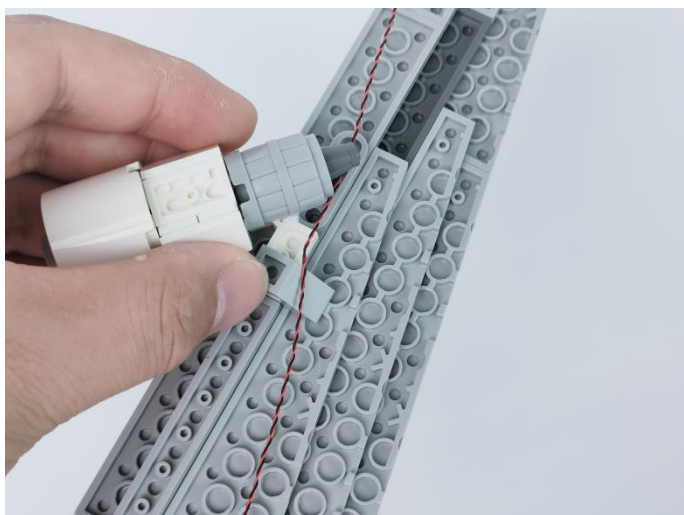

**27.** Pull the wire back, then restore the engine, and press down on the lamp wire.

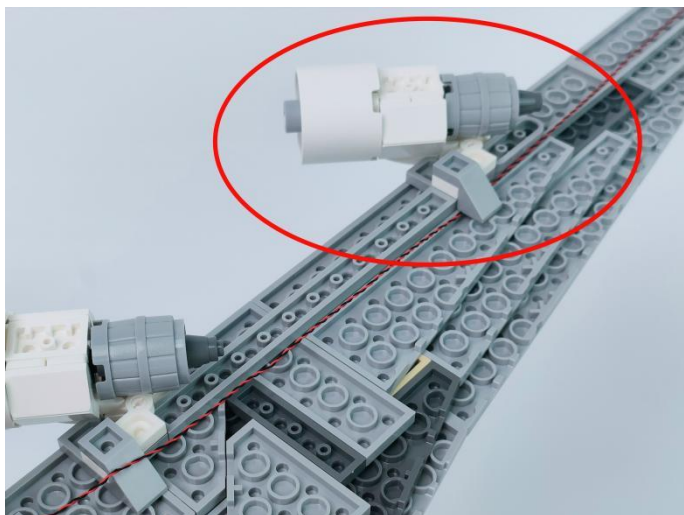

**28**

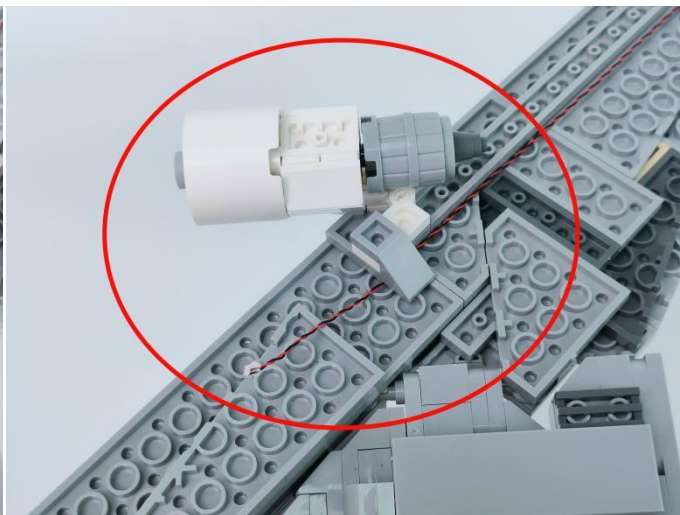
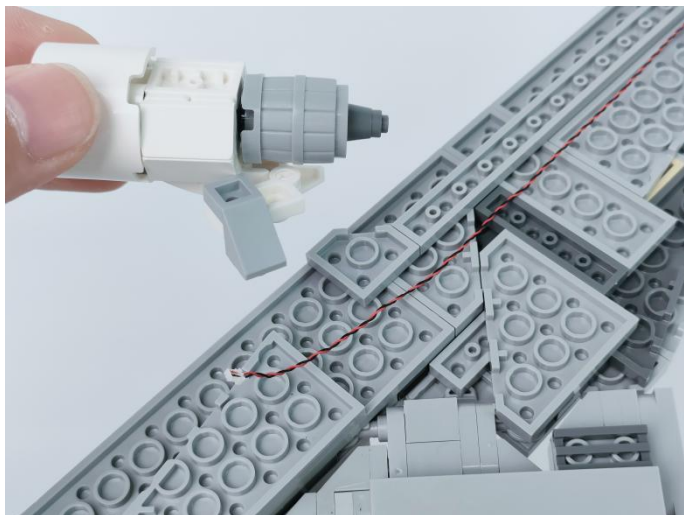

29



30



31

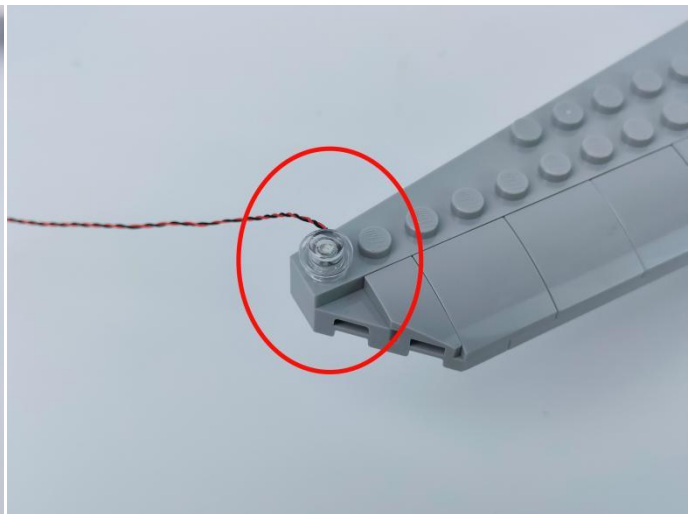
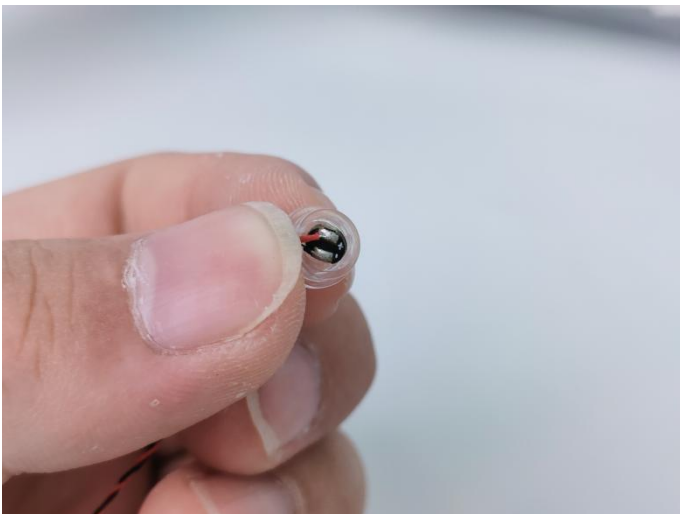

32

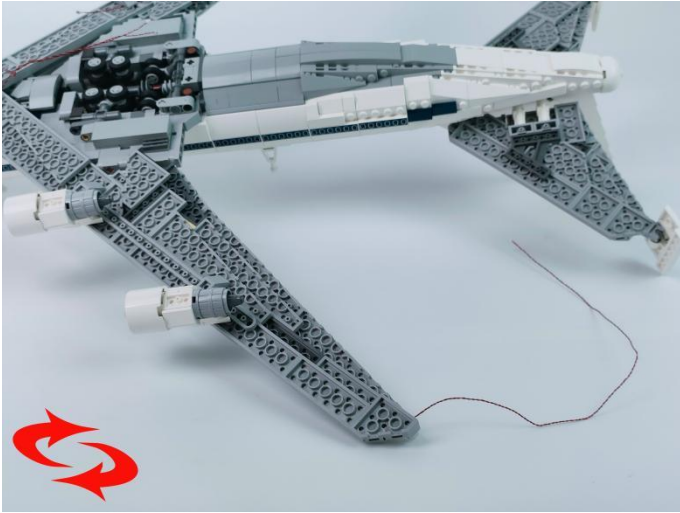

33

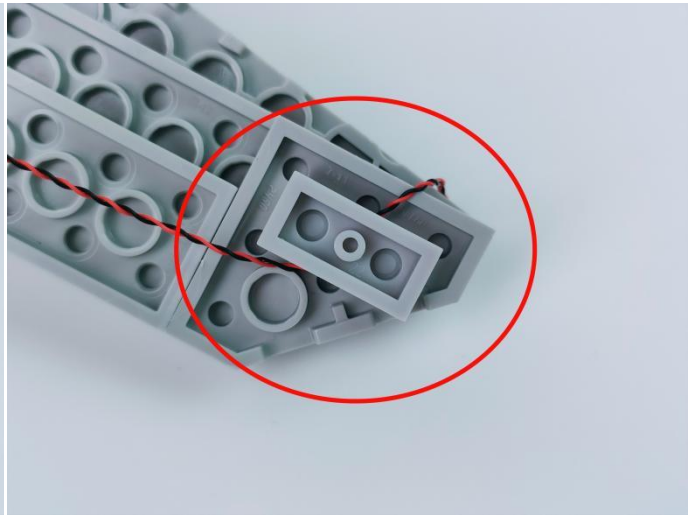
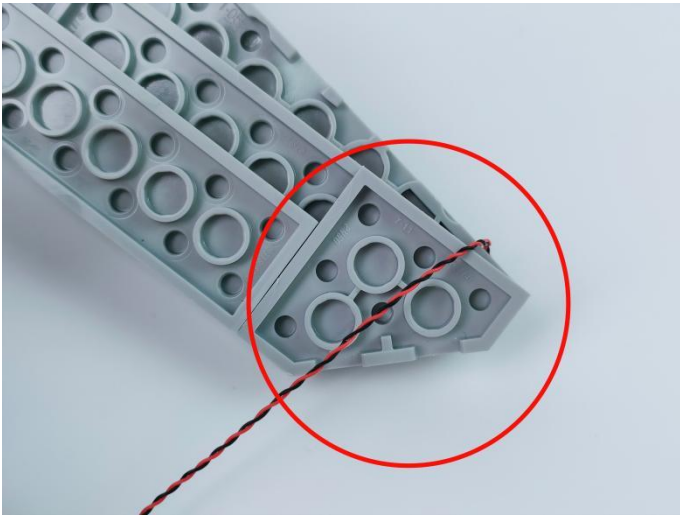

34

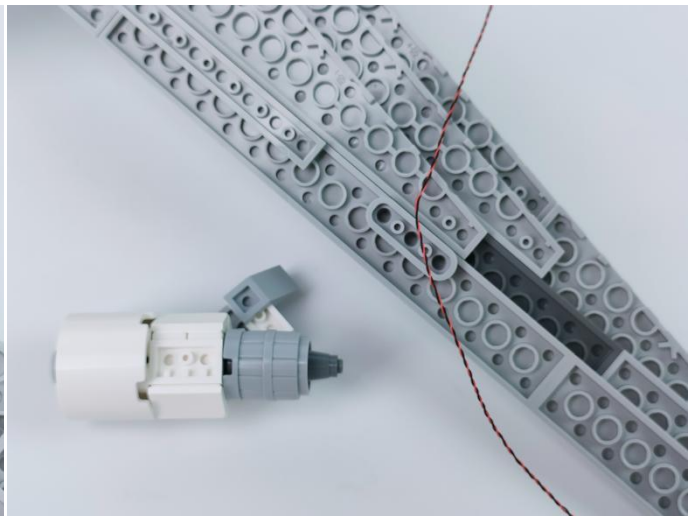
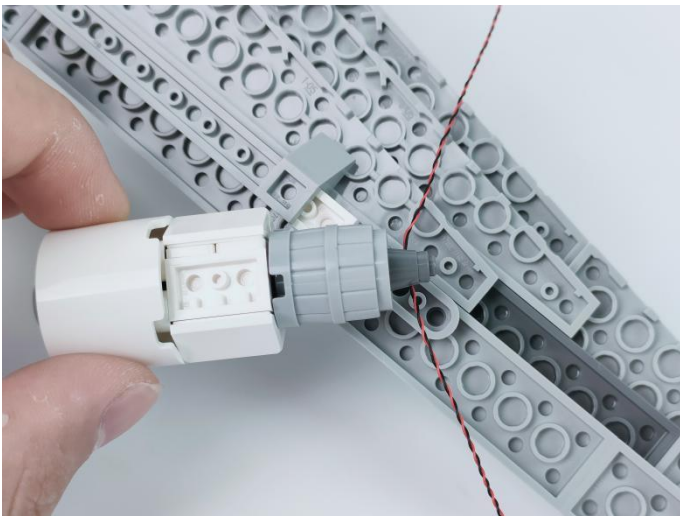



35

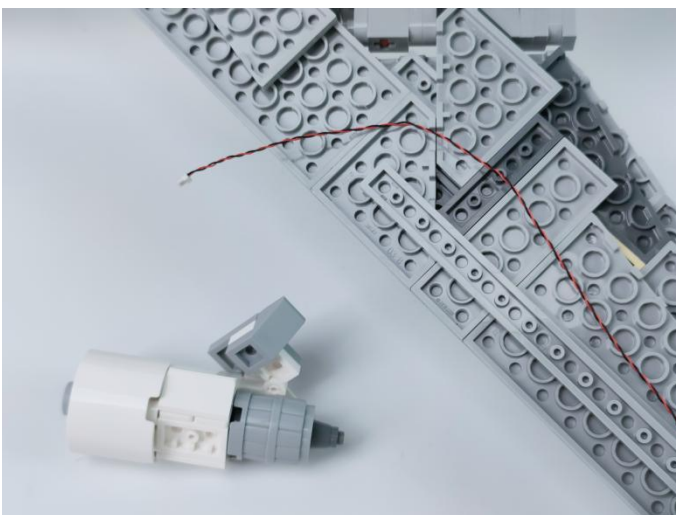
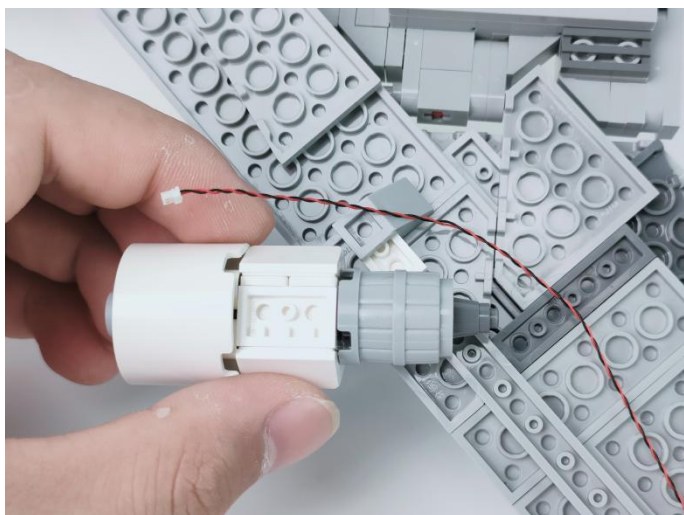

36

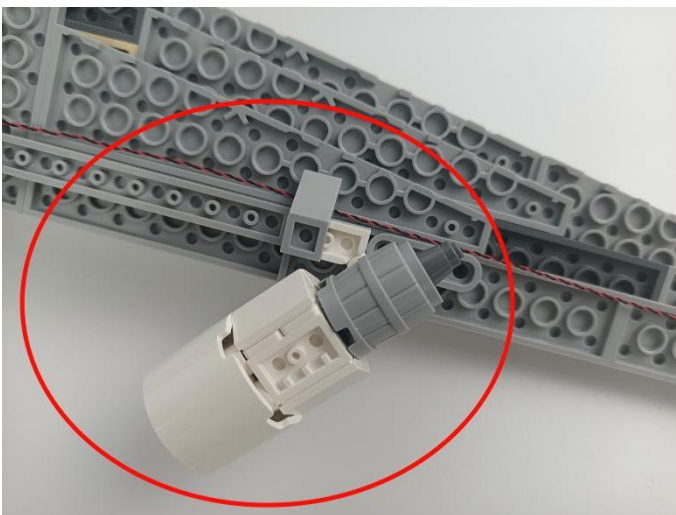
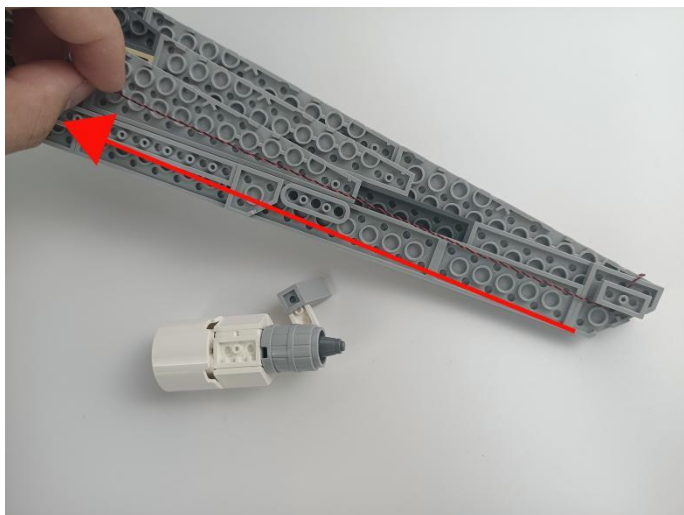

37

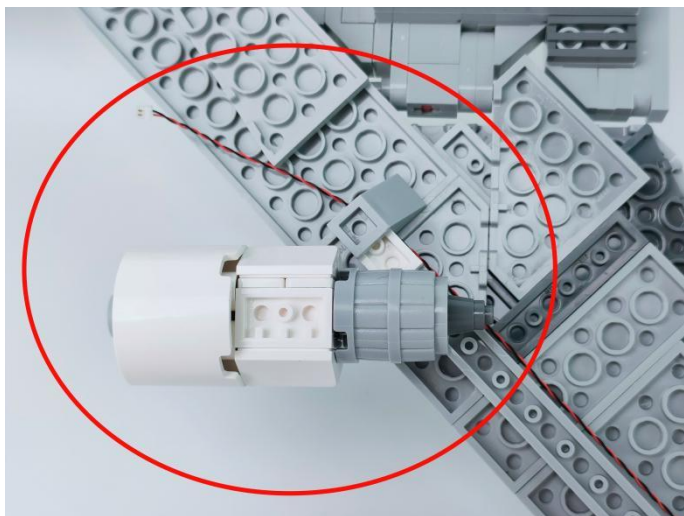



38



39



40

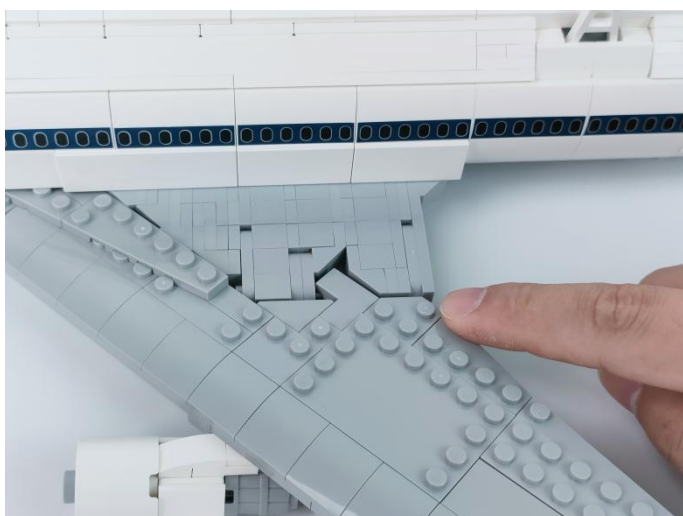

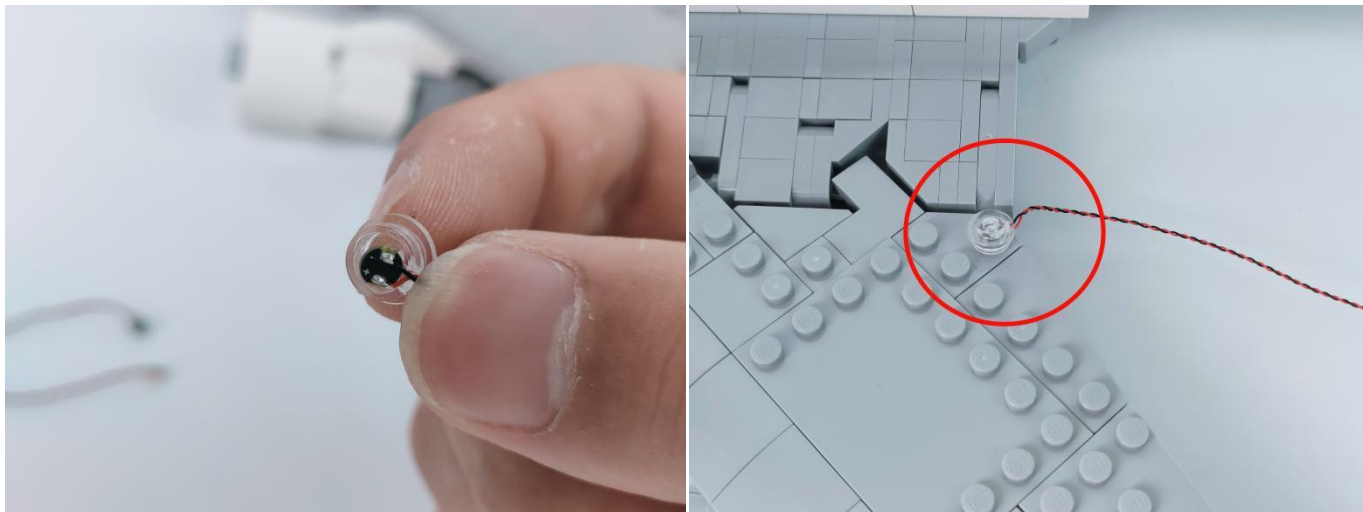

## TIPS

The slit on the the plate round 1X1 are hand-made to avoid squeeze the wire and cause short circuit and abnormal heat during installation.

**The plate without slit**

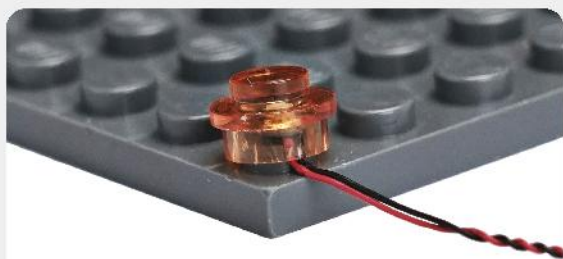

The squeeze causes the protective layer of the wire to be torn apart, the positive and negative wires touch together, and the set is short-circuited and the hot or wire is crushed, the wire to be disconnected and don't work.

**The plate with slit**

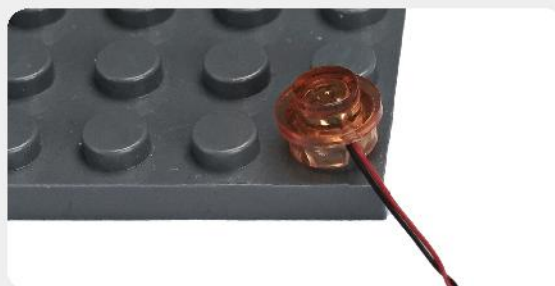

The wire has enough space to avoid being squeezed endowed with longer service life and more stable effect.

42

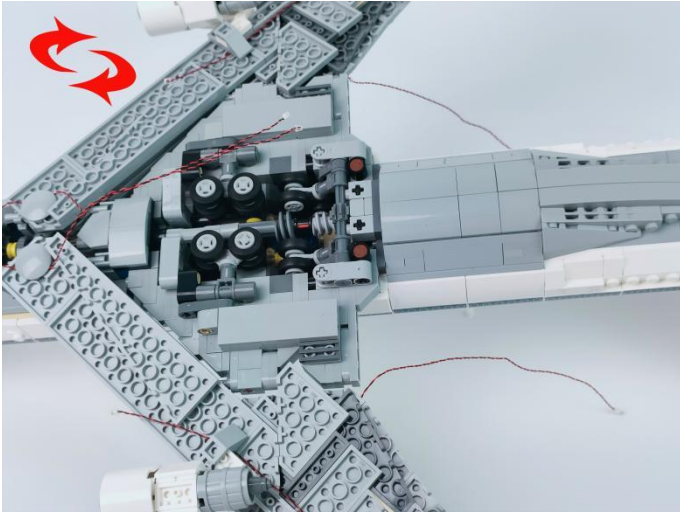

43

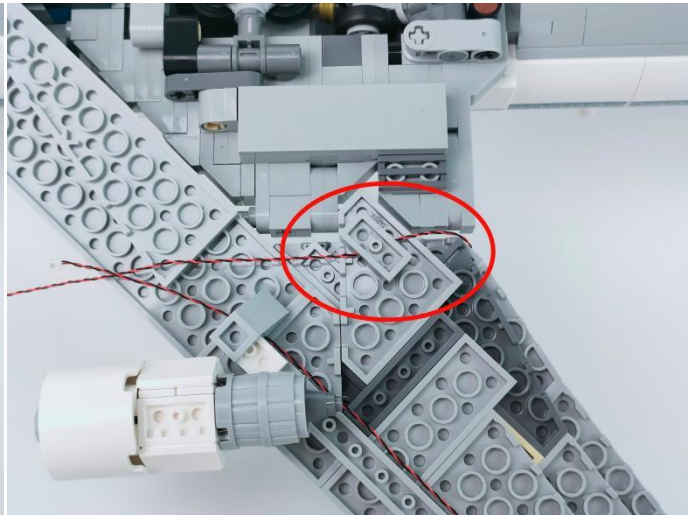
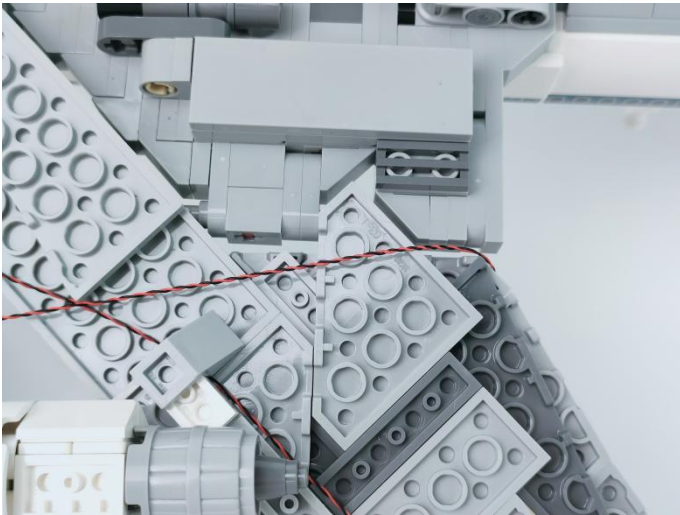

44

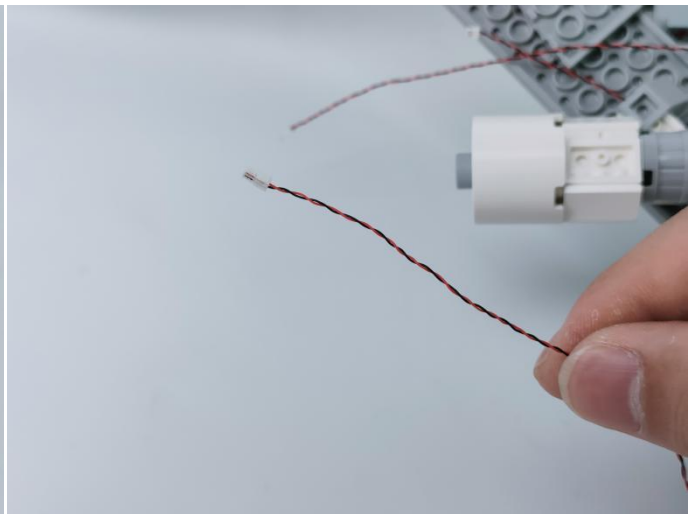



45

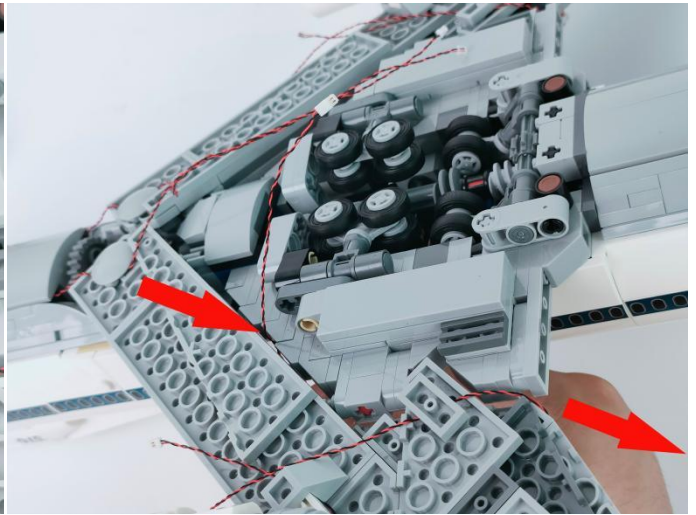
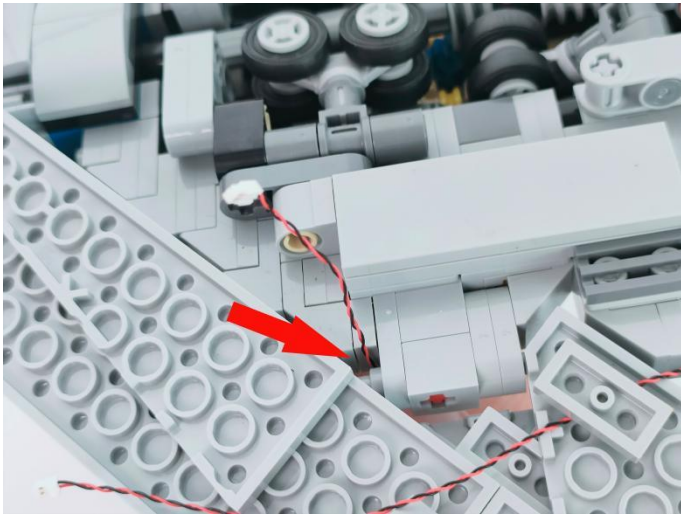

46

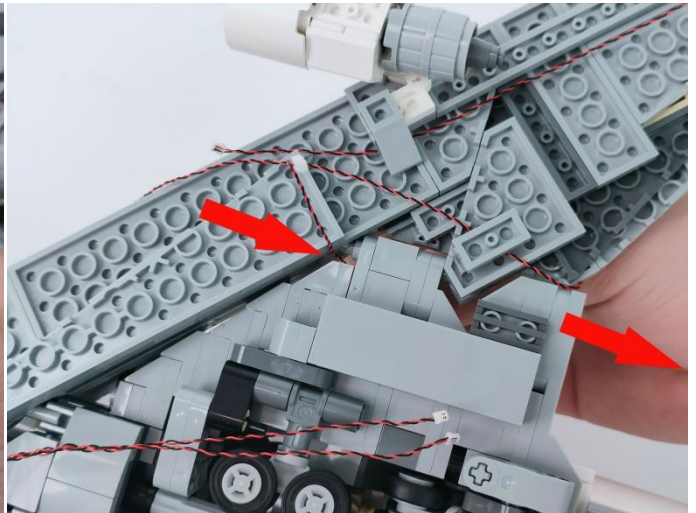
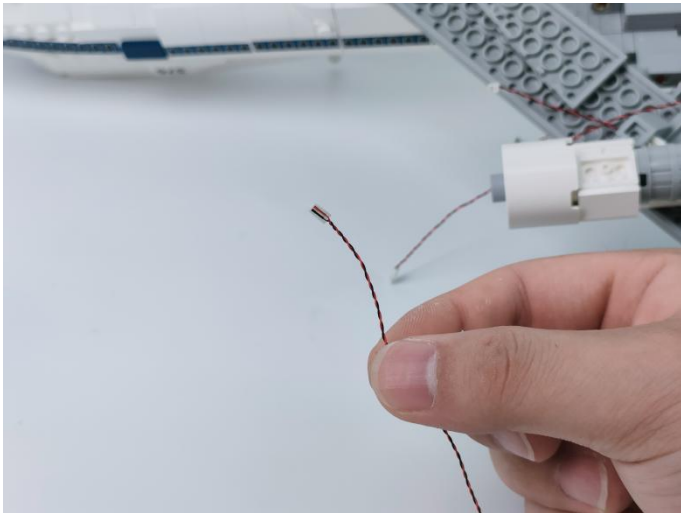

47





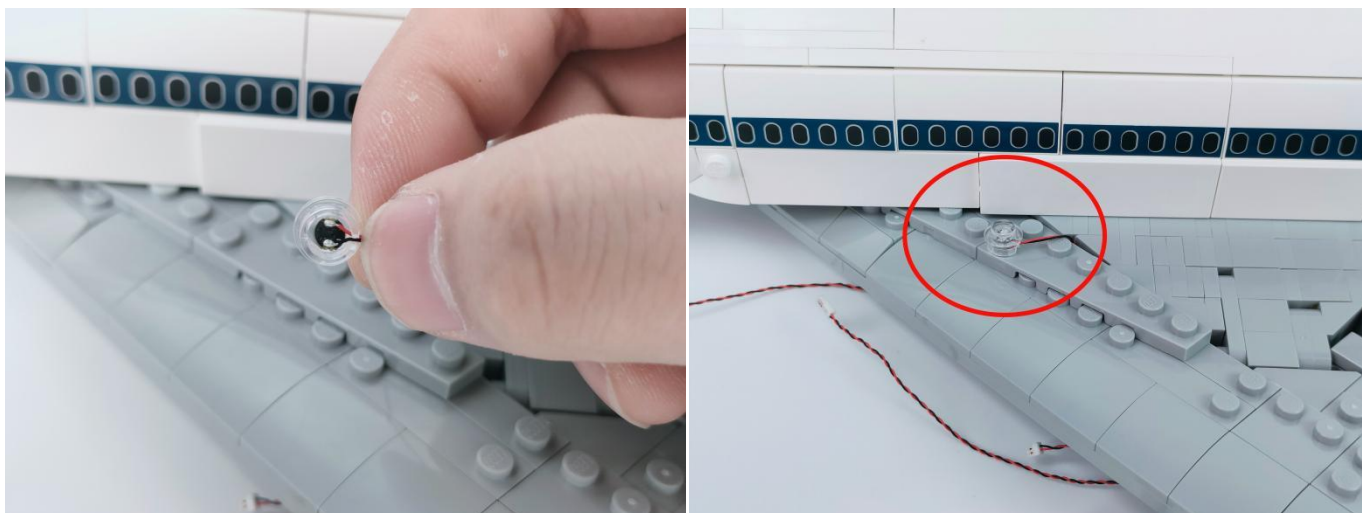

## TIPS

The slit on the the plate round 1X1 are hand-made to avoid squeeze the wire and cause short circuit and abnormal heat during installation.

**The plate without slit**

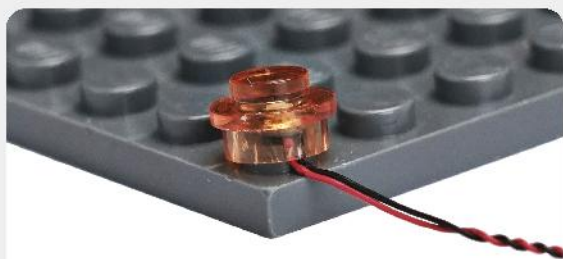

The squeeze causes the protective layer of the wire to be torn apart, the positive and negative wires touch together, and the set is short-circuited and the hot or wire is crushed, the wire to be disconnected and don't work.

**The plate with slit**

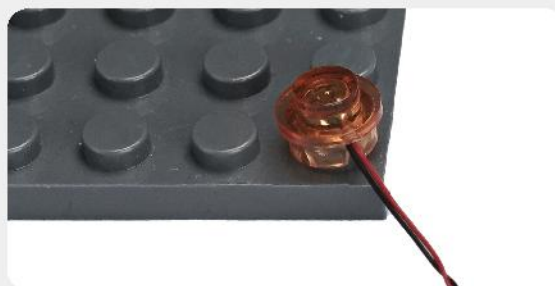

The wire has enough space to avoid being squeezed endowed with longer service life and more stable effect.

49

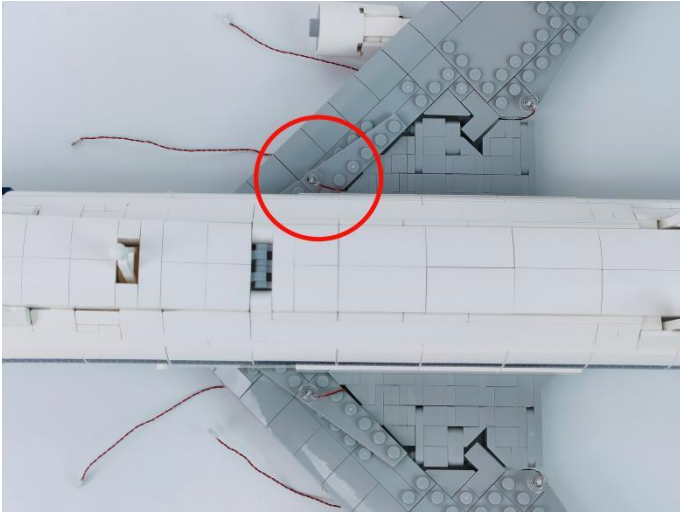

50



51

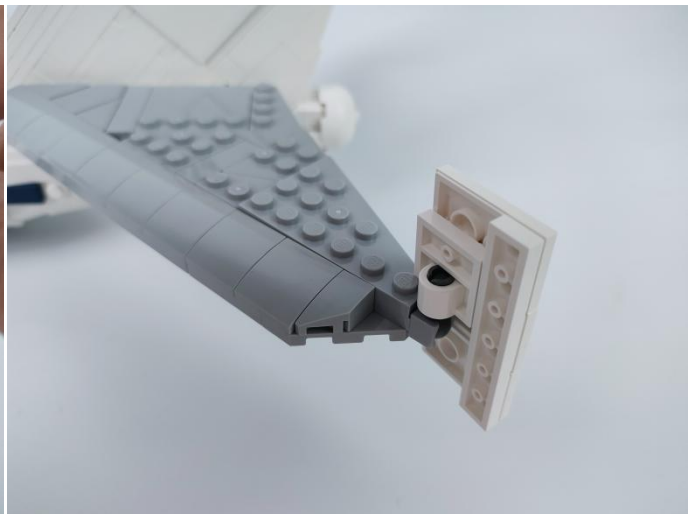

52



53

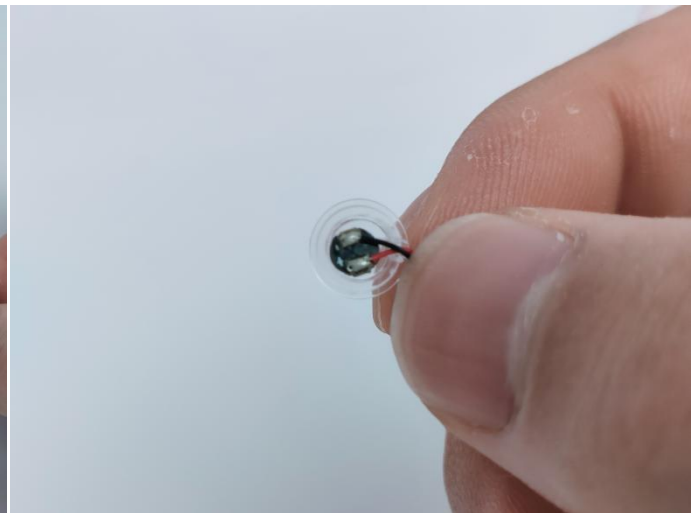

## TIPS

The slit on the the plate round 1X1 are hand-made to avoid squeeze the wire and cause short circuit and abnormal heat during installation.

**The plate without slit**

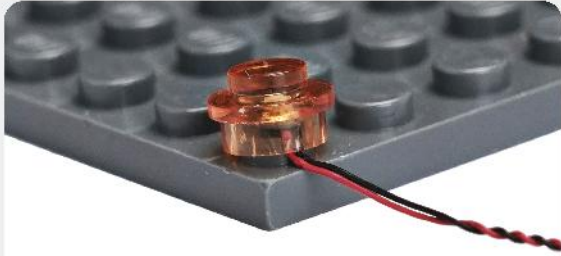

The squeeze causes the protective layer of the wire to be torn apart, the positive and negative wires touch together, and the set is short-circuited and the hot or wire is crushed, the wire to be disconnected and don't work.

**The plate with slit**

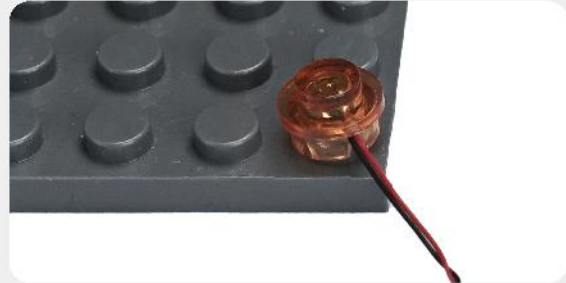

The wire has enough space to avoid being squeezed endowed with longer service life and more stable effect.

54

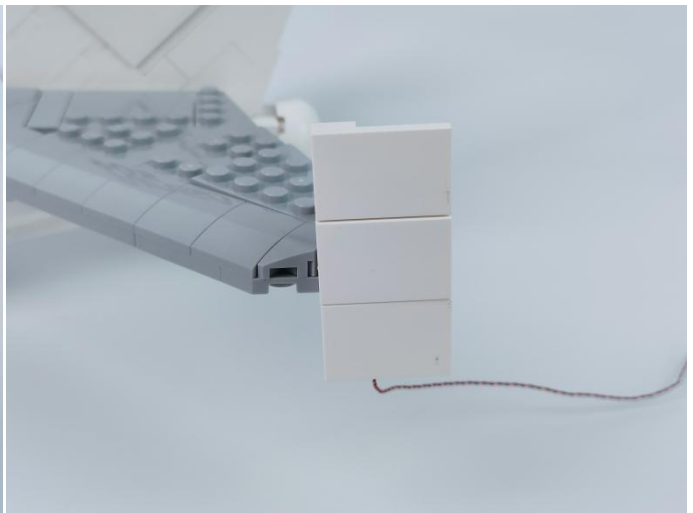
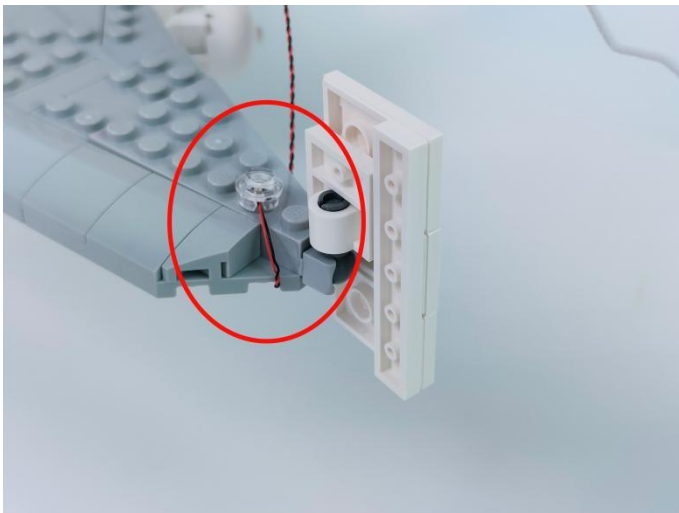



55

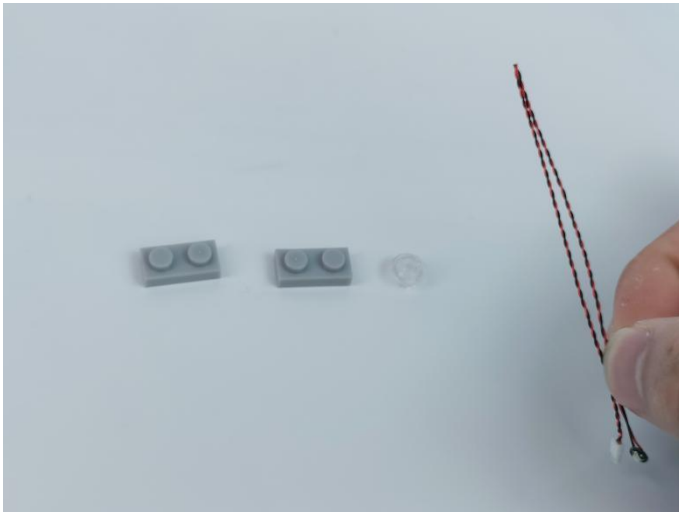

56

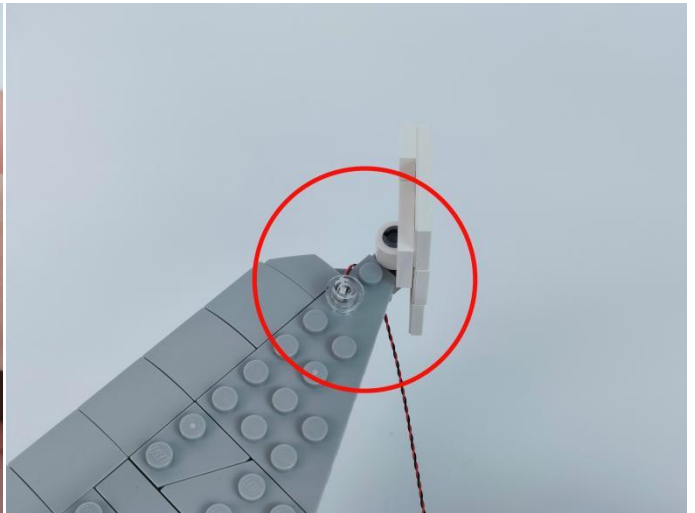
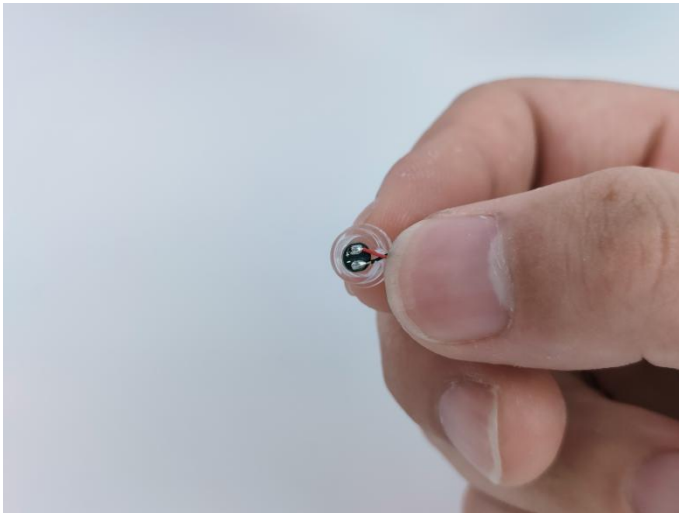

57

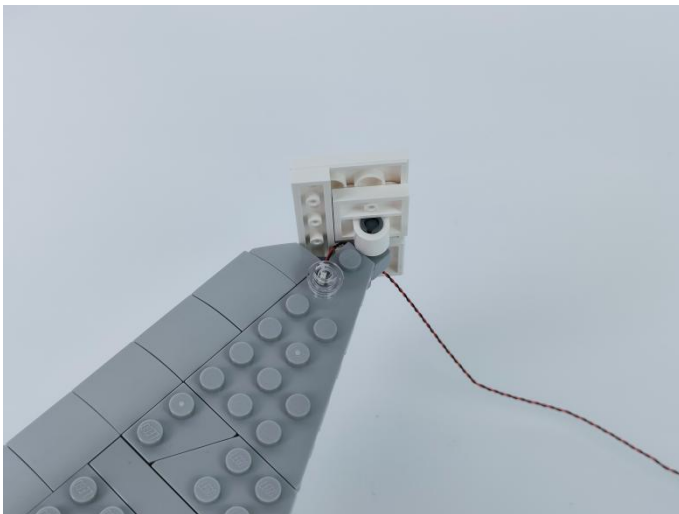

58

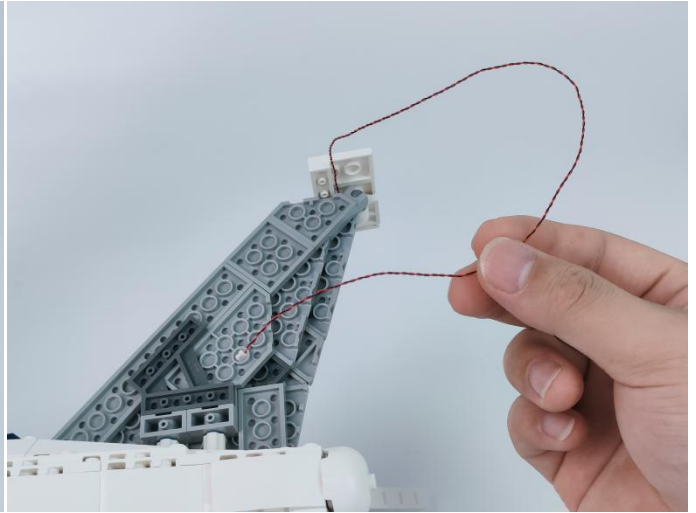
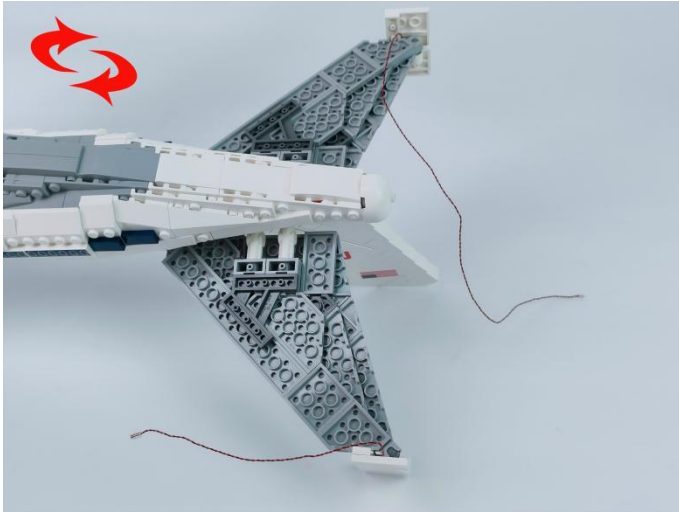

59

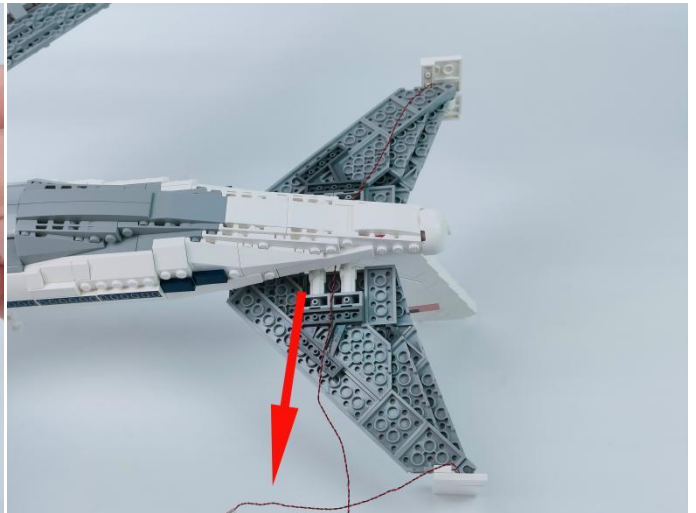
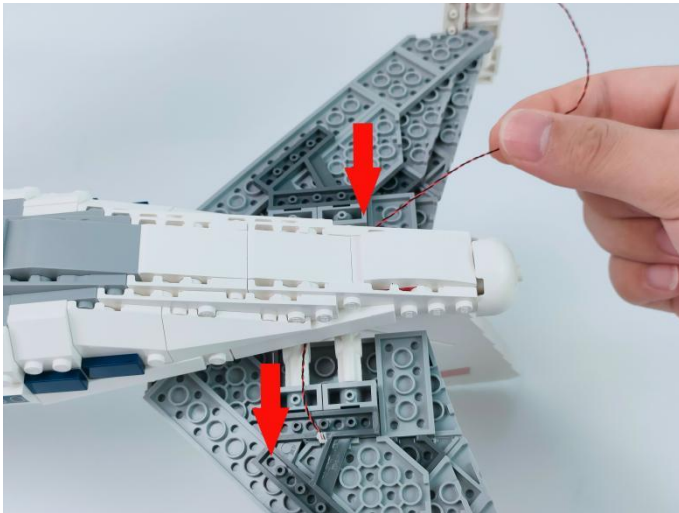

60

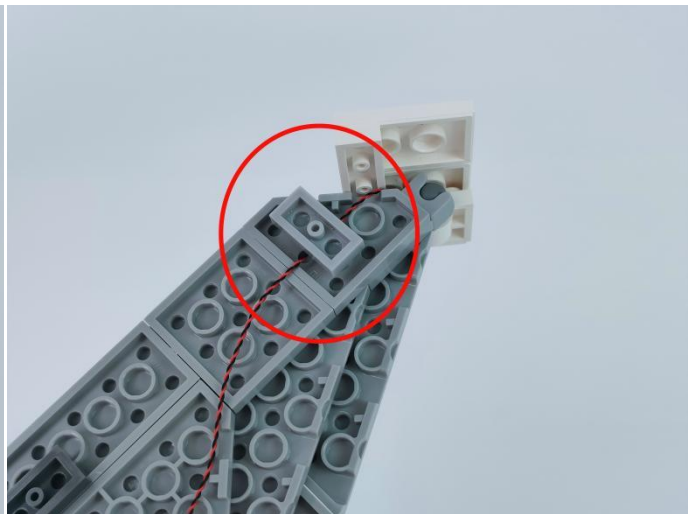
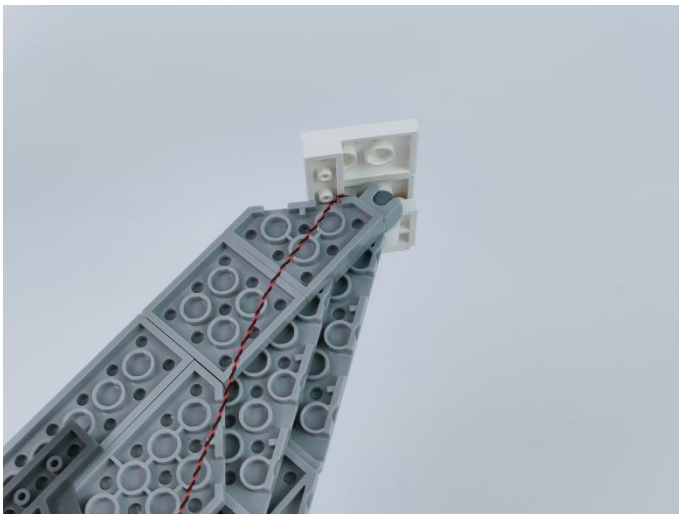

61

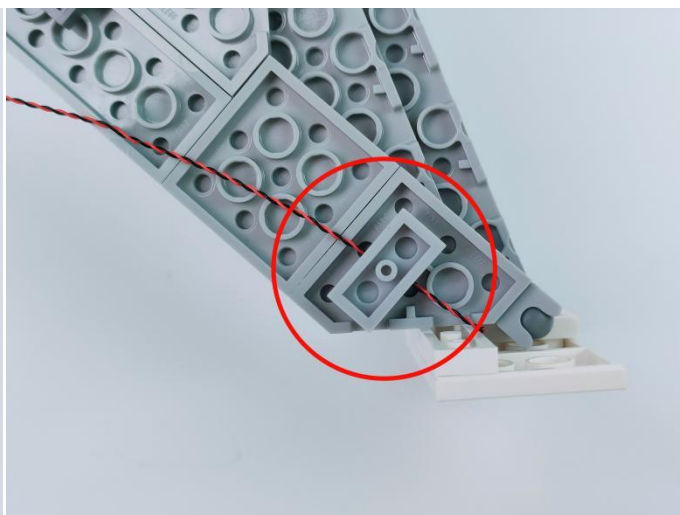
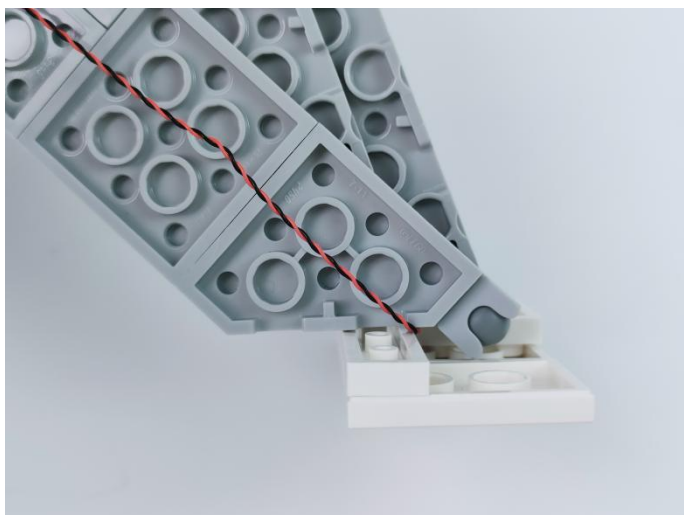

62

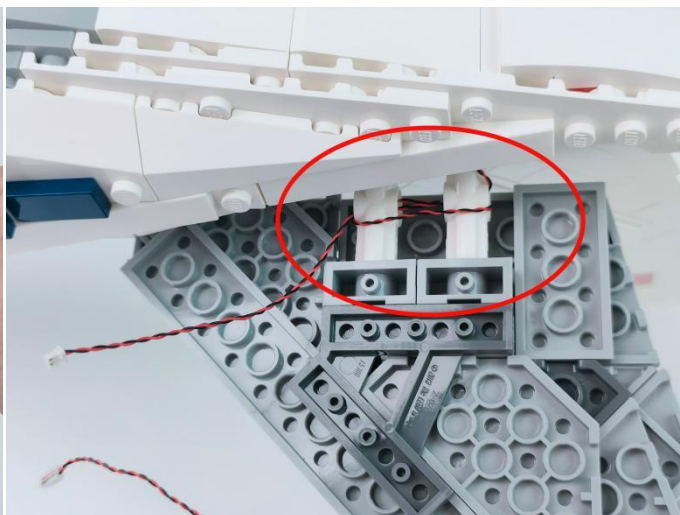
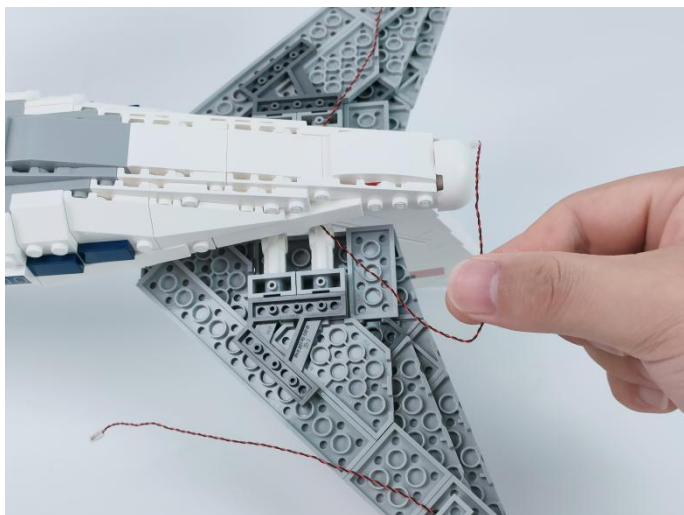

63

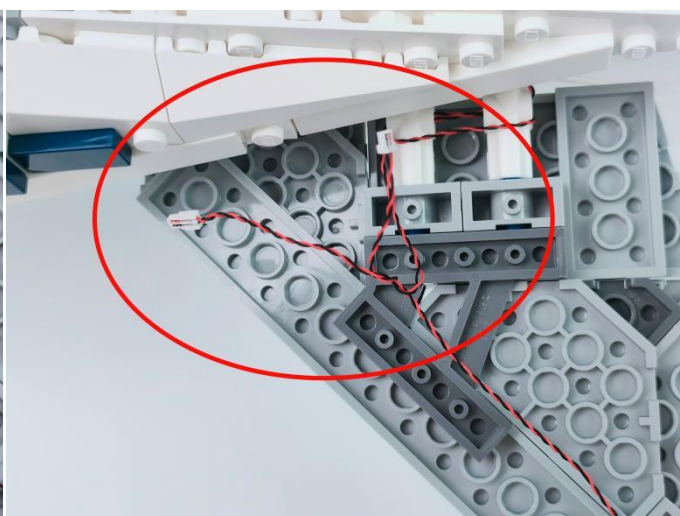
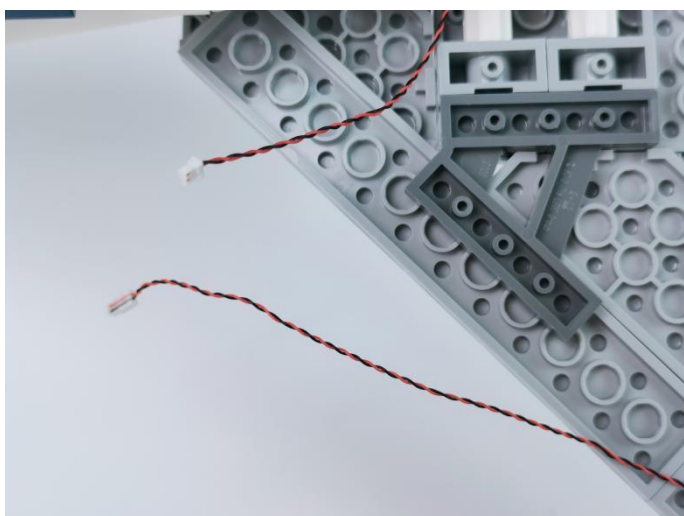



64

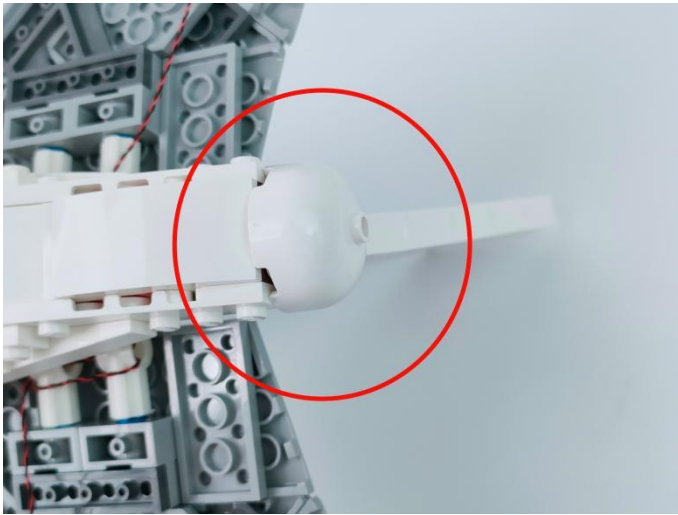

65



66

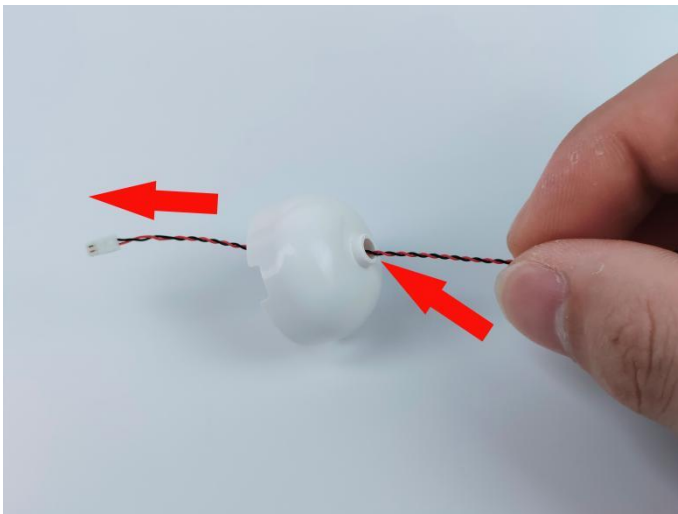



**67**

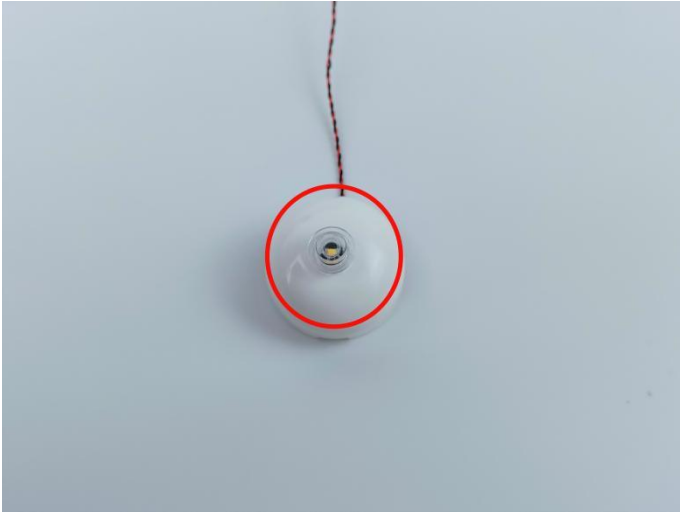

**68**

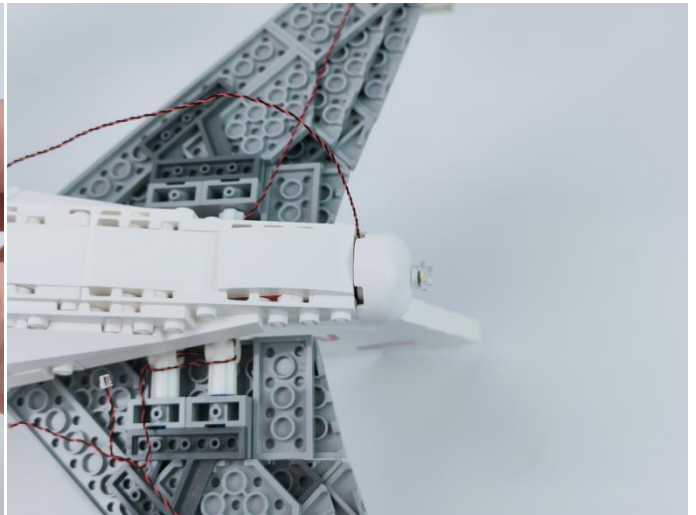
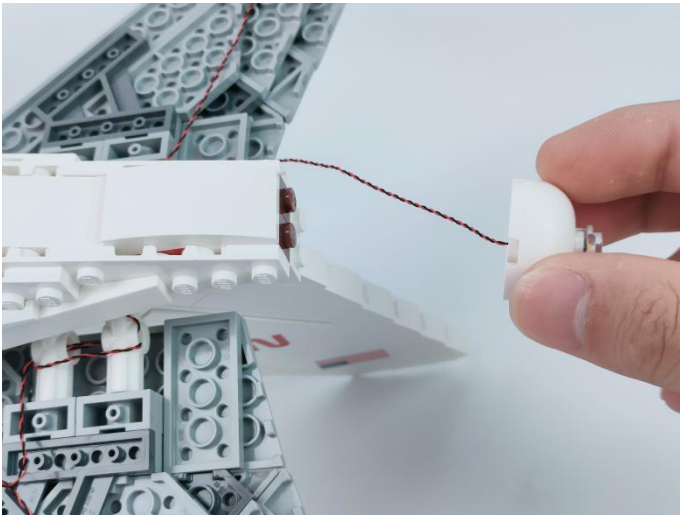

**69.** This part is installed, please move it to the side.



70



71



72



73



74



75

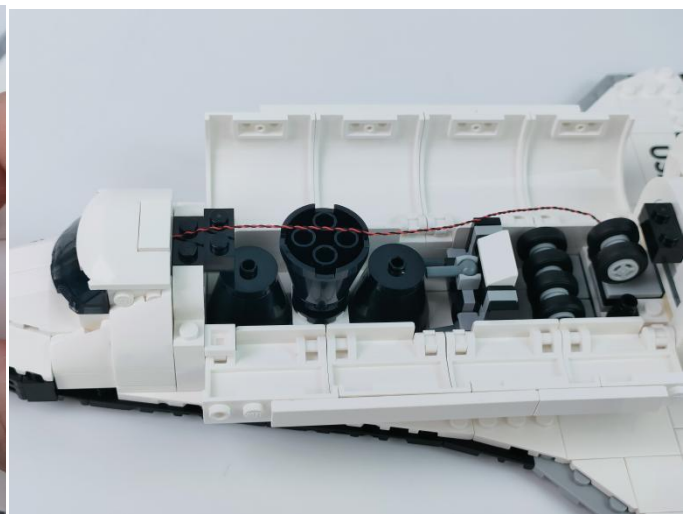
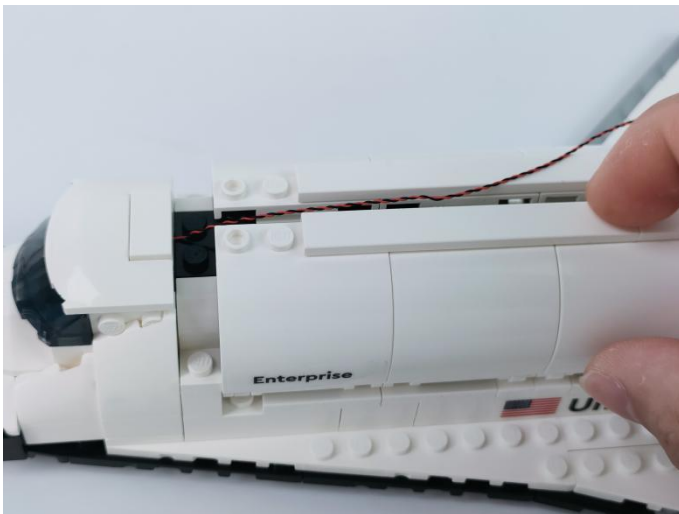

76

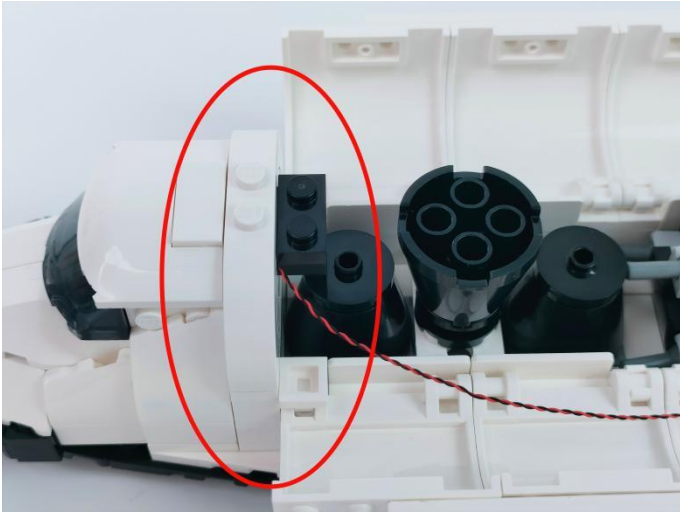

77

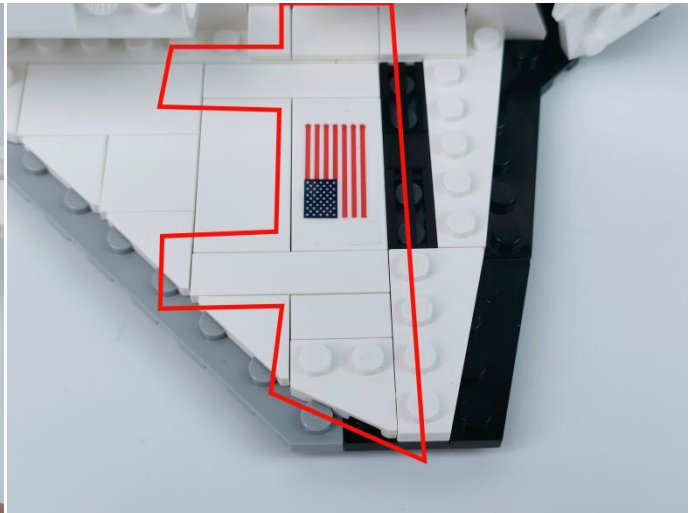
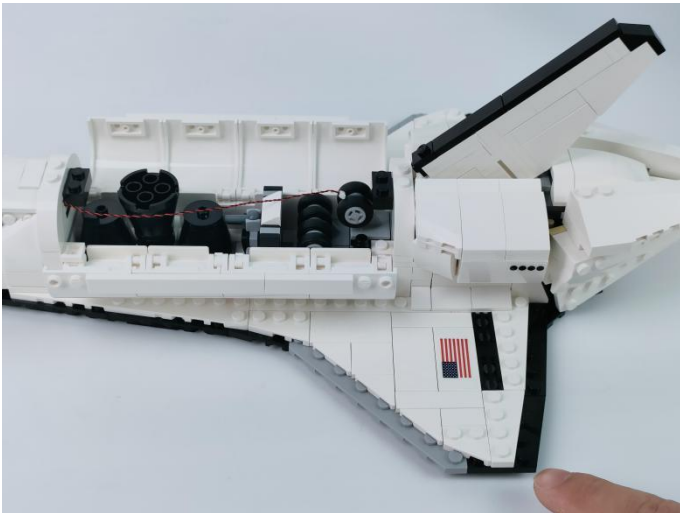

78

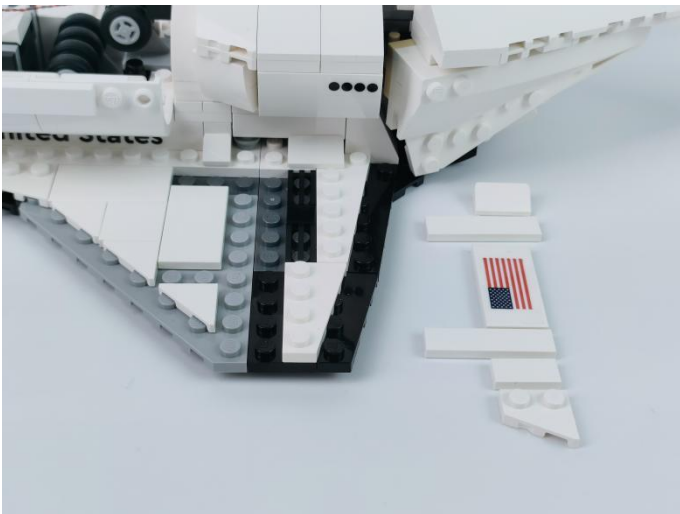



79



80

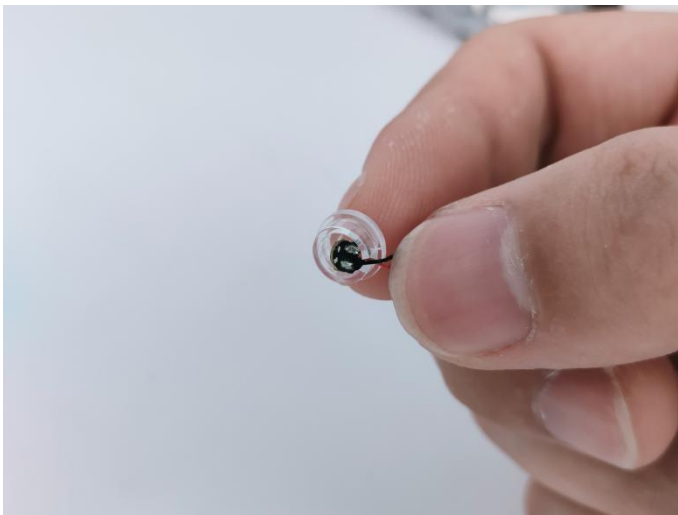

**81.** Please pay attention to placing the lighting line between the protruding points of the building blocks.

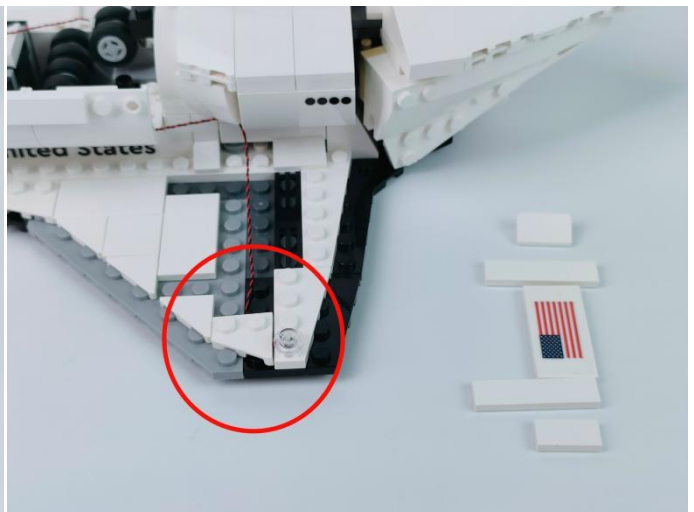
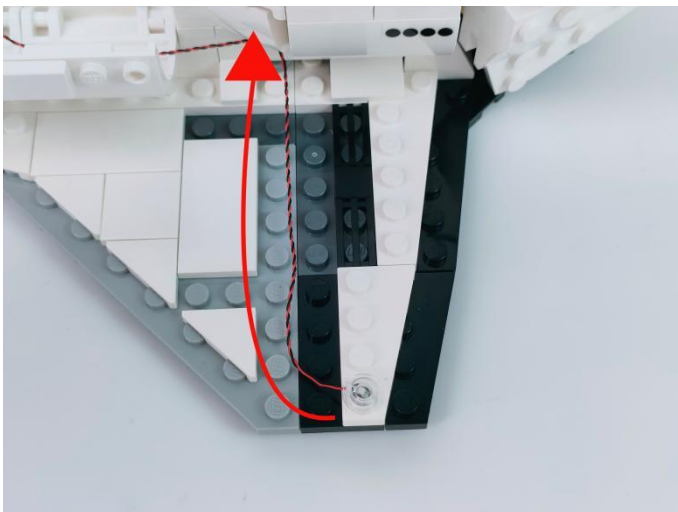

82

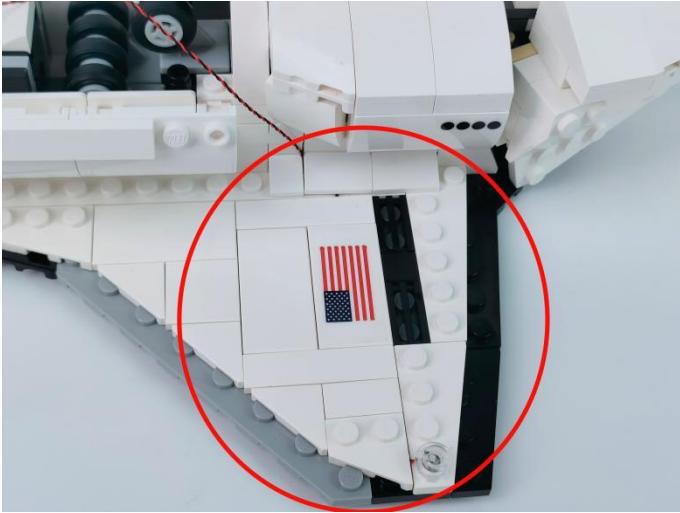

83

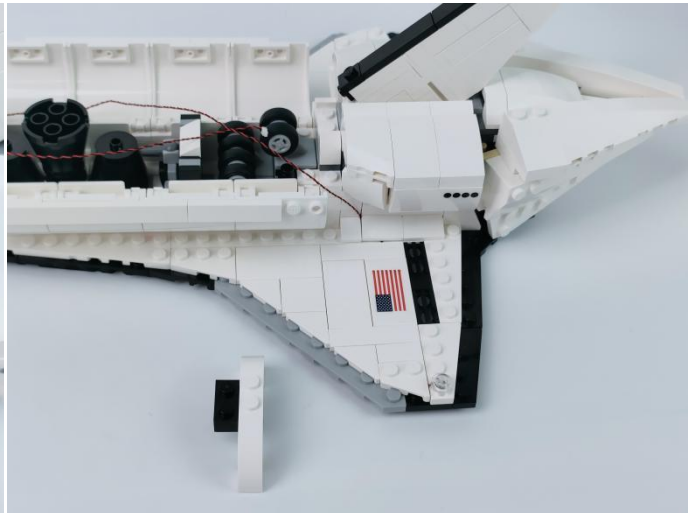
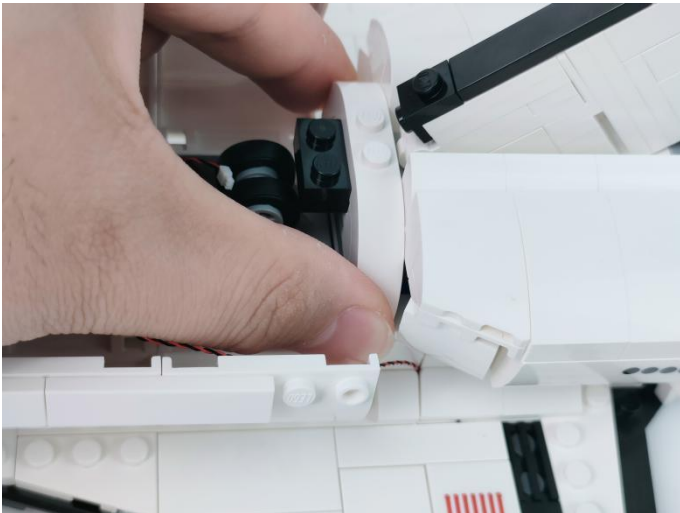

84

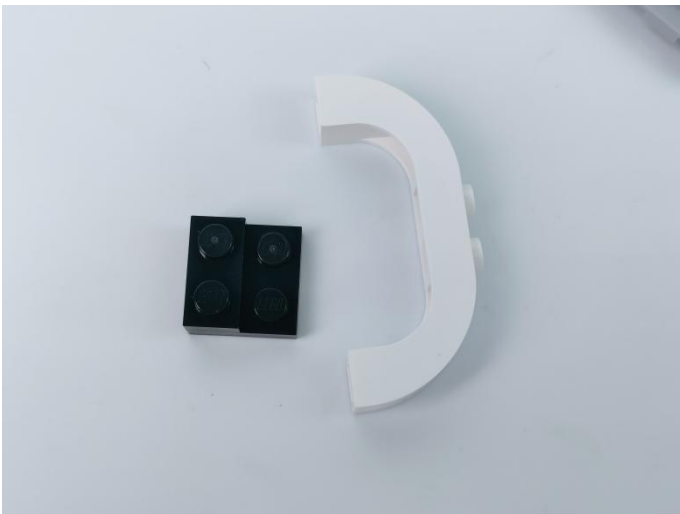

85

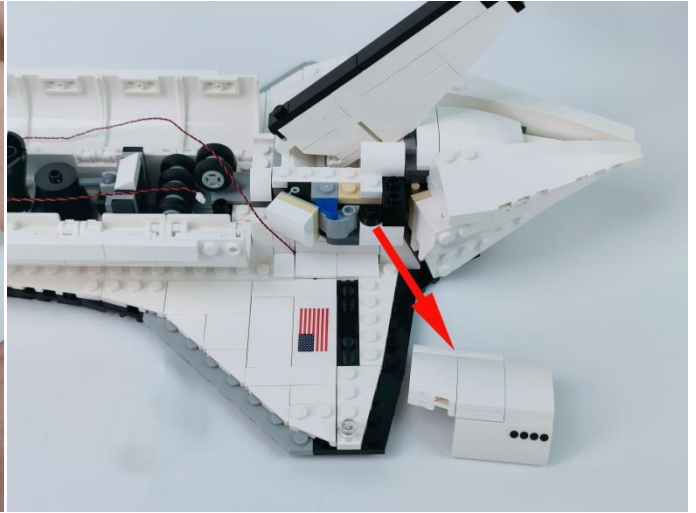

86

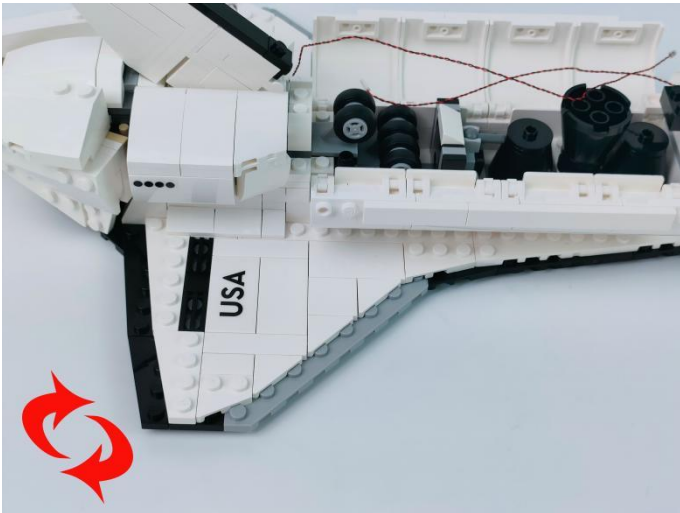

87

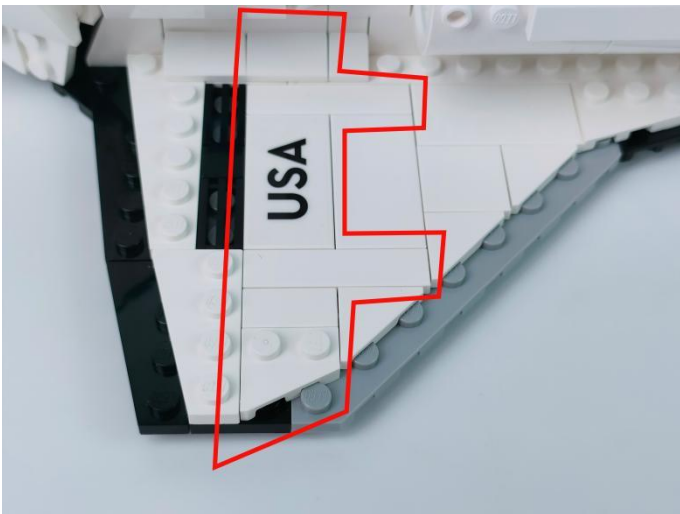



**88.** Please pay attention to placing the lighting line between the protruding points of the building blocks.

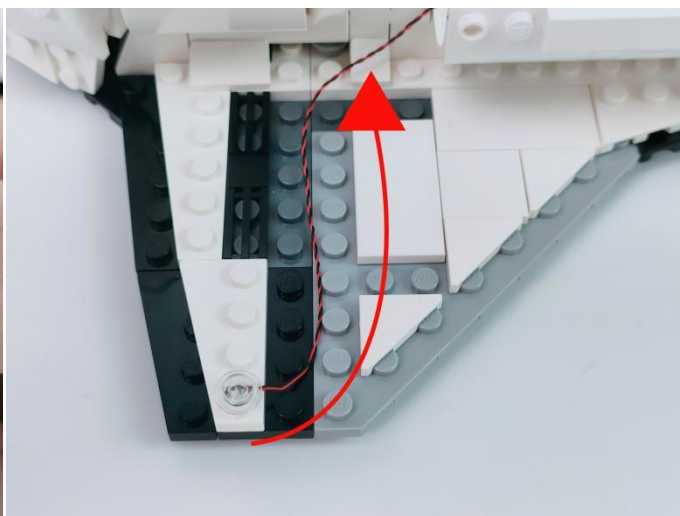
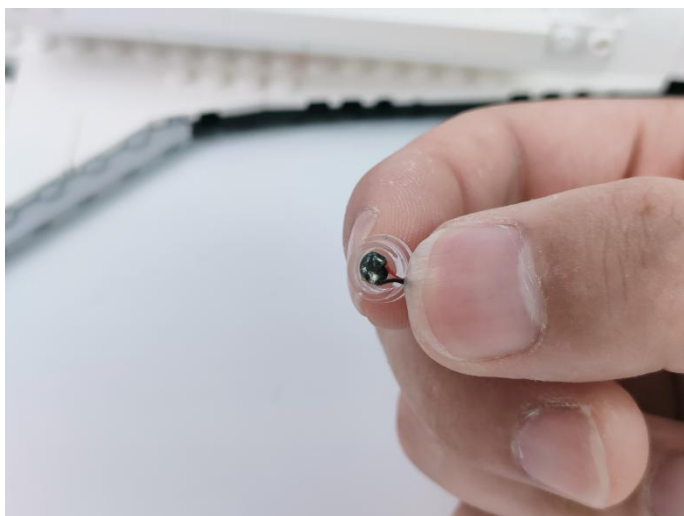

**89**

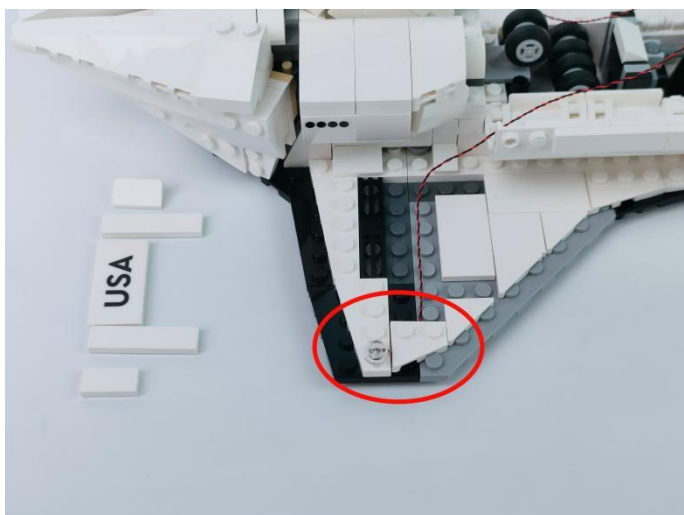

**90**

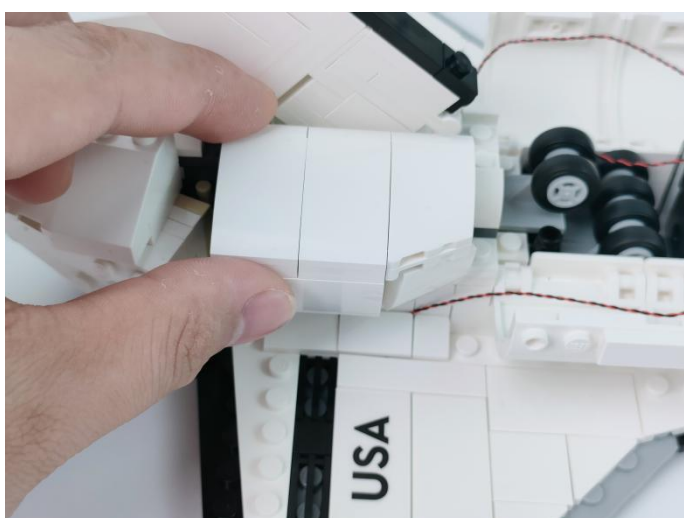



**91.** Twist two lighting wires into one strand and place them between the building blocks.

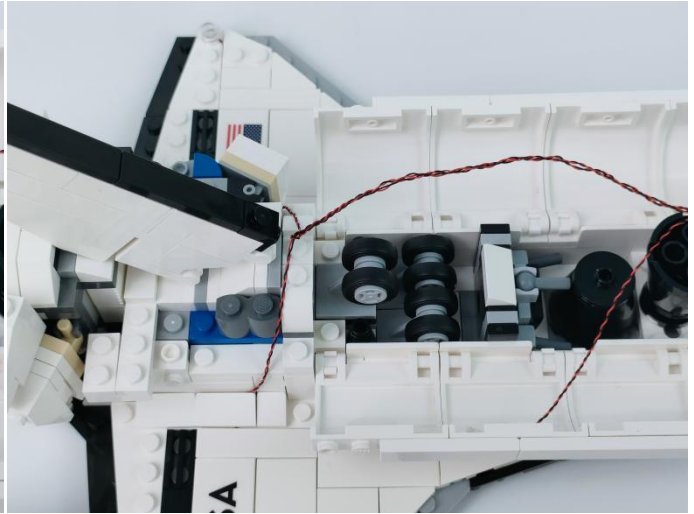
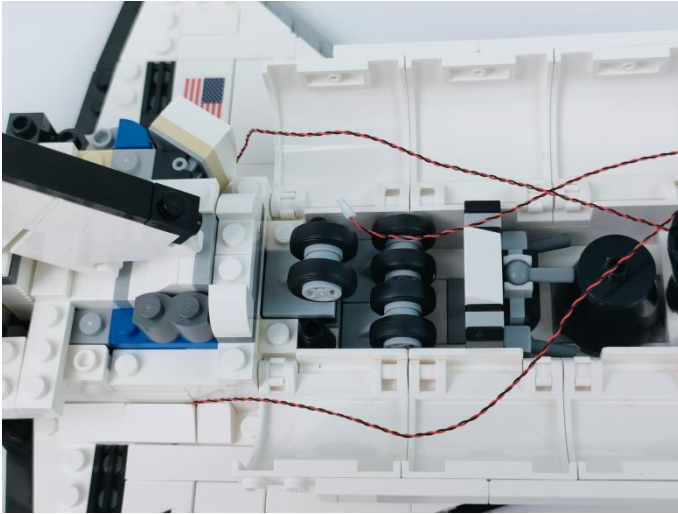

**92**

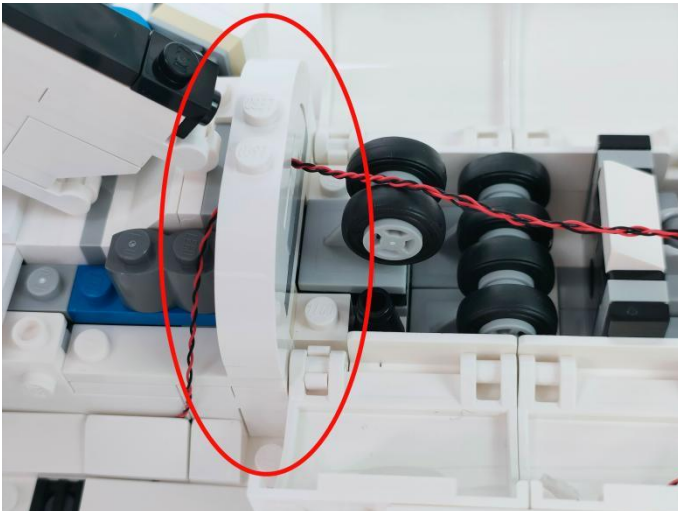

**93**

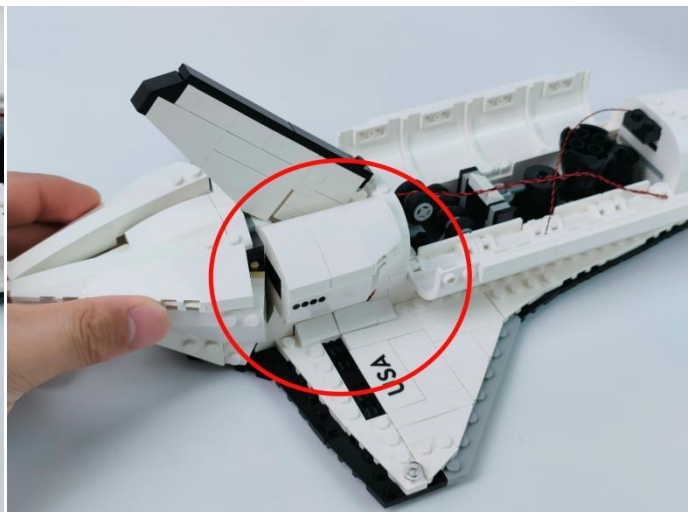
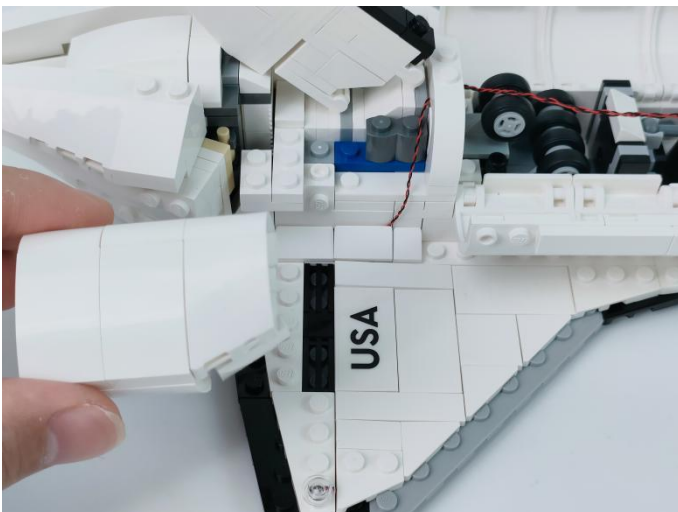

94

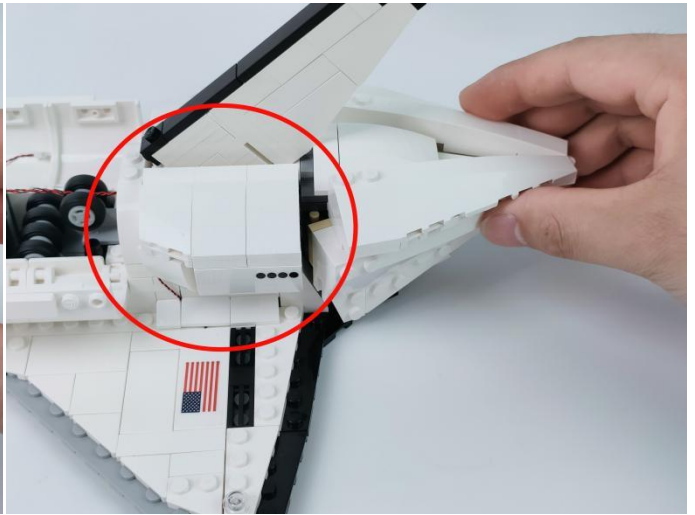
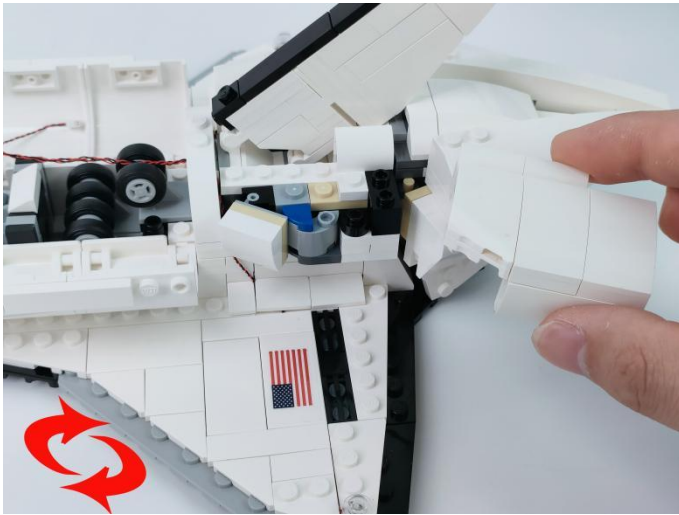

95



96

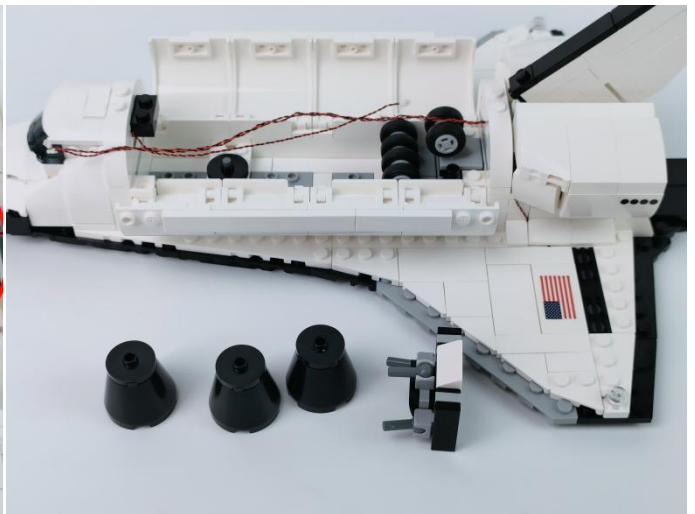
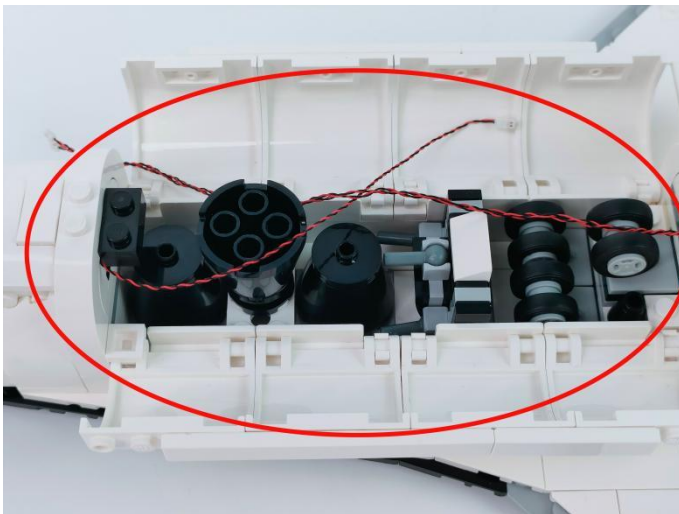

97



98



99

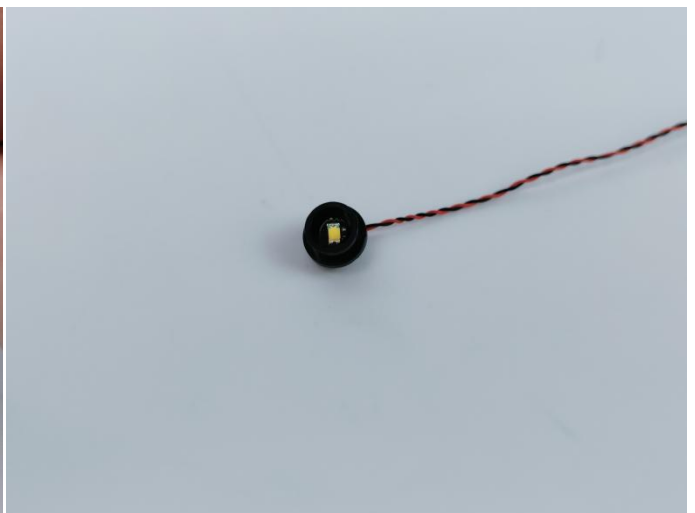
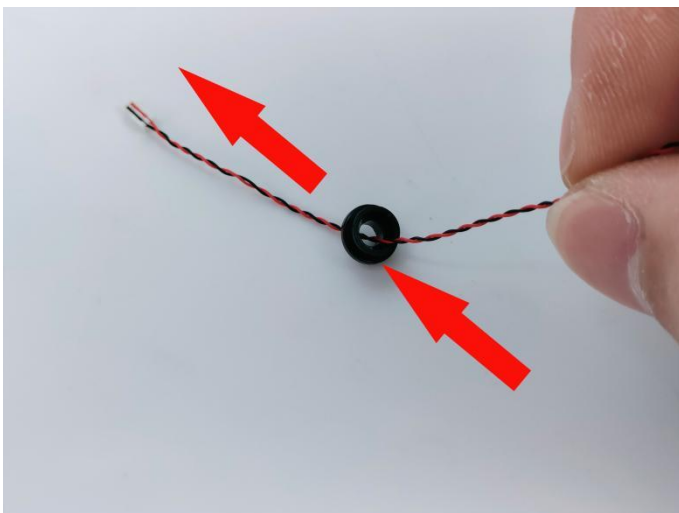



**100**

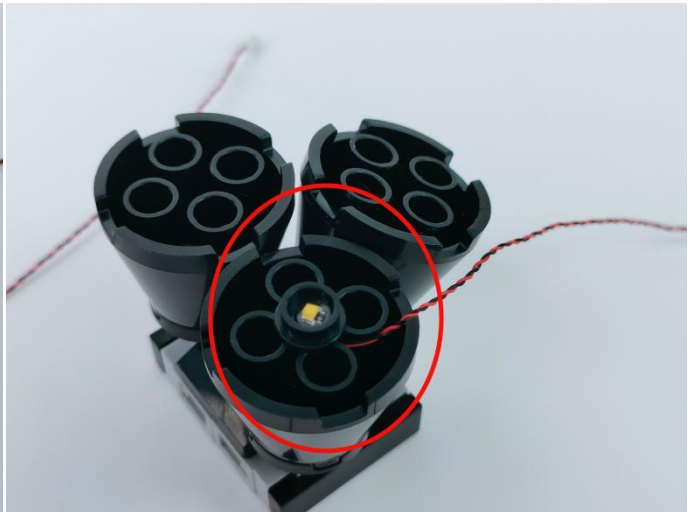

**101**

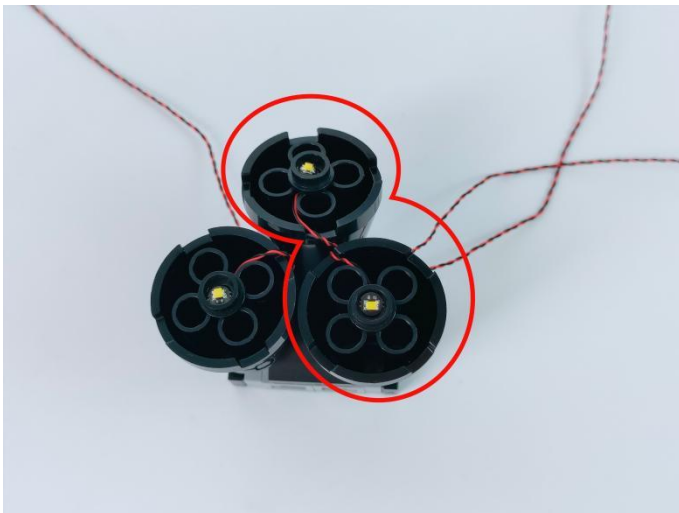

**102.**First, tighten the lamp wire and pull it towards the bottom of the building block, then remove the white building block part.





**103**

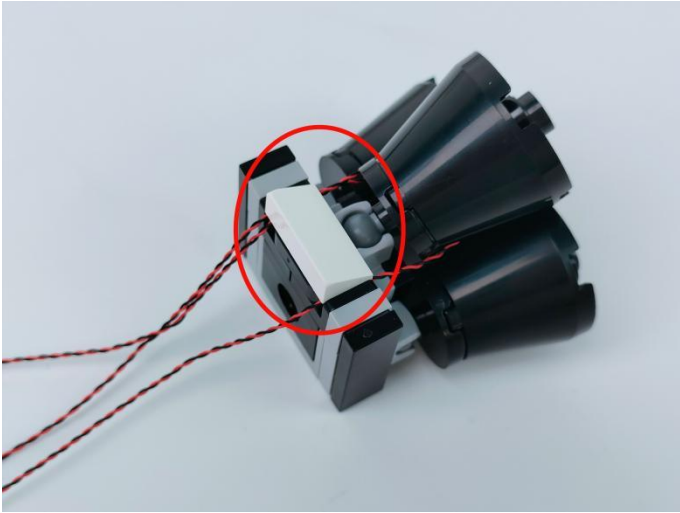

**104.** Install the engine building block components in the positions shown in the diagram. Be careful to keep the light wires outside during installation and remember not to press on them.

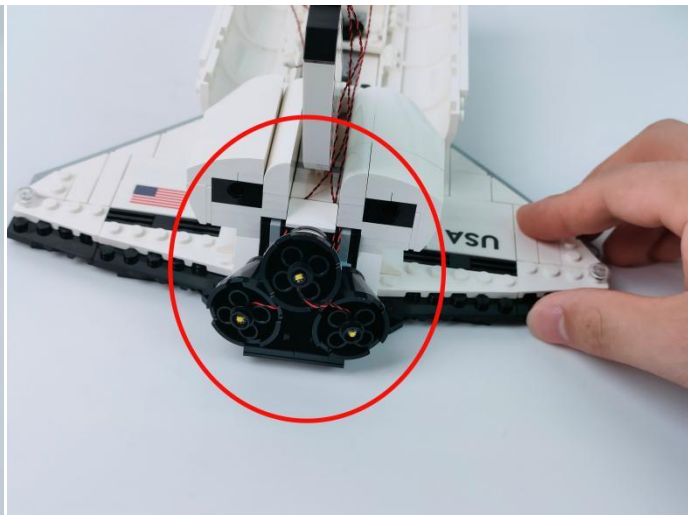

**105**

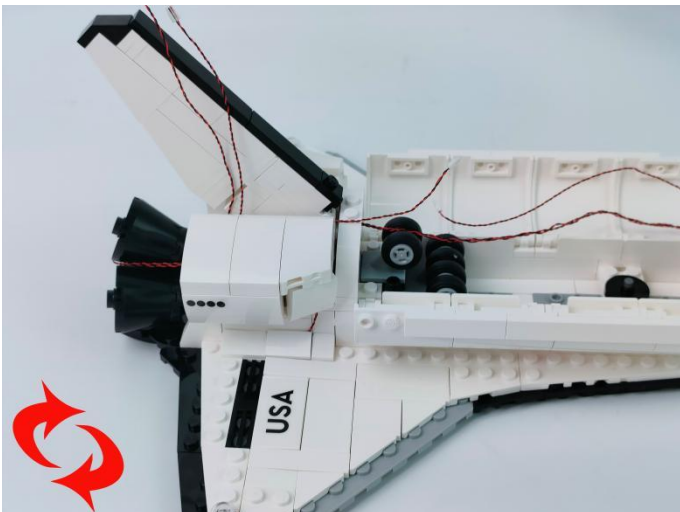

**106.** Remove the white Lego pieces. Pull the lighting wires backward and route them around the protrusions of the Lego pieces to avoid crushing the wires when restoring the Lego pieces. Finally, restore the white Lego pieces.

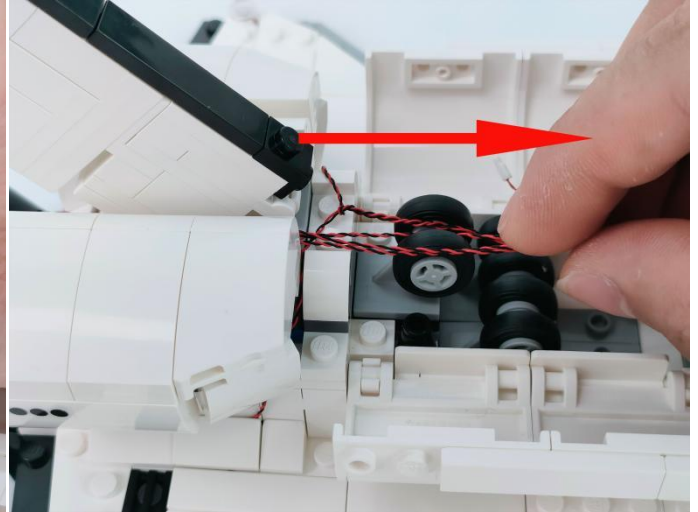
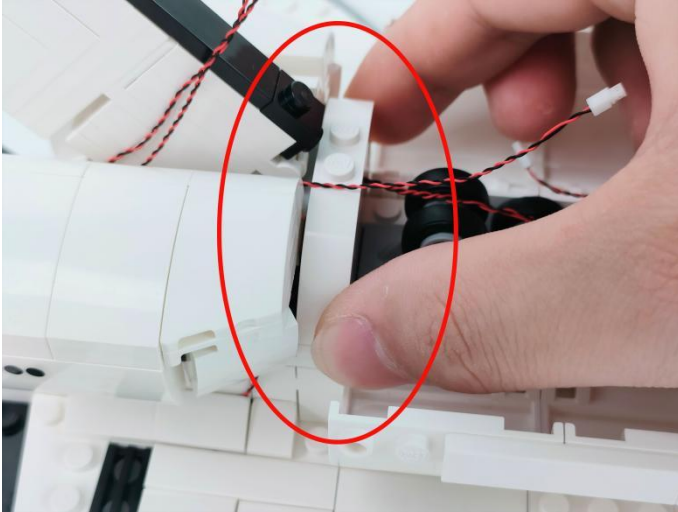

**107**

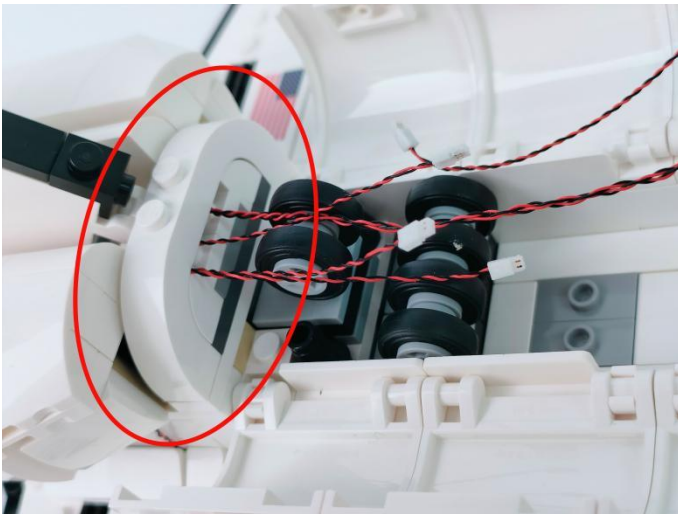

108



109

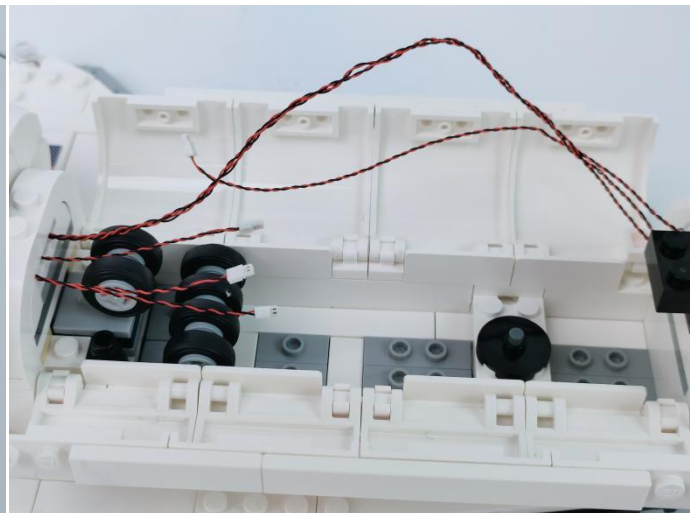

110

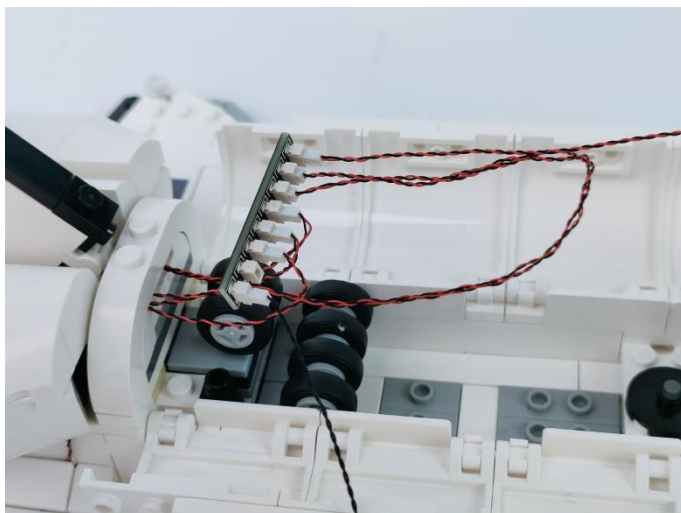



111

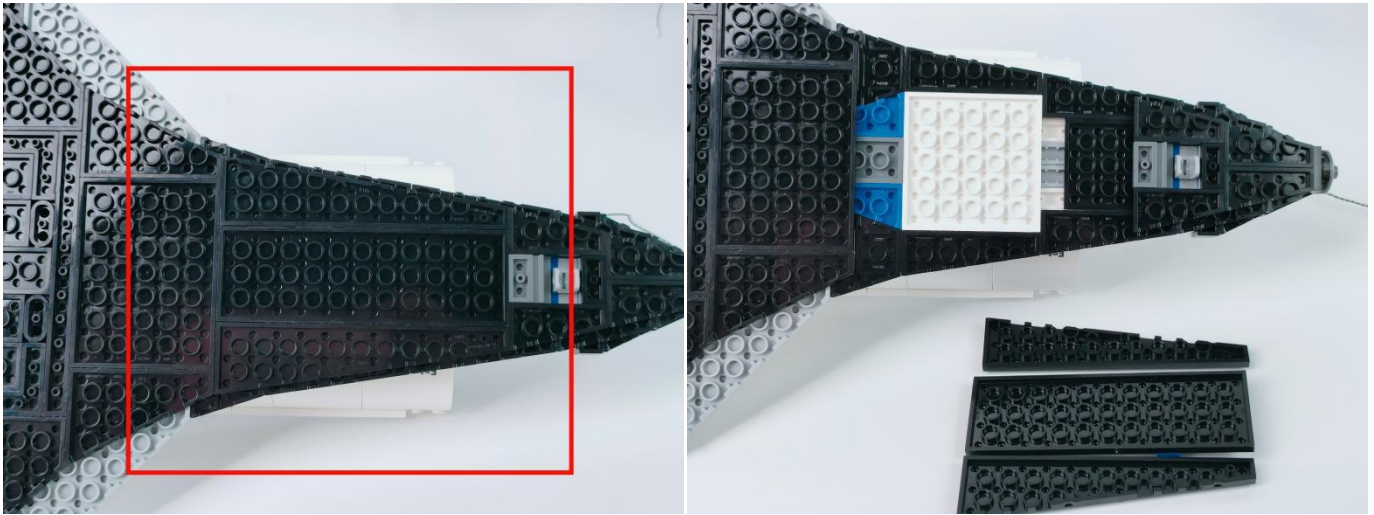

**112.** Pull up the lamp cord and then restore the building blocks in order.

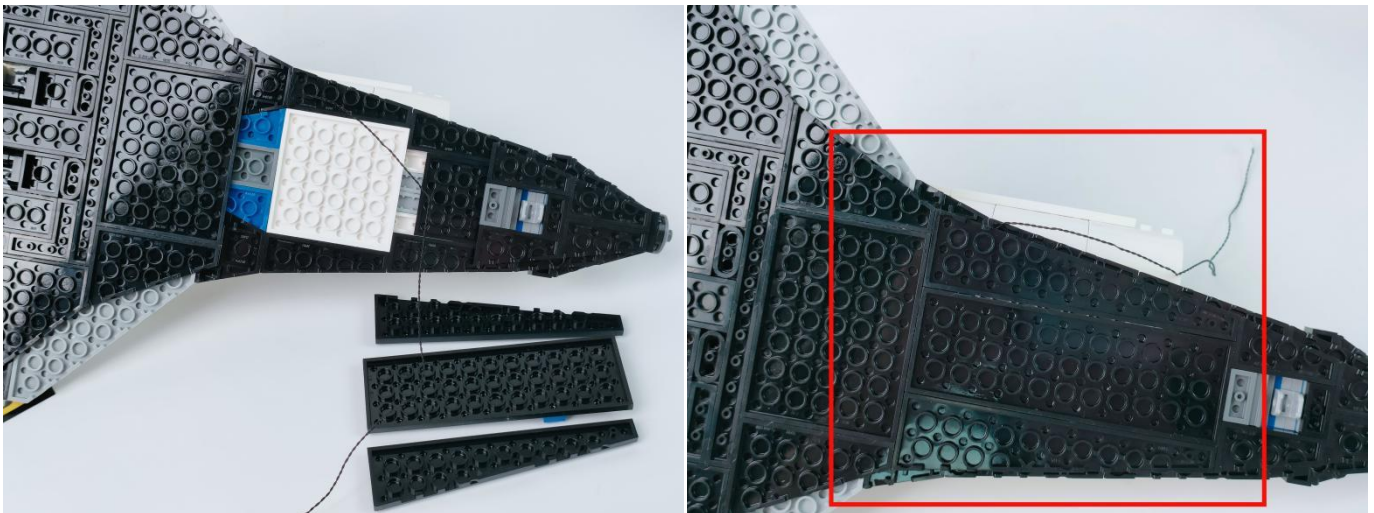

113

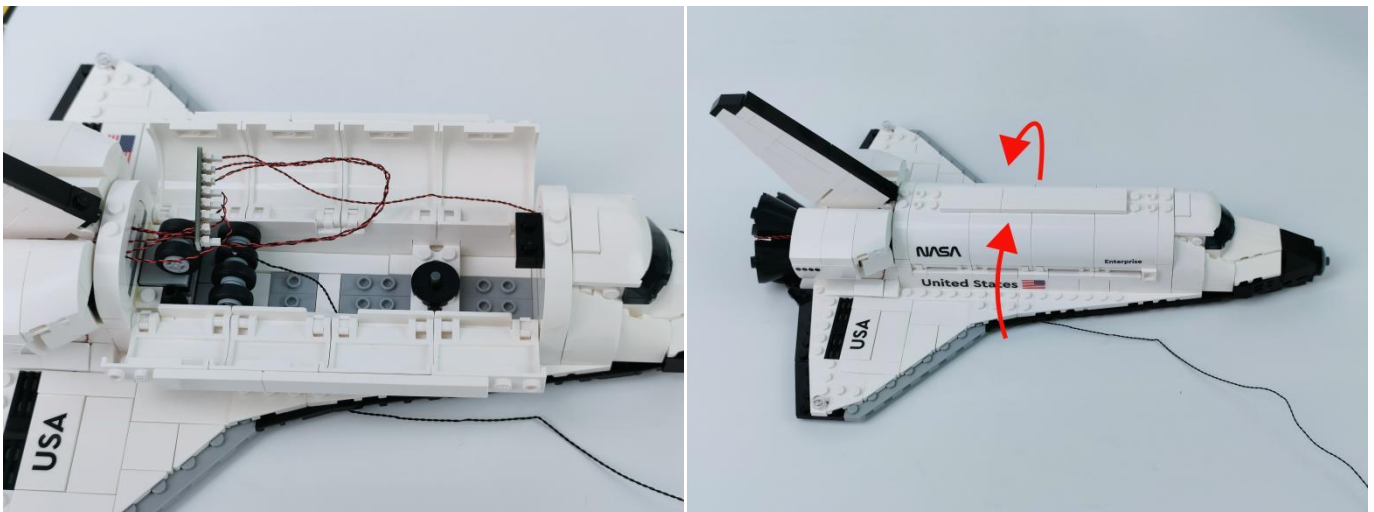



**114.**Take out the Boeing aircraft that was previously installed.



**115**



**116.**Twist the two lighting wires into one strand.

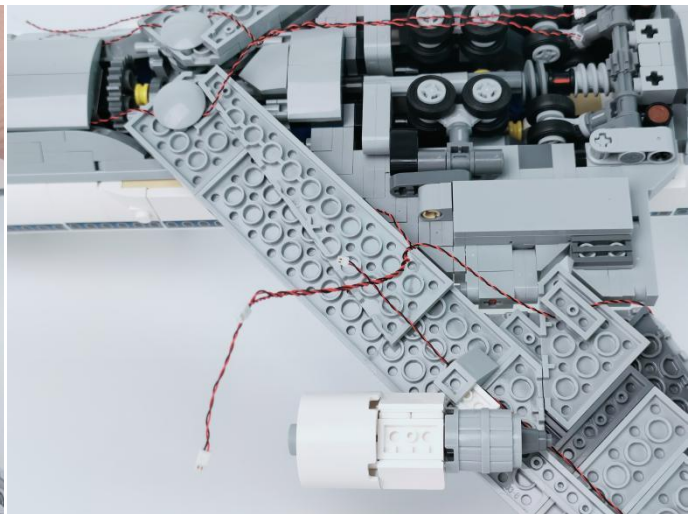
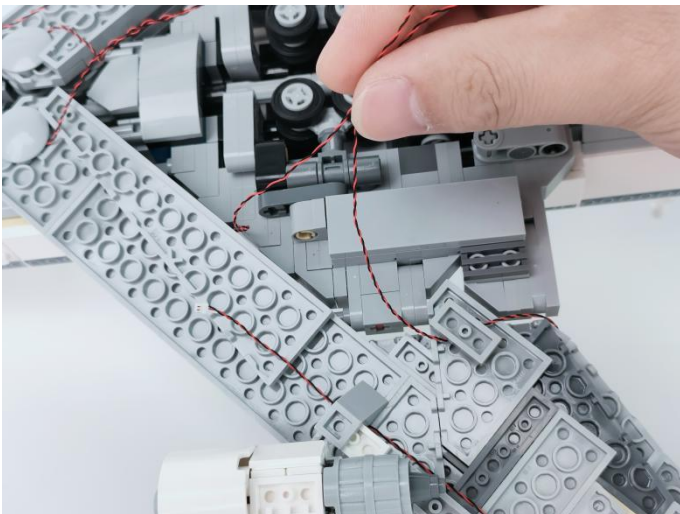

**117.** Tighten the lighting cable and tie it off.

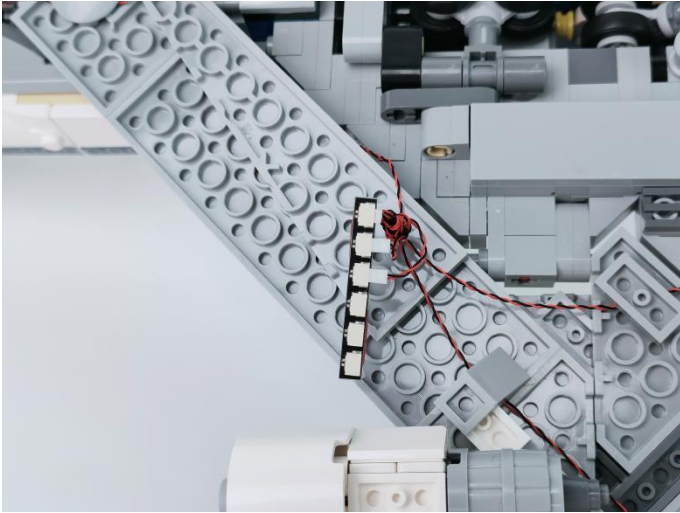

**118**

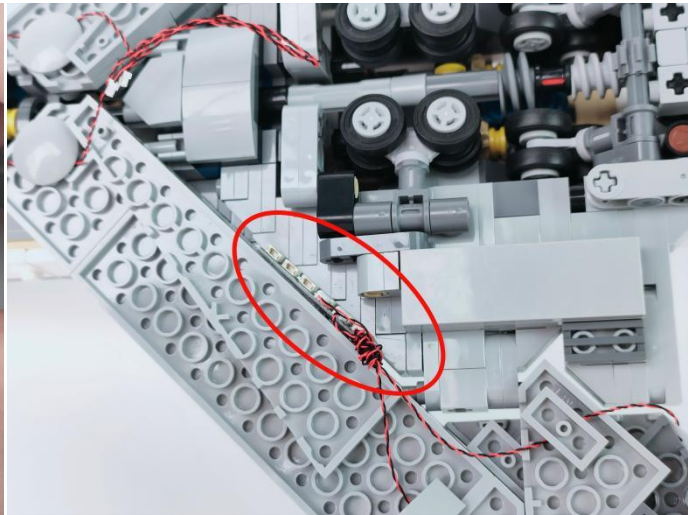
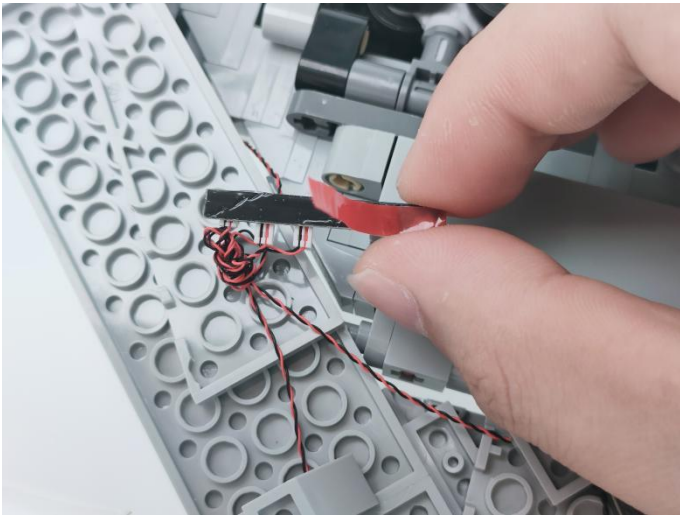

**119.** Find and select two lighting wires, and twist them into one strand.

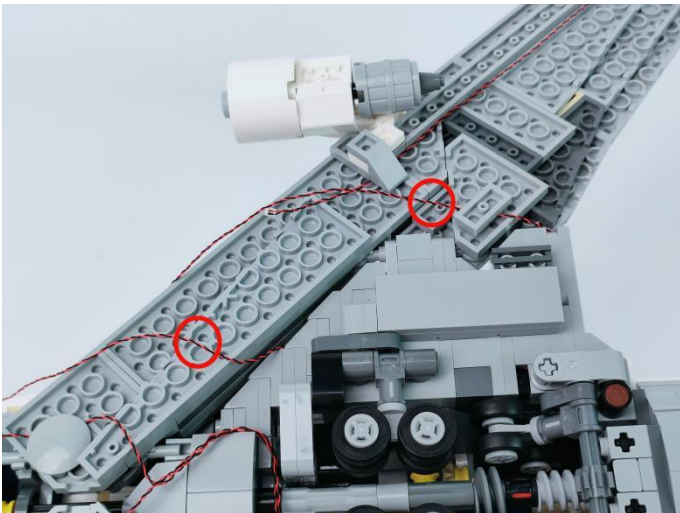



120

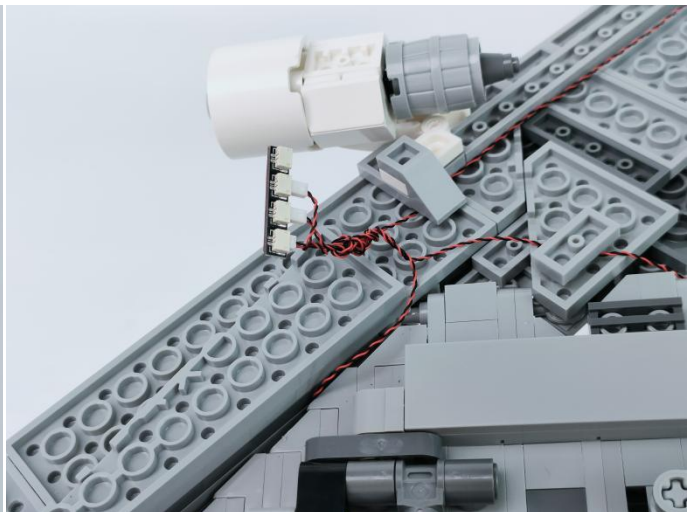

121

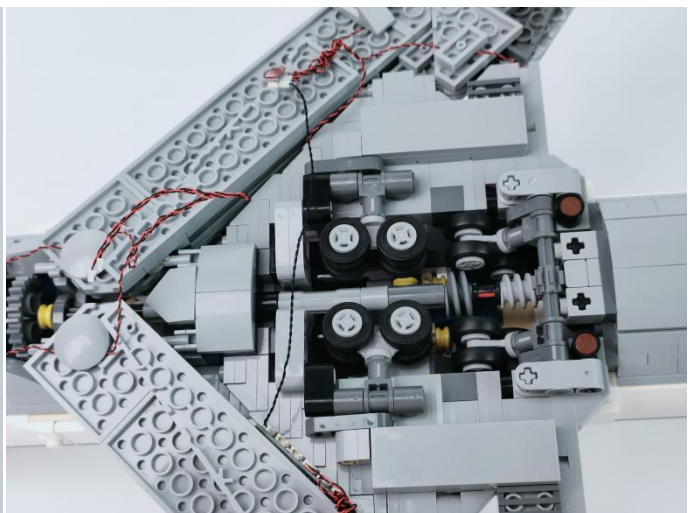

122

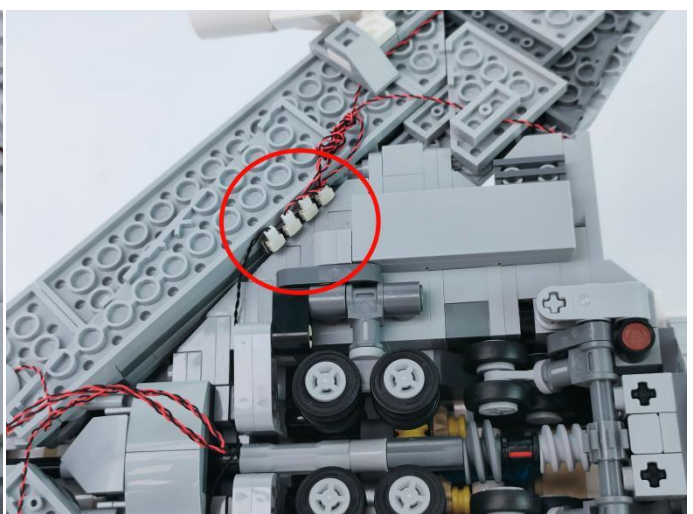

# 123

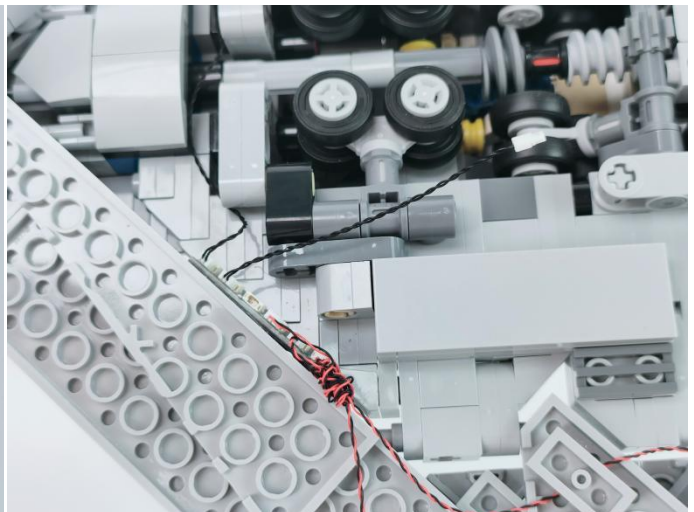

# 124

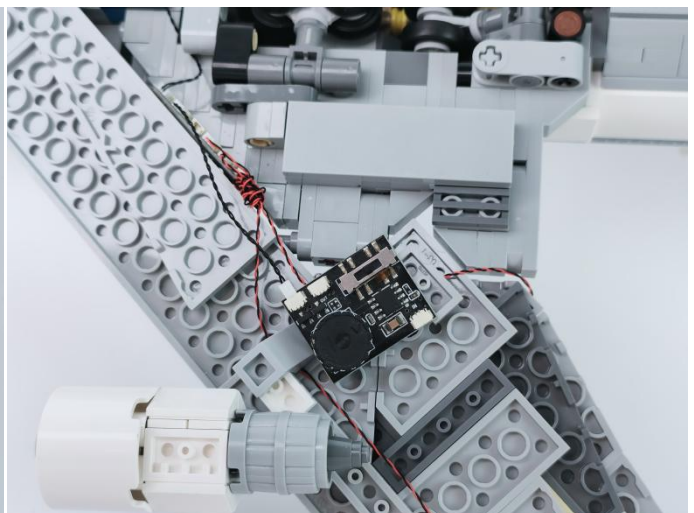

## Breathing Light Module Function Introduce

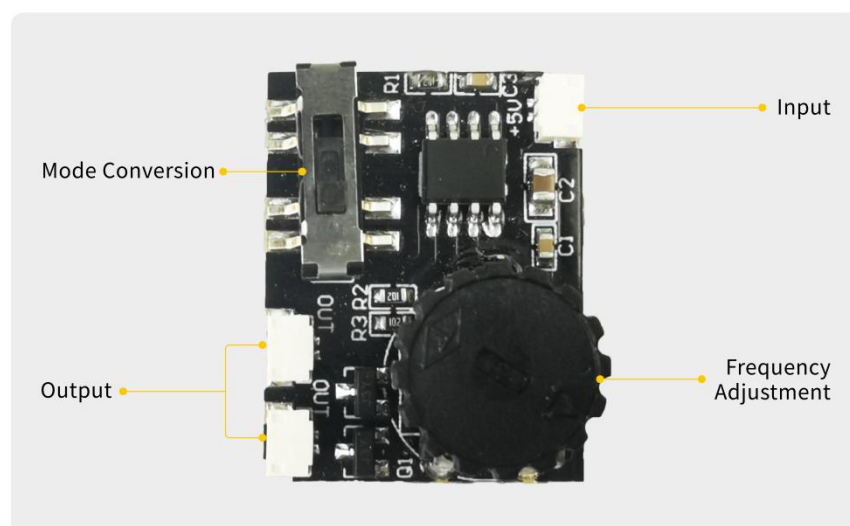



# 125

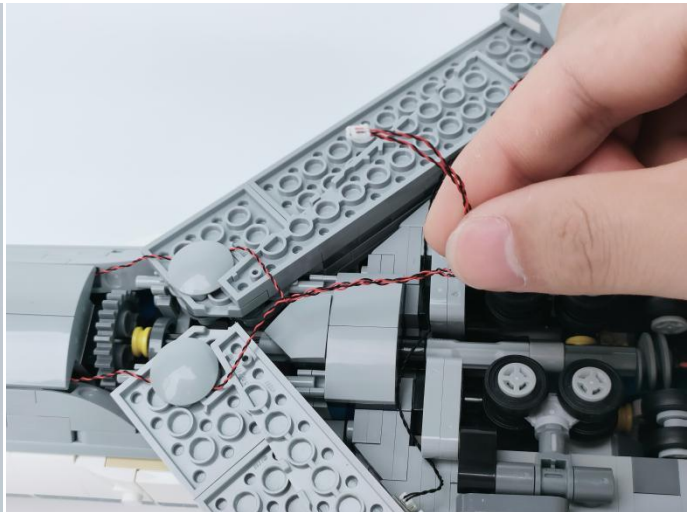

# 126

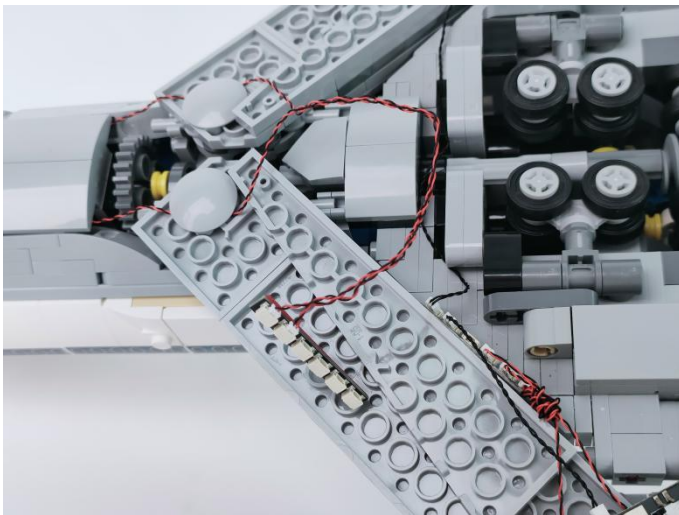

# 127

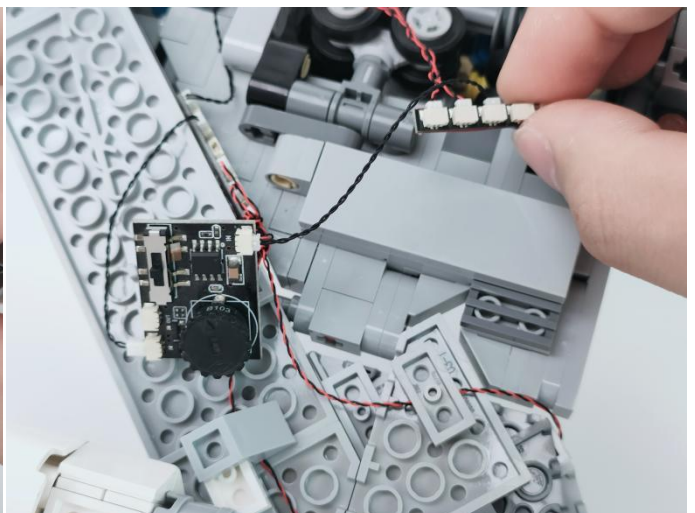
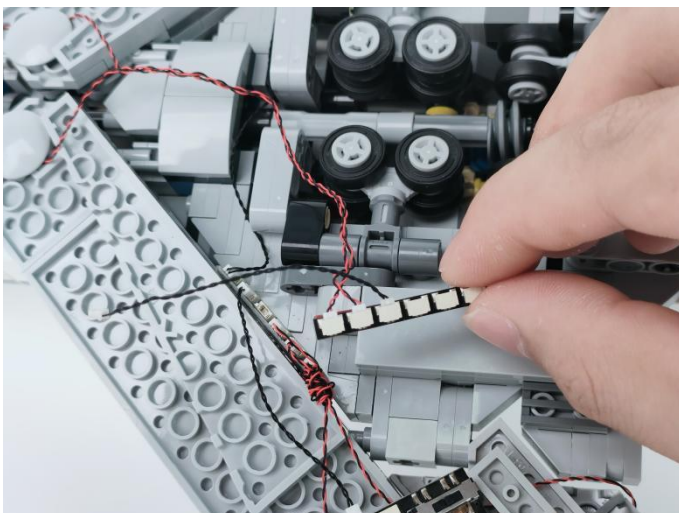

128



129

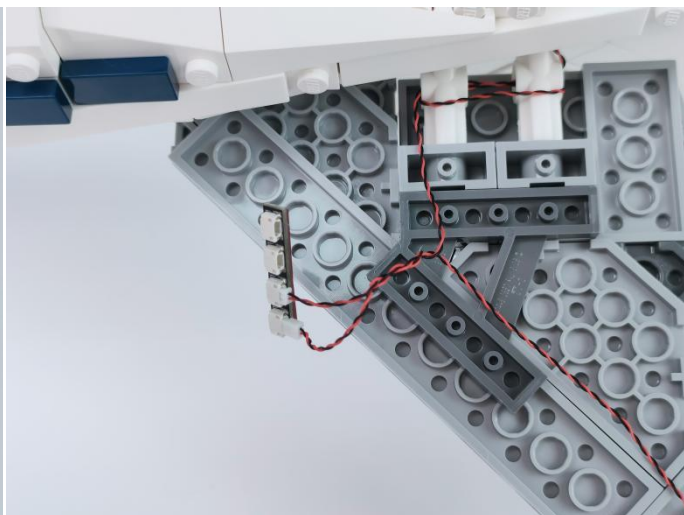

130

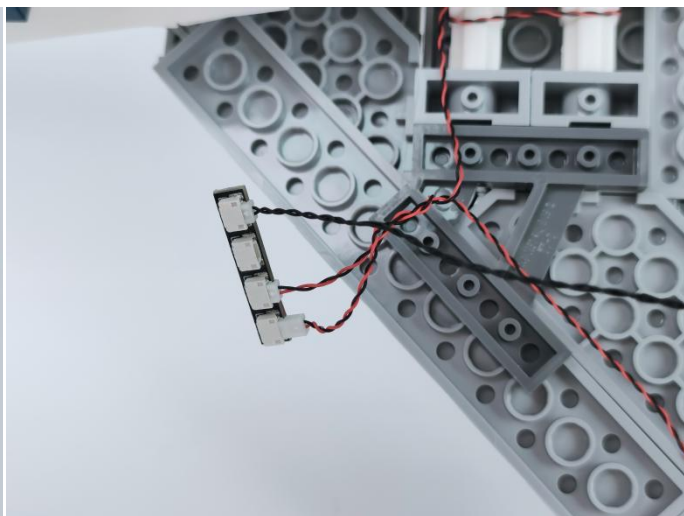



131

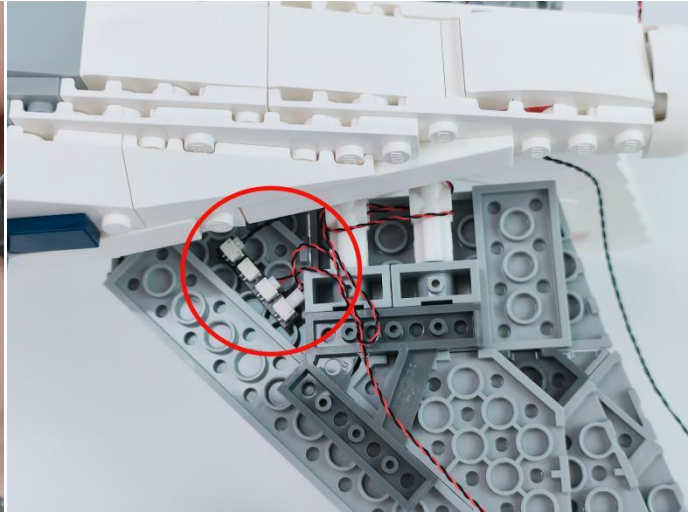
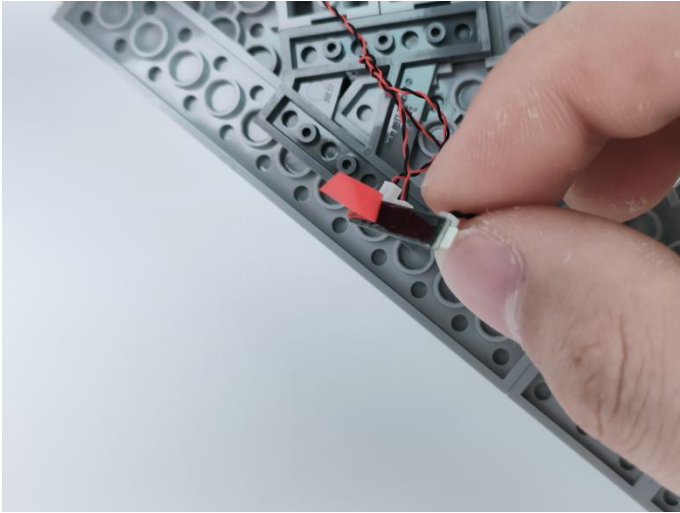

132

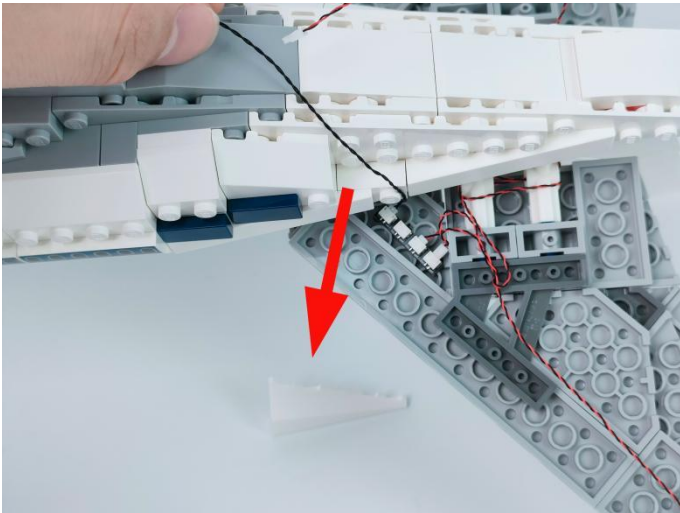

133

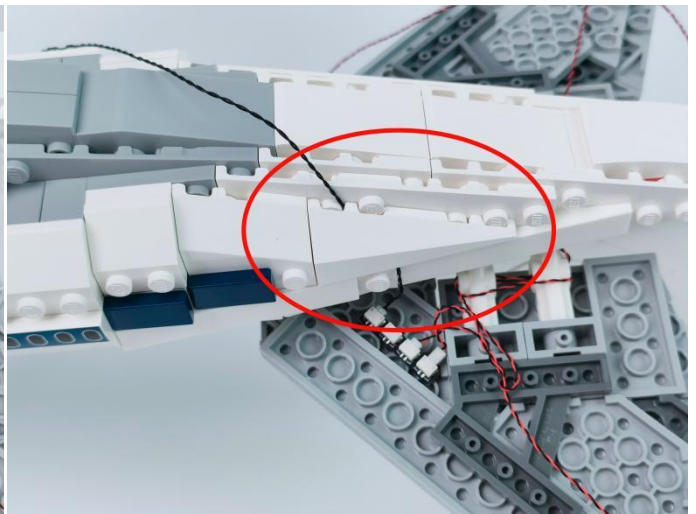
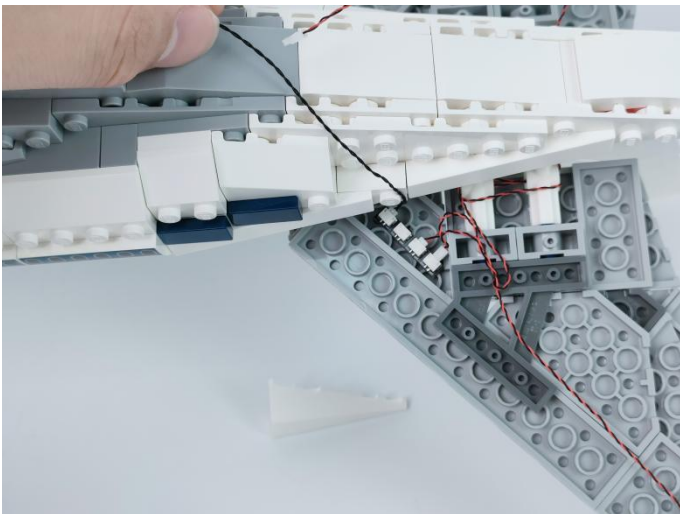

134

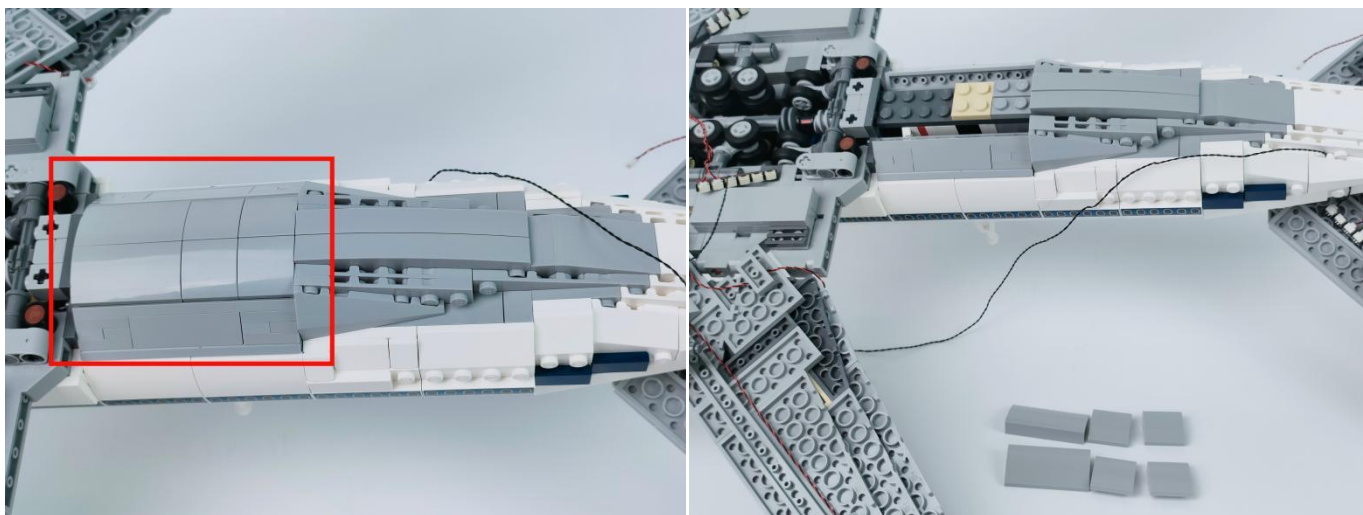

135. Open a gap in the building block components.

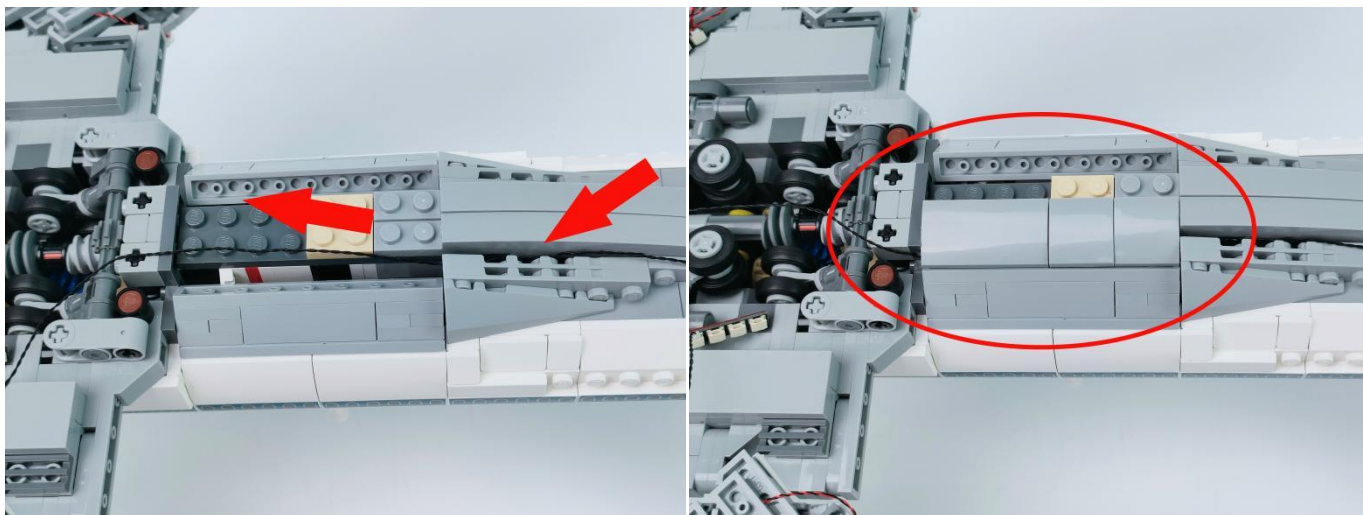

136

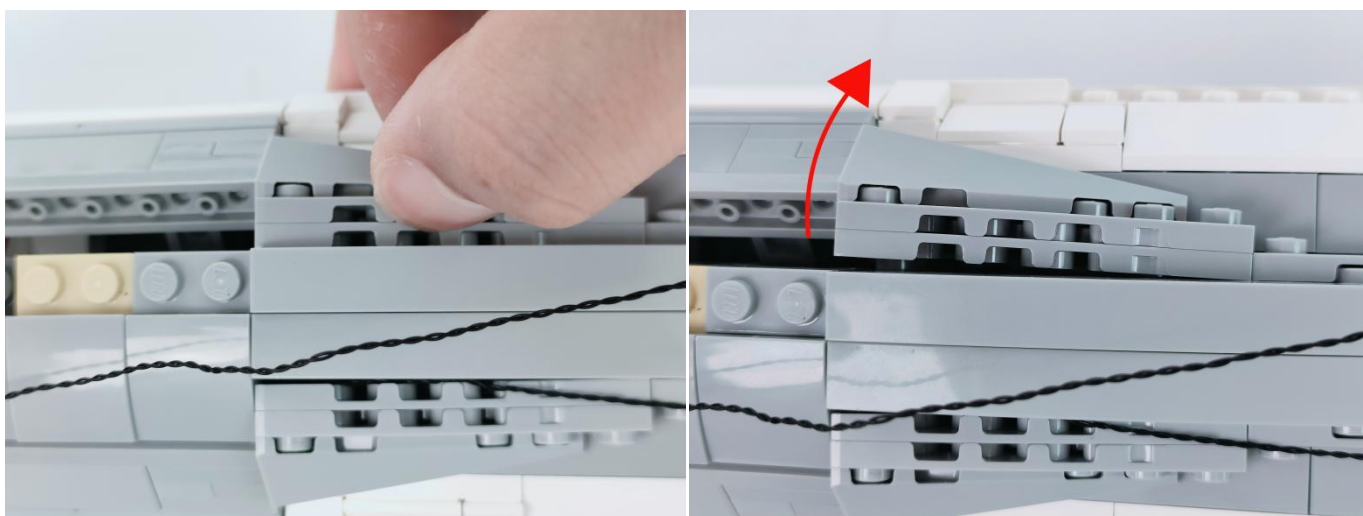



137

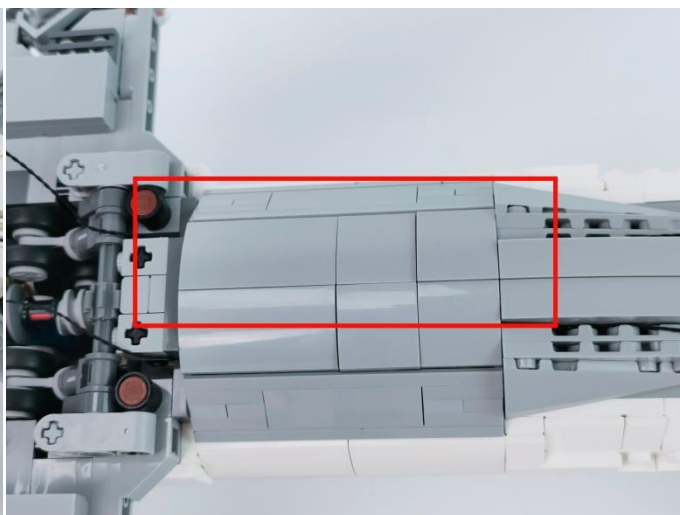
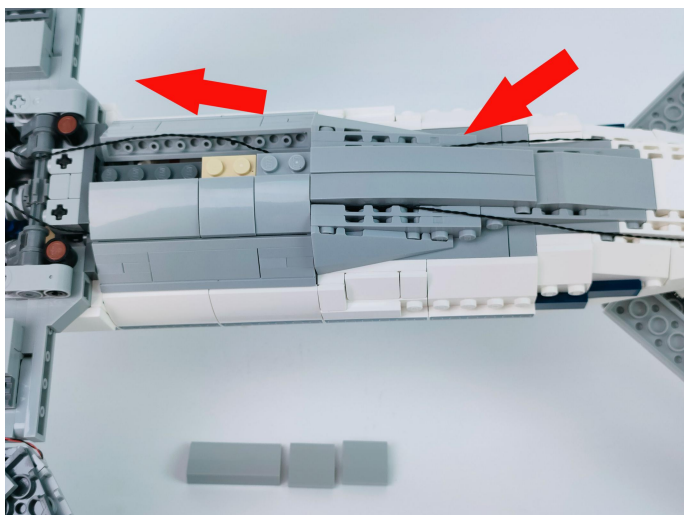

138

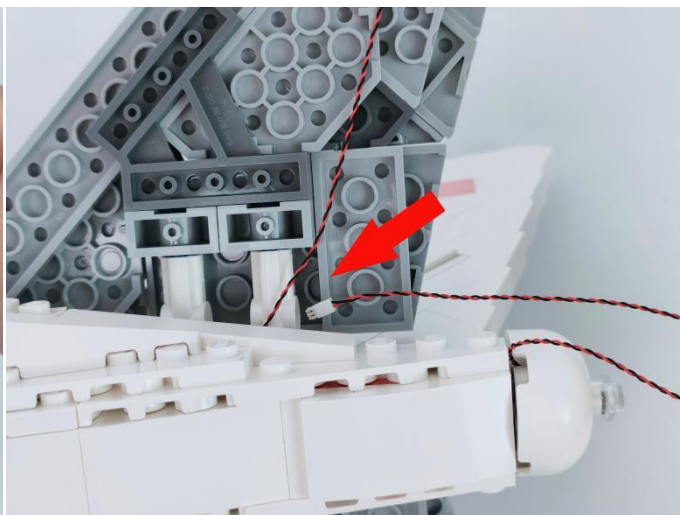
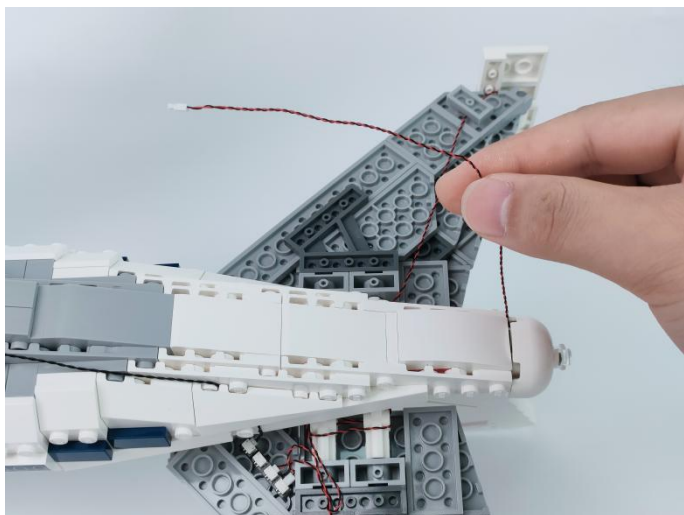

139

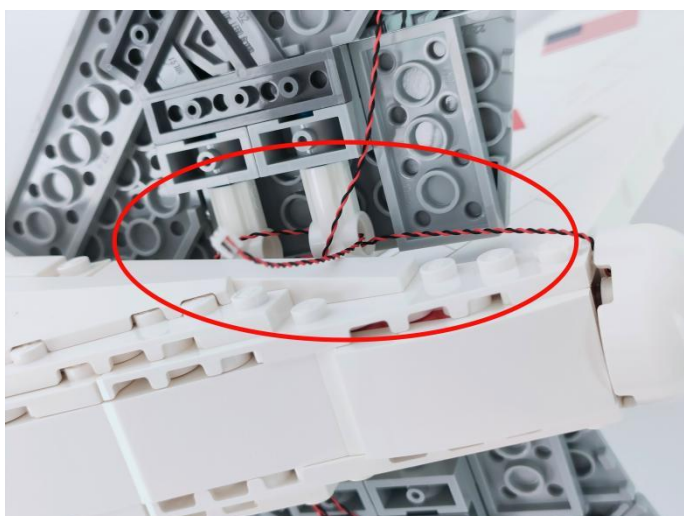

140

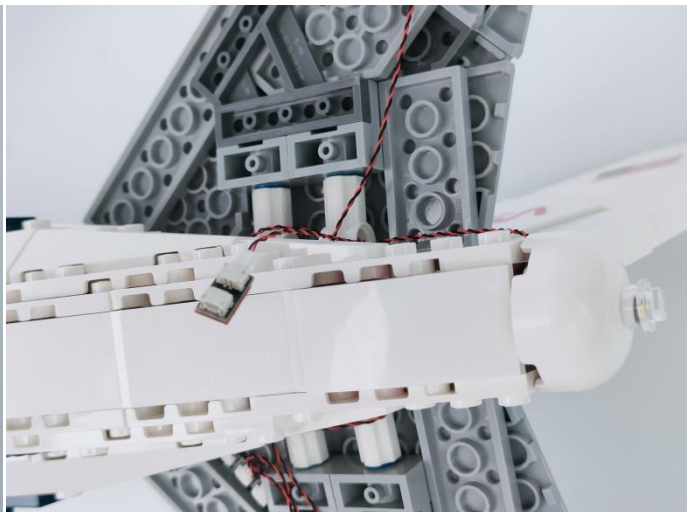

141

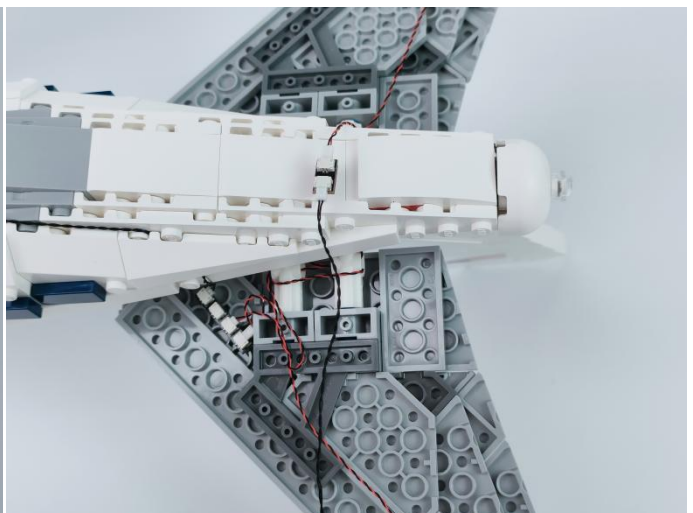

142

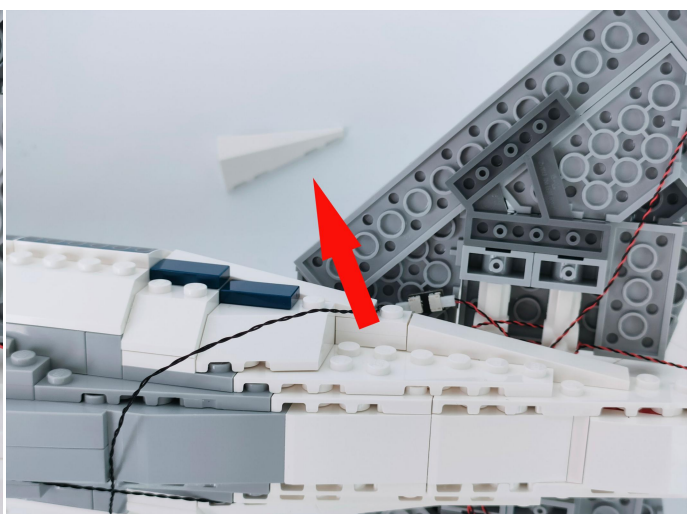
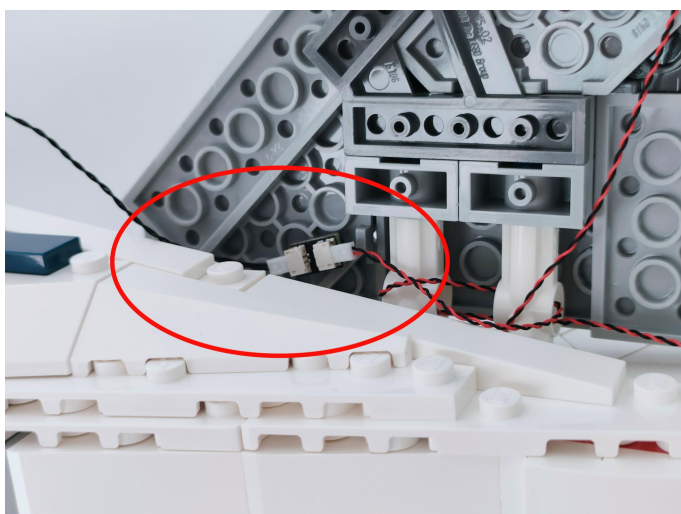



**143.** Be careful to place the lighting wire between the protrusions of the building blocks to avoid crushing the wire during restoration.

Finally, restore the white building blocks.

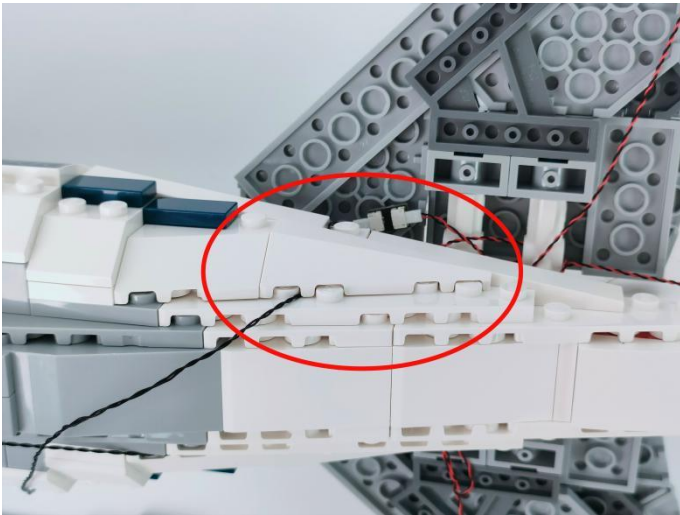

**144**

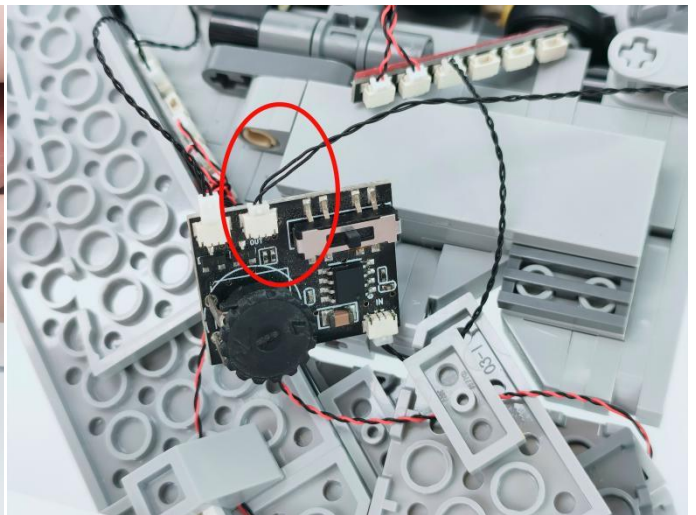
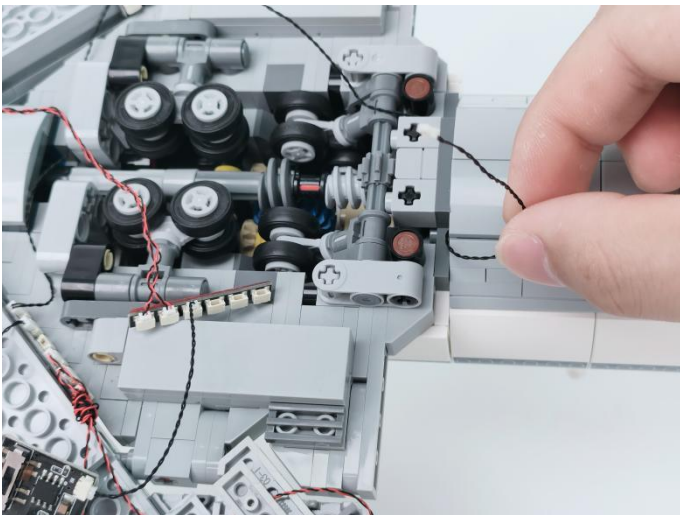

**145**

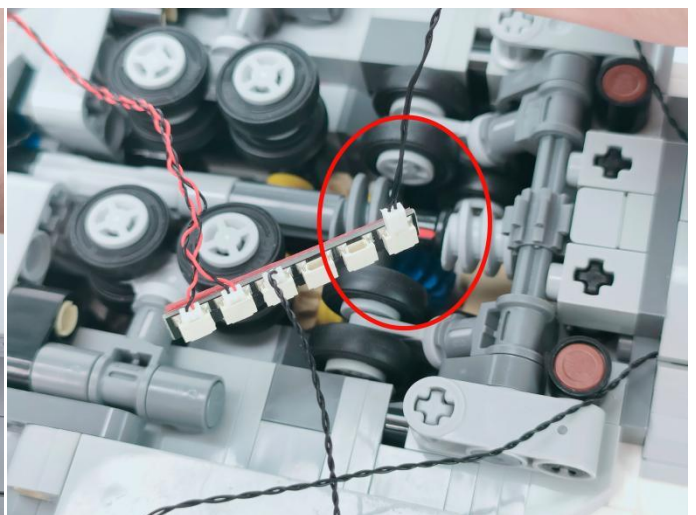
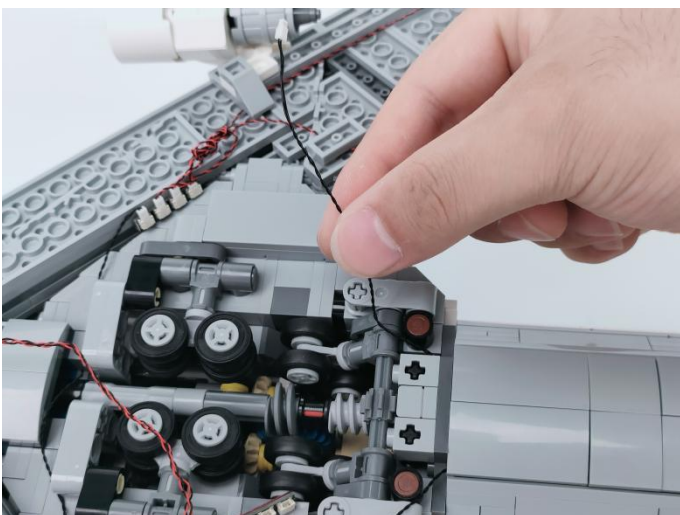

146

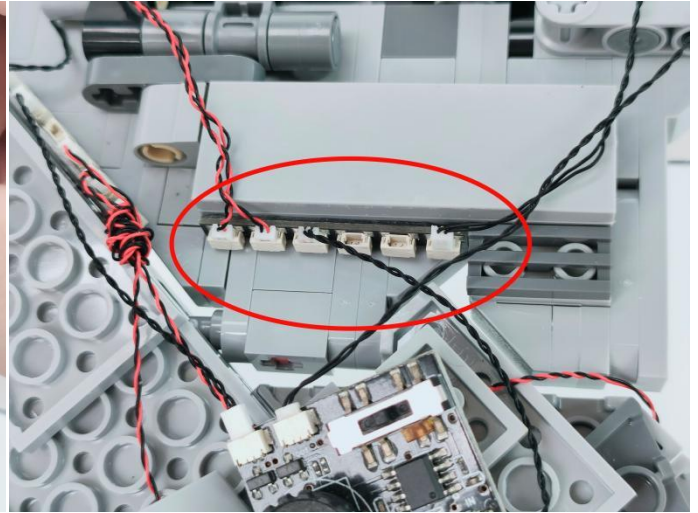
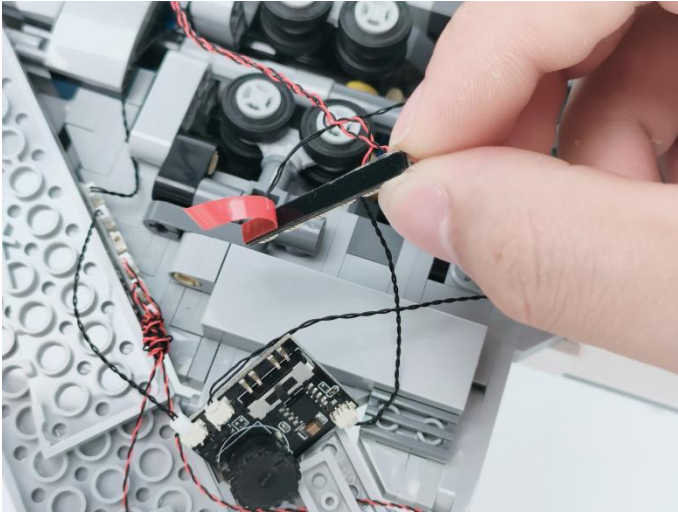

**147.** Peel off the adhesive paper on the back of the breathing module and stick it onto the building block.

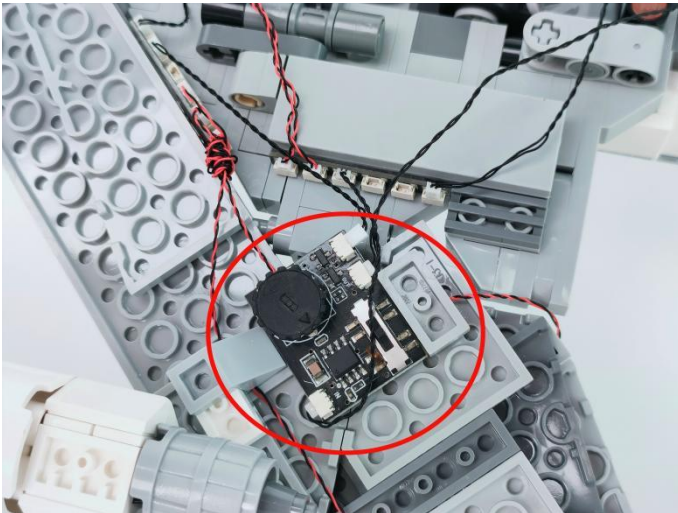



**148.**First, disassemble the building blocks. Then, route the connecting wire around the protrusions of the building blocks. Finally, reassemble the building blocks and press down on the connecting wire.

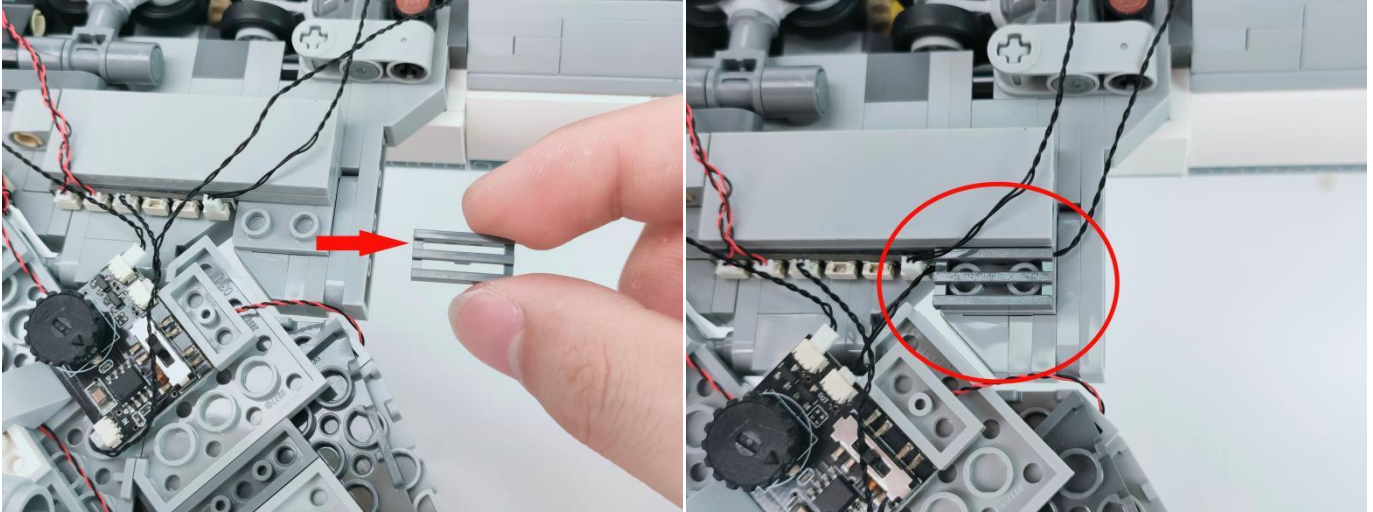

**149.**Take out another airplane and locate the connecting wire in the diagram. Attach it to the expansion board.

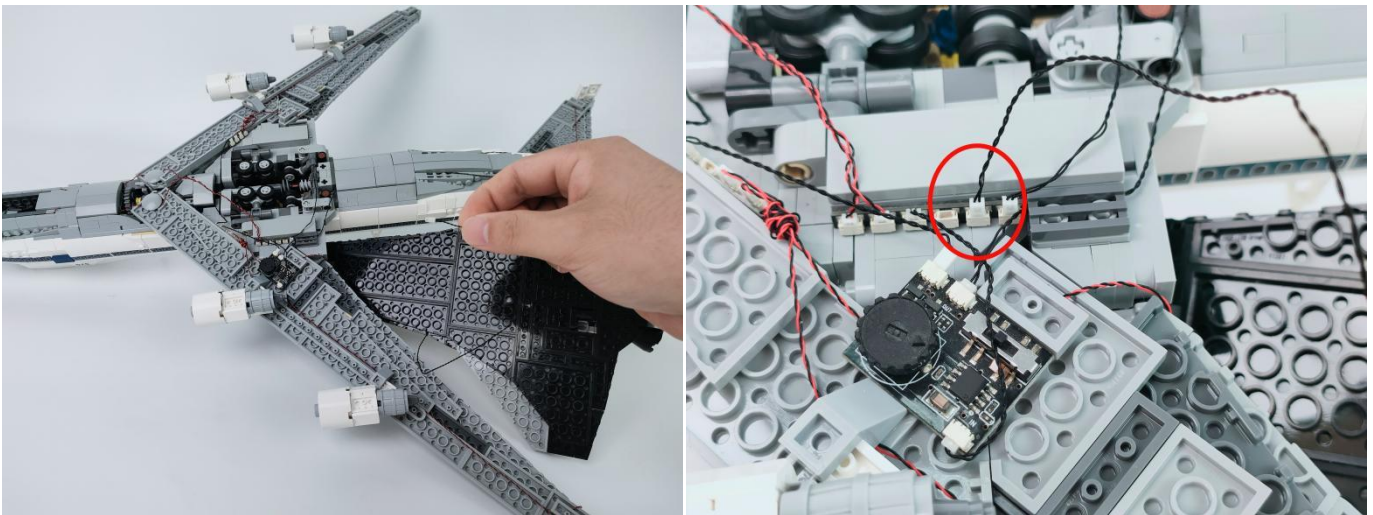

150

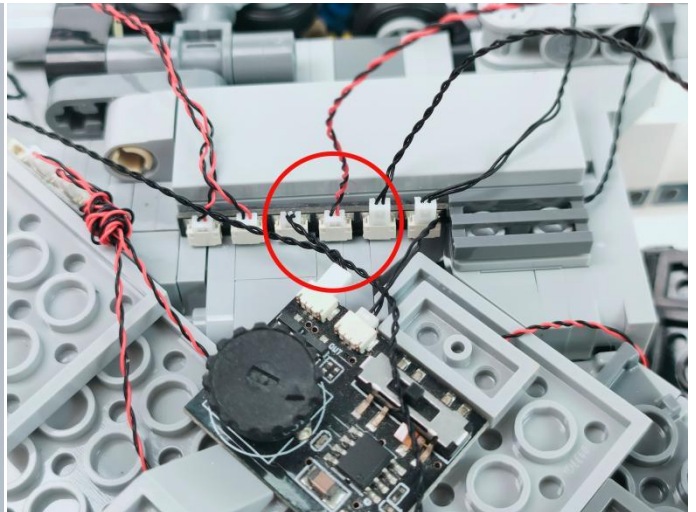

151



**Good job, you've done all the installation steps, power it up and enjoy your work.**



The battery box can also power the set. If it is necessary to change the power supply , prepare three AAA batteries, install them in the battery box, turn on the switch on the battery box, remove the plug of the USB Power Cable from the socket of the expansion board,plug the plug of the battery box to the same socket in the expansion board to power the suit as well.

**THANKS**